

Latitude 8° 10'

Longitude 81° 30'

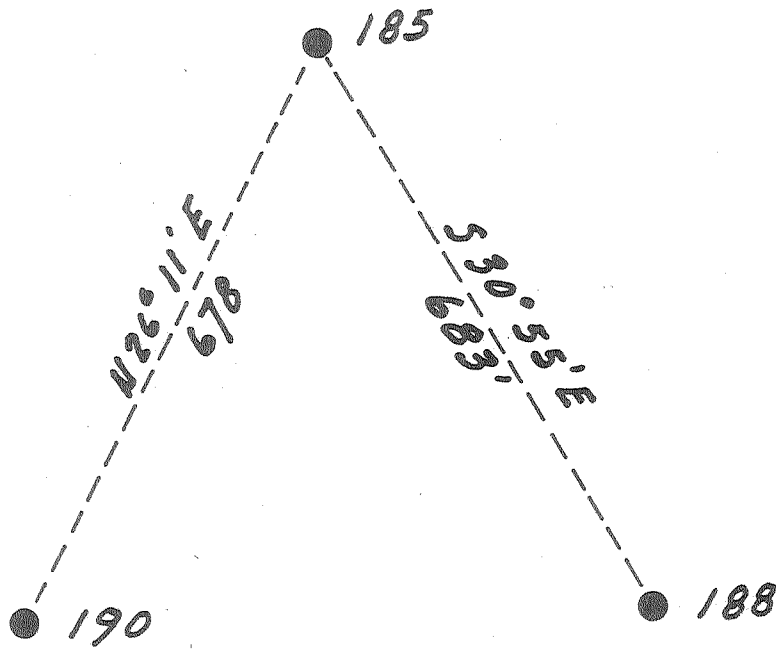

Williams Coal Co.  
12000 <sup>ac</sup>

0.75 W  
K.O.A.

New Location...   
Drill Deeper.....   
Abandonment.....

JUN 21 1960

Company Pure Oil Co.  
 Address Box 311 Olney, Ill  
 Farm Williams Coal Co.  
 Tract \_\_\_\_\_ Acres 12000 Lease No. 5012  
 Well (Farm) No. 185 Serial No. 535  
 Elevation (Spirit Level) 1529.0  
 Quadrangle Peytona  
 County Kanawha District Cabin Creek  
 Engineer J. B. Hunter  
 Engineer's Registration No. Ohio-2912  
 File No. \_\_\_\_\_ Drawing No. \_\_\_\_\_  
 Date 4/14/60 Scale 1" = 200'

STATE OF WEST VIRGINIA  
DEPARTMENT OF MINES  
OIL AND GAS DIVISION  
CHARLESTON

WELL LOCATION MAP  
FILE NO. KAN-1306-A

+ Denotes location of well on United States Topographic Maps, scale 1 to 62,500, latitude and longitude lines being represented by border lines as shown.

- Denotes one inch spaces on border line of original tracing.

7-3-280

WILLIAMS COAL CO., No. 185 - PURE OIL CO., - KAN-1306-A



STATE OF WEST VIRGINIA  
DEPARTMENT OF MINES  
OIL AND GAS DIVISION

20824

WELL RECORD

Quadrangle Payson

Permit No. Kan-1306-A

Oil or Gas Well Wtr. Inj.  
(KIND)

Company The Pure Oil Company  
Address Box 551 Newark, Ohio R.D.#1  
Farm Williams Coal Company Acres 12,000  
Location (waters) Cabin Creek  
Well No. 185 Elev. 1524.7  
District Cabin Creek County Kanawha

Casing and Tubing	Used in Drilling	Left in Well	Packers
Size			
16			Kind of Packer
13			
10	1025	1025	Size of
8 1/4	1334	1334	
6 5/8	2555	2555	Depth set
5 3/16			
3		3160	Perf. top
2			Perf. bottom
Liners Used			Perf. top
			Perf. bottom

The surface of tract is owned in fee by Shonk Land Company  
302 Kan. Bnkg & Trust Co. Bldg. - Charleston, W. Va.  
Mineral rights are owned by Ditto

Address \_\_\_\_\_  
Drilling commenced May 28, 1918  
Drilling completed October 16, 1918  
Date Shot 10-16-18 From 3179 To 3193  
With 50 qts. Glycerine

Open Flow /10ths Water in \_\_\_\_\_ Inch  
/10ths Merc. in \_\_\_\_\_ Inch

Volume \_\_\_\_\_ Cu. Ft.  
Rock Pressure \_\_\_\_\_ lbs. \_\_\_\_\_ hrs.

Oil \_\_\_\_\_ bbls., 1st 24 hrs.  
Fresh water 80 feet \_\_\_\_\_ feet  
Salt water \_\_\_\_\_ feet \_\_\_\_\_ feet

CASING CEMENTED \_\_\_\_\_ SIZE \_\_\_\_\_ No. Ft. \_\_\_\_\_ Date \_\_\_\_\_

COAL WAS ENCOUNTERED AT 80 FEET 36 INCHES  
808 FEET 36 INCHES 958 FEET 48 INCHES  
993 FEET 48 INCHES 1018 FEET 48 INCHES

Formation	Color	Hard or Soft	Top	Bottom	Oil, Gas or Water	Depth Found	Remarks
Conductor			0	11			
Sand	white		11	40			
Slate	black		40	48			
Sand	white		48	80	water	80'	Could not be bailed.
Coal	black		80	83			
Slate	black		83	95			
Sand	white		95	140			
Coal	black		140	143			
Slate	black		143	155			
Sand	white		155	175			
Slate	black		175	182			
Sand	white		182	230			
Slate	black		230	247			
Sand	white		247	290			
Slate	black		290	315			
Sand	white		315	355			
Slate	black		355	378			
Sand	white		378	442			
Slate	black		442	450			
Sand	white		450	470			
Slate	black		470	510			
Sand	white		510	650			
Slate	black		650	672			
Sand	white		672	755			
Slate	black		755	783			
Sand	white		783	808			
Coal	black		808	811			
Slate	black		811	860			
Sand	white		860	958			
Coal	black		958	962			
Sand	white		962	993			
Coal	black		993	997			
Sand	white		997	1012			
Slate	black		1012	1018			
Coal	black		1018	1022			
Sand	white		1022	1050			
Slate	black		1050	1090			
Sand	white		1090	1123			

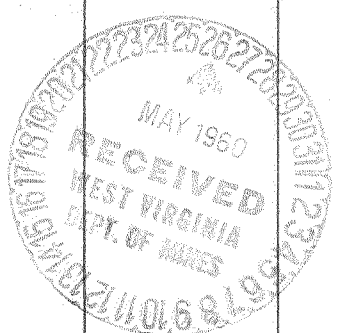

AUG 2 1961

Formation	Color	Hard or Soft	Top	Bottom	Oil, Gas or Water	Depth Found	Remarks
Slate	black		1123	1225			
Sand	white		1225	1252			
Slate	black		1252	1325			
Sand	white		1325	1362			
Slate	black		1362	1380			
Sand	white		1380	1412			
Slate	black		1412	1438			
Sand	white		1438	1550			
Slate	black		1550	1608			
SALT SAND	white		1608	1852			
Slate	white		1852	1900			
Red Rock			1900	1910			
Slate&Shells	gray		1910	1980			
Gritty Lime	gray		1980	2035			
Red Rock			2035	2070			
Slate&Lime	gray		2070	2152			
MAXON SAND	white		2152	2390			
Slate	black		2390	2500			
Lime	black		2500	2525			
BIG LIME	white		2525	2725			
BIG INJUN	red		2725	2760			
Slate&Lime	black		2760	2972			
WEIR SAND	white		2972	3000			
Slate&Lime	black		3000	3115			
Shale	brown		3115	3159			
BEREA SAND	white		3159	3193			
TOTAL DEPTH				3194			
TOTAL DEPTH AFTER C.O.				3199			

Note: Casinghead lowered 3' in 1919. All measurements should be made from a point 3' above same.

MAY 25 1960

Date ~~0-2-33~~, 19 ~~33~~

APPROVED The Pure Oil Company, Owner

By Guy J. Andersen, Division Superintendent  
(Title)

*Guy J. Andersen*