

Latitude 38° 35'

Longitude 81° 25'

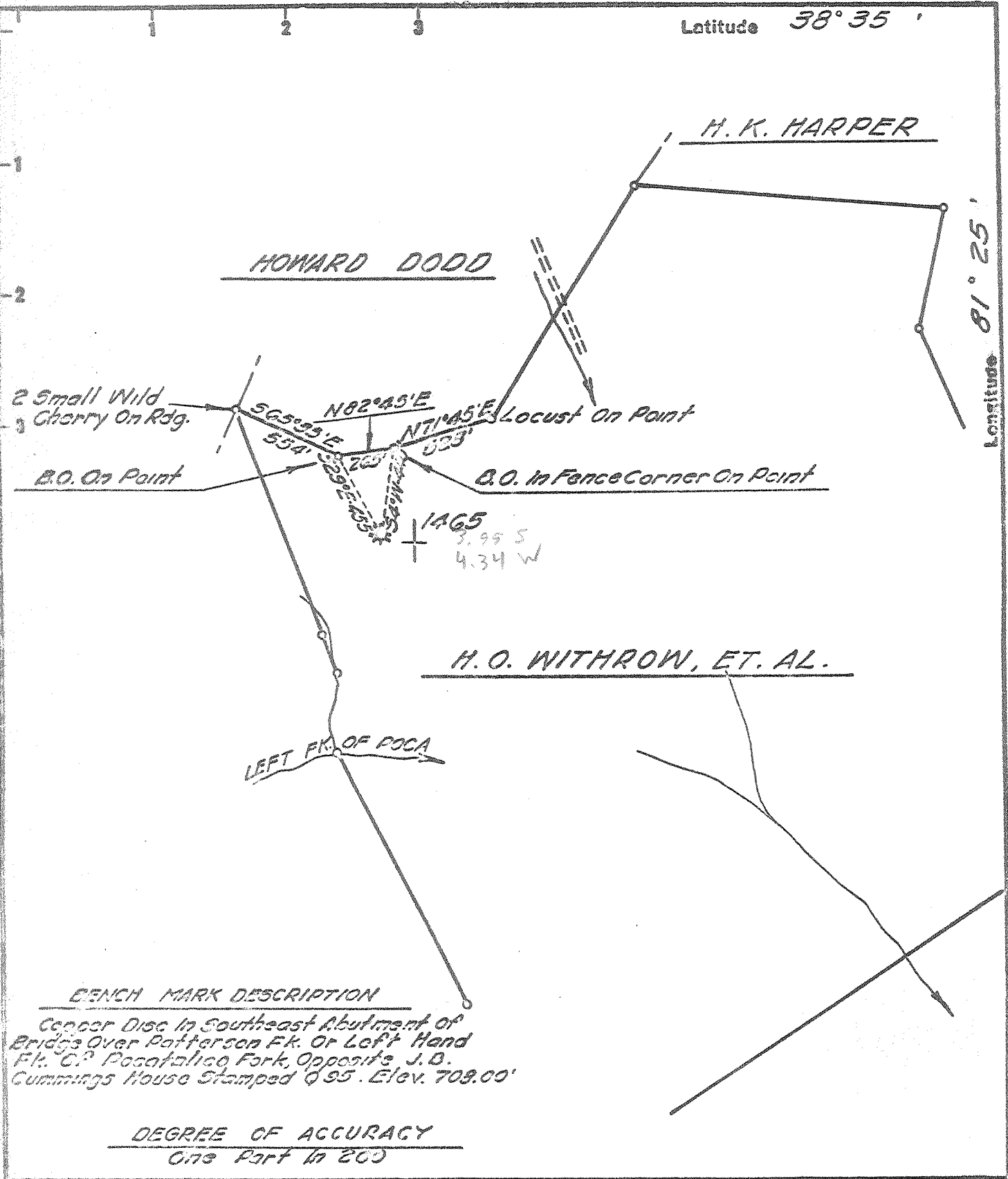

Fracture	<input type="checkbox"/>
Before 6/5/29	<input type="checkbox"/>
New Location	<input type="checkbox"/>
Drill Deeper	<input type="checkbox"/>
Redrill	<input type="checkbox"/>
Abandonment	<input checked="" type="checkbox"/>

I, the undersigned, hereby certify that this map is correct to the best of my knowledge and belief and shows all the information required by Paragraph 5 of the Rules and Regulations of the Oil and Gas Section of the Mining Laws of West Virginia.

The accuracy of this survey is within the limits and as prescribed in paragraph 5 by the Oil and Gas Division of the Department of Mines Regulations.

PROVEN ELEVATION 709.00'

Company UNITED FUEL GAS CO.  
 Address CHARLESTON, W. VA.  
 Farm H. O. WITHROW ET. AL.  
 Tract \_\_\_\_\_ Acres 293 Lease No. 13303  
 Well (Farm) No. 2 Serial No. 1465  
 Elevation (Spirit Level) 946.17'  
 Quadrangle WALTON SW  
 County KANAWHA District ELK  
 Engineer D. J. Smith  
 Engineer's Registration No. 2712  
 File No. 68-71 Drawing No. \_\_\_\_\_  
 Date DEC. 20, '67 Scale 1" = 660'

STATE OF WEST VIRGINIA  
 DEPARTMENT OF MINES  
 OIL AND GAS DIVISION  
 CHARLESTON

**WELL LOCATION MAP**  
 FILE NO. KAN-1394-A

+ Denotes location of well on United States Topographic Maps, scale 1 to 62,500 latitude and longitude lines being represented by border lines as shown.

- Denotes one inch spaces on border line of original tracing.