

Latitude 38° 15'

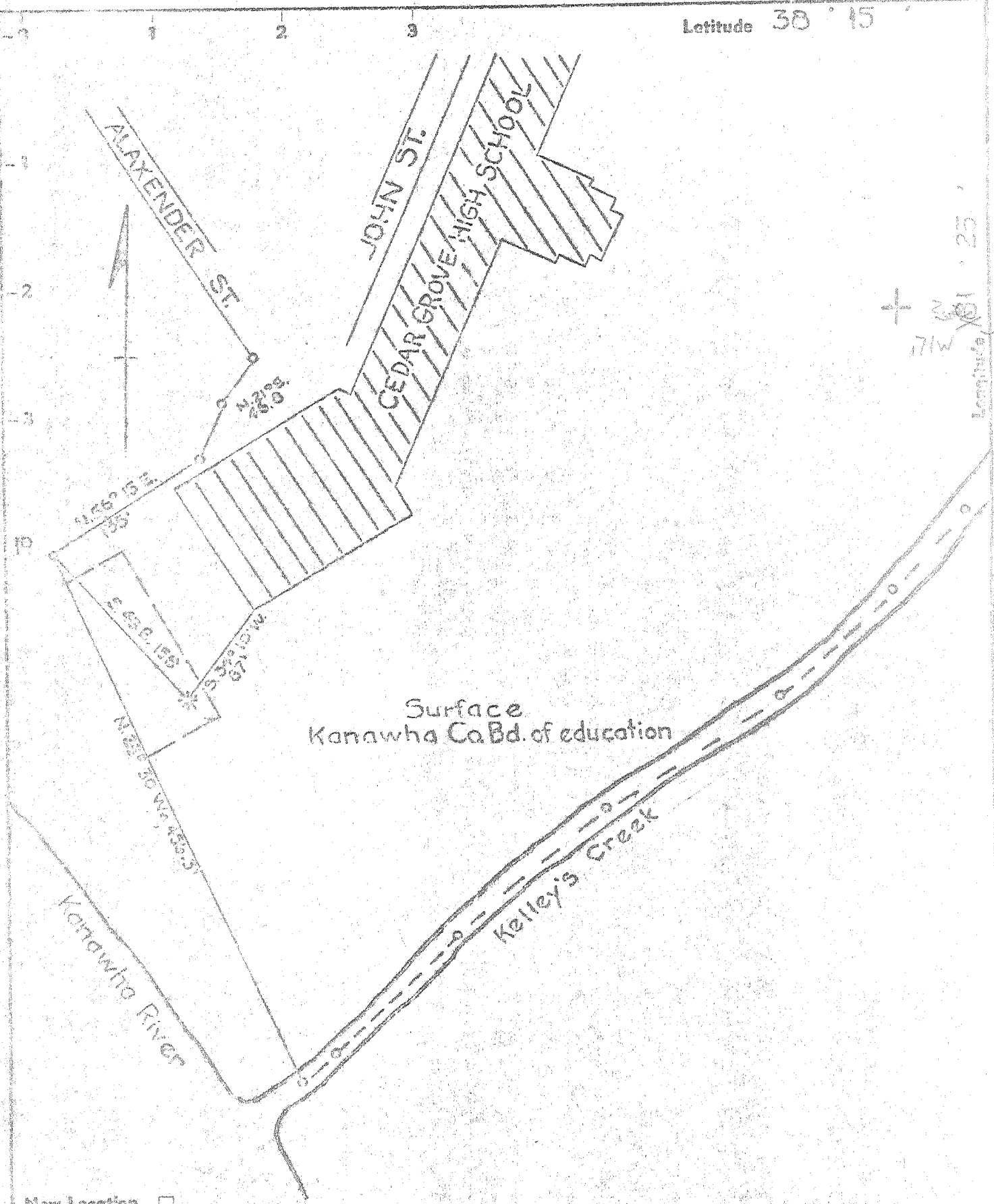

Surface
Kanawha Co Bd. of education

- New Location
- Drill Deeper
- Redrill
- Abandonment

"I, the undersigned, hereby certify that this map is correct to the best of my knowledge and belief and shows all the information required by paragraph 6 of the rules and regulations of the oil and gas section of the mining laws of West Virginia."

Company Kanawha Co Bd. of Education
 Address Charleston, W. Va.
 Person Mattie Bierre
 Tract Acres .17 Lease No. _____
 Well (Farm) No. 1 Serial No. C-16
 Elevation (Spot or Level) 608.3
 Quadrant's Montgomery NW
 County Kanawha District Cabin Ck.
 Mine 2602
 Engineer's Registration No. 2602
 Drawing No. _____
 Date 6-20-70 Scale 1" = 100'

STATE OF WEST VIRGINIA
 DEPARTMENT OF MINES
 OIL AND GAS DIVISION
 CHARLESTON

WELL LOCATION MAP
 FILE NO. KAN-1402-3(A)

+ Denotes location of well on United States Topographic Maps, scale 1 to 62,500, latitude and longitude lines being represented by border lines as shown.
 — Denotes one inch spaces on border line of original tracing.