

LATITUDE 38°25'

81°50'

LONGITUDE

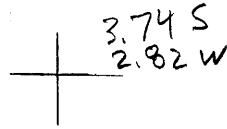

7'5 OGIS topo location

7.5' loc \_\_\_\_\_ 15' loc \_\_\_\_\_  
 \_\_\_\_\_ (calc.) \_\_\_\_\_

Company Kanawha Drilling & Development

Farm Jack Bryan #1

Quad St. Albans

County Kanawha

District Jefferson

WELL LOCATION MAP

File No. 70019  
# 625A in CO RPT

40592

Jefferson District, Kanawha County, W. Va.  
 By Kanawha Drilling and Development Co. (Guffey & Galey, owners  
 of property).

On 475 acres.

Completed, Feb. 15, 1909.

Drillers: Ed. Risher and W. H. Kirtley.

Located on Rockcamp of Browns Creek, 5 mi. S. W. of St. Albans.

Elevation, 715'.

10" casing, 29'; 8", 185'; 6-5/8", 1385' ~~(~~1385'~~)~~.

Big dose salt water, 950'; little gas in Big Lime, 1460'; little  
 gas in Big Injun, 1605'; little gas in Berea Grit, 2070'.

Well pulled out and abandoned.

F. G. Leidecker, Foreman.

	Top.	Bottom.
Conductor	0	10
Surface	0	24
Slate	24	150
Sand	150	195
Slate	195	210
Sand	210	240
Slate	240	265
Sand	265	400
Slate	400	410
Sand	410	510
Slate	510	515
Sand	515	630
Slate	630	670
Sand	670	720
Slate	720	790
Sand	790	810
Slate	810	830
Sand	830	850
Slate	850	870
Sand (Salt) (big dose salt water, 950')	870	1380
Big Lime (little gas at 1460')	1380	1580
Slate	1580	1600
Big Injun Sand (little gas at 1605')	1600	1650
Slate and shells	1650	2065
Berea Grit Sand (little gas at 2070')	2065	2088
Slate, to bottom	2088	2093