

LATITUDE 38°30'

LONGITUDE 81°25'

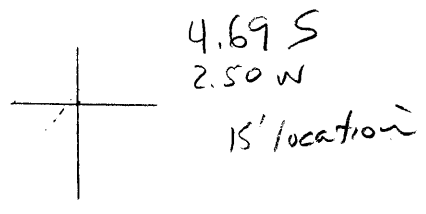

7'5 OGIS topo location

7.5' loc _____ 15' loc _____
 _____ (calc.) _____

Company William S. Edwards Oil Co
 Farm Edna Myers 2
 Quad Clendenin 15'
 County Kanawha
 District E1K

WELL LOCATION MAP
 File No. 40201 70 256
 #182 in Kanawha
 County Report

1914 WUGES