

# HOPE NATURAL GAS COMPANY

LOCATION FOR WELL No. 4281

c 2  
Instructions ✓

On Kandaria DISTRICT  
Freda M. Colvin Farm, on waters of Brook Creek  
Brook Creek District, Lewis County, West Virginia.

Lease No. 24530 Acres 3.2 N. 24 E. 10 W.  
Scale one inch equals 80 P.O. Location made in Pittsburgh May 2, 1916 Sent to Clarksburg May 3, 1916

Location to be 500 feet from A. M. Stalnaker farm and 500 feet from Isaac Jackson 47 1/2 farm.

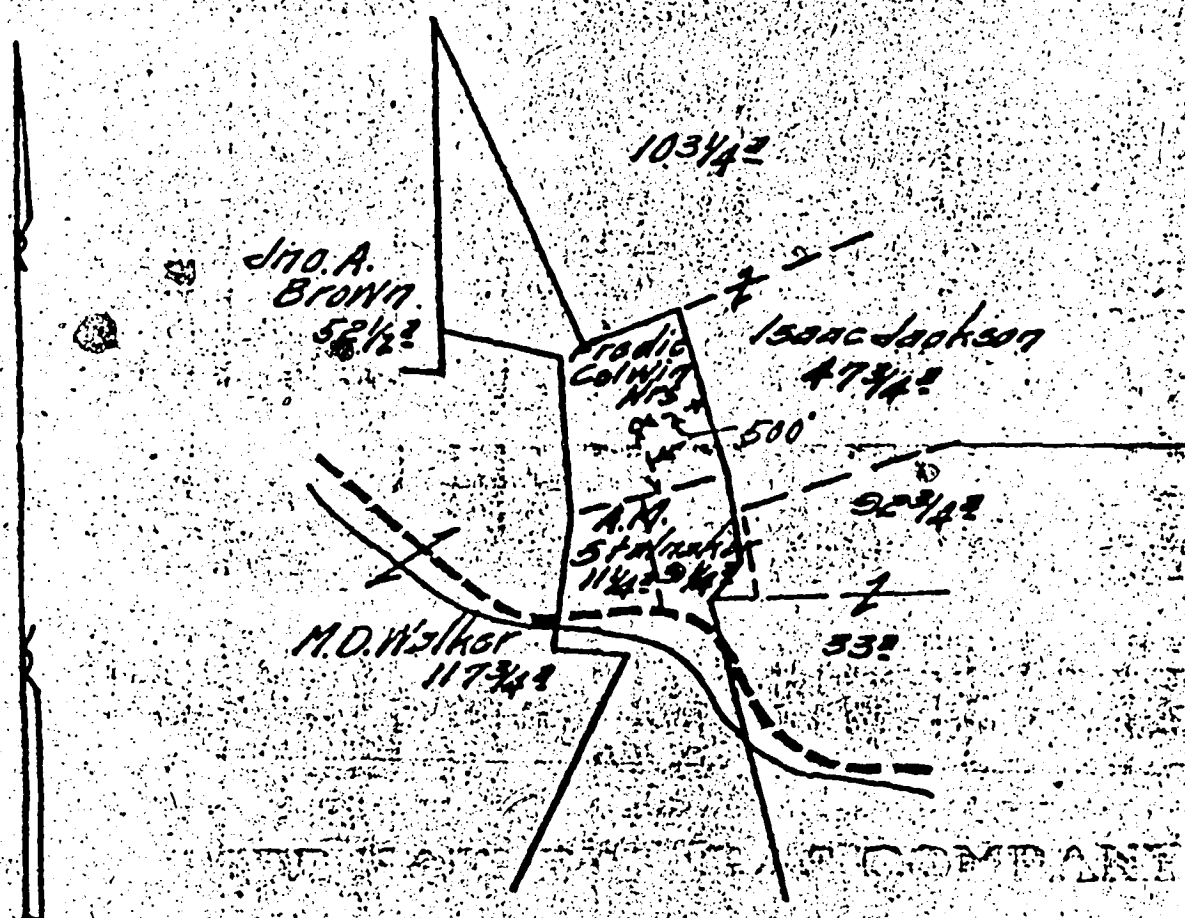

NOT - 641 - 2266

51

TITLE RESERVE Two hundred feet around the dwelling house

SPECIAL INSTRUCTIONS: COMPLETE WELL ON OR BEFORE \_\_\_\_\_  
Same Lease on which Located Well No. \_\_\_\_\_

Location made 5-8-16 by W. Cunningham plat, except as noted. On field map 5-9-16 Returned to Pittsburgh 5-9-16

Location changed on account of \_\_\_\_\_  
Authorized by \_\_\_\_\_ Date \_\_\_\_\_ Signed \_\_\_\_\_

STATE OF WEST VIRGINIA  
DEPARTMENT OF MINES, OIL AND GAS DIVISION

DESIGNATION OF AGENT BY WELL OWNER OR OPERATOR

Well Operator  / Owner  Consolidated Gas Supply Corporation  
Address 445 West Main Street  
Clarksburg, West Virginia 26301

Pursuant to the provisions of Code § 22-4-1k, and subject to the requirements of Regulation 7.01, the undersigned hereby designates the following person to be the agent of the undersigned for the purpose of receiving process, notices, orders and other communications which may be issued under Chapter 22 of the Code of West Virginia:

Designated Agent: J. W. Hendrickson  
Address 445 West Main Street  
Clarksburg, West Virginia 26301  
Telephone 304-623-3611

The undersigned represents that said designated agent is a bona fide resident of the State of West Virginia, and has agreed to accept the designation. This designation applies to the following wells:

- all wells owned or operated by the undersigned in West Virginia
- the wells listed below (Use space below or reverse side or attach list)

[COMPLETE AS APPLICABLE]

The undersigned is hereby recording an existing designation of agent made prior to the initial adoption of Form IV-1.

The undersigned is proposing to own or operate wells in West Virginia for the first time, so that this designation should also be considered the registration by the undersigned with the Deputy Director.

The undersigned has owned and operated a well or wells in West Virginia since the year 1898, but has not heretofore appointed a designated agent.

This designation substitutes a new designated agent for the undersigned, who has owned or operated a well or wells in West Virginia since the year 19\_\_\_\_. The present designated agent of the undersigned, who will continue as such, if he is able, until this new designation has been approved, is--

Agent being replaced \_\_\_\_\_  
Address \_\_\_\_\_

*Handwritten:* API-041-2266

Consolidated Gas Supply Corp.  
Well Owner or Operator  
By: [Signature]  
Its: Vice President, Appl. Gas Supply

ACCEPTED this January 17, 19 79

[Signature]  
(Signature of designated agent)

Taken, subscribed and sworn to before me this 17th day of January, 19 79.  
Notary Public [Signature] My commission expires September 13, 19 86

Record of 4781 Well No. 4781 Company Kanawha  
 Located on Stacker Creek District Stacker Creek  
 County Lewis State W. Va.  
 Date Made 5/8-16 First Work Done 6/1-16  
 Commenced 6/1-16 Rig Completed 6/12-16  
 Drilling Commenced 6/14-16 Drilling Completed 7-23-16  
 Contractor J. H. Watson Drilling Contractor J. H. Watson  
 Drilling J. H. Watson W. B. & Co. Tools, String, etc. J. H. Watson  
 Tool Dressers Bill Henderson Ray Romano

FORMATION	TOP	BOTTOM	Steel Line Measurements	Water Found Depth	Oil Found Depth	Gas Found Depth	REMARKS
10' Coal	215	218					10' bl 206 7/8
bury Coal							8 1/2 " 868 7/8
g. Drift	290	390	8 1/2 "				6 1/2 " 144 1/2 "
Dunkard	400	445	"				5 1/2 " 202 3/4 "
Sand	480	565	4 "	555		53	just full
at Salt	645	760	"				
and Salt	870	854	"				
Iron	1260	1308	"	1290			2 Bales of fl
the Lime							
well Cave							
Lime	1327	1397					
Injun	1397	1530					
Law							
rea							
uff	1702	1712	"				1702 3/10 W. 2' of
ity Fod	1817	1835	"				
arty Pea	1898	1910	"				
rdon Stray	2078	2055	"				
rdon	2059	2075	"				
urb	2096	2141	"				2105-2110 4 1/10 W. 2' of
th	2222	2236	"				2223-2234 1 1/10 W. 2' of
yard							
al Depth		2286					

SIZE	Charged to Wall		Put in Wall		Packed Out		Left in Wall		Transferred Before Completion		Left at Well Not in Use		If more than two strings of casing are left in hole, give reasons for leaving additional strings
	Feet	In.	Feet	In.	Feet	In.	Feet	In.	Feet	In.	Feet	In.	
13" Cas.	339	11	208	-	208	-	None	None	None	None	339	11	
10" "	1031	10	875	5	875	5	None	157	4	880	16		
8" "	1724	2	1444	-	None	1444	-	150	8	129	6		
6" "	2249	7	2053	-	None	2053	-	44	3	152	4		
3" "	2424	2	2237	-	None	2237	-	None	None	192	2		
3" "	66	-	66	-	None	66	-	None	None	None	None		

PACKER RECORD

SIZE	KIND	Amount Ancher	Amount Above Ancher	REMARKS
5/8"	B.H.			
1/2"	B.H.			
3/16"	Wire	272	20.64	

SHOOTING RECORD (If shot before or upon completion of wall)

DATE	Quarts	Top of Shot		Diameter	Sand	Test Before Shot			Test After Shot			Test Taken After Shot No. Hours	By Whom Shot
		Reading	Liquid			Over	Reading	Liquid	Over				
7/6/16	70	2224	2237	4	5th	16/10	Mer	2	17/10	Mer	2	24	M. J. C.

CEMENTING RECORD

Date Cemented.....Slac Holes Cemented.....Slac Casing Cemented.....  
 Top Pittsburg Coal.....Top Cementing.....Amount Cement Used.....  
 Bottom Pittsburg Coal.....Bottom Cementing.....Amount Sand Used.....  
 Mr.....Coal Company on ground when coal was cemented  
 Remarks.....Signature of persons who cemented well

No. 19191 E. 66  
 V. S. Map SEP 5 - 1916 J.C.L.  
 Lit. Map SEP 5 - 1918 A.J.D.  
 Sec. SEP 5 - 1916 H.H.  
 Approved by [Signature] Foreman  
 04-2266  
 APC-041

1.0 API well number (If not available, leave blank 14 digits.)	47-041 2266			
2.0 Type of determination being sought. (Use the codes found on the front of this form.)	108 Section of NGPA		Category Code	
3.0 Depth of the deepest completion location. (Only needed if section 103 or 107 in 2.0 above.)	feet			
4.0 Name, address and code number of applicant. (35 letters per line maximum. If code number not available, leave blank.)	Consolidated Gas Supply Corporation Name		004228 Seller Code	
	445 West Main Street Street			
	Clarksburg City		W. Va. 26301 State Zip Code	
5.0 Location of this well. (Complete (a) or (b).) (a) For onshore wells (35 letters maximum for field name.)	West Virginia Other Field Name		A-85772	
	LEWIS County		W. Va. State	
(b) For OCS wells	Area Name		Block Number	
	Date of Lease		OCS Lease Number	
	Mo Day Yr			
(c) Name and identification number of this well. (35 letters and digits maximum.)	FREDA M. Calvin		4281	
(d) If code 4 or 5 in 2.0 above, name of the reservoir. (35 letters maximum.)				
6.0 (a) Name and code number of the purchaser. (35 letters and digits maximum. If code number not available, leave blank.)	General System Purchasers Name		7 Buyer Code	
(b) Date of the contract	Mo Day Yr			
(c) Estimated annual production	1.5 MMcft.			
7.0 Contract price (As of filing date. Complete to 3 decimal places.)	(a) Base Price (\$/MMBTU)	(b) Tax	(c) All Other Prices (Indicate (+) or (-).)	(d) Total of (a), (b) and (c)
8.0 Maximum lawful rate (As of filing date. Complete to 3 decimal places.)	2.224			
9.0 Person responsible for this application:	J. W. Hendrickson Name		V.P. Gas Supply Title	
Agency Use Only	Signature: <i>J. W. Hendrickson</i>			
Date Received by Regulatory Agency	12/31/78 Date Application is Completed			
Date Received by FERC	304-623-3611 Phone Number			

**U.S. DEPARTMENT OF ENERGY**  
Federal Energy Regulatory Commission  
Washington, D.C. 20426

**APPLICATION FOR DETERMINATION OF THE MAXIMUM LAWFUL  
PRICE UNDER THE NATURAL GAS POLICY ACT (NGPA)**  
(Sections 102, 103, 107 and 108)

**PLEASE READ BEFORE COMPLETING THIS FORM:**

General Instructions

Complete this form if you are applying for price classification under sections 102, 103, 107 or 108 of the NGPA. A separate application is required for each well. If any reservoir qualifies for a category which differs from the category applicable to the producing well, separate applications must be made for the producing well and the reservoir. Complete each appropriate item on the reverse side of this page. The code numbers used in items 4.0 and 6.0 can be obtained from the Buyer/Seller Code Book. If there is more than one purchaser or contract, identify the additional information in the space below. Enter any additional remarks in the space below.

Submit the completed application to the appropriate Jurisdictional Agency as listed in title 18 of the CFR, part 270.103. If there are any questions, call (202) 275-4539.

Specific Instructions for Item 2.0, Type of Determination

<u>Section of NGPA</u>	<u>Category Code</u>	<u>Description</u>
102	1	New OCS Lease
102	2	New onshore well (2.5 mile test)
102	3	New onshore well (1,000 feet deeper test)
102	4	New onshore reservoir
102	5	New reservoir on old OCS Lease
103	-	New onshore production well
107	-	High cost natural gas
108	-	Stripper well

Other Purchasers/Contracts:

<u>Contract Date</u> (Mo. Day Yr.)	<u>Purchaser</u>	<u>Buyer Code</u>
_____	_____	_____
_____	_____	_____
_____	_____	_____

Remarks:

Applicant is an interstate pipeline company. Its production from the subject well is delivered into its pipeline system and is therefore not subject to a field sales contract.

PARTICIPANTS:

DATE:

APR 2 1980

BUYER-SELLER CODE

WELL OPERATOR: Consolidated Gas Supply Corp.

004228

FIRST PURCHASER: General System Purchasers

N/A

OTHER:

Qualifier as Section 108 Shallow well  
Fractured

W. Va. Department of ~~Mineral~~ Oil & Gas Division  
 WELL DETERMINATION FILE NUMBER  
 790227-108-041-2266  
 Use Above File Number on all Communications  
 Relating to Determination of this Well

CHECK EACH ITEM AS COMPLETE OR NOTE WHAT IS MISSING

ITEM NO.

- 1 FERC-121  Items not completed - Line No. \_\_\_\_\_
- 2 IV-1 - Agent  J. W. Hendrickson
- 3 IV-2 - Well Permit \_\_\_\_\_
- 4 IV-6 - Well Plat
- 5 IV-35- Well Record  Drilling  Deepening \_\_\_\_\_
- 6 IV-36- Gas-Oil Test: Gas Only  Was Oil Produced? \_\_\_\_\_ Ratio \_\_\_\_\_
- 7 IV-39- Annual Production 3 years
- 8 IV-40- 90 day Production 90 Days off Line: \_\_\_\_\_
- 9 IV-48- Application for Certification. Complete?
- 10 - 17 IV Form #51 - 52 - 53 - 54 - 55 - (56) - 57 - 58. Complete  Affidavit Signed
- 18 - 28 Other: Survey \_\_\_\_\_ Logs \_\_\_\_\_ Geological Charts \_\_\_\_\_ Structure Map \_\_\_\_\_  
 1:4000 Map \_\_\_\_\_ Well Tabulations \_\_\_\_\_ Gas Analyses \_\_\_\_\_
- (5) DATE COMMENCED 6-14-110  
 Date Completed: 7-23-110 Deepened \_\_\_\_\_
- (5) Production Depth: 1702-1712, 2090-2141, 2222-2236
- (5) Production Formation: GRANTZ 4th SAND, FRA SAND
- (5) Final OPEN FLOW: 53 computer sheet
- (5) ~~AFRR~~ R.P. ~~FRAC.~~ 460
- (6) Other Gas Test: \_\_\_\_\_
- (7) Avg. Daily Gas from Annual Production:  $\frac{1525}{365} = 4.2$  Mcf
- (8) Avg. Daily Gas from 90-day ending w/1-120 days:  $\frac{378}{90} = 4.2$  Mcf
- (8) Line Pressure: 23# PSIG from Daily Report
- (5) Oil Production: \_\_\_\_\_ From Completion Report \_\_\_\_\_
- (10-17) Does lease inventory indicate enhanced recovery being done? NO
- (10-17) Is affidavit signed?  Notarized?

Does official well record with the Department confirm the submitted information? yes

Additional Information \_\_\_\_\_ Does computer program confirm? \_\_\_\_\_

Was Determination Objected to? \_\_\_\_\_ By Whom? \_\_\_\_\_

STATE OF WEST VIRGINIA  
DEPARTMENT OF MINES, OIL AND GAS DIVISION

Date Dec 31 1978

Operator's Well No. 4281

API Well No. 47 - 041 2260  
State County Permit

WELL CLASSIFICATION FORM

STRIPPER GAS WELL

MGPA Section 108

DESIGNATED AGENT J. W. Hendrickson

ADDRESS 445 West Main Street

Clarksburg, West Virginia 26301

WELL OPERATOR Cons. Gas Supply Corp. LOCATION: Elevation \_\_\_\_\_

ADDRESS 445 West Main Street

Watershed Broad Run

Clarksburg, W. Va.

Dist MARKERS CO County Lewis Quad. \_\_\_\_\_

GAS PURCHASER None; gas is de-

Gas Purchase Contract No. N/A

ADDRESS livered into applicant's

Meter Chart Code N/A

interstate pipeline system.

Date of Contract N/A

Provide a complete inventory of the lease and production equipment used for the well for the previous 24 months or, if less than 24 months, the period the well has been in production. Include a complete list of equipment or processes used in connection with recognized enhanced recovery techniques during completion or production. (Attach separate sheets, if necessary.)

See attachment; compression, dehydration, or related equipment indicated on the attached inventory, and hydraulic fracturing, shooting, or similar completion processes indicated on the attached well records, are used in connection with recognized enhanced recovery techniques during production or completion.

List all records reasonably available to you which contain information relevant to a determination of eligibility (including production records, B&O Tax Records and royalty payment records) and indicate the location of such records:

Applicant's oil and gas production records (which are largely computerized) constitute its primary and most reliable source of information relevant to a determination of eligibility. From these records Applicant derives information used by it in connection with royalty payments, tax payments, and general statistical uses, and records of these matters are also maintained. All of the above records are located at Applicant's offices at 445 West Main Street, Clarksburg, West Virginia.

Describe the search made of any records listed above.

As indicated, Applicant's primary oil and gas production records have been largely computerized. In preparing this application, Applicant, by use of its computers, generated a listing of those of its wells which produced non-associated natural gas at a rate not exceeding an average of 60 Mcf per production day (at maximum efficient rates of flow) during the 90 day production period indicated on the attachment. These listings were checked and verified manually by two or more Applicant's employees. The results of this diligent search and examination indicated that the well which is the subject of this application qualifies as a stripper well; see attached data submitted in compliance with applicable regulations of this agency and the Federal Energy Regulatory Commission.

Are you aware of any other information which would tend to be inconsistent with the information specified above? Yes        No   Y  . If yes, indicate the type and source of the information.

AFFIDAVIT

I, J. W. Hendrickson, having been first sworn according to law, state that I have caused to be made a diligent search of those records hereinbefore indicated in the manner herein described, that the information contained in this document is true and accurate and that on the basis of the records and examinations hereinbefore described, and to the best of my information, knowledge and belief, the well for which this certification is sought qualifies as a stripper well.

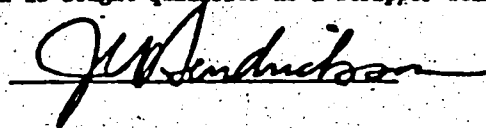

STATE OF WEST VIRGINIA;

COUNTY OF HARRISON, TO WIT:

I, Ralph D. Bradley, a Notary Public in and for the state and county aforesaid, do certify that J.W. Hendrickson, whose name is signed to the writing above, bearing date the        day of DEC 31 1978, 19      , has acknowledged the same before me, in my county aforesaid.

Given under my hand and official seal this 8 day of Feb., 1979.

My term of office expires on the 13th day of September, 1986.

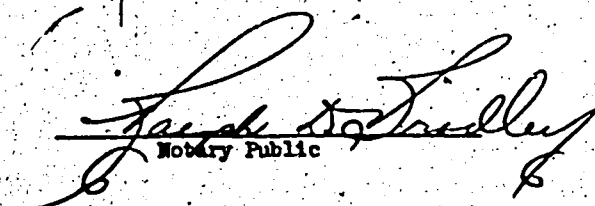

(NOTARIAL SEAL)



CONSOLIDATED GAS SUPPLY CORPORATION--SOUTHERN REGION

WELL NUMBER	4281	DATE COMPLETED	7/23/1966	ORIG OPEN FLOW	53 MCF
COMPANY FORMATION CODE	0	DATE INTO LINE	07/07/66	ORIG ROCK PRES	460 PSI
DISTRICT	KENNEDY	SPUD DATE	07/07/66	PCT INTEREST	100.0000
COUNTY	41			TOWNSHIP	4
WELL NUMBER	99999999			PRE	10/07/69 LEASE
WELL PRESSURE	43 IN 0/71			LAST LINE PRESSURE	23
WELL IDENT NUMBER	2266				

GROSS MONTHLY PRODUCTION IN MCF

	JAN	FEB	MAR	APR	MAY	JUN	JUL	AUG	SEP	OCT	NOV	DEC	TOTAL
76 PROD	0	0	0	0	0	0	0	0	0	0	87	140	227
WELL AVG	0	0	0	0	0	0	0	0	0	0	2	4	3
SEC. GRAV.	0.0	0.0	0.0	0.0	0.0	0.0	0.0	0.0	0.0	0.0	69.430	69.431	
77 PROD	133	134	149	129	115	180	186	186	120	115	159	155	1761
WELL AVG	4	4	4	4	3	6	6	6	4	3	5	5	4
SEC. GRAV.	69.431	69.428	69.431	69.430	69.431	69.430	69.431	69.431	69.430	69.431	69.430	69.431	
78 PROD	175	134	90	90	164	138	161	171	129	136	117	0	1525
WELL AVG	6	4	2	3	5	4	5	5	4	4	3	0	4
SEC. GRAV.	69.431	69.428	69.431	69.430	69.431	69.430	69.431	69.431	69.430	69.431	69.430	0.0	