



SURVEYOR/ENGINEER: 1-304-933-3463
1700 ANMOORE RD.
BRIDGEPORT, WV 26330

SURFACE HOLE LOCATION (SHL):

GEOGRAPHIC (NAD83):
LATITUDE: 39.130330°
LONGITUDE: -80.566304°

SPCS (NAD83, WV NORTH, FEET):
NORTHING: 776,068.193
EASTING: 2,091,540.030

UTM (NAD83, ZONE 17, METERS):
NORTHING: 4,331,329.156
EASTING: 537,485.562

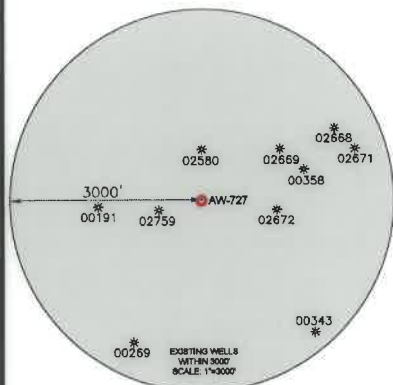

N/F
CURTIS G. FERGUSON
D.B. 552, Pg. 449
TAX MAP #21-03-004B-0040

N/F
CURTIS G. FERGUSON
D.B. 552, Pg. 449
TAX MAP #21-03-004B-0040

N/F
CLARENCE OWEN FERGUSON
D.B. 552, Pg. 612
TAX MAP #21-03-004B-0017

N/F
BERNARD SACHS
D.B. WB34, Pg. 645
TAX MAP #21-03-004C-0033

N/F
STEVEN EUGENE CHUMNEY
D.B. 776, Pg. 131
TAX MAP #21-03-004B-0042

N/F
JEREMY BRYAN & REBECCA KAYE DAY
D.B. 726, Pg. 592
TAX MAP #21-03-004C-0027

1. N/F DAVID N. HILL
D.B. 732, Pg. 27
TAX MAP #21-03-004C-0025-0001

WELL RESTRICTIONS

- NO OCCUPIED DWELLINGS > 2500 SQ FT. WITHIN 625 FEET OF CENTER OF PAD.
- NO AGRICULTURE BUILDINGS > 2500 SQ FT. WITHIN 625 FEET OF CENTER OF PAD.
- NO WATER WELLS OR DEVELOPED SPRINGS ARE WITHIN 250 FEET OF PROPOSED WELL.
- PERENNIAL STREAMS, LAKES, PONDS, OR RESERVOIRS WITHIN 100 FEET OF THE LIMITS OF DISTURBANCE.
- NO NATURALLY PRODUCING TROUT STREAM WITHIN 300 FEET OF LIMITS OF DISTURBANCE.
- NO GROUND INTAKE OR PUBLIC WATER SUPPLY WITHIN 1000 FEET OF WELL PAD, LIMITS OF DISTURBANCE, E & S CONTROLS OR PUBLIC WATER SUPPLY.

NOTES ON SURVEY

- TIES TO WELLS AND CORNERS ARE BASED ON SPCS, NAD83 DATUM, WEST VIRGINIA SOUTH, US FT.
- WELL LAT/LONG ESTABLISHED BY DIRECT GPS NAD '83.
- BOUNDARIES SHOWN ARE TAKEN FROM TAX MAPS, DEEDS, AND FIELD SURVEY. THIS DRAWING IS NOT REPRESENTATIVE OF A FULL BOUNDARY SURVEY.
- SURFACE OWNER INFORMATION TAKEN FROM THE ASSESSOR AND COUNTY CLERK RECORDS OF BARBOUR COUNTY IN OCTOBER OF 2021.
- WELLS SHOWN ARE TAKEN FROM RECORDS OF WVDEP.

I, THE UNDERSIGNED, HEREBY CERTIFY THAT THIS PLAT IS CORRECT TO THE BEST OF MY KNOWLEDGE AND BELIEF AND SHOWS ALL THE INFORMATION REQUIRED BY LAW AND REGULATIONS ISSUED AND PRESCRIBED BY THE DEPARTMENT OF ENVIRONMENTAL PROTECTION.



LINE	BEARING	DISTANCE
L1	S 21°28'52" W	2116.98'
L2	S 44°54'28" E	1545.99'
L3	S 74°42'48" E	754.95'
L4	S 71°46'46" E	643.79'

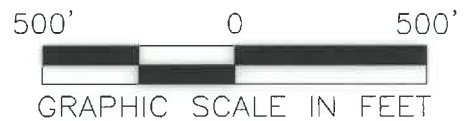

P.S. 983 *Michael R. Hyman* 12-12-2025



(+) DENOTES LOCATION OF WELL ON UNITED STATES TOPOGRAPHIC MAPS
WVDEP
OFFICE OF OIL & GAS
601 57TH STREET
CHARLESTON, WV 25034

MINIMUM DEGREE OF ACCURACY: 1/200
PROVEN SOURCE OF ELEVATION: SURVEY GRADE GPS (NAVD 88, US FT)

OPERATOR'S WELL #: **AW-727**
API WELL #: **47** **41** **2579**
STATE COUNTY PERMIT

WELL TYPE: OIL WASTE DISPOSAL PRODUCTION DEEP GAS LIQUID INJECTION STORAGE SHALLOW

WATERSHED: WEST FORK ELEVATION: 1397.72
DISTRICT: FREEMANS CREEK COUNTY: LEWIS QUADRANGLE: BIG ISAAC

SURFACE OWNER: STEVEN EUGENE CHUMNEY ACREAGE: ±56.5
OIL & GAS ROYALTY OWNER: REBECCA J LIPP et al ACREAGE: ±56.5

DRILL DRILL DEEPER REDRILL FRACTURE OR STIMULATE PLUG OFF OLD FORMATION PERFORATE NEW FORMATION

CONVERT PLUG & ABANDON CLEAN OUT & RE-PLUG OTHER CHANGE (SPECIFY) **05/01/2026**

TARGET FORMATION: GANTZ ESTIMATED DEPTH: TVD TMD

WELL OPERATOR: Eastern Gas Transmission and Storage, Inc. DESIGNATED AGENT: John M. Love
ADDRESS: 925 White Oaks Blvd. ADDRESS: 925 White Oaks Blvd.
CITY: Bridgeport STATE: WV ZIP CODE: 26330 CITY: Bridgeport STATE: WV ZIP CODE: 26330

LEGEND:	REVISIONS:	DATE:
● PROPOSED SURFACE HOLE / BOTTOM HOLE	— SURVEYED BOUNDARY	12-12-2025
☼ EXISTING / PRODUCING WELLHEAD	— DRILLING UNIT	FILE NO:
⊙ EXISTING WATER WELL	— LEASE BOUNDARY	DRAWN BY: TMF
⊙ EXISTING SPRING	— 500' OFFSET LINE	SCALE: 1" = 500'
	— PROPOSED PATH	DRAWING NO: 30-4574
		WELL LOCATION PLAT 1