

**HG Energy II Appalachia, LLC**  
**Well No. Flesher 1212 N-3H**  
**As-Drilled**  
 Page 1 of 2

**Well Location References**  
 Not to Scale

Flesher 1212 Pad  
 AZT2° 350'  
 18" Sycamore  
 AZ336° 367'  
 Flesher 1212 N-3H  
 16" Elm

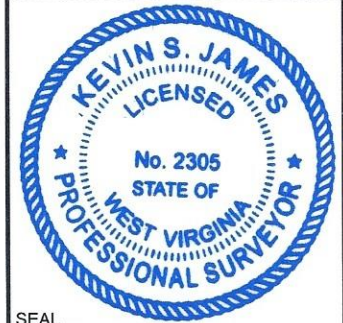

I, the undersigned, hereby certify that this plat is correct to the best of my knowledge and belief and shows all the information required by law and the rules issued and prescribed by the Department of Environmental Protection.

*Kevin S. James*  
 Kevin S. James, P.S. 2305

ID	Lease
5	W.H. Coffindaffer, et al
6	W.H. Coffindaffer, et al
7	A.C. Thrash, et al
12	Mary Post Davis, et al
14	Fannie M. Hughes, et al
15	Alvadore Hughes, et al
17	Henry L. Frashuer, et al
19	A.R. Frashuer, et al
21	Henry L. Frashuer, et al
23	A.C. Thrash, et al
28	Nell R. Pierce, et al
40	Loxie V. McClung, et al
45	Edwin Gaston, et al
46	B.E. Williams, et al
51	Susan R. Hall, et al
50	Alda V. Hitt
52	W.D. Hitt, et al

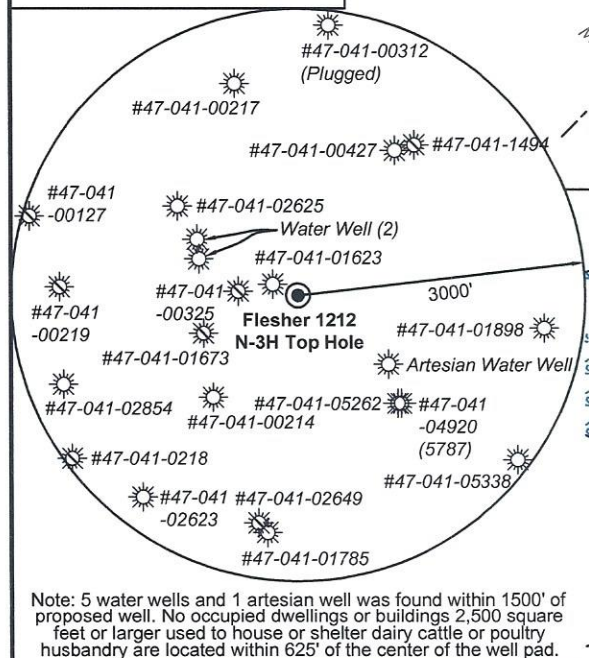

Note: 5 water wells and 1 artesian well was found within 1500' of proposed well. No occupied dwellings or buildings 2,500 square feet or larger used to house or shelter dairy cattle or poultry husbandry are located within 625' of the center of the well pad.

FILE NO: 156-36-12-U-F-19  
 DRAWING NO: Flesher 1212 N-3H As-Drilled  
 SCALE: 1" = 2000'  
 MINIMUM DEGREE OF ACCURACY: Submeter  
 PROVEN SOURCE OF ELEVATION: CORS, Bridgeport, WV

**STATE OF WEST VIRGINIA**  
 DEPARTMENT OF ENVIRONMENTAL PROTECTION  
**OIL AND GAS DIVISION**

DATE: January 19 2022  
 OPERATOR'S WELL NO. Flesher 1212 N-3H  
 API WELL NO  
 47 - 041 - 05712  
 STATE COUNTY PERMIT

WELL TYPE:  OIL  GAS  LIQUID INJECTION  WASTE DISPOSAL  
 (IF GAS) PRODUCTION:  STORAGE  DEEP  SHALLOW

LOCATION: ELEVATION: 1,332.2' WATERSHED: Middle West Fork Creek  
 DISTRICT: Freemans Creek  
 SURFACE OWNER: H.G. Energy II Appalachia, LLC  
 ROYALTY OWNER: W.D. Hitt, et al, et al LEASE NO: ACREAGE: 210.00

PROPOSED WORK:  DRILL  CONVERT  DRILL DEEPER  FRACTURE OR STIMULATE  PLUG OFF OLD FORMATION  
 PERFORATE NEW FORMATION  OTHER PHYSICAL CHANGE IN WELL (SPECIFY) As Drilled Plat 7,262' TVD  
 PLUG AND ABANDON  CLEAN OUT AND REPLUG TARGET FORMATION: Marcellus Shale ESTIMATED DEPTH: 24,283' MD

WELL OPERATOR: HG Energy II Appalachia, LLC  
 ADDRESS: 5260 Dupont Road Parkersburg, WV 26101

DESIGNATED AGENT: Diane C. White  
 ADDRESS: 5260 Dupont Road Parkersburg, WV 26101

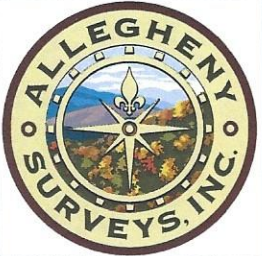

03/22/2024

Legend

- Proposed gas well
- Well Reference, as noted
- Monument, as noted
- Existing Well, as noted
- Digitized Well, as noted
- Creek or Drain
- Existing Road
- Surface boundary (approx.)
- Interior surface tracts (approx.)

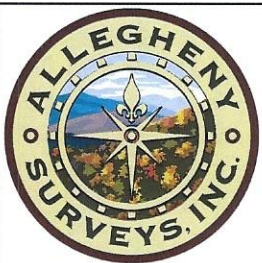

Notes: Well No. Flesher 1212 N-3H  
West Virginia Coordinate System of 1927, North Zone  
based upon Differential GPS Measurements.  
Top Hole coordinates Bottom Hole coordinates  
Latitude: 39°07'05.80" Latitude: 39°09'50.02"  
Longitude: 80°29'16.01" Longitude: 80°30'19.65"  
UTM Zone 17, NAD 1983  
Top Hole Coordinates Bottom Hole Coordinates  
N: 4,330,037.378m N: 4,335,090.888m  
E: 544,296.085m E: 542,740.246m  
Plat orientation and corner and well references are  
based upon the grid north meridian. Well location  
references are based upon the magnetic meridian.

Notes:  
Well No. Flesher 1212 N-3H  
UTM NAD 1983 (USSF)  
Top Hole Coordinates  
N: 14,206,130.97'  
E: 1,785,744.74'  
Landing Point Coordinates  
N: 14,206,507.25'  
E: 1,786,354.08'  
Bottom Hole Coordinates  
N: 14,222,710.69'  
E: 1,780,640.29'

Lewis Co. - Freeman Creek Dist.			
No.	TM / Par	Owner	Ac.
1	6C / 47	HG Energy II Appalachia, LLC	753 / 453 70.00
2	6C / 43	Gary Allen Sias	646 / 688 50.59
3	6C / 45	Fred A. Bailey	W25 / 263 48.00
4	6C / 48	Marlene Hovis	672 / 411 15.00
5	6C / 49	Marlene Hovis	672 / 411 12.90
6	6C / 51	Marlene Hovis	672 / 411 12.55
7	6C / 23	Richard G. & Loretta E. Hayhurst	566 / 357 34.80
8	6C / 60	Bryan Todd Beam	617 / 6 6.78
9	6C / 61	Mann Family Trust	617 / 608 49.91
10	6C / 61.1	Susanne Mann & Theodore William Lanouette	702 / 38 5.00
11	6C / 61.2	Susanne Mann & Theodore William Lanouette	721 / 189 1.08
12	6B / 30.2	Dickie E. & Ruth A. Radcliff	578 / 429 6.81
13	6B / 30.1	Theodore & Mary C. Eldridge	561 / 257 11.75
14	6B / 30	Theodore & Mary C. Eldridge	561 / 257 38.16
15	6B / 32	Mann Family Trust	617 / 608 23.00
16	6B / 33	Robert E. Brincefield, Jr. & Terri Lynne Trust, et al	578 / 630 50.05
17	6B / 34	Robert E. Brincefield, Jr. & Terri Lynne Trust, et al	578 / 630 34.78
18	6B / 35	Robert E. Brincefield, Jr. & Terri Lynne Trust, et al	578 / 630 21.75
19	6B / 36	Robert E. Brincefield, Jr. & Terri Lynne Trust, et al	578 / 630 28.00
20	6B / 24	Robert E. Brincefield, Jr. & Terri Lynne Trust, et al	578 / 630 11.15
21	6B / 25	Robert E. Brincefield, Jr. & Terri Lynne Trust, et al	578 / 630 45.00
22	6B / 37	Robert E. Brincefield, Jr. & Terri Lynne Trust, et al	578 / 630 96.14
23	6B / 37.1	Robert E. Brincefield, Jr. & Terri Lynne Trust, et al	570 / 720 11.72
24	6B / 23	Robert E. Brincefield, Jr. & Terri Lynne Trust, et al	578 / 630 21.75
25	6B / 22	Robert E. Brincefield, Jr. & Terri Lynne Trust, et al	578 / 630 99.46
26	6B / 21.1	Robert E. Brincefield, Jr. & Terri Lynne Trust, et al	578 / 630 44.00
27	6B / 21.3	Margarete E. Roles	W50 / 769 6.63
28	6B / 21.2	Mark D. & Betty Roles	557 / 627 25.47
Harrison Co. - Union-Outside Dist.			
No.	TM / Par	Owner	Ac.
29	443 / 8.2	Estella Breise	W197 / 1310 10.00
30	443 / 20	HG Energy II Appalachia, LLC	1614 / 1198 1.89
31	443 / 21	Mark D. Roles, et ux	1219 / 824 0.33
32	443 / 22	Marion G. Dougherty	1231 / 629 0.55
33	443 / 22.1	Debra Swick	W197 / 1310 30.61
34	443 / 8	Amanda Braimantyer	W197 / 1310 53.40
35	423 / 25	Terence L. Washburn	1117 / 553 16.00
36	423 / 24	Sherry Darlene Baldwin, et al	1531 / 944 15.00
37	423 / 23	Jeffrey & Anessa Griffith	1313 / 1245 25.10
38	423 / 13	Jeffrey & Anessa Griffith	1313 / 1245 45.10
39	423 / 14	Jeffrey & Anessa Griffith	1313 / 1245 13.98
40	423 / 12	Sherry Darlene Baldwin, et al	1531 / 944 65.39
41	423 / 11	William L. & Sandra L. Coffindaffer	1157 / 151 94.00

Wellhead Layout (NTS)

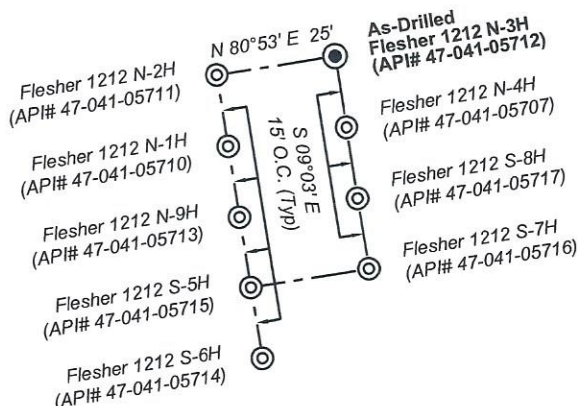

Detail 1 (Scale 1"=500')

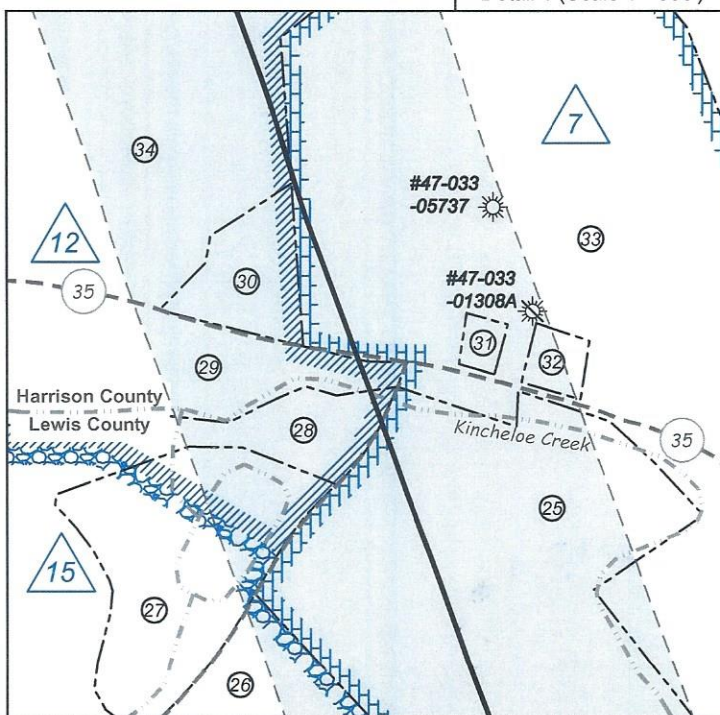

FILE NO: 156-36-12-U-F-19  
DRAWING NO: Flesher 1212 N-3H As-Drilled  
SCALE: 1" = 2000'  
MINIMUM DEGREE OF ACCURACY: Submeter  
PROVEN SOURCE OF ELEVATION: CORS, Bridgeport, WV

STATE OF WEST VIRGINIA  
DEPARTMENT OF ENVIRONMENTAL PROTECTION  
OIL AND GAS DIVISION



DATE: January 19 2022  
OPERATOR'S WELL NO. Flesher 1212 N-3H  
API WELL NO  
47 - 041 - 05712  
STATE COUNTY PERMIT

WELL TYPE:  OIL  GAS  LIQUID INJECTION  WASTE DISPOSAL  
(IF GAS) PRODUCTION:  STORAGE  DEEP  SHALLOW

LOCATION: ELEVATION: 1,332.2' WATERSHED: Middle West Fork Creek

Btm: Big Isaac  
QUADRANGLE: Top: Weston

DISTRICT: Freemans Creek

COUNTY: Lewis  
ACREAGE: 70.00

SURFACE OWNER: H.G. Energy II Appalachia, LLC

ROYALTY OWNER: W.D. Hiitt, et al, et al

LEASE NO: ACREAGE: 210.00

PROPOSED WORK:  DRILL  CONVERT  DRILL DEEPER  FRACTURE OR STIMULATE  PLUG OFF OLD FORMATION  
 PERFORATE NEW FORMATION  OTHER PHYSICAL CHANGE IN WELL (SPECIFY) As Drilled Plat 7,262' TVD

PLUG AND ABANDON  CLEAN OUT AND REPLUG TARGET FORMATION: Marcellus Shale ESTIMATED DEPTH: 24,283' MD

WELL OPERATOR: HG Energy II Appalachia, LLC

DESIGNATED AGENT: Diane C. White

ADDRESS: 5260 Dupont Road

ADDRESS: 5260 Dupont Road

Parkersburg, WV 26101

Parkersburg, WV 26101