

6,467' to Bottom Hole

8,346' to Top Hole

LATITUDE 39 - 07 - 30

LONGITUDE 80 - 27 - 30

2,492' to Top Hole

7,995' to Bottom Hole



I, the undersigned, hereby certify that this plat is correct to the best of my knowledge and belief and shows all the information required by law and the rules issued and prescribed by the Department of Environmental Protection.

Kevin S. James
Kevin S. James, P.S. 2305

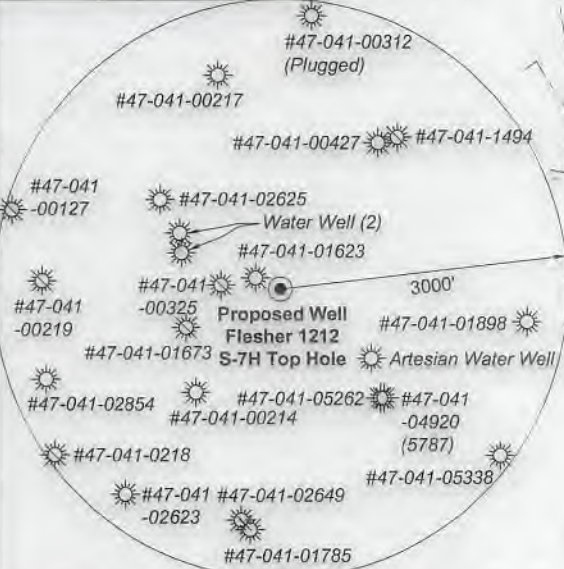

Note: 2 water wells and 1 artesian well was found within 1500' of proposed well. No occupied dwellings or buildings 2,500 square feet or larger used to house or shelter dairy cattle or poultry husbandry are located within 625' of the center of the well pad.

FILE NO: 156-36-12-U-F-19
DRAWING NO: Flesher 1212 S-7H Well Plat
SCALE: 1" = 2000'
MINIMUM DEGREE OF ACCURACY: Submeter
PROVEN SOURCE OF ELEVATION: CORS, Bridgeport, WV

STATE OF WEST VIRGINIA
DEPARTMENT OF ENVIRONMENTAL PROTECTION
OIL AND GAS DIVISION

DATE: December 2 2020
OPERATOR'S WELL NO. Flesher 1212 S-7H
API WELL NO. HGA
47 - 041 - 05716
STATE COUNTY PERMIT

WELL TYPE: OIL GAS LIQUID INJECTION WASTE DISPOSAL
(IF GAS) PRODUCTION: STORAGE DEEP SHALLOW

LOCATION: ELEVATION: 1,332.2' WATERSHED: Middle West Fork Creek QUADRANGLE: Btm: Big Isaac Top: Weston
DISTRICT: Freemans Creek COUNTY: Lewis
SURFACE OWNER: H.G. Energy II Appalachia, LLC ACREAGE: 70.00
ROYALTY OWNER: W.D. Hitt, et al, et al LEASE NO: ACREAGE: 210.00
PROPOSED WORK: DRILL CONVERT DRILL DEEPER FRACTURE OR STIMULATE PLUG OFF OLD FORMATION
 PERFORATE NEW FORMATION OTHER PHYSICAL CHANGE IN WELL (SPECIFY) 6,925' TVD
 PLUG AND ABANDON CLEAN OUT AND REPLUG TARGET FORMATION: Marcellus Shale ESTIMATED DEPTH: 12,645' MD

WELL OPERATOR: HG Energy II Appalachia, LLC DESIGNATED AGENT: Diane C. White
ADDRESS: 5260 Dupont Road ADDRESS: 5260 Dupont Road
Parkersburg, WV 26101 Parkersburg, WV 26101



Tag	Bearing	Dist.	Description
L1	N 42°43' W	1,513.6'	#47-041-05262
L2	N 24°51' E	664.5'	1/2" Rebar
L3	N 68°43' E	1,615.6'	1" Iron pipe
L4	S 53°14' E	1,583.7'	#47-041-02625
L5	S 16°27' E	518.2'	Landing point

ID	Lease
7	Pearle A. Norris, et al
12	C.L. Hitt, et al
13	Alda V. Hitt, et al
16	George Norris, et al
17	H.M. Stewart & C.J. Stewart
18	W.E. Carpenter, et al
26	W.D. Hitt, et al
28	Charles F. Bailey, et al

Lewis Co. - Freeman Creek Dist.				
No.	TM / Par	Owner	Bk / Pg	Ac.
1	6C / 47	HG Energy II Appalachia, LLC	753 / 453	70.00
2	6C / 45	Fred A. Bailey	W25 / 263	48.00
3	6C / 25.1	William Radtka & Helen Burton	655 / 681	5.85
4	6C / 43	Gary A. Sias	646 / 688	50.59
5	6C / 32.1	Fred A. Bailey	W25 / 263	92.89
6	6C / 42	Fred A. Bailey	W25 / 263	6.70
7	6C / 41	Larry R. & Gina F. Simon	702 / 865	19.11
8	6C / 40	Scott & Amy Carpenter	709 / 821	45.95
9	6C / 40.1	Jeffrey R. & Pamela J. Nicholson	713 / 40	5.50
10	7C / 16	Mary Jane Bailey Trust	W49 / 571	130.50
11	6C / 39	Phyllis L. & Dolores A. Hinterer	591 / 653	23.00
12	6D / 42	Michael & Kelly M. Goodwin	682 / 485	15.98
13	6D / 43	Deborah D. Hunt	W24 / 544	17.50

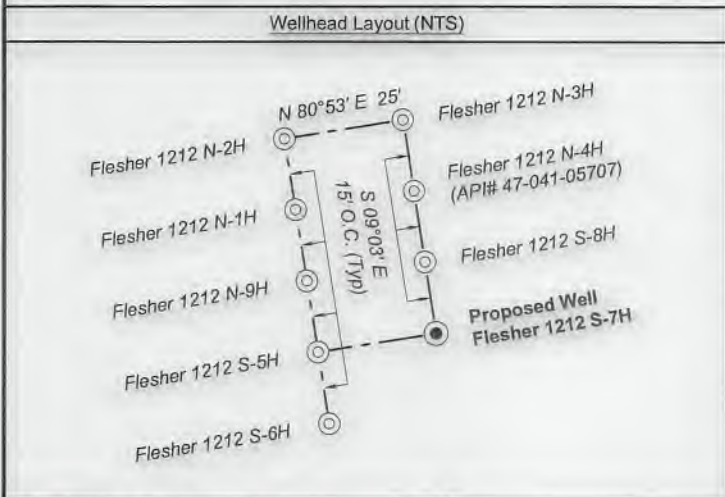
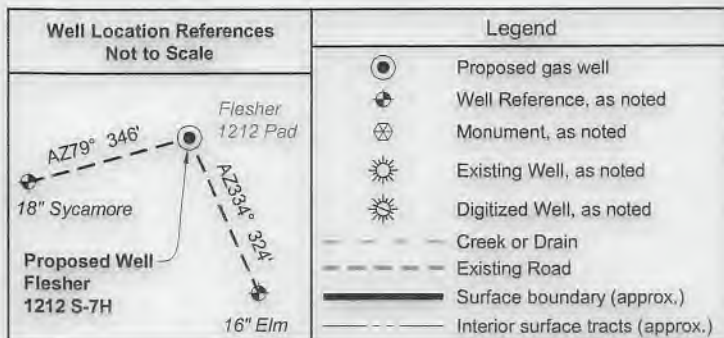

Notes: Well No. Flesher 1212 S-7H
West Virginia Coordinate System of 1927, North Zone based upon Differential GPS Measurements.

Top Hole coordinates	Bottom Hole coordinates
Latitude: 39°07'05.36"	Latitude: 39°06'10.96"
Longitude: 80°29'15.92"	Longitude: 80°28'52.060"
UTM Zone 17, NAD 1983	
Top Hole Coordinates	Bottom Hole Coordinates
N: 4,330,023.840m	N: 4,328,350.040m
E: 544,298.245m	E: 544,880.893m

Plat orientation and corner and well references are based upon the grid north meridian. Well location references are based upon the magnetic meridian.

Notes: Well No. Flesher 1212 S-7H
UTM NAD 1983 (USSF)

Top Hole Coordinates	Bottom Hole coordinates
N: 14,206,086.55'	N: 14,205,589.56'
E: 1,785,751.82'	E: 1,785,898.54'
Landing Point Coordinates	Bottom Hole Coordinates
N: 14,205,589.56'	N: 14,200,595.09'
E: 1,785,898.54'	E: 1,787,663.39'

FILE NO: 156-36-12-U-F-19
DRAWING NO: Flesher 1212 S-7H Well Plat
SCALE: 1" = 2000'
MINIMUM DEGREE OF ACCURACY: Submeter
PROVEN SOURCE OF ELEVATION: CORS, Bridgeport, WV

STATE OF WEST VIRGINIA
DEPARTMENT OF ENVIRONMENTAL PROTECTION
OIL AND GAS DIVISION

DATE: December 2 2020
OPERATOR'S WELL NO. Flesher 1212 S-7H
API WELL NO. **46A**
47 - 041 - **05714**
STATE COUNTY PERMIT

WELL TYPE: OIL GAS LIQUID INJECTION WASTE DISPOSAL
(IF GAS) PRODUCTION: STORAGE DEEP SHALLOW

LOCATION: ELEVATION: 1,332.2' WATERSHED: Middle West Fork Creek
DISTRICT: Freemans Creek
SURFACE OWNER: H.G. Energy II Appalachia, LLC
ROYALTY OWNER: W.D. Hitt, et al, et al LEASE NO: ACREAGE: 210.00

PROPOSED WORK: DRILL CONVERT DRILL DEEPER FRACTURE OR STIMULATE PLUG OFF OLD FORMATION
 PERFORATE NEW FORMATION OTHER PHYSICAL CHANGE IN WELL (SPECIFY) _____ 6,925' TVD
 PLUG AND ABANDON CLEAN OUT AND REPLUG TARGET FORMATION: Marcellus Shale ESTIMATED DEPTH: 12,645' MD

WELL OPERATOR: HG Energy II Appalachia, LLC DESIGNATED AGENT: Diane C. White
ADDRESS: 5260 Dupont Road ADDRESS: 5260 Dupont Road
Parkersburg, WV 26101 Parkersburg, WV 26101



Tag	Bearing	Dist.	Description
L1	N 42°43' W	1,513.6'	#47-041-05262
L2	N 24°51' E	664.5'	1/2" Rebar
L3	N 68°43' E	1,615.6'	1" Iron pipe
L4	S 53°14' E	1,583.7'	#47-041-02625
L5	S 16°27' E	518.2'	Landing point

ID	Lease
7	Pearle A. Norris, et al
12	C.L. Hitt, et al
13	Alda V. Hitt, et al
16	George Norris, et al
17	H.M. Stewart & C.J. Stewart
18	W.E. Carpenter, et al
26	W.D. Hitt, et al
28	Charles F. Bailey, et al

RECEIVED
Office of Oil and Gas

DEC 28 2020

WV Department of
Environmental Protection

Lewis Co. - Freeman Creek Dist.				
No.	TM / Par	Owner	Bk / Pg	Ac.
1	6C / 47	HG Energy II Appalachia, LLC	753 / 453	70.00
2	6C / 45	Fred A. Bailey	W25 / 263	48.00
3	6C / 25.1	William Radtka & Helen Burton	655 / 681	5.85
4	6C / 43	Gary A. Sias	646 / 688	50.59
5	6C / 32.1	Fred A. Bailey	W25 / 263	92.89
6	6C / 42	Fred A. Bailey	W25 / 263	6.70
7	6C / 41	Larry R. & Gina F. Simon	702 / 865	19.11
8	6C / 40	Scott & Amy Carpenter	709 / 821	45.95
9	6C / 40.1	Jeffrey R. & Pamela J. Nicholson	713 / 40	5.50
10	7C / 16	Mary Jane Bailey Trust	W49 / 571	130.50
11	6C / 39	Phyllis L. & Dolores A. Hinterer	591 / 653	23.00
12	6D / 42	Michael & Kelly M. Goodwin	682 / 485	15.98
13	6D / 43	Deborah D. Hunt	W24 / 544	17.50

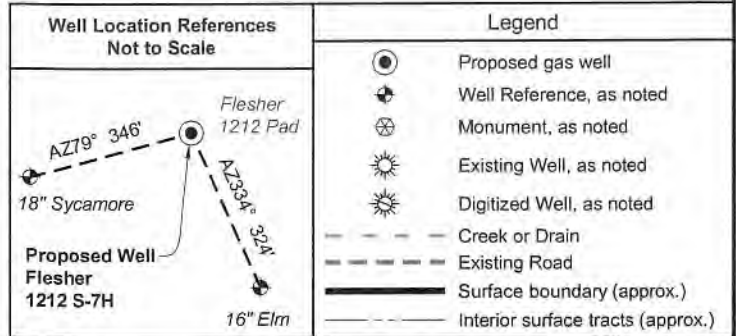

Legend	
	Proposed gas well
	Well Reference, as noted
	Monument, as noted
	Existing Well, as noted
	Digitized Well, as noted
	Creek or Drain
	Existing Road
	Surface boundary (approx.)
	Interior surface tracts (approx.)

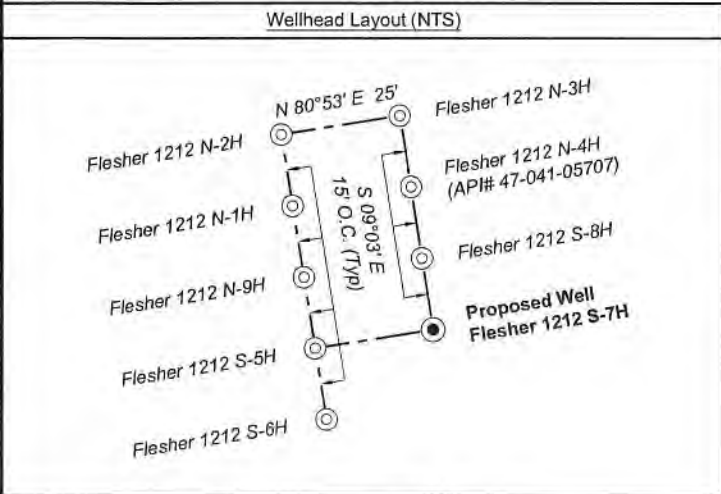

Notes: Well No. Flesher 1212 S-7H
West Virginia Coordinate System of 1927, North Zone
based upon Differential GPS Measurements.
Top Hole coordinates Bottom Hole coordinates
Latitude: 39°07'05.36" Latitude: 39°06'10.96"
Longitude: 80°29'15.92" Longitude: 80°28'52.060"
UTM Zone 17, NAD 1983
Top Hole Coordinates Bottom Hole Coordinates
N: 4,330,023.840m N: 4,328,350.040m
E: 544,298.245m E: 544,880.893m
Plate orientation and corner and well references are
based upon the grid north meridian. Well location
references are based upon the magnetic meridian.

Notes:
Well No. Flesher 1212 S-7H
UTM NAD 1983 (USSF)
Top Hole Coordinates
N: 14,206,086.55'
E: 1,785,751.82'
Landing Point Coordinates
N: 14,205,589.56'
E: 1,785,898.54'
Bottom Hole Coordinates
N: 14,200,595.09'
E: 1,787,663.39'

FILE NO: 156-36-12-U-F-19
DRAWING NO: Flesher 1212 S-7H Well Plat
SCALE: 1" = 2000'
MINIMUM DEGREE OF ACCURACY:
Submeter
PROVEN SOURCE OF ELEVATION:
CORS, Bridgeport, WV

STATE OF WEST VIRGINIA
DEPARTMENT OF ENVIRONMENTAL PROTECTION
OIL AND GAS DIVISION

DATE: December 2 2020
OPERATOR'S WELL NO. Flesher 1212 S-7H
API WELL NO 44A
47 - 041 - 05716
STATE COUNTY PERMIT

WELL TYPE: OIL GAS LIQUID INJECTION WASTE DISPOSAL
(IF GAS) PRODUCTION: STORAGE DEEP SHALLOW
LOCATION: ELEVATION: 1,332.2' WATERSHED: Middle West Fork Creek
DISTRICT: Freemans Creek
SURFACE OWNER: H.G. Energy II Appalachia, LLC
ROYALTY OWNER: W.D. Hitt, et al, et al LEASE NO: ACREAGE: 210.00
PROPOSED WORK: DRILL CONVERT DRILL DEEPER FRACTURE OR STIMULATE PLUG OFF OLD FORMATION
 PERFORATE NEW FORMATION OTHER PHYSICAL CHANGE IN WELL (SPECIFY) _____ 6.925' TVD
 PLUG AND ABANDON CLEAN OUT AND REPLUG TARGET FORMATION: Marcellus Shale ESTIMATED DEPTH: 12,645' MD

WELL OPERATOR: HG Energy II Appalachia, LLC DESIGNATED AGENT: Diane C. White
ADDRESS: 5260 Dupont Road ADDRESS: 5260 Dupont Road
Parkersburg, WV 26101 Parkersburg, WV 26101

HG Energy II Appalachia, LLC
Well No. Flesher 1212 S-7H

Page 1 of 2

6,467' to Bottom Hole

8,346' to Top Hole

LATITUDE 39 - 07 - 30

LONGITUDE 80 - 27 - 30

RECEIVED
Office of Oil and Gas
DEC 28 2020

WV Department of
Environmental Protection

2,492' to Top Hole

7,995' to Bottom Hole



I, the undersigned, hereby certify that this plat is correct to the best of my knowledge and belief and shows all the information required by law and the rules issued and prescribed by the Department of Environmental Protection.

Kevin S. James
Kevin S. James, P.S. 2305

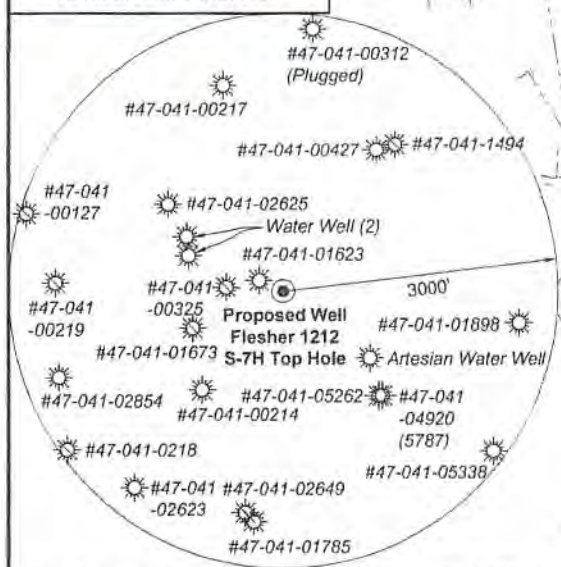

Note: 2 water wells and 1 artesian well was found within 1500' of proposed well. No occupied dwellings or buildings 2,500 square feet or larger used to house or shelter dairy cattle or poultry husbandry are located within 625' of the center of the well pad.

FILE NO: 156-36-12-U-F-19
DRAWING NO: Flesher 1212 S-7H Well Plat
SCALE: 1" = 2000'
MINIMUM DEGREE OF ACCURACY: Submeter
PROVEN SOURCE OF ELEVATION: CORS, Bridgeport, WV

STATE OF WEST VIRGINIA
DEPARTMENT OF ENVIRONMENTAL PROTECTION
OIL AND GAS DIVISION

DATE: December 2 2020
OPERATOR'S WELL NO. Flesher 1212 S-7H
API WELL NO. **467**
47 - 041 - **05716**
STATE COUNTY PERMIT

WELL TYPE: OIL GAS LIQUID INJECTION WASTE DISPOSAL
(IF GAS) PRODUCTION: STORAGE DEEP SHALLOW

LOCATION: ELEVATION: 1,332.2' WATERSHED: Middle West Fork Creek
DISTRICT: Freemans Creek
SURFACE OWNER: H.G. Energy II Appalachia, LLC
ROYALTY OWNER: W.D. Hitt, et al, et al LEASE NO: _____ ACREAGE: 210.00

PROPOSED WORK: DRILL CONVERT DRILL DEEPER FRACTURE OR STIMULATE PLUG OFF OLD FORMATION
 PERFORATE NEW FORMATION OTHER PHYSICAL CHANGE IN WELL (SPECIFY) _____

PLUG AND ABANDON CLEAN OUT AND REPLUG TARGET FORMATION: Marcellus Shale ESTIMATED DEPTH: 12,645' MD 6,925' TVD

WELL OPERATOR: HG Energy II Appalachia, LLC DESIGNATED AGENT: Diane C. White
ADDRESS: 5260 Dupont Road ADDRESS: 5260 Dupont Road
Parkersburg, WV 26101 Parkersburg, WV 26101



RECEIVED
Office of Oil and Gas

DEC 28 2020

WV Department of
Environmental Protection

Tag	Bearing	Dist.	Description
L1	N 42°43' W	1,513.6'	#47-041-05262
L2	N 24°51' E	664.5'	1/2" Rebar
L3	N 68°43' E	1,615.6'	1" Iron pipe
L4	S 53°14' E	1,583.7'	#47-041-02625
L5	S 16°27' E	518.2'	Landing point

ID	Lease
7	Pearle A. Norris, et al
12	C.L. Hitt, et al
13	Alda V. Hitt, et al
16	George Norris, et al
17	H.M. Stewart & C.J. Stewart
18	W.E. Carpenter, et al
26	W.D. Hitt, et al
28	Charles F. Bailey, et al

Lewis Co. - Freeman Creek Dist.				
No.	TM / Par	Owner	Bk / Pg	Ac.
1	6C / 47	HG Energy II Appalachia, LLC	753 / 453	70.00
2	6C / 45	Fred A. Bailey	W25 / 263	48.00
3	6C / 25.1	William Radtka & Helen Burton	655 / 681	5.85
4	6C / 43	Gary A. Sias	646 / 688	50.59
5	6C / 32.1	Fred A. Bailey	W25 / 263	92.89
6	6C / 42	Fred A. Bailey	W25 / 263	6.70
7	6C / 41	Larry R. & Gina F. Simon	702 / 865	19.11
8	6C / 40	Scott & Amy Carpenter	709 / 821	45.95
9	6C / 40.1	Jeffrey R. & Pamela J. Nicholson	713 / 40	5.50
10	7C / 16	Mary Jane Bailey Trust	W49 / 571	130.50
11	6C / 39	Phyllis L. & Dolores A. Hinterer	591 / 653	23.00
12	6D / 42	Michael & Kelly M. Goodwin	682 / 485	15.98
13	6D / 43	Deborah D. Hunt	W24 / 544	17.50

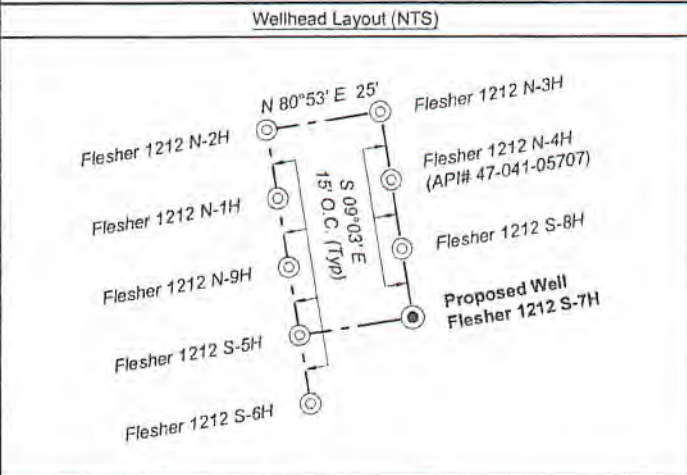
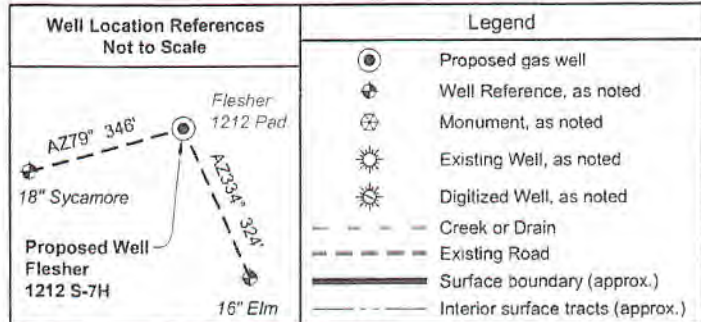

Notes: Well No. Flesher 1212 S-7H	Notes: Well No. Flesher 1212 S-7H
West Virginia Coordinate System of 1927, North Zone based upon Differential GPS Measurements.	UTM NAD 1983 (USSF)
Top Hole coordinates Latitude: 39°07'05.36" Longitude: 80°29'15.92"	Top Hole Coordinates N: 14,206,086.55' E: 1,785,751.82'
Bottom Hole coordinates Latitude: 39°06'10.96" Longitude: 80°28'52.060"	Landing Point Coordinates N: 14,205,589.56' E: 1,785,898.54'
UTM Zone 17, NAD 1983	Bottom Hole Coordinates N: 14,200,595.09' E: 1,787,663.39'
Top Hole Coordinates N: 4,330,023.840m E: 544,298.245m	
Bottom Hole Coordinates N: 4,328,350.040m E: 544,880.893m	
Plat orientation and corner and well references are based upon the grid north meridian. Well location references are based upon the magnetic meridian.	

FILE NO: 156-36-12-U-F-19
DRAWING NO: Flesher 1212 S-7H Well Plat
SCALE: 1" = 2000'
MINIMUM DEGREE OF ACCURACY: Submeter
PROVEN SOURCE OF ELEVATION: CORS, Bridgeport, WV

STATE OF WEST VIRGINIA
DEPARTMENT OF ENVIRONMENTAL PROTECTION
OIL AND GAS DIVISION

DATE: December 2 2020
OPERATOR'S WELL NO. Flesher 1212 S-7H
API WELL NO. H6A
47 - 041 - 05716
STATE COUNTY PERMIT

WELL TYPE: OIL GAS LIQUID INJECTION WASTE DISPOSAL
(IF GAS) PRODUCTION: STORAGE DEEP SHALLOW

LOCATION: ELEVATION: 1,332.2' WATERSHED: Middle West Fork Creek
DISTRICT: Freemans Creek
SURFACE OWNER: H.G. Energy II Appalachia, LLC
ROYALTY OWNER: W.D. Hitt, et al, et al LEASE NO: _____ ACREAGE: 210.00

PROPOSED WORK: DRILL CONVERT DRILL DEEPER FRACTURE OR STIMULATE PLUG OFF OLD FORMATION
 PERFORATE NEW FORMATION OTHER PHYSICAL CHANGE IN WELL (SPECIFY) _____ 6,925' TVD
 PLUG AND ABANDON CLEAN OUT AND REPLUG TARGET FORMATION: Marcellus Shale ESTIMATED DEPTH: 12,645' MD

WELL OPERATOR: HG Energy II Appalachia, LLC DESIGNATED AGENT: Diane C. White
ADDRESS: 5260 Dupont Road ADDRESS: 5260 Dupont Road
Parkersburg, WV 26101 Parkersburg, WV 26101



I, the undersigned, hereby certify that this plat is correct to the best of my knowledge and belief and shows all the information required by law and the rules issued and prescribed by the Department of Environmental Protection.

Kevin S. James
Kevin S. James, P.S. 2305

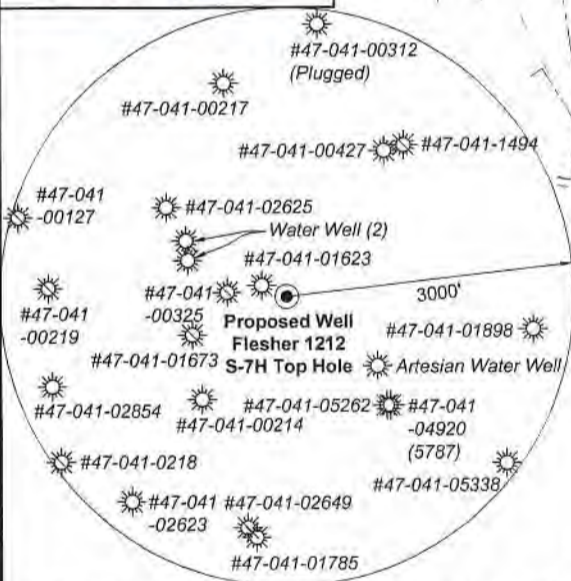

Note: 2 water wells and 1 artesian well was found within 1500' of proposed well. No occupied dwellings or buildings 2,500 square feet or larger used to house or shelter dairy cattle or poultry husbandry are located within 625' of the center of the well pad.

FILE NO: 156-36-12-U-F-19
DRAWING NO: Flesher 1212 S-7H Well Plat
SCALE: 1" = 2000'
MINIMUM DEGREE OF ACCURACY: Submeter
PROVEN SOURCE OF ELEVATION: CORS, Bridgeport, WV

STATE OF WEST VIRGINIA
DEPARTMENT OF ENVIRONMENTAL PROTECTION
OIL AND GAS DIVISION

DATE: December 2 2020
OPERATOR'S WELL NO. Flesher 1212 S-7H
API WELL NO HGA
47 - 041 - 05716
STATE COUNTY PERMIT

WELL TYPE: OIL GAS LIQUID INJECTION WASTE DISPOSAL
(IF GAS) PRODUCTION: STORAGE DEEP SHALLOW

LOCATION: ELEVATION: 1,332.2' WATERSHED: Middle West Fork Creek QUADRANGLE: Btm: Big Isaac
DISTRICT: Freemans Creek Top: Weston
SURFACE OWNER: H.G. Energy II Appalachia, LLC COUNTY: Lewis
ROYALTY OWNER: W.D. Hitt, et al, et al LEASE NO: ACREAGE: 70.00
PROPOSED WORK: DRILL CONVERT DRILL DEEPER FRACTURE OR STIMULATE PLUG OFF OLD FORMATION
 PERFORATE NEW FORMATION OTHER PHYSICAL CHANGE IN WELL (SPECIFY) 6,925' TVD
 PLUG AND ABANDON CLEAN OUT AND REPLUG TARGET FORMATION: Marcellus Shale ESTIMATED DEPTH: 12,645' MD

WELL OPERATOR: HG Energy II Appalachia, LLC DESIGNATED AGENT: Diane C. White
ADDRESS: 5260 Dupont Road ADDRESS: 5260 Dupont Road
Parkersburg, WV 26101 Parkersburg, WV 26101

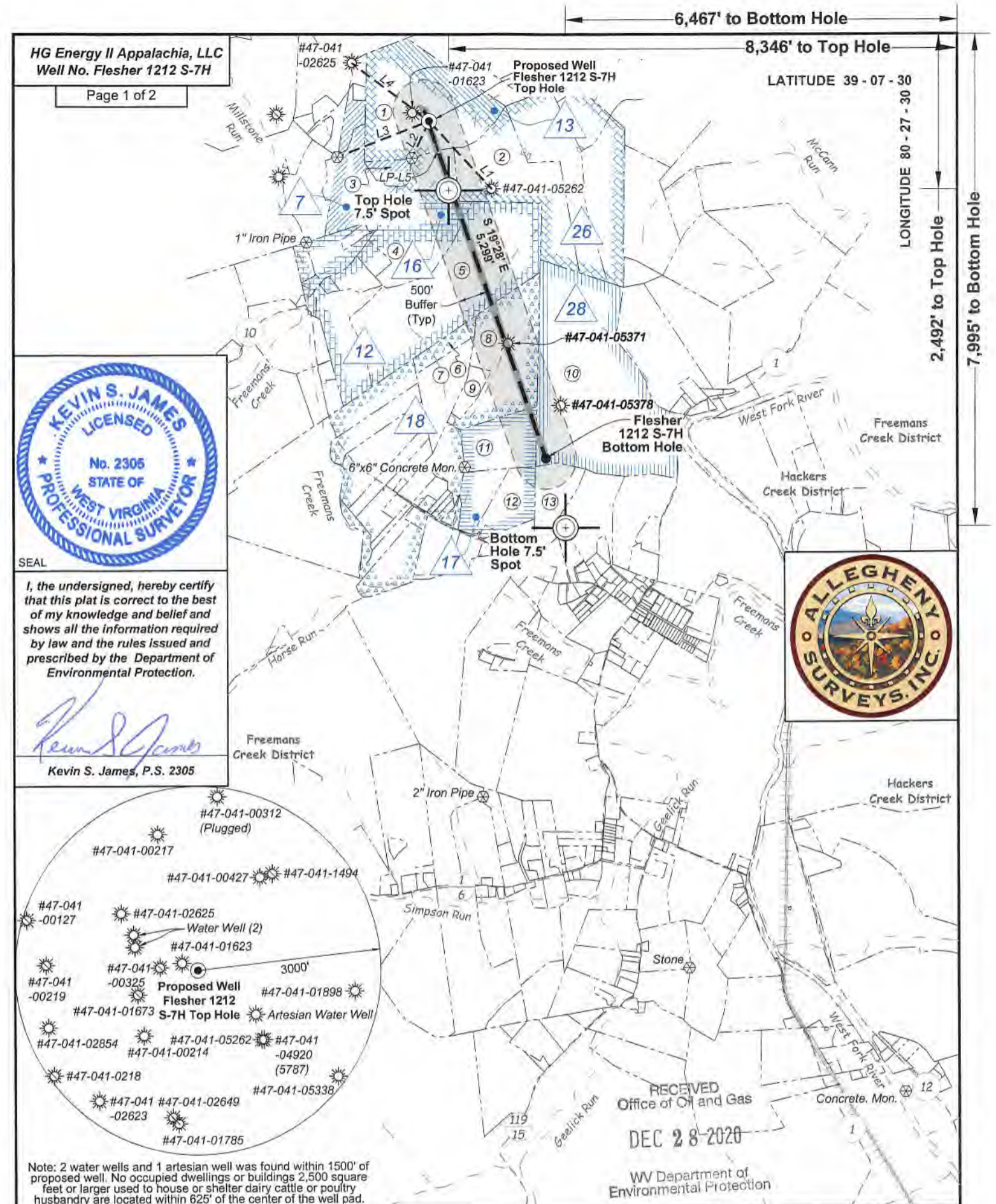

RECEIVED
Office of Oil and Gas
DEC 28 2020
WV Department of Environmental Protection

SUBJECT WELL
Flesher 1212 S-7H

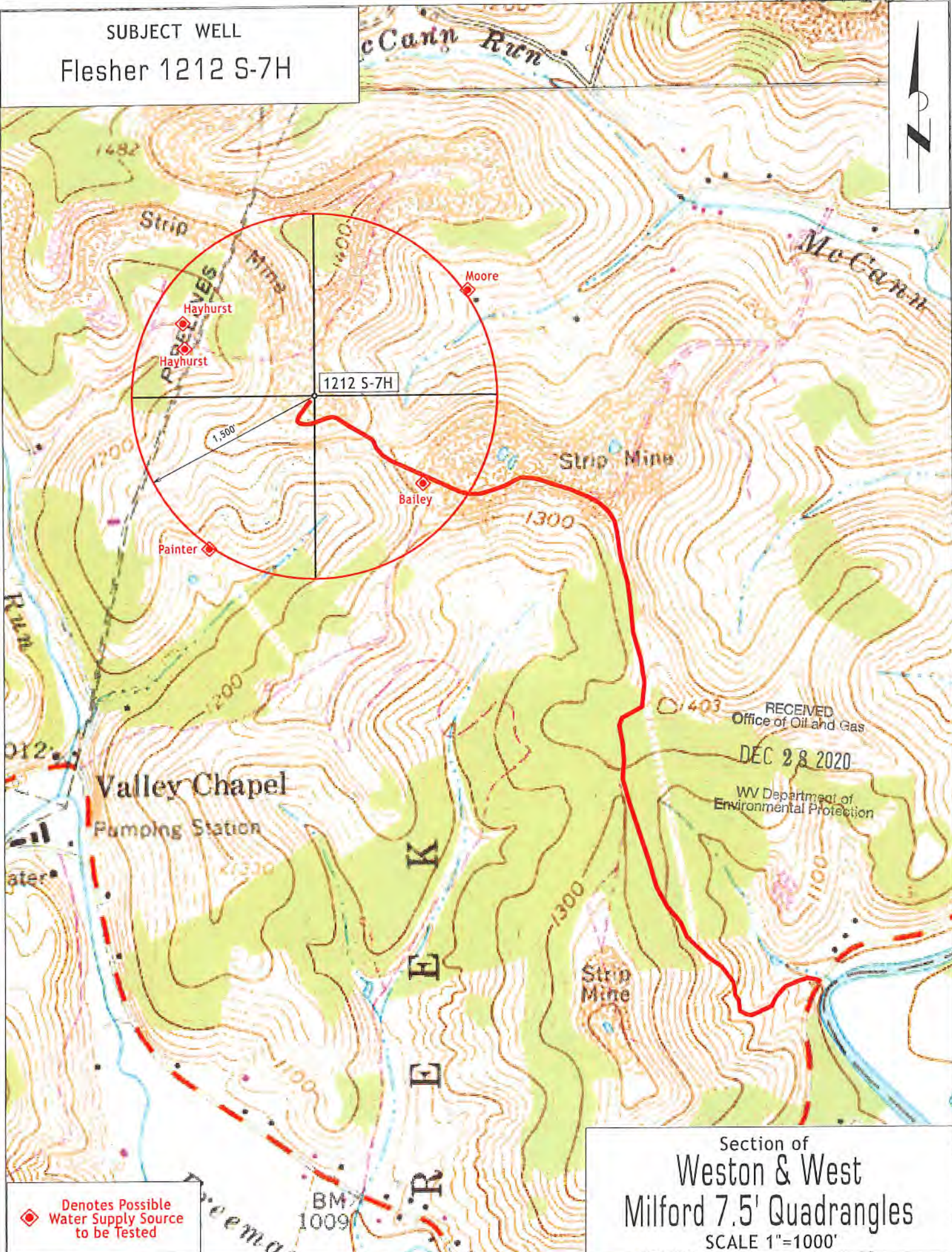

1212 S-7H

RECEIVED
Office of Oil and Gas
DEC 28 2020
WV Department of
Environmental Protection

◆ Denotes Possible
Water Supply Source
to be Tested

Section of
Weston & West
Milford 7.5' Quadrangles
SCALE 1"=1000'