

7,942' to Top Hole

4,047' to Bottom Hole

TOP LATITUDE 39 - 07 - 30  
BTM LATITUDE 39 - 12 - 30

TOP HOLE LONGITUDE 80 - 32 - 30  
BTM HOLE LONGITUDE 80 - 35 - 00

6,318' to Top Hole

13,334' to Bottom Hole

Page 2  
MATCH LINE

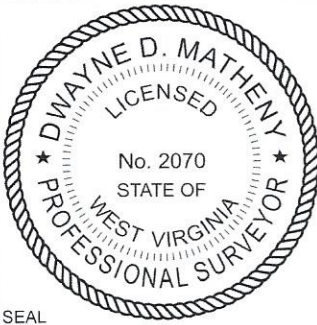

I, the undersigned, hereby certify that this plat is correct to the best of my knowledge and belief and shows all the information required by law and the rules issued and prescribed by the Department of Environmental Protection.

*Dwayne D. Matheny*  
Dwayne D. Matheny, P.S. 2070

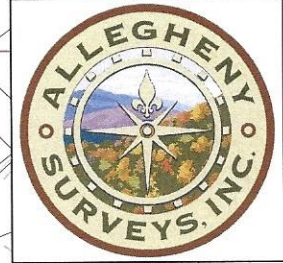

RECEIVED  
Office of Oil and Gas  
MAR 18 2024  
WV Department of Environmental Protection

Tag	Bearing	Dist.	Monument
L1	S 87°58' W	1,939.2'	1" Pipe
L2	N 44°39' W	3,079.4'	1" Pipe
L3	S 82°58' E	677.6'	47-041-04554
L4	S 42°56' E	975.3'	47-041-03099
L5	N 04°10' E	448.2'	Landing Point

Note: 0 water wells, 1 cistern and 1 pond were found within 1500' of proposed well. No occupied dwellings or buildings 2,500 square feet or larger used to house or shelter dairy cattle or poultry husbandry are located within 625' of the center of the well pad.

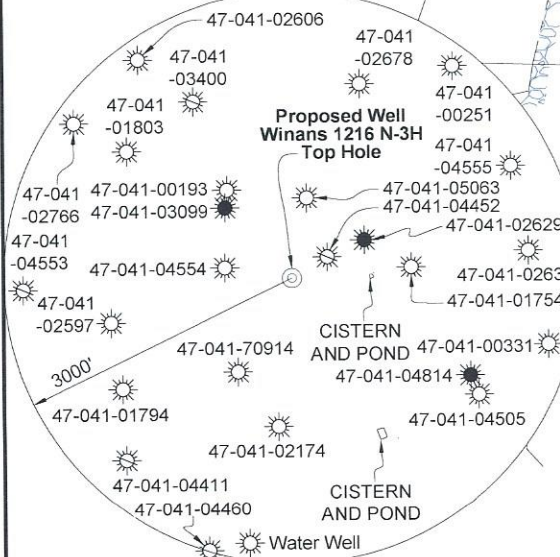

FILE NO: 43-12-FC-21  
DRAWING NO: Winans 1216 N-3H Well Plat  
SCALE: 1" = 2000'  
MINIMUM DEGREE OF ACCURACY: Submeter  
PROVEN SOURCE OF ELEVATION: CORS, Bridgeport, WV

**STATE OF WEST VIRGINIA**  
DEPARTMENT OF ENVIRONMENTAL PROTECTION  
**OIL AND GAS DIVISION**

DATE: January 24 2024  
OPERATOR'S WELL NO. Winans 1216 N-3H  
API WELL NO  
47 - 041 - 05747  
STATE COUNTY PERMIT

WELL TYPE:  OIL  GAS  LIQUID INJECTION  WASTE DISPOSAL  
(IF GAS) PRODUCTION:  STORAGE  DEEP  SHALLOW

LOCATION: ELEVATION: 1,394' WATERSHED: Fink Creek QUADRANGLE: Top: Camden Btm: Big Isaac  
DISTRICT: Freemans Creek COUNTY: Lewis  
SURFACE OWNER: Stephen B. Winans ACREAGE: 45.00  
ROYALTY OWNER: Elaina D. Yanceris, et al, et al LEASE NO: ACREAGE: 123

PROPOSED WORK:  DRILL  CONVERT  DRILL DEEPER  FRACTURE OR STIMULATE  PLUG OFF OLD FORMATION  
 PERFORATE NEW FORMATION  OTHER PHYSICAL CHANGE IN WELL (SPECIFY) Bottom Hole MOD 7,175' TVD  
 PLUG AND ABANDON  CLEAN OUT AND REPLUG TARGET FORMATION: Marcellus Shale ESTIMATED DEPTH: 32,061' MD

WELL OPERATOR: HG Energy II Appalachia, LLC DESIGNATED AGENT: Diane C. White  
ADDRESS: 5260 Dupont Road ADDRESS: 5260 Dupont Road  
Parkersburg, WV 26101 Parkersburg, WV 26101

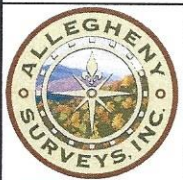

RECEIVED  
Office of Oil and Gas

MAR 18 2024

WV Department of  
Environmental Protection

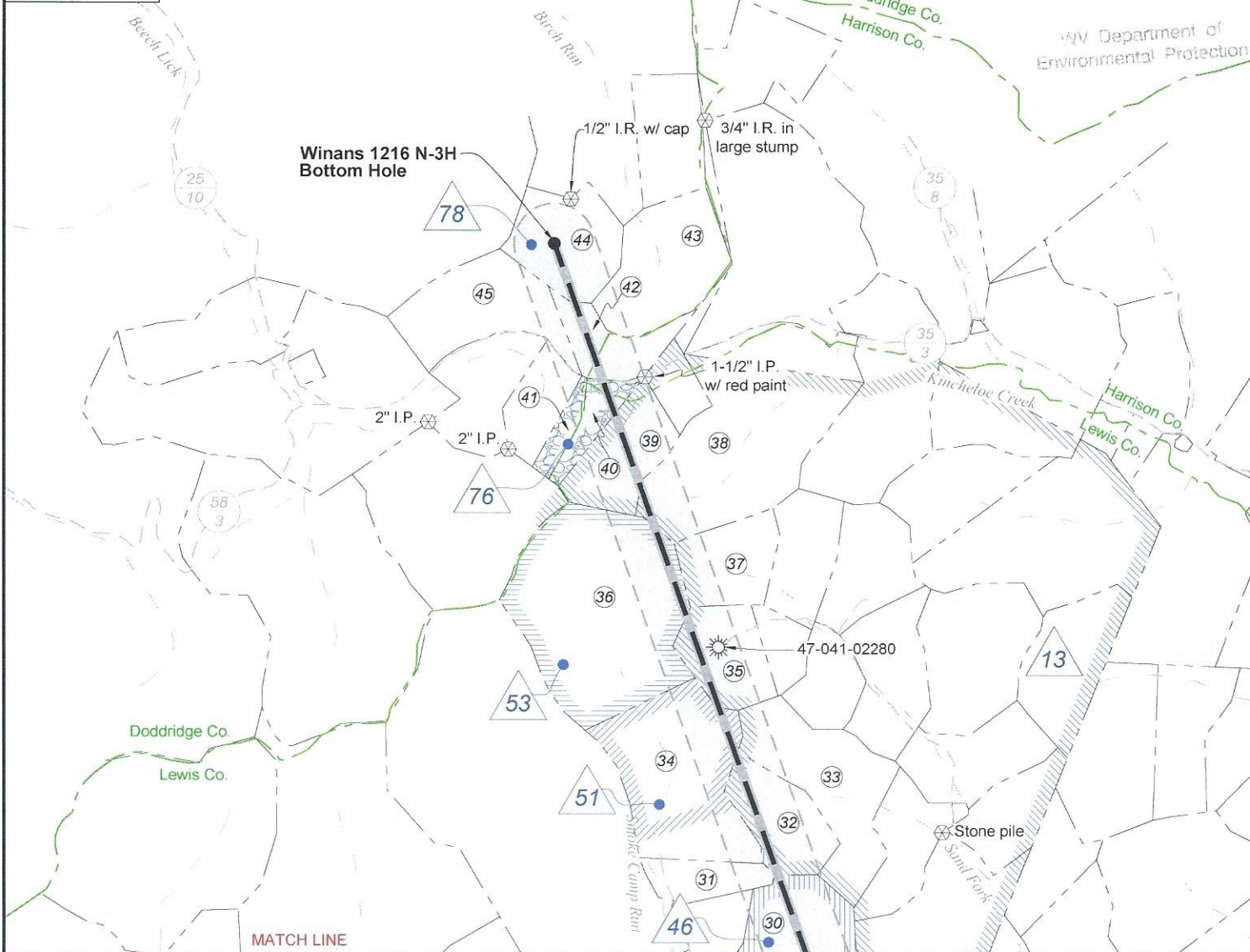

MATCH LINE

Page 1

Wellhead Layout (NTS)

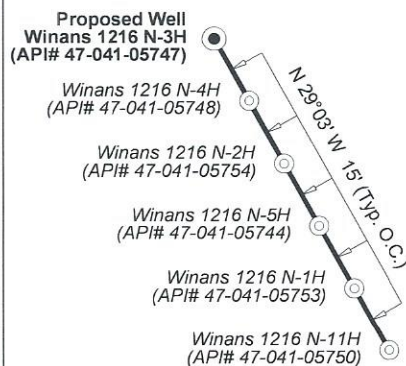

Notes: Well No.  
Winans 1216 N-3H  
UTM NAD 1983 (USSF)  
Top Hole Coordinates  
N: 14,202,140.01'  
E: 1,762,538.92'  
Landing Point Coordinates  
N: 14,202,587.05'  
E: 1,762,571.44'  
Bottom Hole Coordinates  
N: 14,225,427.48'  
E: 1,754,506.97'

Notes: Well No. Winans 1216 N-3H  
West Virginia Coordinate System of 1927, North Zone  
based upon Differential GPS Measurements.  
Top Hole coordinates Bottom Hole coordinates  
Latitude: 39°06'27.54" Latitude: 39°10'18.16"  
Longitude: 80°34'10.79" Longitude: 80°35'51.40"  
UTM Zone 17, NAD 1983  
Top Hole Coordinates Bottom Hole Coordinates  
N: 4,328,820.933m N: 4,335,918.968m  
E: 537,222.937m E: 534,774.794m  
Plat orientation and corner and well references are  
based upon the grid north meridian. Well location  
references are based upon the magnetic meridian.

Well Location References  
Not to Scale



FILE NO: 43-12-FC-21  
DRAWING NO: Winans 1216 N-3H Well Plat  
SCALE: 1" = 2000'  
MINIMUM DEGREE OF ACCURACY:  
Submeter  
PROVEN SOURCE OF ELEVATION:  
CORS, Bridgeport, WV

STATE OF WEST VIRGINIA  
DEPARTMENT OF ENVIRONMENTAL PROTECTION  
OIL AND GAS DIVISION

DATE: January 24 2024  
OPERATOR'S WELL NO. Winans 1216 N-3H  
API WELL NO  
47 - 041 - 05747  
STATE COUNTY PERMIT

WELL TYPE:  OIL  GAS  LIQUID INJECTION  WASTE DISPOSAL  
(IF GAS) PRODUCTION:  STORAGE  DEEP  SHALLOW

LOCATION: ELEVATION: 1,394' WATERSHED: Fink Creek

QUADRANGLE: Top: Camden  
Btm: Big Isaac

DISTRICT: Freemans Creek

COUNTY: Lewis  
ACREAGE: 45.00

SURFACE OWNER: Stephen B. Winans

ROYALTY OWNER: Elaina D. Yanceris, et al, et al

LEASE NO: ACREAGE: 123

PROPOSED WORK:  DRILL  CONVERT  DRILL DEEPER  FRACTURE OR STIMULATE  PLUG OFF OLD FORMATION  
 PERFORATE NEW FORMATION  OTHER PHYSICAL CHANGE IN WELL (SPECIFY) Bottom Hole MOD

PLUG AND ABANDON  CLEAN OUT AND REPLUG TARGET FORMATION: Marcellus Shale ESTIMATED DEPTH: 7,175' TVD  
32,061' MD

WELL OPERATOR: HG Energy II Appalachia, LLC

DESIGNATED AGENT: Diane C. White

ADDRESS: 5260 Dupont Road

ADDRESS: 5260 Dupont Road

Parkersburg, WV 26101

Parkersburg, WV 26101



RECEIVED  
Office of Oil and Gas

MAR 18 2024

WV Department of  
Environmental Protection

Legend

- Proposed gas well
- Well Reference, as noted
- Monument, as noted
- Existing Well, as noted
- Existing Plugged Well, as noted
- Digitized Well, as noted
- Creek or Drain
- Existing Road
- Surface boundary (approx.)

ID	Lease
3	Minor J. Hall, et ux
5	Lee Woofter
6	I.E. Waggoner, et ux
8	Alexander Brown, et ux
9	J.A. Riffée, et ux, et al
10	Mary J. McConkey, et vir, et al
13	W. Brent Maxwell, et al
34	J.P. Hull
35	W.J. Woofter, et ux
36	Charles Woofter, et ux
37	J.L. Straley
40	T.L. Straley, et ux, et al
41	Frances E. Straley, et al
44	Will E. Morris, et ux, et al
46	C.M. Garrett, et ux
51	L.G. Garrett
53	HG Energy, LLC, et al
61	William & Mary Winans
62	Boyd Gum, et ux
76	Jennifer Diane Stauch, et al
78	Teresa Gale (Freeman) Oakes, et al

Lewis Co. (Freemans Creek Dist.)				
No.	TM / Par	Owner	Bk / Pg	Ac.
1	4C / 21	Stephen B. Winans	630 / 50	45.00
2	4C / 22	Robert & Brenda McKinley	777 / 635	74.00
3	4C / 31	Gerald P. Hull	W18 / 661	199.25
4	4C / 30.1	Faye Isabella	654 / 202	36.88
5	4C / 23	Jason E. & Amy L. Hunt	627 / 224	76.25
6	4C / 10	Ricky Barnes, et al	598 / 747	294.98
7	4C / 15	Steven C. & Elizabeth A. Holden	512 / 270	90.25
8	4C / 25.2	Clara M. Sweeney, et al	573 / 424	0.04
9	4C / 25.3	Christopher N. Hitt, et al	781 / 435	1.26
10	4C / 25	David N. Hitt	732 / 27	44.21
11	4C / 14.1	Lewis County BOE	19 / 6	0.02
12	4C / 14	Roy A. & Kimberly J. Fisher	467 / 259	106.00
13	4C / 33	Crystal M. Mick	713 / 935	92.75
14	4C / 35	Nancy N. & Thomas M. Salvetti	783 / 902	124.88
15	4B / 17	Clarence O. Ferguson	552 / 612	96.50
16	4B / 14	Martin E. McHenry, et al	739 / 3	111.74
17	4B / 21	Karl H. & Theresa B. Skaggs, et al	712 / 704	24.00
18	4B / 22	Karl H. & Theresa B. Skaggs, et al	712 / 704	25.75
19	4B / 23	Karl H. & Theresa B. Skaggs, et al	712 / 704	26.00
20	4B / 13	Robert J. Bennett	W25 / 121	8.00
21	4B / 26	Robert J. Bennett	W25 / 121	16.67
22	4B / 12	Edward E. Garrett, et al	429 / 245	30.00
23	4B / 11	Edward E. Garrett, et al	429 / 245	30.00
24	4B / 31	Robert J. Bennett	W25 / 121	29.75
25	4B / 28	Robert J. Bennett	W25 / 121	19.78
26	4B / 29	Evan S. Bennett	736 / 327	35.72
27	4B / 9	James J. Hitt Trust	674 / 376	68.00
28	4B / 8	Edward E. Garrett, et al	429 / 245	7.50
29	4B / 7	James J. Hitt Trust	674 / 379	96.23
30	4B / 46	Edward E. Garrett, et al	429 / 245	30.33
31	4A / 11	Delphia Garrett Heirs	632 / 245	15.25
32	4A / 21	Edward E. Garrett, et al	429 / 245	27.75
33	4A / 22	John W. Morgan	601 / 74	48.21
34	4A / 9	Edward E. Garrett, et al	429 / 245	69.00
35	4A / 8	Edward E. Garrett, et al	429 / 245	26.00
36	4A / 5	Edward E. Garrett, et al	429 / 245	109.00
37	4A / 6	Melvin James, et al	FID / - - -	26.25
38	4A / 2	Haven Sullivan	789 / 834	81.23
39	4A / 3	Michael L. Small, et al	558 / 15	30.00
40	4A / 4	Michael L. Small, et al	558 / 15	11.60

Doddridge Co. (Greenbrier Dist.)				
No.	TM / Par	Owner	Bk / Pg	Ac.
41	17 / 12.1	Michael L. Small, et al	243 / 592	6.20
42	17 / 9.1	Hayward & Jane Phillips	425 / 36	24.00
43	17 / 10	Carol J. Snow	167 / 4	44.83
44	17 / 6	Carol J. Snow	167 / 1	35.00
45	17 / 9	Justin A. Husk	379 / 659	31.87

FILE NO: 43-12-FC-21  
DRAWING NO: Winans 1216 N-3H Well Plat  
SCALE: 1" = 2000'  
MINIMUM DEGREE OF ACCURACY:  
Submeter  
PROVEN SOURCE OF ELEVATION:  
CORS, Bridgeport, WV

**STATE OF WEST VIRGINIA**  
DEPARTMENT OF ENVIRONMENTAL PROTECTION  
**OIL AND GAS DIVISION**

DATE: January 24 2024  
OPERATOR'S WELL NO. Winans 1216 N-3H  
API WELL NO  
47 - 041 - 05747  
STATE COUNTY PERMIT

WELL TYPE:  OIL  GAS  LIQUID INJECTION  WASTE DISPOSAL  
(IF GAS) PRODUCTION:  STORAGE  DEEP  SHALLOW  
LOCATION: ELEVATION: 1,394' WATERSHED: Fink Creek QUADRANGLE: Top: Camden  
DISTRICT: Freemans Creek Btm: Big Isaac  
SURFACE OWNER: Stephen B. Winans COUNTY: Lewis  
ROYALTY OWNER: Elaina D. Yanceris, et al, et al LEASE NO: ACREAGE: 123  
PROPOSED WORK:  DRILL  CONVERT  DRILL DEEPER  FRACTURE OR STIMULATE  PLUG OFF OLD FORMATION  
 PERFORATE NEW FORMATION  OTHER PHYSICAL CHANGE IN WELL (SPECIFY) Bottom Hole MOD 7,175' TVD  
 PLUG AND ABANDON  CLEAN OUT AND REPLUG TARGET FORMATION: Marcellus Shale ESTIMATED DEPTH: 32,061' MD

WELL OPERATOR: HG Energy II Appalachia, LLC DESIGNATED AGENT: Diane C. White  
ADDRESS: 5260 Dupont Road ADDRESS: 5260 Dupont Road  
Parkersburg, WV 26101 Parkersburg, WV 26101