

HG Energy II Appalachia, LLC  
Well No. Winans 1216 S-12H  
Page 1 of 2

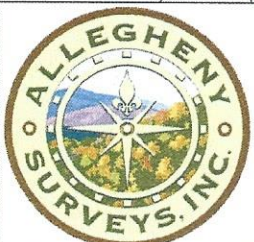

Tag	Bearing	Dist.	Monument
L1	S 79°35' W	1,853.4'	1" Pipe
L2	N 46°48' W	2,810.9'	1" Pipe
L3	S 66°05' E	861.8'	47-041-04554
L4	S 38°30' E	1,252.5'	47-041-03099
L5	S 63°27' W	3,617.2'	Landing Point

Note: 0 water wells, 1 cistern and 1 pond were found within 1500' of proposed well. No occupied dwellings or buildings 2,500 square feet or larger used to house or shelter dairy cattle or poultry husbandry are located within 625' of the center of the well pad.

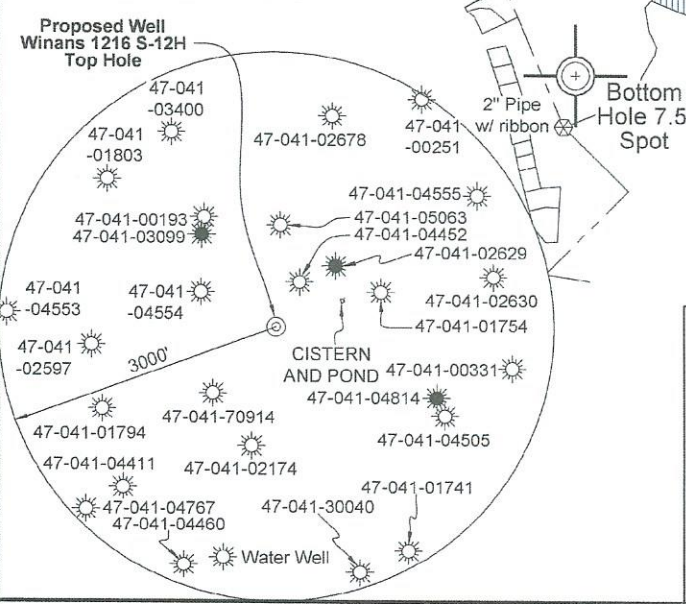

I, the undersigned, hereby certify that this plat is correct to the best of my knowledge and belief and shows all the information required by law and the rules issued and prescribed by the Department of Environmental Protection.

*Dwayne D. Matheny*  
Dwayne D. Matheny, P.S. 2070



Notes: Well No. Winans 1216 S-12H  
UTM NAD 1983 (USSF)  
Top Hole Coordinates  
N: 14,201,873.73'  
E: 1,762,654.16'  
Landing Point Coordinates  
N: 14,200,256.71'  
E: 1,759,418.54'  
Bottom Hole Coordinates  
N: 14,195,133.34'  
E: 1,761,224.78'

Notes: Well No. Winans 1216 S-12H  
West Virginia Coordinate System of 1927, North Zore based upon Differential GPS Measurements.  
Top Hole coordinates Bottom Hole coordinates  
Latitude: 39°06'24.90" Latitude: 39°05'18.32"  
Longitude: 80°34'09.34" Longitude: 80°34'27.88"  
UTM Zone 17, NAD 1983  
Top Hole Coordinates Bottom Hole Coordinates  
N: 4,328,739.770m N: 4,326,685.295m  
E: 537,258.062m E: 536,822.387m  
Plat orientation and corner and well references are based upon the grid north meridian. Well location references are based upon the magnetic meridian.

FILE NO: 43-12-FC-21  
DRAWING NO: Winans 1216 S-12H Well Plat  
SCALE: 1" = 2000'  
MINIMUM DEGREE OF ACCURACY: Submeter  
PROVEN SOURCE OF ELEVATION: CORS, Bridgeport, WV

STATE OF WEST VIRGINIA  
DEPARTMENT OF ENVIRONMENTAL PROTECTION  
OIL AND GAS DIVISION

DATE: August 2 2023  
OPERATOR'S WELL NO. Winans 1215 S-12H  
API WELL NO  
47 - 041 - 05157  
STATE COUNTY PERMIT

WELL TYPE:  OIL  GAS  LIQUID INJECTION  WASTE DISPOSAL  
(IF GAS) PRODUCTION:  STORAGE  DEEP  SHALLOW  
LOCATION: ELEVATION: 1,394' WATERSHED: Fink Creek  
DISTRICT: Freemans Creek  
SURFACE OWNER: Stephen B. Winans  
ROYALTY OWNER: Elaina D. Yanceris, et al, et al LEASE NO: ACREAGE: 123  
PROPOSED WORK:  DRILL  CONVERT  DRILL DEEPER  FRACTURE OR STIMULATE  PLUG OFF OLD FORMATION  
 PERFORATE NEW FORMATION  OTHER PHYSICAL CHANGE IN WELL (SPECIFY) \_\_\_\_\_ 7,175' TVD  
 PLUG AND ABANDON  CLEAN OUT AND REPLUG TARGET FORMATION: Marcellus Shale ESTIMATED DEPTH: 14,762' MD

WELL OPERATOR: HG Energy II Appalachia, LLC  
ADDRESS: 5260 Dupont Road Parkersburg, WV 26101  
DESIGNATED AGENT: Diane C. White  
ADDRESS: 5260 Dupont Road Parkersburg, WV 26101

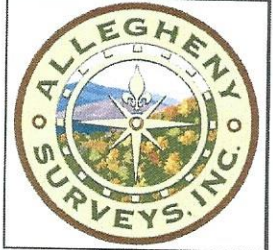

**Well Location References  
Not to Scale**

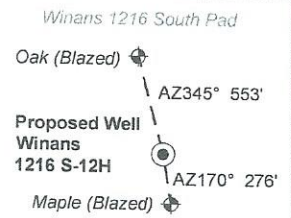

**Legend**

- Proposed gas well
- Well Reference, as noted
- Monument, as noted
- Existing Well, as noted
- Existing Plugged Well, as noted
- Digitized Well, as noted
- Creek or Drain
- Existing Road
- Surface boundary (approx.)

ID	Lease
7	Boyd Gum, et ux
8	William & Mary Winans
46	J.P. Hull
50	Howard & Lucille Ferguson, et al
57	Joseph Gum, et ux, et al
76	P.L. Hull, et ux

Lewis Co. (Freemans Creek Dist.)				
No.	TM / Par	Owner	Bk / Pg	Ac.
1	4C / 31	Gerald P. Hull	W18 / 661	199.25
2	4C / 21	Stephen B. Winans	630 / 50	45.00
3	4C / 22	Robert & Brenda McKinley, et al	540 / 137	74.00
4	4C / 16	Robert & Brenda McKinley, et al	540 / 137	32.00
5	4C / 17	Jeremy H. Bennett	602 / 716	29.25
6	4C / 18	Robert & Brenda McKinley, et al	540 / 137	52.80
7	4C / 8	Donna J. Goldsmith	577 / 690	32.60
8	4C / 8.1	Donna J. Goldsmith	577 / 690	21.39
9	4C / 19	Robert & Brenda McKinley, et al	547 / 235	23.50
10	4D / 68	Robert & Brenda McKinley, et al	551 / 567	29.75
11	4D / 44	Stephen B. Winans	733 / 528	35.00
12	4D / 43	Garnett A. Gum Trust	W11 / 74	101.00
13	4D / 42.1	Darrel E. & Kathy I. James	607 / 135	2.00
14	4D / 42	Garnett A. Gum Trust	W11 / 74	138.25
15	4D / 60.3	Jeffrey A. White	606 / 591	17.27
16	4D / 60.2	Christopher P. White	598 / 647	14.97
17	4D / 62	Stephen R. Ferstermann	562 / 547	172.16

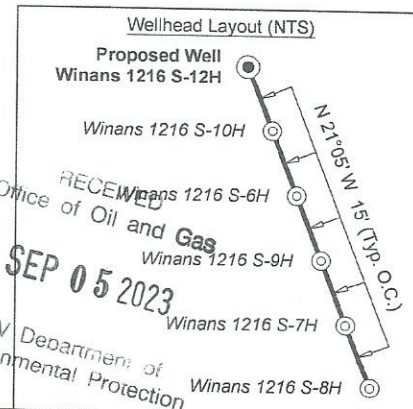

FILE NO: 43-12-FC-21  
DRAWING NO: Winans 1216 S-12H Well Plat  
SCALE: 1" = 2000'  
MINIMUM DEGREE OF ACCURACY:  
Submeter  
PROVEN SOURCE OF ELEVATION:  
CORS, Bridgeport, WV

**STATE OF WEST VIRGINIA**  
DEPARTMENT OF ENVIRONMENTAL PROTECTION  
**OIL AND GAS DIVISION**

DATE: August 2 2023  
OPERATOR'S WELL NO. Winans 1216 S-12H  
API WELL NO  
47 -- 041 -- 05757  
STATE COUNTY PERMIT

WELL TYPE:  OIL  GAS  LIQUID INJECTION  WASTE DISPOSAL  
(IF GAS) PRODUCTION:  STORAGE  DEEP  SHALLOW

LOCATION: ELEVATION: 1,394' WATERSHED: Fink Creek

QUADRANGLE: Camden

DISTRICT: Freemans Creek

COUNTY: Lewis

SURFACE OWNER: Stephen B. Winans

ACREAGE: 10/06/2023

ROYALTY OWNER: Elaina D. Yanceris, et al, et al

LEASE NO: ACREAGE: 123

PROPOSED WORK:  DRILL  CONVERT  DRILL DEEPER  FRACTURE OR STIMULATE  PLUG OFF OLD FORMATION  
 PERFORATE NEW FORMATION  OTHER PHYSICAL CHANGE IN WELL (SPECIFY)

PLUG AND ABANDON  CLEAN OUT AND REPLUG TARGET FORMATION: Marcellus Shale ESTIMATED DEPTH: 14,762' MD

WELL OPERATOR: HG Energy II Appalachia, LLC  
ADDRESS: 5260 Dupont Road  
Parkersburg, WV 26101

DESIGNATED AGENT: Diane C. White  
ADDRESS: 5260 Dupont Road  
Parkersburg, WV 26101