

HG Energy II Appalachia, LLC
Well No. Van Wie 1221 S-9H



Page 1 of 2



SEAL

I, the undersigned, hereby certify that this plat is correct to the best of my knowledge and belief and shows all the information required by law and the rules issued and prescribed by the Department of Environmental Protection.

Dwayne D. Matheny
Dwayne D. Matheny, P.S. 2070

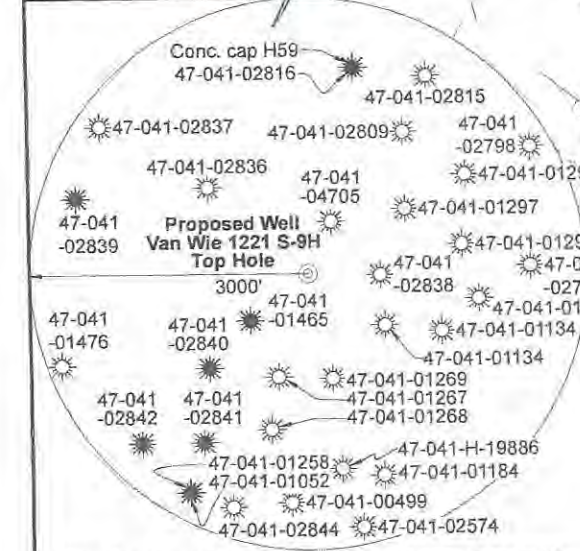

Note: 0 water wells, 0 cistern, and 0 pond were found within 1500' of proposed well. No occupied dwellings or buildings 2,500 square feet or larger used to house or shelter dairy cattle or poultry husbandry are located within 625' of the center of the well pad.



Tag	Bearing	Dist.	Description
L1	N 74°12' E	2,684.2'	5/8" Iron rebar
L2	S 71°24' E	2,618.8'	47-041-02839
L3	S 60°10' E	3,508.8'	5/8" Iron rebar
L4	S 34°17' W	1,861.5'	47-041-02809
L5	S 81°42' E	1,079.5'	Landing Point

FILE NO: 170-12-30-FC-22
DRAWING NO: Van Wie 1221 S-9H Well Plat-S
SCALE: 1" = 2000'
MINIMUM DEGREE OF ACCURACY: Submeter
PROVEN SOURCE OF ELEVATION: CORS, Bridgeport, WV

STATE OF WEST VIRGINIA
DEPARTMENT OF ENVIRONMENTAL PROTECTION
OIL AND GAS DIVISION

DATE: September 13 20 24
OPERATOR'S WELL NO. Van Wie 1221 S-9H
API WELL NO
47 - 041 - 05768
STATE COUNTY PERMIT

WELL TYPE: OIL GAS LIQUID INJECTION WASTE DISPOSAL
(IF GAS) PRODUCTION: STORAGE DEEP SHALLOW

LOCATION: ELEVATION: 1,251.77' WATERSHED: Fink Creek QUADRANGLE: Vadis
DISTRICT: Freemans Creek COUNTY: Lewis
SURFACE OWNER: HG Energy II Appalachia, LLC, et al ACREAGE: 131.85
ROYALTY OWNER: Joseph Krenn, et al LEASE NO: ACREAGE: 249

PROPOSED WORK: DRILL CONVERT DRILL DEEPER FRACTURE OR STIMULATE PLUG OFF OLD FORMATION
 PERFORATE NEW FORMATION OTHER PHYSICAL CHANGE IN WELL (SPECIFY) _____ 7,035' TVD
 PLUG AND ABANDON CLEAN OUT AND REPLUG TARGET FORMATION: Marcellus Shale ESTIMATED DEPTH: 19,162' MD

WELL OPERATOR: HG Energy II Appalachia, LLC DESIGNATED AGENT: Diane C. White
ADDRESS: 5260 Dupont Road ADDRESS: 5260 Dupont Road
Parkersburg, WV 26101 Parkersburg, WV 26101

11/08/2024

HG Energy II Appalachia, LLC
Well No. Van Wie 1221 S-9H



Page 2 of 2

West Virginia Coordinate System of 1927, North Zone based upon Differential GPS Measurements.

UTM Zone 17, NAD 1983
Plat orientation and corner and well references are based upon the grid north meridian. Well location references are based upon the magnetic meridian.

Notes: Well No. Van Wie 1221 S-9H
WVCS 1927, North Zone
Top Hole Coordinates
Lat: 39°05'40.31"
Lon: 80°40'09.63"
Landing Point Coordinates
Lat: 39°05'38.73"
Lon: 80°39'56.09"
Bottom Hole Coordinates
Lat: 39°03'52.12"
Lon: 80°39'08.43"

Notes: Well No. Van Wie 1221 S-9H
UTM NAD 1983 (USSF)
Top Hole Coordinates
N: 14,197,244.84'
E: 1,734,279.91'
Landing Point Coordinates
N: 14,197,088.94'
E: 1,735,348.14'
Bottom Hole Coordinates
N: 14,186,321.85'
E: 1,739,145.36'

Notes: Well No. Van Wie 1221 S-9H
UTM NAD 1983 (Meters)
Top Hole Coordinates
N: 4,327,328.832m
E: 528,609.574m
Landing Point Coordinates
N: 4,327,281.363m
E: 528,935.171m
Bottom Hole Coordinates
N: 4,323,999.548m
E: 530,092.566m

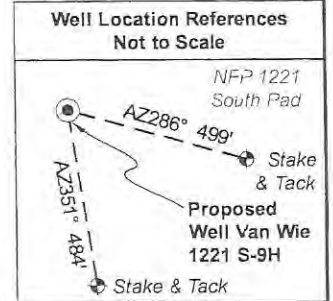
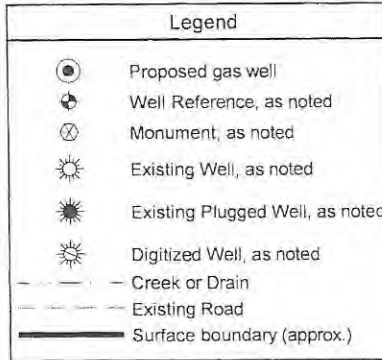
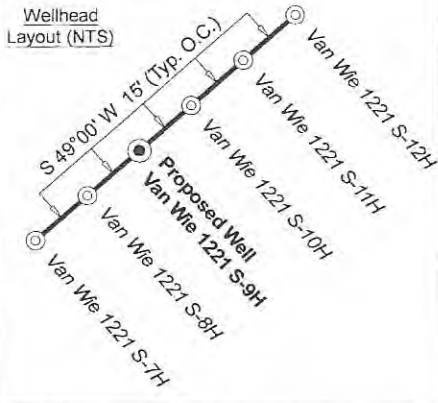

RECEIVED
Office of Oil and Gas
OCT 08 2024
WV Department of Environmental Protection

ID	Lease
6	Joseph Krenn, et ux
7	HG Energy II Appalachia, LLC
8	L.M.Reed, et ux
12	HG Energy II Appalachia, LLC
14	C.K. Gibson, et ux
15	Elsie & J.P. Linder, et al
16	E. Ray Bennett, et ux, et al
52	S.R. Harrison, Jr., et ux, et al
53	T&B Natural Resource Ventures, LLC
57	CNX Gas Company, LLC

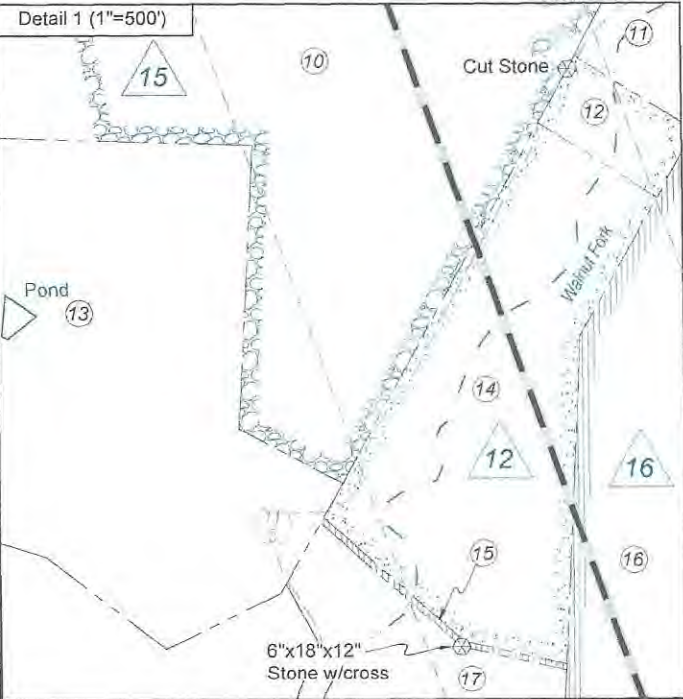

Lewis Co. (Freemans Creek Dist.)				
No.	TM / Par	Owner	Bk / Pg	Ac.
1	2D / 3	HG Energy II Appalachia, LLC	800 / 637	131.85
2	2D / 3.1	HG Energy II Appalachia, LLC	800 / 637	20.00
3	2D / 40	Judith A. Rioch	403 / 270	26.96
4	2D / 37	Jacob R. Straley Heirs	728 / 53	97.00
5	2D / 30	Anthony S. & Dawn H. VanWie	732 / 622	19.00
6	2D / 29	Anthony S. & Dawn H. VanWie	732 / 622	26.63
7	2D / 31	Anthony S. & Dawn H. VanWie	732 / 622	73.10
8	2D / 36	Eugene C. Groah, Jr.	705 / 777	93.12
9	2D / 34	Anthony S. & Dawn H. VanWie	732 / 622	43.81
10	2D / 35	Eugene C. Groah, Jr.	705 / 777	80.00
11	2D / 47	Frances McCutchan, et al	726 / 551	151.00
12	2E / 41.2	Charles M. & Katie D. Groah	652 / 348	1.84
13	2E / 41.1	David B. Lang	717 / 614	72.75
14	2E / 41	Charles M. & Katie D. Groah	575 / 205	15.50
15	2E / 43.1	David B. Lang	662 / 726	0.25
16	2E / 43	David B. Lang	662 / 726	68.00
17	2E / 45	Paul J. Groah & James C. Empoules	723 / 719	173.00
18	2E / 44	David B. Lang	662 / 726	43.00
19	2E / 46	Emily M. & Carlton E. Jones, II	734 / 928	130.00
20	2E / 55	Carlton E. Jones, II	671 / 536	94.00
21	2E / 54	Emily M. & Carlton E. Jones, II	734 / 928	47.44
22	2E / 59	Donna L. & Joseph A. Motto, Jr. (L/E)	746 / 367	51.68

FILE NO: 170-12-30-FC-22
DRAWING NO: Van Wie 1221 S-9H Well Plat-S
SCALE: 1" = 2000'
MINIMUM DEGREE OF ACCURACY: Submeter
PROVEN SOURCE OF ELEVATION: CORS, Bridgeport, WV

STATE OF WEST VIRGINIA
DEPARTMENT OF ENVIRONMENTAL PROTECTION
OIL AND GAS DIVISION

DATE: September 13 20 24
OPERATOR'S WELL NO. Van Wie 1221 S-9H
API WELL NO
47 - 041 - 05168
STATE COUNTY PERMIT

WELL TYPE: OIL GAS LIQUID INJECTION WASTE DISPOSAL
(IF GAS) PRODUCTION: STORAGE DEEP SHALLOW

LOCATION: ELEVATION: 1,251.77' WATERSHED: Fink Creek QUADRANGLE: Vadis
DISTRICT: Freemans Creek COUNTY: Lewis
SURFACE OWNER: HG Energy II Appalachia, LLC, et al ACREAGE: 131.85
ROYALTY OWNER: Joseph Krenn, et al LEASE NO: ACREAGE: 245
PROPOSED WORK: DRILL CONVERT DRILL DEEPER FRACTURE OR STIMULATE PLUG OFF OLD FORMATION
 PERFORATE NEW FORMATION OTHER PHYSICAL CHANGE IN WELL (SPECIFY)
 PLUG AND ABANDON CLEAN OUT AND REPLUG TARGET FORMATION: Marcellus Shale ESTIMATED DEPTH: 7,035' TVD 19,162' MD

WELL OPERATOR: HG Energy II Appalachia, LLC DESIGNATED AGENT: Diane C. White
ADDRESS: 5260 Dupont Road ADDRESS: 5260 Dupont Road
Parkersburg, WV 26101 Parkersburg, WV 26101