

LATITUDE 39° 07' 30"



0.330

0.774W

80° 55' 00" LONGITUDE

7'5 OGIS topo location

7.5' loc \_\_\_\_\_ 15' loc \_\_\_\_\_  
(calc.) \_\_\_\_\_

Company Pitts + WV Gas Co

Farm A.H. Kemper 4200

Quad CAMDEN

County LEWIS

District FREEMANS CREEK

WELL LOCATION MAP

File No. 041- 1A

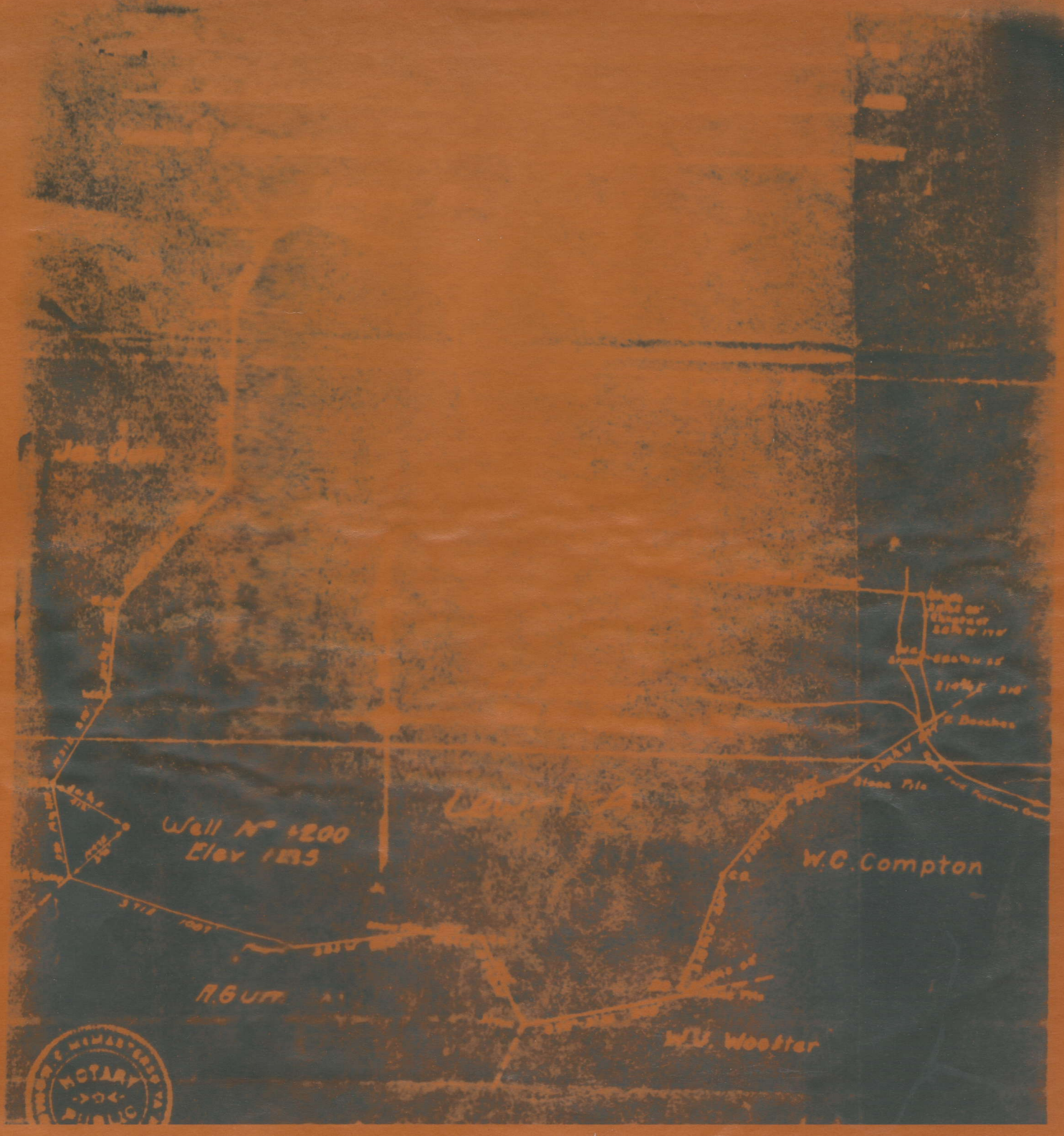

LOWIA

CONTINUED COPY  
Of Driller's Well Log of Well No. 4200  
drilled by  
PITTSBURGH & WEST VIRGINIA GAS COMPANY

on  
A. L. Hunter Farm in Freedom's Creek District, Lewis County, W. Va.

- o o o -

<u>FORMATION</u>	<u>TOP</u>	<u>BOTTOM</u>	<u>REMARKS</u>
Clay	0'	20'	
Slate & Lime	20	295	
Coal	295	298	
Slate	298	568	
Lime	368	608	
Pittsburg Coal	608	612	
Slate	612	624	
Coal	624	704	
Slate & Red Rock	704	920	
Little Dunkard Sand	920	1000	
Slate	1000	1072	
Big Dunkard Sand	1072	1131	
Slate	1131	1148	
Gas Sand	1148	1200	
Lime	1200	1224	
Preport Coal	1224	1224	
Slate	1224	1415	
Sand	1415	1490	Water @ 1424
Slate	1490	1505	
Sand	1505	1610	
Slate	1610	1800	
Sand	1800	1845	
Slate	1845	1855	
Sand	1855	1895	
Red Rock	1895	1990	
Sand	1990	2022	
Red Rock	2022	2048	
Little Lime	2048	2060	
Slate	2060	2080	
Big Lime	2080	2142	
Big Injun	2142	2250	
Red Rock	2250	2260	
Sand	2260	2305	
Slab & Shells	2305	2450	
Gas Sand	2450	2490	Little Gas @ 2456
Slab & Shells	2490	2508	
Fifty Foot Sand	2508	2528	
Slab	2528	2628	
Thirty Foot Sand	2628	2642	
Slab & Shells	2642	2734	
Gas Sand	2734	2752	
Slab	2752	3047	
TOTAL DEPTH		3047	

( See next page for certificate )

CERTIFICATE

I, the undersigned, hereby certify that I am a true and correct copy of the driller's log of Well No. 4000, and that the same is true to the best of my knowledge and belief, in accordance with the provisions of the Mining Laws of West Virginia.

FURNISHED BY

By [Signature]

Acknowledged before me a NOTARY

this 1st day of August

[Signature]  
JOHN  
M.