

LATITUDE 39° 00" 00"



80° 27' 30" LONGITUDE

7.5 OGIS topo location

7.5' loc 0.595 15' loc _____
' 1.62w (calc.) _____

Company _____

Farm _____

Quad ROANOKE 7 1/2'

County LEWIS

District COURT HOUSE

WELL LOCATION MAP

File No. 041-36A

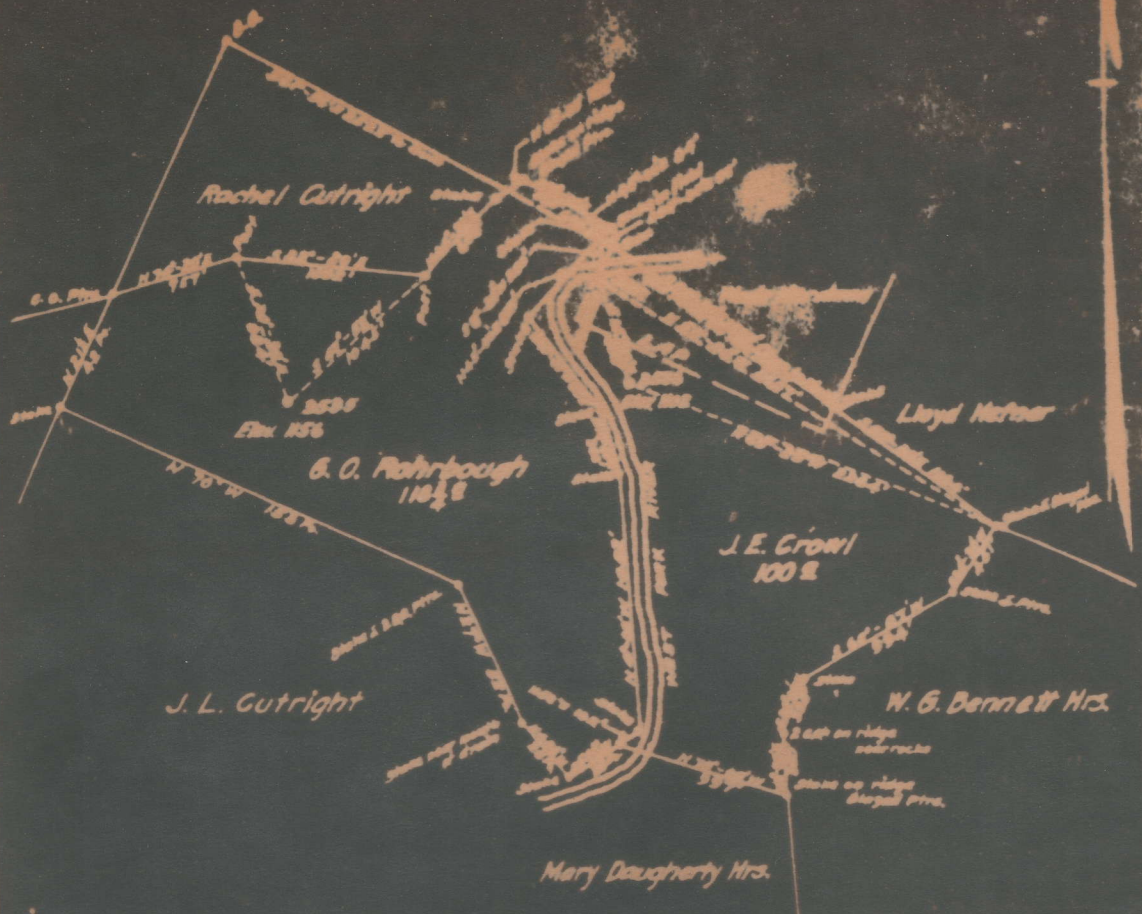

Low-36-A

- LEGEND
- Location
 - Oil Well
 - ⊙ " " Aband.
 - ⊛ Gas Well
 - ⊙ " " Aband.
 - ⊕ Dry Hole
- 3-14-31
 P.A. 580-74-25
 Scale 1" = 800'
 8526 1-5-31

ENGINEERS CERTIFICATE

I, the undersigned, hereby certify that this map is correct and shows all the information to the best of my knowledge and belief, required by the oil and gas section of the mining laws of West Virginia.

Court House District, Lewis County, W. Va.
 Hope Cons. & Ref. Co., 445 W. Main St., Clarksburg, W. Va.
 On 100 acres, surface and mineral rights owned by J. E. Crowl,
 Route 3, Weston, W. Va.
 Elevation, 1102'.
 6-5/8" casing, 1850'.
 Coal was encountered at 140-145'.
 Abandonment reported to Dept. of Mines Jan. 5, 1932.
 Well was shot at 2481-2487'.
 Fresh water at 95-140'; no salt water recorded.
 Oil? well.

	Top.	Bottom.
Water, 95-140'		
Coal	140	145
Gas Sand	960	1120
First and Second Salt Sands	1200	1280
Third Salt Sand	1300	1435
Red rock	1590	1700
Lime	1760	1795
Little Lime	1800	1825
Pencil Cave	1825	1835
Big Lime	1835	1918
Big Injun Sand	1918	2020
Gantz? (Berea) Sand (gas, 2243-2247')	2230	2255
Gordon Sand (oil, 2481-2487')	2477	2491
Total depth		2508