

LATITUDE 39° 02' 30"

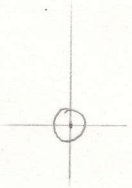

LONGITUDE 80° 37' 30"

T'S OGIS topo location

7.5' 10C 0.285 15' 10C _____
 1.98W (calc.) _____

Company _____

Farm _____

Quad VADIS 7 1/2'

County LEWIS

District FREEMANS CREEK

WELL LOCATION MAP

File No. 041-54A

HOPE NATURAL GAS CO.
G. L. BUSH & J. STARK
FREEMANS CREEK

District

Clatsburg, W. Va., on the
Farm containing of Acres
County, W. Va.

No 3905 Aug. 5, 1933.

Law 54-A

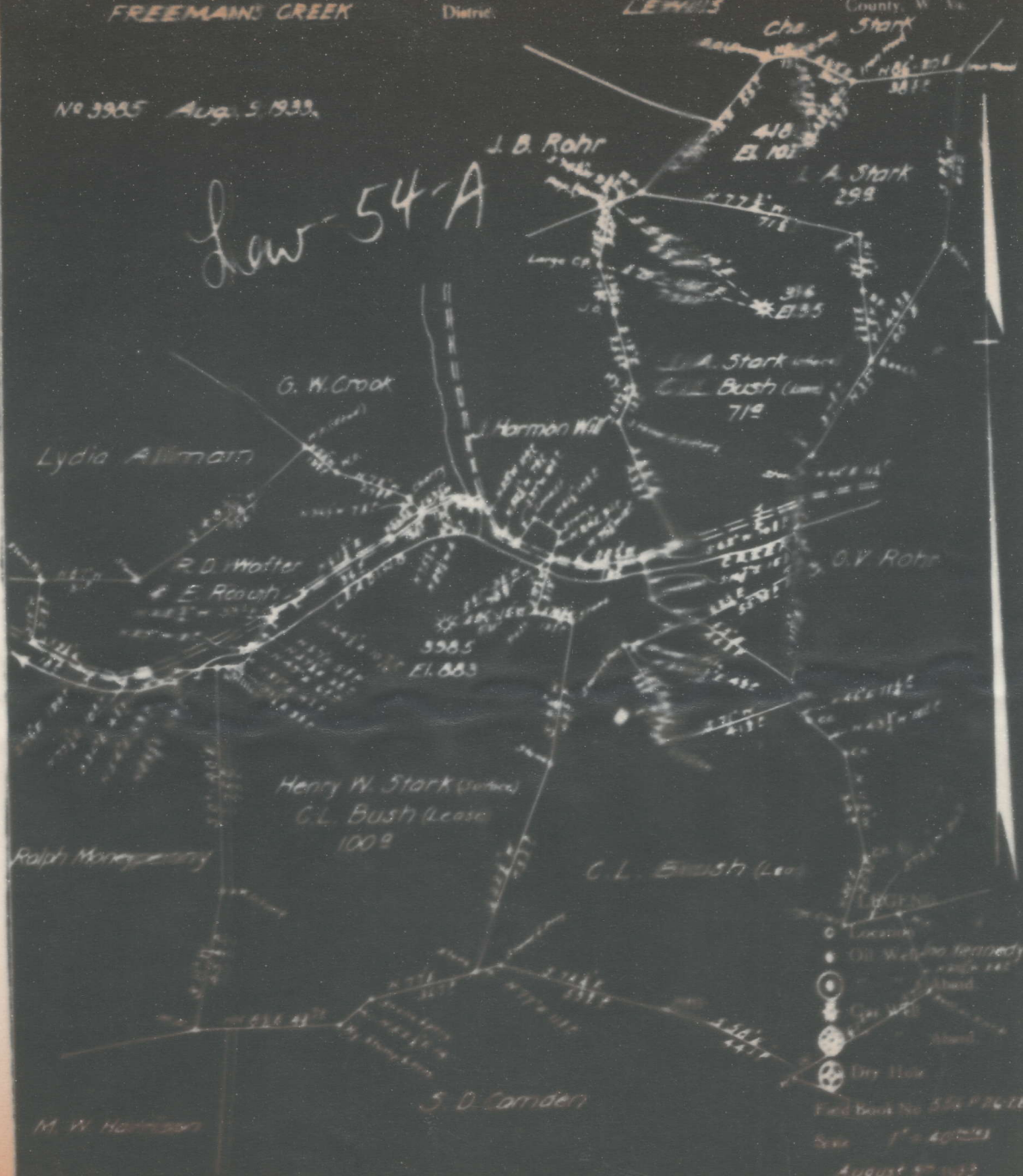

ENGINEERS CERTIFICATE

We, the undersigned, hereby certify that this map is correct and shows with the information to the best of our knowledge and belief all the oil and gas wells in the mining laws of West Virginia.

JWA

Freemans Creek District, Lewis County, W. Va.

Hope Natural Gas Co., 445 W. Main St., Clarksburg, W. Va.

On 100 acres, surface owned by Henry W. Stark, Alum Bridge, W. Va.

Elevation, 883' L.

10" casing, 155'; 8½", 809'; 6-5/8", 1460'; 2" tubing, 2441'.

Coal was encountered at 296-299'.

Abandonment reported to Dept. of Mines Aug. 9, 1933.

Well was shot at 2374-2379' and 2128-2143'.

Fresh water at 132'; salt water not recorded.

Producing hole; now exhausted to the extent that it is no longer commercially productive.

	Top.	Bottom.
Water at 132'		
Coal	296	299
Big Dunkard Sand	370	560
Gas Sand	581	630
First Salt Sand	640	781
Second Salt Sand	799	948
Little Lime	1344	1366
Pencil Cave	1366	1374
Big Lime	1374	1447
Big Injun Sand (show oil, 1447'; show gas, 1523')	1447	1558
Squaw Sand	1592	1718
Gordon Sand (gas, 2129')	2125	2146
Fourth Sand	2195	2215
Fifth Sand	2307	2309
Bayard Sand (oil and gas, 2377')	2374	2379
Total depth		2419