

LATITUDE  $39^{\circ} 02' 30''$



80° 30' 00"

LONGITUDE

7.5 OGIS topo location

7.5' loc	<u>0.895</u>	15' loc	_____
	<u>1.48 w</u>	(calc.)	_____

Company \_\_\_\_\_

Farm \_\_\_\_\_

Quad CAMDEN 7 1/2

County LEWIS

District COURTHOUSE

### WELL LOCATION MAP

File No. 041-623A

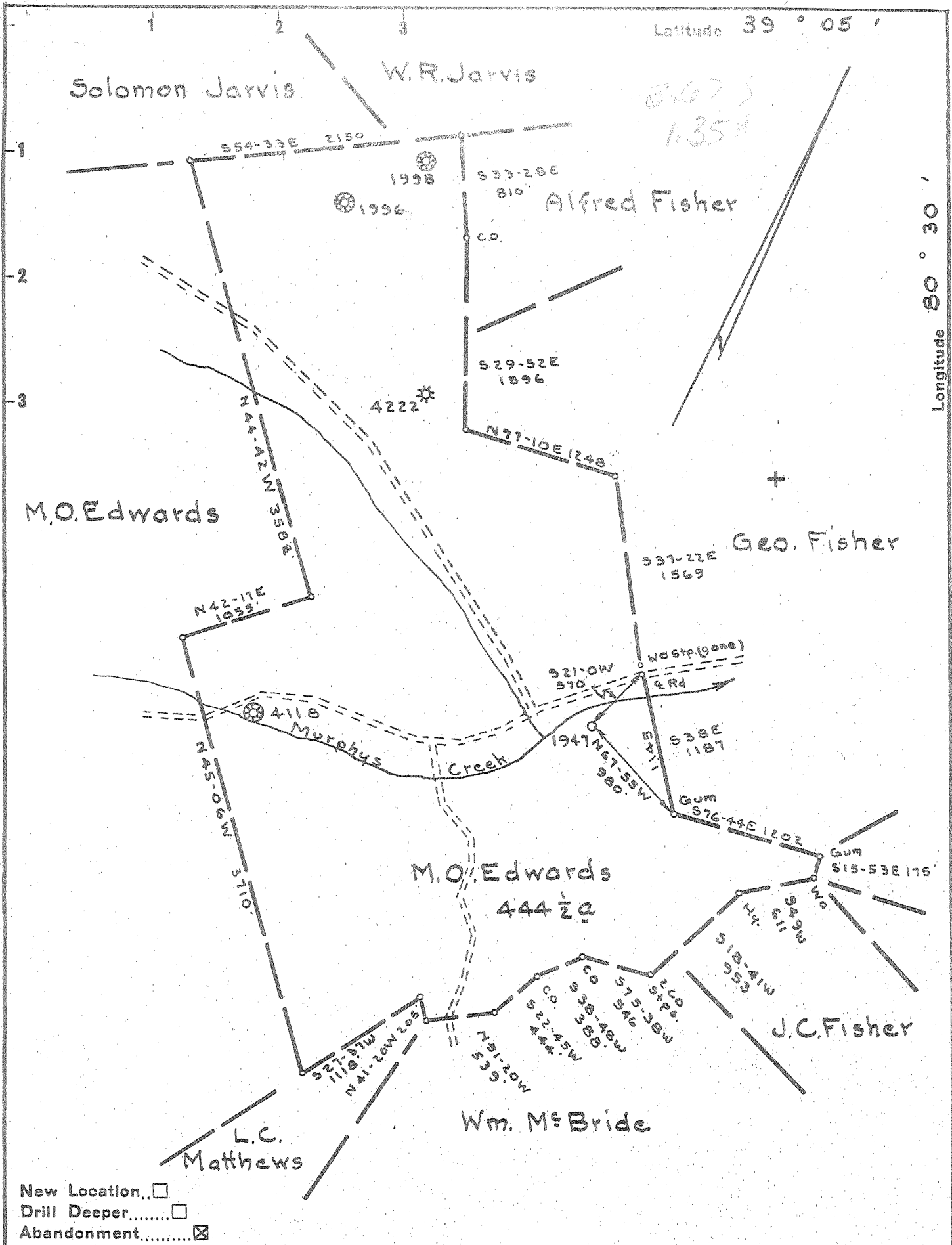

Company Equitable Gas Co. W.Va. Div.  
 Address Clarksburg W.Va.  
 Farm M.O. Edwards  
 Tract \_\_\_\_\_ Acres 1019 Lease No. 4370  
 Well (Farm) No. One Serial No. 1947  
 Elevation (Spirit Level) 1064  
 Quadrangle Vadis S.E. 4<sup>e</sup>  
 County Lewis District Courthouse  
 Engineer James D Jeffries  
 Engineer's Registration No. 1084  
 File No. 86/140 Drawing No. \_\_\_\_\_  
 Date 1-26-54 Scale 1" = 1000'

STATE OF WEST VIRGINIA  
 DEPARTMENT OF MINES  
 OIL AND GAS DIVISION  
 CHARLESTON

**WELL LOCATION MAP**  
 FILE NO. LEW-623-A

+ Denotes location of well on United States Topographic Maps, scale 1 to 62,500, latitude and longitude lines being represented by border lines as shown.

- Denotes one inch spaces on border line of original tracing.



STATE OF WEST VIRGINIA  
DEPARTMENT OF MINES  
OIL AND GAS DIVISION

715

Quadrangle Vadis S/E. 4-C

WELL RECORD

Permit No. 623-A

Oil or Gas Well "GAS"  
(KIND)

Company Equitable Gas Company - West Va Div.  
 Address Clarksburg, West Va.  
 Farm M. O. Edwards Acres 1019  
 Location (waters) Vadis S/E. 4-C  
 Well No. 1947 Elev. 1064'  
 District Court House County Lewis  
 The surface of tract is owned in fee by Kraus Bros.  
Miss Anna Kraus Address R.D.#2, Weston, W. Va.  
 Mineral rights are owned by John J. Hendrick, Agt.  
 Address Glenville, W. Va.  
 Drilling commenced June 29, 1905  
 Drilling completed July 31, 1905  
 Date Shot \_\_\_\_\_ From \_\_\_\_\_ To \_\_\_\_\_  
 With \_\_\_\_\_

Casing and Tubing	Used in Drilling	Left in Well	Packers
Size			
16			Kind of Packer
13			
10	<u>187'</u>	<u>187'</u>	Size of
8 1/4	<u>929'</u>	<u>929'</u>	<u>92</u>
6 5/8	<u>1707'</u>	<u>1707'</u>	Depth set
5 3/16			
3 5/8			Perf. top
2			Perf. bottom
Liners Used			Perf. top
			Perf. bottom

Open Flow \_\_\_\_\_ /10ths Water in \_\_\_\_\_ Inch  
 \_\_\_\_\_ /10ths Merc. in \_\_\_\_\_ Inch  
 Volume \_\_\_\_\_ Cu. Ft.  
 Rock Pressure \_\_\_\_\_ lbs. \_\_\_\_\_ hrs.  
 Oil \_\_\_\_\_ bbls., 1st 24 hrs.  
 Fresh water \_\_\_\_\_ feet \_\_\_\_\_ feet  
 Salt water \_\_\_\_\_ feet \_\_\_\_\_ feet

CASING CEMENTED \_\_\_\_\_ SIZE \_\_\_\_\_ No. Ft. \_\_\_\_\_ Date \_\_\_\_\_  
 COAL WAS ENCOUNTERED AT 295 FEET 24 INCHES  
460 FEET 24 INCHES FEET INCHES  
 FEET INCHES FEET INCHES

Formation	Color	Hard or Soft	Top	Bottom	Oil, Gas or Water	Depth Found	Remarks
Sand			0	110			
Un-recorded			110	295			
Coal			295	297			
Un-recorded			297	460			
Coal			460	462			
Un-recorded			462	520			
Sandy Lime			520	560			
Sand		Hard	560	660			
Slate			660	770			
Sand			770	895			
Slate&Shell			895	948			
Sand			948	1000			
Slate	Black		1000	1010			
Sand		Hard	1010	1106			
Slate	Black		1106	1186			
Sand		Hard	1186	1250			
Slate Shell	Black		1250	1420			
Red Rock			1420	1545			
Maxon Sand			1545	1570			
Slate&Shells			1570	1666			
Big Lime			1666	1731			
Big Injun			1731	1776			
Red Lime			1776	1786			
Sand		Hard	1786	1836			
Slate&Shell			1836	1998			
Slate		Hard	1998	2060			
Sand	Gray	"	2060	2161			
Slate			2161	2205			
Sand	Gray	Hard	2205	2238			
Sand			2238	2239			
Gordon Sand			2239	2355	Gas	2293'	
Slate & Shells	Dark	Soft&Hard	2355	2502			
5th Sand	Gray	Hard	2502	2512	Gas	2505	
Slate	Dark	Soft	2512	2563			
Total Depth				2563			

C

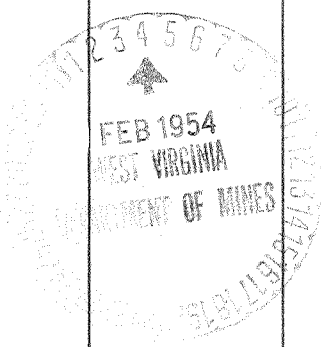

Formation	Color	Hard or Soft	Top	Bottom	Oil, Gas or Water	Depth Found	Remarks

January 25, 1954

Date \_\_\_\_\_, 19\_\_\_\_

Equitable Gas Company - West Va Div.

APPROVED \_\_\_\_\_, Owner

By W. L. M. Mester  
(Title)