

LATITUDE 38° 10' 00"

LONGITUDE 91° 52' 30"

T'S OGIS topo location

7.5' loc 0.08 S 15' loc \_\_\_\_\_  
1.44 W (calc.) \_\_\_\_\_

Company \_\_\_\_\_

Farm \_\_\_\_\_

Quad GRIFFITHSVILLE 7 1/2'

County LINCOLN

District DUVAL

WELL LOCATION MAP

File No. 043-0168

Rec'd

(236)

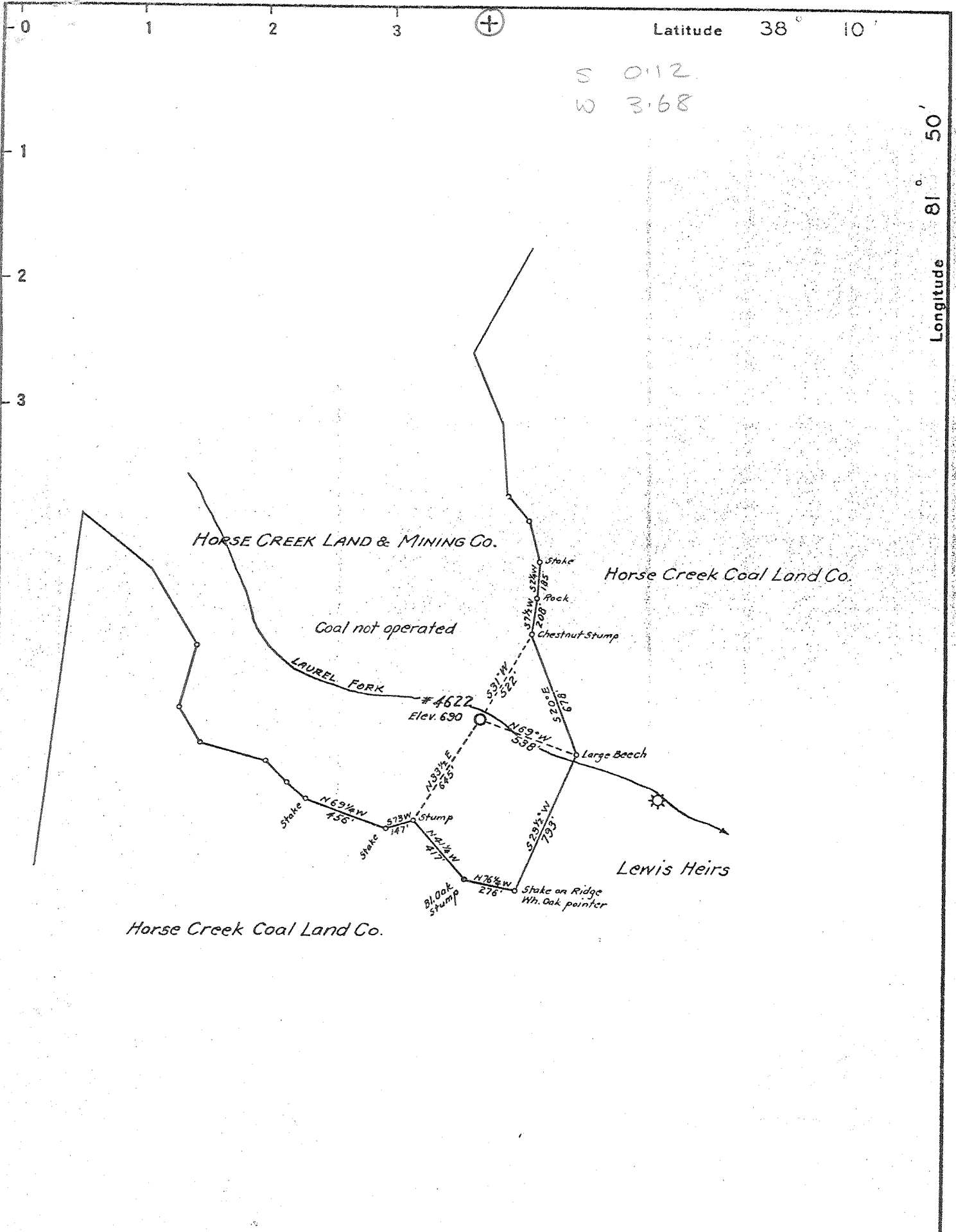

Company	UNITED FUEL GAS CO.
Address	CHARLESTON, W.VA.
Farm	HORSE CREEK LAND & MINING CO.
Tract	Acres 11,324 Lease No. 4976
Well (Farm) No.	32 Serial No. 4622
Quadrangle	MADISON C
County	LINCOLN
District	DUVAL 1
Engineer	<i>J. Madison</i>
Engineer's Registration No.	659
File No.	46-45 Drawing No.
Date	APRIL 7, 1936 Scale 1" = 660'

STATE OF WEST VIRGINIA  
 DEPARTMENT OF MINES  
 OIL AND GAS DIVISION  
 CHARLESTON

**WELL LOCATION MAP**  
 FILE NO. LIN - 168

+ Denotes location of well on United States Topographic Maps, scale 1 to 62,500, latitude and longitude lines being represented by border lines as shown.

- Denotes one inch spaces on border line of original tracing.

*Julian Madison (236)*  
 - Deep Well -

*Carniferous*

## Horse Creek Land &amp; Mining Company No. 4622 Well.

Duval District, Lincoln County, W. Va.

By United Fuel Gas Company.

Permit No. Lin-168.

Elevation, 690' B.

453 M. cu. ft. gas.

Located 0.09 mi. S. of 38° 10' and 3.72 mi. W. of 81° 50'—C—Madison  
Quadrangle.

On south side of Laurel Fork of Horse Creek.

0.64 mi. N. W. of Woodville; 2.08 mi. N. of Laviile.

	Top.	Bottom.	Thickness.	Elevation (top)
Big Lime -----	1349	1555	206	— 659
Big Injun Sand-----	1555	1591	36	— 865
Berea Sand -----	2038	2057	19	—1348
Corniferous Lime-----	4209	4247	38+	—3519

Thickness, Devonian Shales, 2152 feet.

Total depth, 4247'.

Remarks: Completed July 1, 1936.

Shot

Fresh water, 5'. Salt water, 600'.

Gas, 380', 388', 560', (Salt Sand), 1586' (Big Injun), 2040-41',  
2041-46', and 2046-51' (Berea).Shale gas, 2777-2890', 2959-68', 2995-3005', 3175-88', 4144-49', and  
4214-21'.

On 11,324 acres.

Duval District, Lincoln County, W. Va.

By United Fuel Gas Co., Charleston, W. Va.

On 11,324 acres. Lat. 38-10; Long. 81-50 block, Madison Quad. C

Surface and mineral rights owned by Horse Creek Land &amp; Mining Co.

Drilled under ~~mining~~ permit LIN-168.

Elevation, 690' B.

13" conductor, 14'; 10" casing, 27' 6"; 8", 338' 2"; 6", 1392' 11";

~~6 1/2"~~ 3" tubing, 2070'.

Heeter hook wall packer, 3 x 6 3/8 x 16, set at 2052'.

Casing not perforated.

Coal was encountered at 80-84, 240-242, and 307-312'.

Completion reported to Dept. of Mines Aug. 27, 1936.

Well was shot.

Fresh water at 5'; salt water at 600'.

Gas well. 455,000 cu. ft.

Record from Miss Griffith 4-14-37.

	Top.	Bottom.	Thickness.
Gravel (water at 5')	0	27	27
Slate	27	80	53
✓ Coal	80	84	4
Lime	84	90	6
Slate and shells	90	210	120
Sand	210	225	15
Slate	225	240	15
✓ Coal	240	242	2
Slate	242	307	65
✓ Coal	307	312	5
Slate	312	370	58
Sand (gas, 380 and 388')	370	390	20
Slate	390	480	90
✓ Salt Sand (gas, 560'; water, 600')	480	1100	620
Slate	1100	1105	5
Sand	1105	1165	60
Slate	1165	1180	15
Red rock	1180	1185	5
Slate and shells	1185	1215	30
Red rock	1215	1218	3
Slate	1218	1264	46
✓ Maxton Sand	1264	1297	33
✓ Little Lime	1297	1333	36
✓ Pencil Cave	1333	1349	16
✓ Big Lime	1349	1555	206
✓ Big Injun Sand, red (gas, 1586')	1555	1591	36
Slate and shells	1591	2018	427
✓ Brown shale <i>Col. G. S.</i>	2018	2038	20
✓ Berea Grit (gas, 2040-2041'; gas, 2041-2046'; gas, 2046-2051')	2038	2057	19
Slate, white	2057	2075	18
Shell, lime	2075	2090	15
Slate, white	2090	2120	30
Slate, brown	2120	2135	15
Lime shell	2135	2150	15
White slate and shells	2150	2195	45
Black lime	2195	2204	9
Slate and shells	2204	2425	221
White slate and shells	2425	2525	100
Brown slate and shells	2525	2640	115

(OVER)

HORSE CREEK LAND & MINING CO. NO. 4622 WELL (Continued).

	Top.	Bottom.	Thickness.
Gray slate and shells (gas, 2777-2890'; gas, 2959-2968')	2640	- 2980	340
Brown shale (gas, 2995-3005'; gas, 3175- 3188')	2980	- 3025	45
Slate and shells	3025	- 3205	180
Brown shale	3205	- 3220	15
Slate and shell	3220	- 3360	140
Brown shale	3360	- 3400	40
White slate and shell	3400	- 3435	35
Brown shale	3435	- 3465	30
White slate and shell	3465	- 3475	10
Brown shale	3475	- 3633	158
White slate and shells	3633	- 3964	331
Brown slate and shells	3964	- 4019	55
Brown shale (gas, 4144-4149')	4019	- 4204	185
Black lime (gas, 4214-4221')	4204	- 4209	5
Corniferous Lime ←	4209	- 4247	38
Total depth		4247	

(46)