

Latitude 38° 15'

Longitude 81° 50'

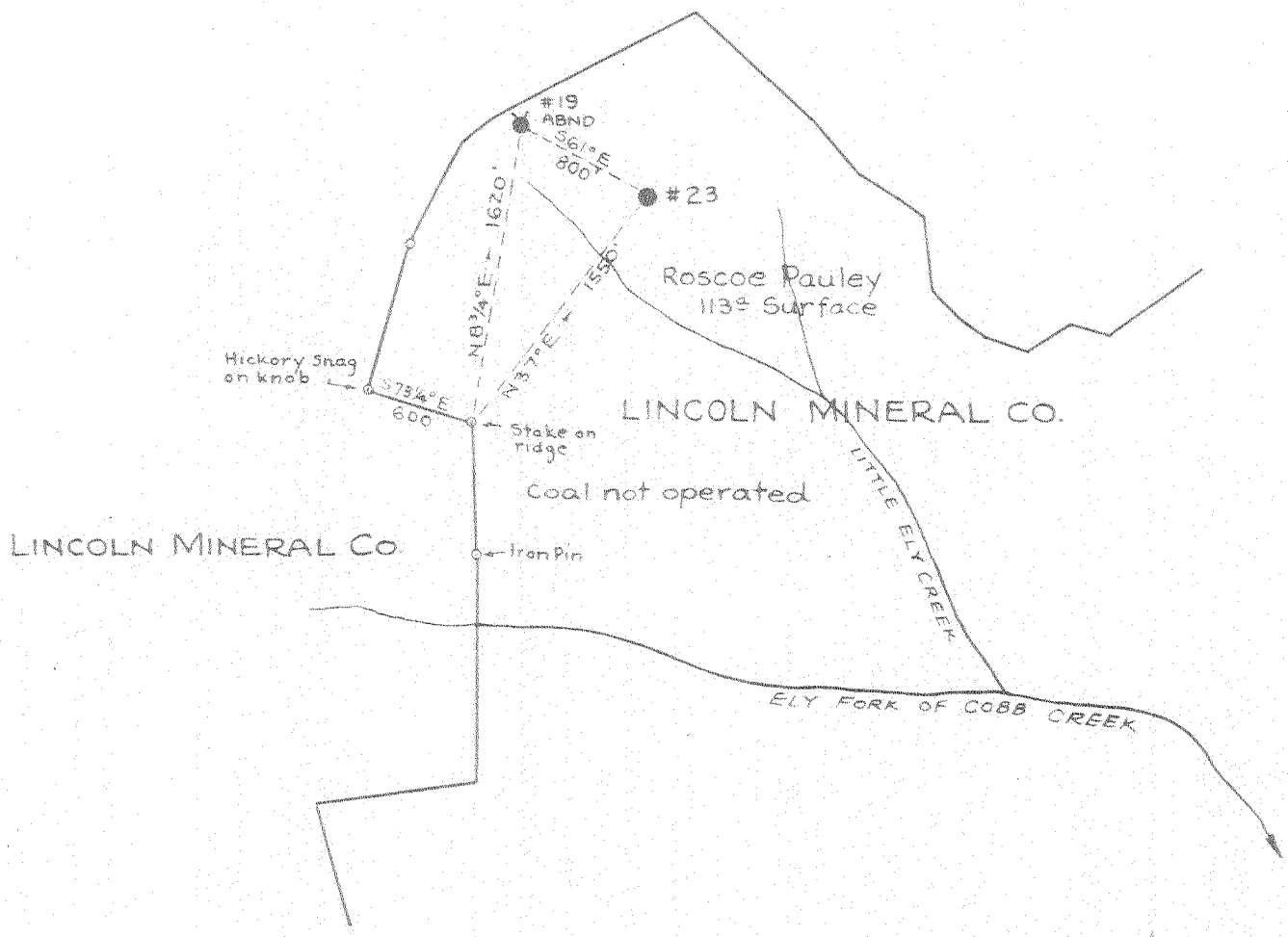

LINCOLN MINERAL CO.



3.42 W
2.26 S

New Location
 Drill Deeper
 Abandonment

FEB 11 1953

Company HARVARD GAS COMPANY
 Address CHARLESTON, W.VA.
 Farm LINCOLN MINERAL CO
 Tract _____ Acres 12,905 Lease No. _____
 Well (Farm) No. 23 Serial No. _____
 Elevation (Spirit Level) 994
 Quadrangle MADISON
 County LINCOLN District WASHINGTON
 Engineer Harold W. Field
 Engineer's Registration No. 651
 File No. _____ Drawing No. _____
 Date OCT. 12, 1950 Scale 1" = 1000'

STATE OF WEST VIRGINIA
 DEPARTMENT OF MINES
 OIL AND GAS DIVISION
 CHARLESTON

WELL LOCATION MAP
 FILE NO. LIN-958-A

+ Denotes location of well on United States Topographic Maps, scale 1 to 62,500, latitude and longitude lines being represented by border lines as shown.
 - Denotes one inch spaces on border line of original tracing.

LINCOLN MINERAL CO., NO. 23 - HARVARD GAS CO. - LIN-958-A