

Latitude 38 ~~38~~

*28*

U.F.G. CO. MIN.

U.F.G. CO. MIN.

U.F.G. CO. MIN.

U.F.G. CO. MIN.

Longitude 82 <sup>00</sup>'

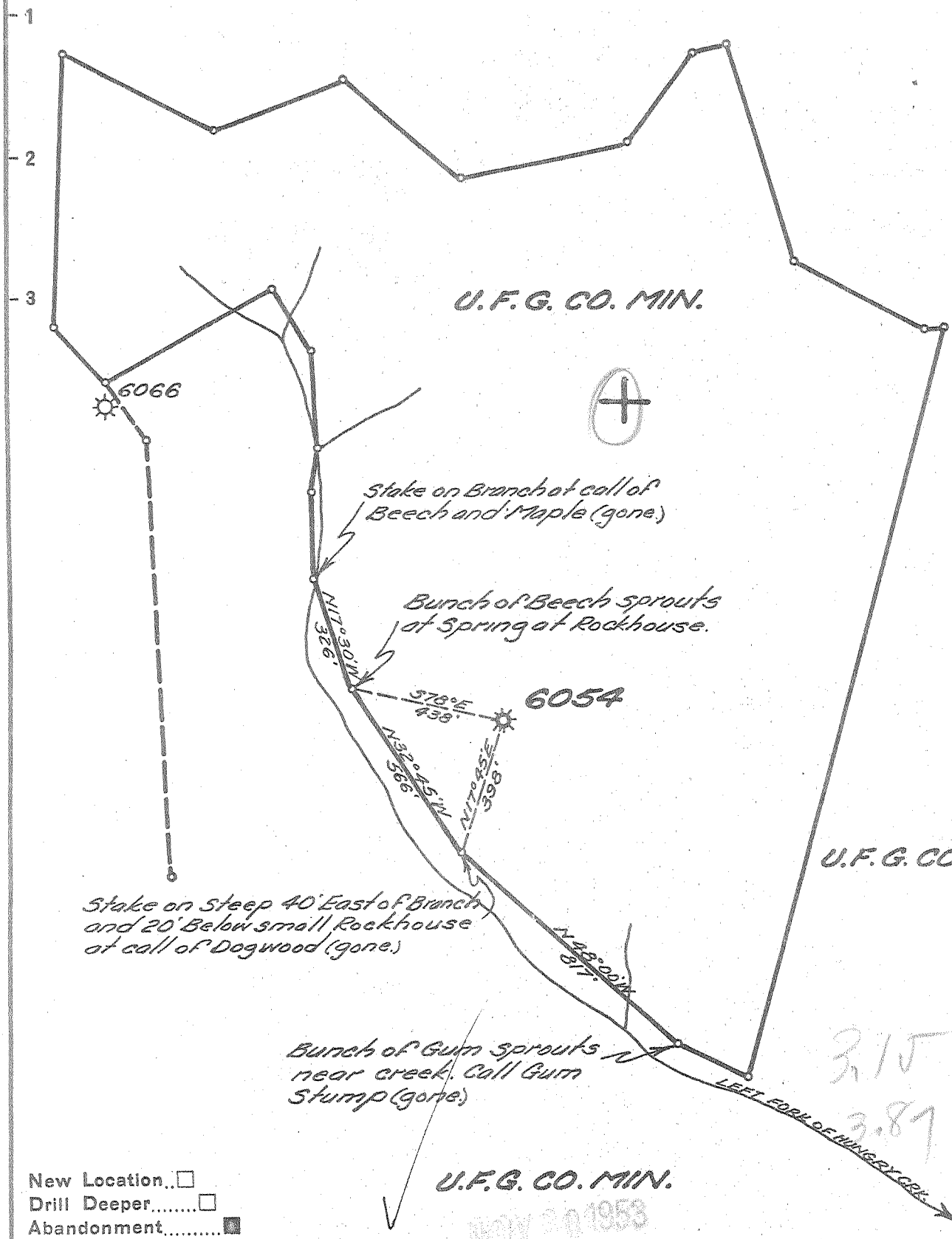

- New Location...
- Drill Deeper.....
- Abandonment.....

Company UNITED FUEL GAS CO.  
 Address CHARLESTON, W.VA.  
 Farm UNITED FUEL GAS CO. MIN.  
 Tract 10 Acres 1215.35 Lease No. NO REF  
 Well (Farm) No. \_\_\_\_\_ Serial No. 6054  
 Elevation (Spirit Level) 933.0  
 Quadrangle MILTON  
 County LINCOLN District CARROLL  
 Engineer Paul G. J. ...  
 Engineer's Registration No. 669  
 File No. 38-59 Drawing No. \_\_\_\_\_  
 Date 11-17-53 Scale 1" = 400'

STATE OF WEST VIRGINIA  
 DEPARTMENT OF MINES  
 OIL AND GAS DIVISION  
 CHARLESTON

**WELL LOCATION MAP**  
 FILE NO. LIN-1096-A

+ Denotes location of well on United States Topographic Maps, scale 1 to 62,500, latitude and longitude lines being represented by border lines as shown.

- Denotes one inch spaces on border line of original tracing.



STATE OF WEST VIRGINIA  
DEPARTMENT OF MINES  
OIL AND GAS DIVISION

WELL RECORD

Oil or Gas Well Gas  
(KIND)

Permit No. 109674  
Company UNITED FUEL GAS COMPANY  
Address P. O. Box 1273, Charleston 25, W. Va.  
Farm U. F. G. Min. Tr. #10 Acres 1215.36  
Location (waters) Hungry Creek  
Well No. 6054 Elev. 933 B.  
District Carroll County Lincoln  
The surface of tract is owned in fee by \_\_\_\_\_  
Address \_\_\_\_\_  
Mineral rights are owned by United Fuel Gas Company  
Address Charleston, W. Va.  
Drilling commenced 7-7-19  
Drilling completed 7-7-19  
Date Shot 7-7-19 From \_\_\_\_\_ To \_\_\_\_\_  
With 60 qts.  
Open Flow 6 /10ths Water in \_\_\_\_\_ Inch  
6 /10ths Merc. in 2" Inch  
Volume 600,000 Cu. Ft.  
Rock Pressure 425 lbs. \_\_\_\_\_ hrs.  
Oil \_\_\_\_\_ bbls., 1st 24 hrs.  
Fresh water \_\_\_\_\_ feet \_\_\_\_\_ feet  
Salt water \_\_\_\_\_ feet \_\_\_\_\_ feet

Casing and Tubing	Used in Drilling	Left in Well	Packers
Size			Kind of Packer
16			
18			
10		18'	Size of
8 1/4	500	120'	
6 5/8	1645		Depth set
5 3/16		1899'	
3		218	Perf. top
2		2151	Perf. bottom
Liners Used			Perf. top
			Perf. bottom

CASING CEMENTED \_\_\_\_\_ SIZE \_\_\_\_\_ No. Ft. \_\_\_\_\_ Date \_\_\_\_\_  
COAL WAS ENCOUNTERED AT \_\_\_\_\_ FEET \_\_\_\_\_ INCHES  
\_\_\_\_\_ FEET \_\_\_\_\_ INCHES \_\_\_\_\_ FEET \_\_\_\_\_ INCHES  
\_\_\_\_\_ FEET \_\_\_\_\_ INCHES \_\_\_\_\_ FEET \_\_\_\_\_ INCHES

Formation	Color	Hard or Soft	Top	Bottom	Oil, Gas or Water	Depth Found	Remarks
Clay			0	16	Gas from berea		
Sand			16	105			
Slate			105	130			
Sand			132	190			
Slate & Shells			190	250			
Red Rock			250	280			
Slate			280	320			
Sand			320	345			
Red Rock			345	355			
Slate & Shells			355	575			
Sand			575	700			
Slate			700	705			
Sand			705	820			
Slate & Shells			820	940			
Sand			940	960			
Slate & Shells			960	1020			
Sand			1020	1065			
Slate			1065	1105			
Gas Sand			1115	1142			
Slate			1142	1154			
Salt <sup>4</sup> / <sub>8</sub>			1154	1305			
Slate			1305	1310			
Sand			1310	1400			
Slate			1400	1405			
Sand			1405	1450			
Slate & Shells			1450	1515			
Sand			1515	1635			
Slate			1635	1640			
Big Lime			1640	1800			
Slate			1800	1805			
Injun			1805	1880			
Slate & Shells			1880	2315			
Brown Shales			2315	2332			
Berea Sand			2332	2354			
Total depth			2368				

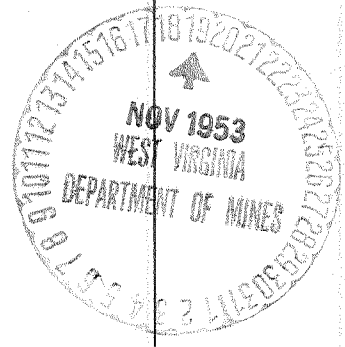

(Over) JAN 2 1954  
JAN 2 REC'D

