

Latitude $38^{\circ} 15'$

Longitude $82^{\circ} 05'$

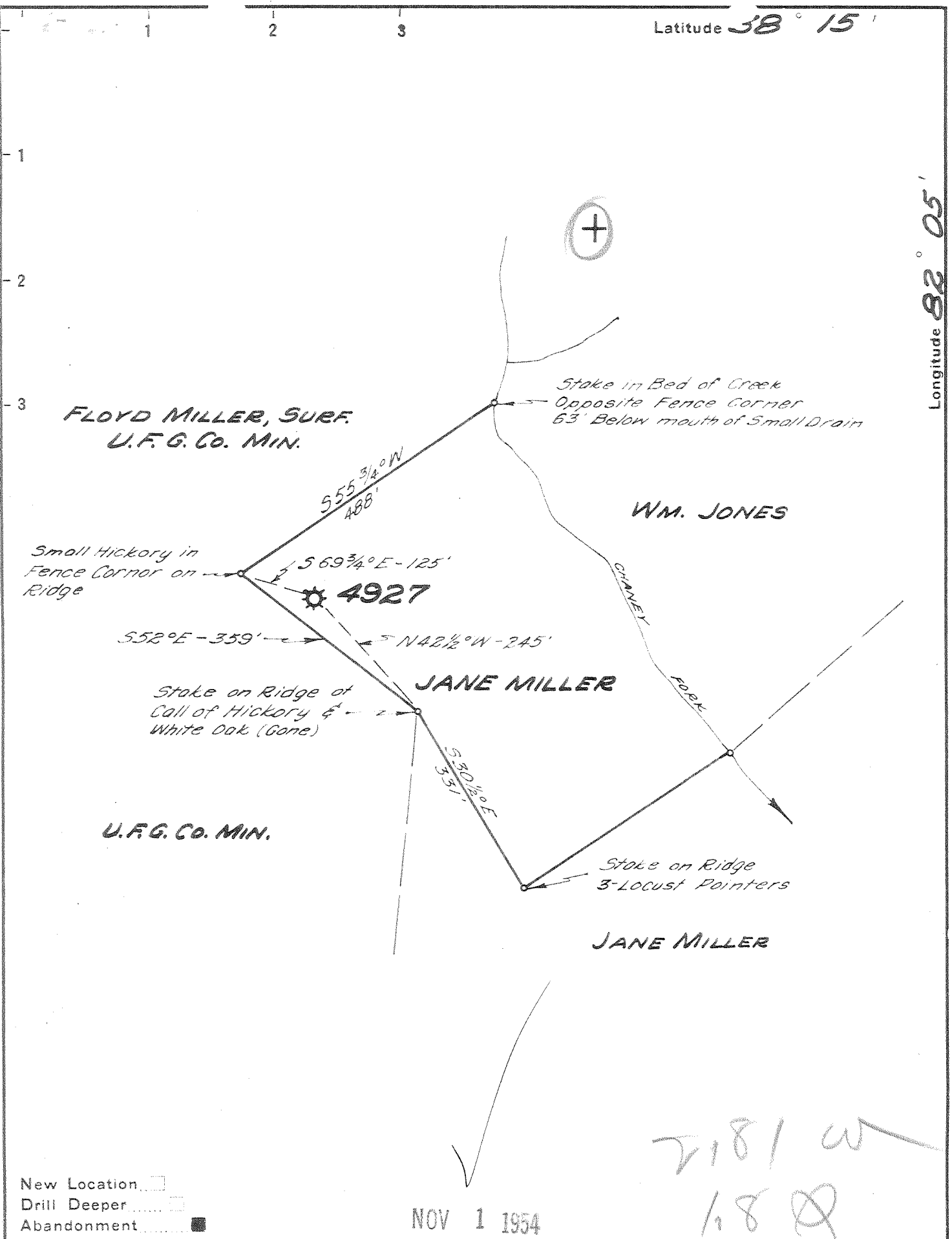

New Location
 Drill Deeper
 Abandonment

NOV 1 1954

2181 W
 188

Company UNITED FUEL GAS CO.
 Address CHARLESTON, W.VA.
 Farm JANE MILLER
 Tract _____ Acres 10 Lease No. 43371
 Well (Farm) No. _____ Serial No. 4927
 Elevation (Spirit Level) 872.0'
 Quadrangle MIDKIFF
 County LINCOLN District CARBOLL
 Engineer [Signature]
 Engineer's Registration No. 2529
 File No. 49-34 Drawing No. _____
 Date 10-5-54 Scale 1"=200'

STATE OF WEST VIRGINIA
 DEPARTMENT OF MINES
 OIL AND GAS DIVISION
 CHARLESTON

WELL LOCATION MAP
 FILE NO. LIN-1116-A

+ Denotes location of well on United States Topographic Maps, scale 1 to 62,500, latitude and longitude lines being represented by border lines as shown.

- Denotes one inch spaces on border line of original tracing.

JANE MILLER No. 4927 - U.F.G. Co. - LIN-1116-A



STATE OF WEST VIRGINIA
DEPARTMENT OF MINES
OIL AND GAS DIVISION

1452

Quadrangle Midciff

WELL RECORD

Permit No. 1116 A

Oil or Gas Well Gas
(KIND)

Company UNITED FUEL GAS CO.
Address P.O. Box 1273, Charleston 25, W. Va.
Farm Jane Miller Acres 10
Location (waters) Chaney Fork
Well No. 4927 Elev. 872'
District Carroll County Lincoln
The surface of tract is owned in fee by _____
Address _____
Mineral rights are owned by Joseph D. Miller
Address Hamlin, W. Va.
Drilling commenced 11-5-17
Drilling completed 11-30-17
Date Shot _____ From _____ To _____
With _____

Casing and Tubing	Used in Drilling	Left in Well	Packers
Size			Kind of Packer
16			
18			
10		20'	Size of
8 1/4			
6 5/8		1388'	Depth set
5 3/16			
3			Perf. top
2		1528'	Perf. bottom
Liners Used			Perf. top
			Perf. bottom

Open Flow _____ /10ths Water in _____ Inch
_____ /10ths Merc. in _____ Inch
Volume 1,759,680 Cu. Ft.
Rock Pressure 565 lbs. _____ hrs.
Oil _____ bbls., 1st 24 hrs.
Fresh water _____ feet _____ feet
Salt water _____ feet _____ feet

CASING CEMENTED _____ SIZE _____ No. Ft. _____ Date _____
COAL WAS ENCOUNTERED AT 300 FEET 48 INCHES
_____ FEET _____ INCHES FEET _____ INCHES
_____ FEET _____ INCHES FEET _____ INCHES

Formation	Color	Hard or Soft	Top	Bottom	Oil, Gas or Water	Depth Found	Remarks
Surface			0	7	Oil in Big	Line at 1456'	
Slate			7	192			
Sand			192	197			
Slate			197	200			
Sand			200	221			
Slate			221	300			
Coal			300	304			
Slate			304	330			
Sand			330	356			
Slate			356	386			
Sand			386	420			
Slate			420	488			
Sand			488	531			
Slate			531	540			
Sand			540	562			
Slate			562	678			
Sand			678				
Sand & Slate			678	774			
Salt Sand			774	981			
Slate			981	991			
Sand			991	1158			
Slate & Shells			1158	1194			
Sand			1194	1246			
Slate & Shells			1246	1260			
Red Rock			1260	1265			
Slate			1265	1300			
Red Rock			1300	1305			
Slate			1305	1320			
Maxon Sand			1320	1355			
Slate			1355	1358			
Little Lime			1358	1381			
Pencil Cave			1381	1383			
Big Lime			1383	1453			
Slate			1453	1456			
Lime			1456	1564			
Red Rock			1564	1574			
Injun Sand			1574	1614'6"			
Total depth			1628'				

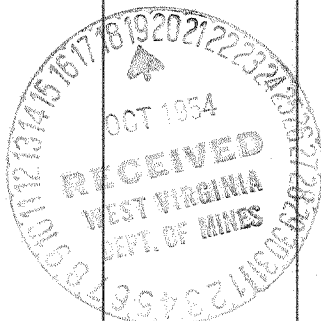
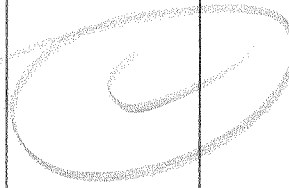

APR 22 1955

