

Latitude 38° 15'

Longitude 82° 05'

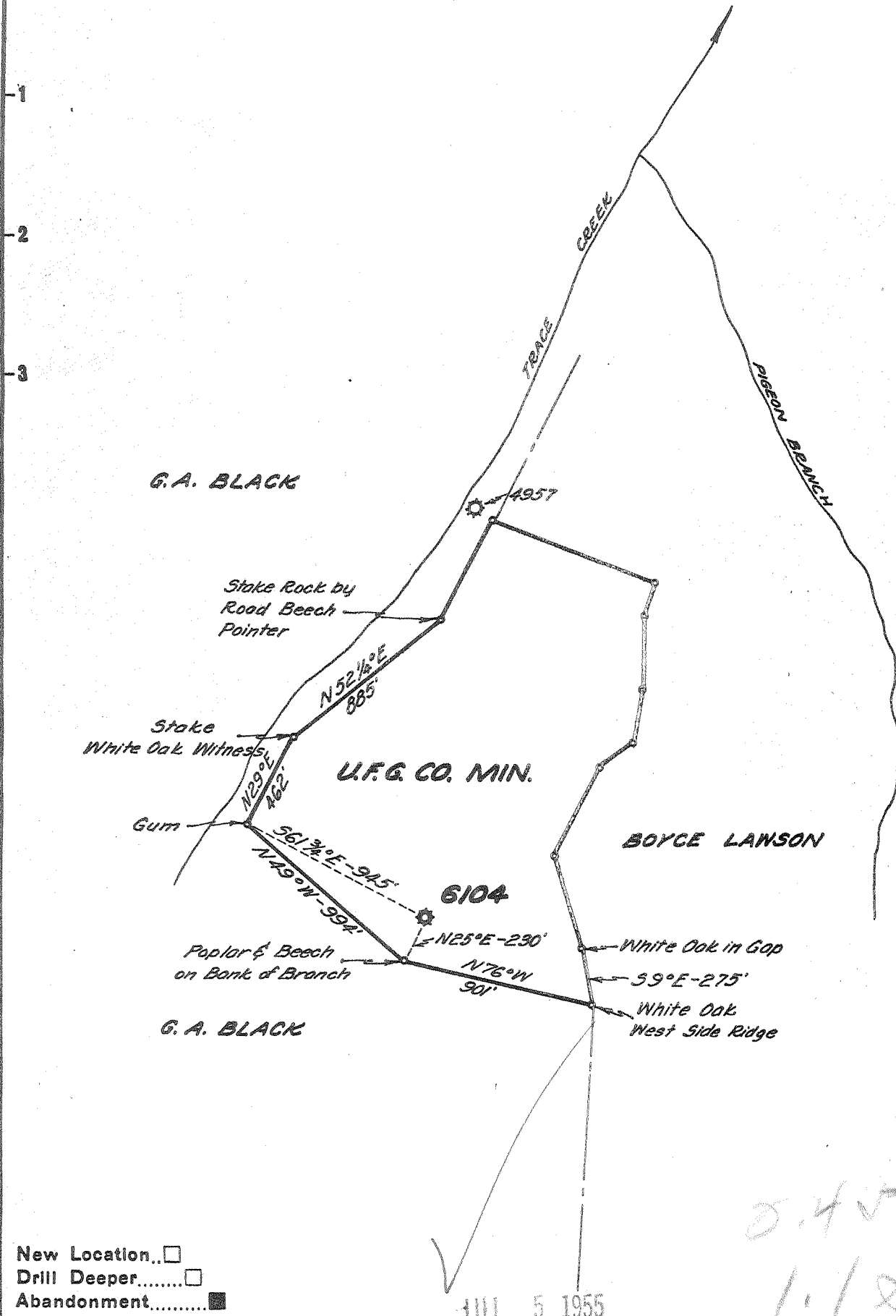

- New Location...
- Drill Deeper.....
- Abandonment.....

JUL 5 1955

0.45 W  
1.1 2

Company UNITED FUEL GAS CO.  
 Address CHARLESTON, W. VA.  
 Farm UNITED FUEL GAS CO. MIN.  
 Tract 29 Acres 1540.25 Lease No. No REF.  
 Well (Farm) No. \_\_\_\_\_ Serial No. 6104  
 Elevation (Spirit Level) 917.40  
 Quadrangle MIDKIFF  
 County LINCOLN District CARROLL  
 Engineer Hubert R. Howell  
 Engineer's Registration No. 2529  
 File No. 36-51 Drawing No. \_\_\_\_\_  
 Date 5-25-55 Scale 1" = 660'

STATE OF WEST VIRGINIA  
 DEPARTMENT OF MINES  
 OIL AND GAS DIVISION  
 CHARLESTON

WELL LOCATION MAP  
 FILE NO. LIN-1169-A

+ Denotes location of well on United States Topographic Maps, scale 1 to 62,500, latitude and longitude lines being represented by border lines as shown.

- Denotes one inch spaces on border line of original tracing.



STATE OF WEST VIRGINIA  
DEPARTMENT OF MINES  
OIL AND GAS DIVISION

1466

WELL RECORD

Quadrangle Midkiff

Permit No. \_\_\_\_\_

Oil or Gas Well Gas  
(KIND)

Company UNITED FUEL GAS CO.  
Address P.O. Box 1273, Charleston 25, W. Va.  
Farm U.F.G.Co. Min. Tr. #29 Acres 1540.96  
Location (waters) Trace Creek  
Well No. 6104 Elev. 917.40'  
District Carroll County Lincoln  
The surface of tract is owned in fee by \_\_\_\_\_  
Address \_\_\_\_\_  
Mineral rights are owned by United Fuel Gas Co.  
Address Charleston, W.Va.  
Drilling commenced \_\_\_\_\_  
Drilling completed 6-18-23  
Date Shot \_\_\_\_\_ From \_\_\_\_\_ To \_\_\_\_\_  
With \_\_\_\_\_  
Open Flow 6 /10ths Water in 2 Inch  
\_\_\_\_\_ /10ths Merc. in \_\_\_\_\_ Inch  
Volume 103,000 Cu. Ft.  
Rock Pressure \_\_\_\_\_ lbs. \_\_\_\_\_ hrs.  
Oil \_\_\_\_\_ bbls., 1st 24 hrs.  
Fresh water \_\_\_\_\_ feet \_\_\_\_\_ feet  
Salt water \_\_\_\_\_ feet \_\_\_\_\_ feet

Casing and Tubing	Used in Drilling	Left in Well	Packers
Size			Kind of Packer
16			
13			
10		<u>20'</u>	Size of _____
8 1/4			
6 3/8		<u>1520'</u>	Depth set _____
5 3/16			
3			Perf. top _____
2		<u>2249'</u>	Perf. bottom _____
Liners Used			Perf. top _____
			Perf. bottom _____

CASING CEMENTED \_\_\_\_\_ SIZE \_\_\_\_\_ No. Ft. \_\_\_\_\_ Date \_\_\_\_\_

COAL WAS ENCOUNTERED AT \_\_\_\_\_ FEET \_\_\_\_\_ INCHES  
\_\_\_\_\_ FEET \_\_\_\_\_ INCHES \_\_\_\_\_ FEET \_\_\_\_\_ INCHES  
\_\_\_\_\_ FEET \_\_\_\_\_ INCHES \_\_\_\_\_ FEET \_\_\_\_\_ INCHES

Formation	Color	Hard or Soft	Top	Bottom	Oil, Gas or Water	Depth Found	Remarks
Red Rock				50	Gas from Berea		
Slate			50	130			
Sand			130	150			
Slate			150	250			
Sand			250	310			
Slate			310	350			
Sand			350	450			
Slate			450	500			
Sand			500	575			
Slate			575	630			
Sand			630	680			
Slate			680	700			
Sand			700	790			
Slate			790	820			
Sand			820	870			
Shell			870	900			
Salt Sand			900	1400			
Slate			1400	1430			
Maxon Sand			1430	1440			
Slate			1440	1460			
Little Lime			1460	1492			
Pencil Cave			1492	1500			
Big Lime			1500	1680			
Red Rock			1680	1692			
Injun Sand			1692	1715			
Slate & Shells			1715	1885			
Lime			1885	1950			
Slate Shells			1950	2198			
B. Shell			2198	2209			
Berea Sand			2209	2228			
Total depth			2249'				

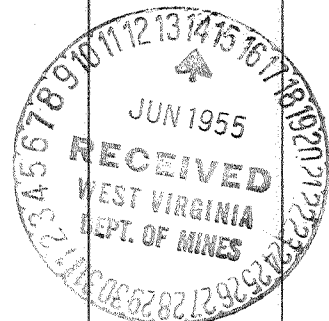

OCT 6 1955

