

Latitud 38° 15'

Longitude 82° 10'

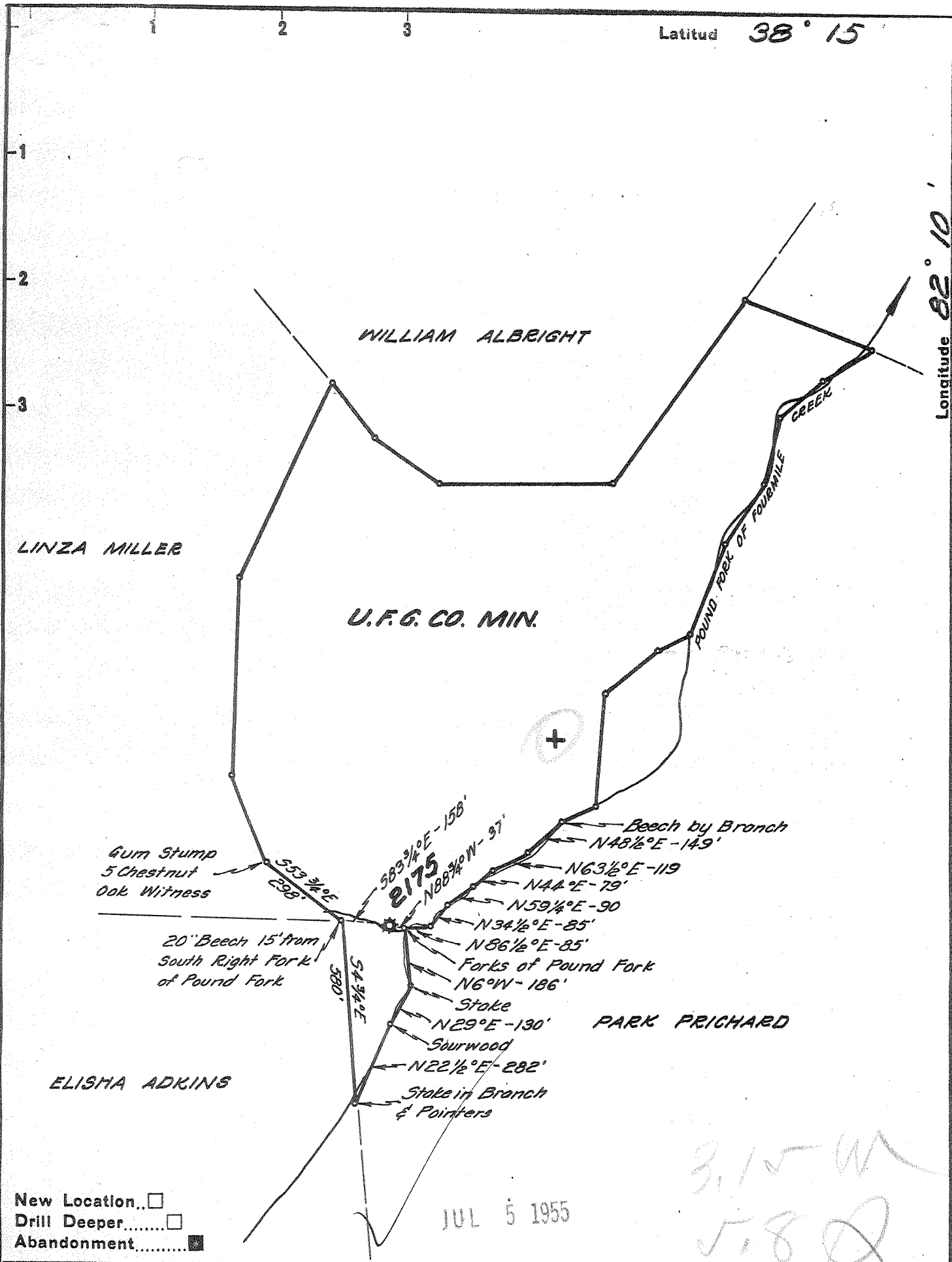

| | |
|-----------------------------|---|
| Company | <u>UNITED FUEL GAS CO.</u> |
| Address | <u>CHARLESTON, W. VA.</u> |
| Farm | <u>UNITED FUEL GAS CO. MIN.</u> |
| Tract | <u>1</u> Acres <u>20,293.44</u> Lease No. <u>Ref. 24689</u> |
| Well (Farm) No. | Serial No. <u>2175</u> |
| Elevation (Spirit Level) | <u>807.0</u> |
| Quadrangle | <u>MIDKIFF</u> |
| County | <u>LINCOLN</u> District <u>LAUREL HILL</u> |
| Engineer | <u>Seibert R. Russell</u> |
| Engineer's Registration No. | <u>2529</u> |
| File No. | <u>28-45</u> Drawing No. _____ |
| Date | <u>5-26-55</u> Scale <u>1"=400"</u> |

STATE OF WEST VIRGINIA
 DEPARTMENT OF MINES
 OIL AND GAS DIVISION
 CHARLESTON

WELL LOCATION MAP
 FILE NO. LIN-1172-A

+ Denotes location of well on United States Topographic Maps, scale 1 to 62,500, latitude and longitude lines being represented by border lines as shown.

- Denotes one inch spaces on border line of original tracing.



STATE OF WEST VIRGINIA
DEPARTMENT OF MINES
OIL AND GAS DIVISION

1453

Quadrangle Midkiff

WELL RECORD

Oil or Gas Well Gas

(KIND)

Permit No. _____

Company UNITED FUEL GAS CO.

Address P.O. Box 1273, Charleston 25, W. Va.

Farm U.F.G.Co. Min. Tr. #1 Acres 24,293.44

Location (waters) Fourmile Ck.

Well No. 2175 Elev. 807'

District Laurel Hill County Lincoln

The surface of tract is owned in fee by _____

Address _____

Mineral rights are owned by United Fuel Gas Co.

Address Charleston, W. Va.

Drilling commenced 7-12-13

Drilling completed 8-6-13

Date Shot From 1460 To 1472

With 60 qts.

Open Flow 24 /10ths Water in _____ Inch

2 /10ths Merc. in _____ Inch

Volume 859,000 Cu. Ft.

Rock Pressure 495 lbs. 16 hrs.

Oil _____ bbls., 1st 24 hrs.

Fresh water _____ feet

Salt water _____ feet

| Casing and Tubing | Used in Drilling | Left in Well | Packers |
|-------------------|------------------|--------------|----------------|
| Size | | | Kind of Packer |
| 16 | | | |
| 13 | | | |
| 10 | | 13' | Size of |
| 8 1/4 | 180' | | |
| 6 5/8 | | 1213' | Depth set |
| 5 3/16 | | | |
| 3 | | | Perf. top |
| 2 | 1569 | 1569 | Perf. bottom |
| Liners Used | | | Perf. top |
| | | | Perf. bottom |

CASING CEMENTED _____ SIZE _____ No. Ft. _____ Date _____

COAL WAS ENCOUNTERED AT 76 FEET 80 FEET 48 INCHES

160 FEET _____ INCHES FEET _____ INCHES

FEET _____ INCHES FEET _____ INCHES

| Formation | Color | Hard or Soft | Top | Bottom | Oil, Gas or Water | Depth Found | Remarks |
|---------------|-------|--------------|-------|--------|--------------------|-------------|---------|
| Coal | | | 76 | 80 | | | |
| Coal | | | 160 | 165 | | | |
| 1st Salt Sand | | | 710 | 1010 | Gas 1455', 1474'. | | |
| Little Lime | | | 1159 | 1180 | | | |
| Pencil Cave | | | 1180 | 1209 | Made 24/10 M in 2" | | |
| Big Lime | | | 1209 | 1426 | | | |
| Big Injun | | | 1455 | 1492 | | | |
| Total depth | | | 1543' | | | | |

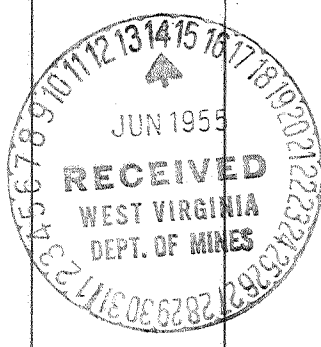

OCT 6 1955

(Over)

