

Latitude 38° 15' N

Longitude 82° 05' W

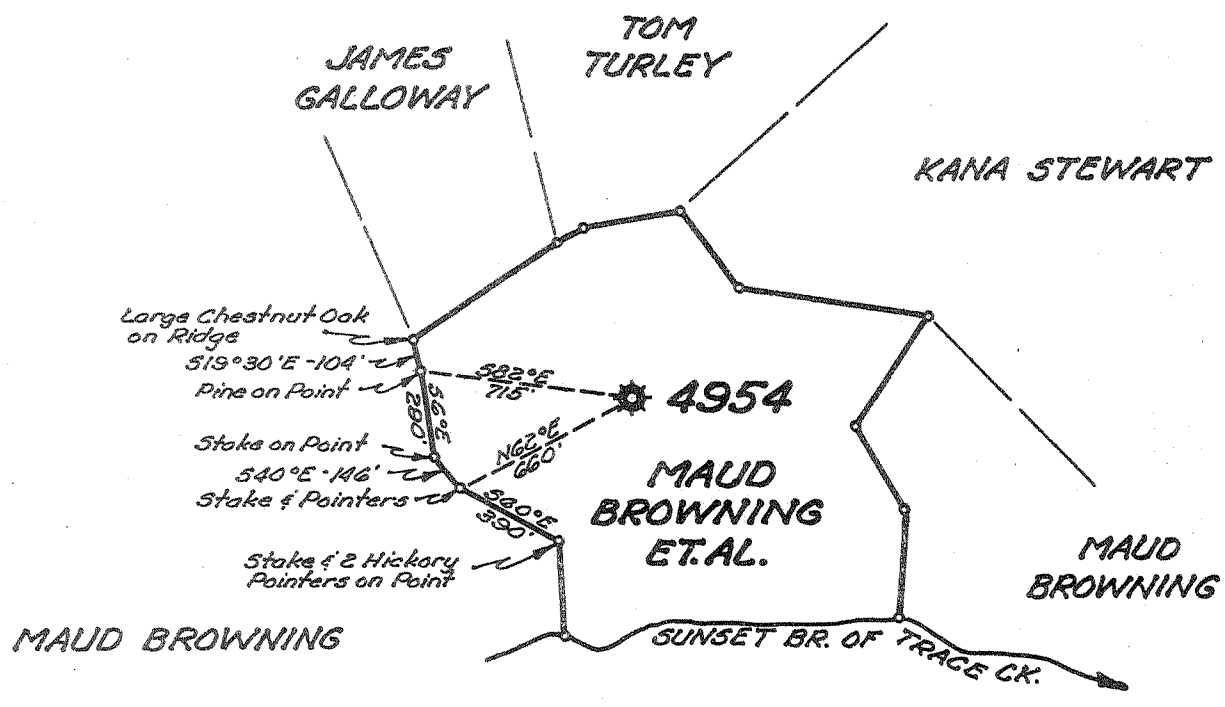

New Location
 Drill Deeper
 Abandonment

JUL 5 1955

0.15 W
0.05 Q

Company UNITED FUEL GAS CO.
 Address CHARLESTON W. VA.
 Farm MAUD BROWNING ET AL.
 Tract _____ Acres 42.5 Lease No. 43396
 Well (Farm) No. _____ Serial No. 4954
 Elevation (Spirit Level) 861.0'
 Quadrangle MIDKIFF
 County LINCOLN District CARROLL
 Engineer Paul E. Joachim
 Engineer's Registration No. 669
 File No. 36-51 Drawing No. _____
 Date 5-24-55 Scale 1" = 660'

STATE OF WEST VIRGINIA
 DEPARTMENT OF MINES
 OIL AND GAS DIVISION
 CHARLESTON

WELL LOCATION MAP
 FILE NO. LIN-1180-A

+ Denotes location of well on United States Topographic Maps, scale 1 to 62,500, latitude and longitude lines being represented by border lines as shown.

- Denotes one inch spaces on border line of original tracing.

1180A

Carroll District, Lincoln County, W. Va.
 By Kanawha Gas & Utilities Co., Charleston, W. Va.
 On 42.5 acres, waters of Trace Creek of Mud River; surface and
 mineral rights owned by Maude Browning et al., Hamlin, W. Va.
 Elevation, 880' L.
 8 1/2" casing, 64'; 5-3/16", 1170'.
 No coal was encountered. No liners used.
 Drilling completed Feb. 14, 1925.
 "The above well was drilled by another company and later acquired
 by the Kanawha Gas & Utilities. Due to that fact, we can not
 vouch for its authenticity."
 Well was shot at 2175-2195'.
 No record of water.
 Gas well.
 Abandonment report to Dept. of Mines not dated; filed, 1932?

	Top.	Bottom.	Thickness.
Surface	0	- 20	20
Slate	20	- 65	45
Sand	65	- 85	20
Slate	85	- 125	40
Sand	125	- 200	75
Slate	200	- 225	25
Sand	225	- 350	25
Slate	350	- 400	50
Sand	400	- 475	75
Slate	475	- 550	75
Sand	550	- 760	210
Slate	760	- 775	15
Sand	775	- 850	75
Slate	850	- 930	80
Salt Sand	930	- 1350	420
Slate	1350	- 1355	5
Maxton Sand	1355	- 1421	66
Little Lime	1421	- 1466	45
Pencil Cave	1466	- 1481	15
Big Lime	1481	- 1671	190
Keener Sand (Red rock)	1671	- 1665?	
Big Injun Sand	1665?	- 1700	
Slate	1700	- 1880	180
Shell	1880	- 1930	50
Slate	1930	- 2175	221
Berea Sand, to bottom	2175	- 2195	20



STATE OF WEST VIRGINIA
DEPARTMENT OF MINES
OIL AND GAS DIVISION

14919

22

WELL RECORD

Quadrangle Midkiff

Permit No. 1180-A

Oil or Gas Well Gas
(KIND)

Company UNITED FUEL GAS CO.
Address P.O. Box 1273, Charleston 25, W. Va.
Farm Maud Browning, et al Acres 42½
Location (waters) Sunset Branch
Well No. 4954 Elev. 861'
District Carroll County Lincoln

The surface of tract is owned in fee by _____
Address _____
Mineral rights are owned by T.E. Tincher, et al
Rt. 3 Address Hurricanes, W. Va.

Drilling commenced 1-7-25
Drilling completed 2-14-25
Date Shot From 2177 To 2193'
With 40 cts.

Open Flow /10ths Water in _____ Inch
/10ths Merc. in _____ Inch
Volume 200,000 Cu. Ft.
Rock Pressure _____ lbs. _____ hrs.
Oil _____ bbls., 1st 24 hrs.
Fresh water _____ feet _____ feet
Salt water _____ feet _____ feet

Casing and Tubing	Used in Drilling	Left in Well	Packers
Size			Kind of Packer
16			
18			
10			Size of
8½		<u>6¼'</u>	
6¾			Depth set
5 3/16		<u>1770'</u>	
3			Perf. top
2		<u>2195'</u>	Perf. bottom
Liners Used			Perf. top
			Perf. bottom

CASING CEMENTED _____ SIZE _____ No. Ft. _____ Date _____

COAL WAS ENCOUNTERED AT _____ FEET _____ INCHES
_____ FEET _____ INCHES _____ FEET _____ INCHES
_____ FEET _____ INCHES _____ FEET _____ INCHES

Formation	Color	Hard or Soft	Top	Bottom	Oil, Gas or Water	Depth Found	Remarks
Surface			0	20			
Slate			20	65			
Sand			65	85			
Slate			85	125			
Sand			125	200			
Slate			200	225			
Sand			225	350			
Slate			350	400			
Sand			400	475			
Slate			475	550			
Sand			550	760			
Slate			760	775			
Sand			775	850			
Slate			850	930			
Salt Sand			930	1350			
Slate			1350	1355			
Maxon Sand			1355	142			
Little Lime			1421	1466			
Pencil Cave			1466	1481			
Big Lime			1481	1665			
Red Rock			1665	1671			
Injun Sand			1671	1700			
Slate			1700	1880			
Shell			1880	1930			
Slate			1954	2175			
Berea Sand			2175	2195			
Total depth			2195'				

JUN 1955
RECEIVED
WEST VIRGINIA
DEPT. OF MINES

AUG 12 1955

