

Latitude 38° 20'

Longitude 82° 00'

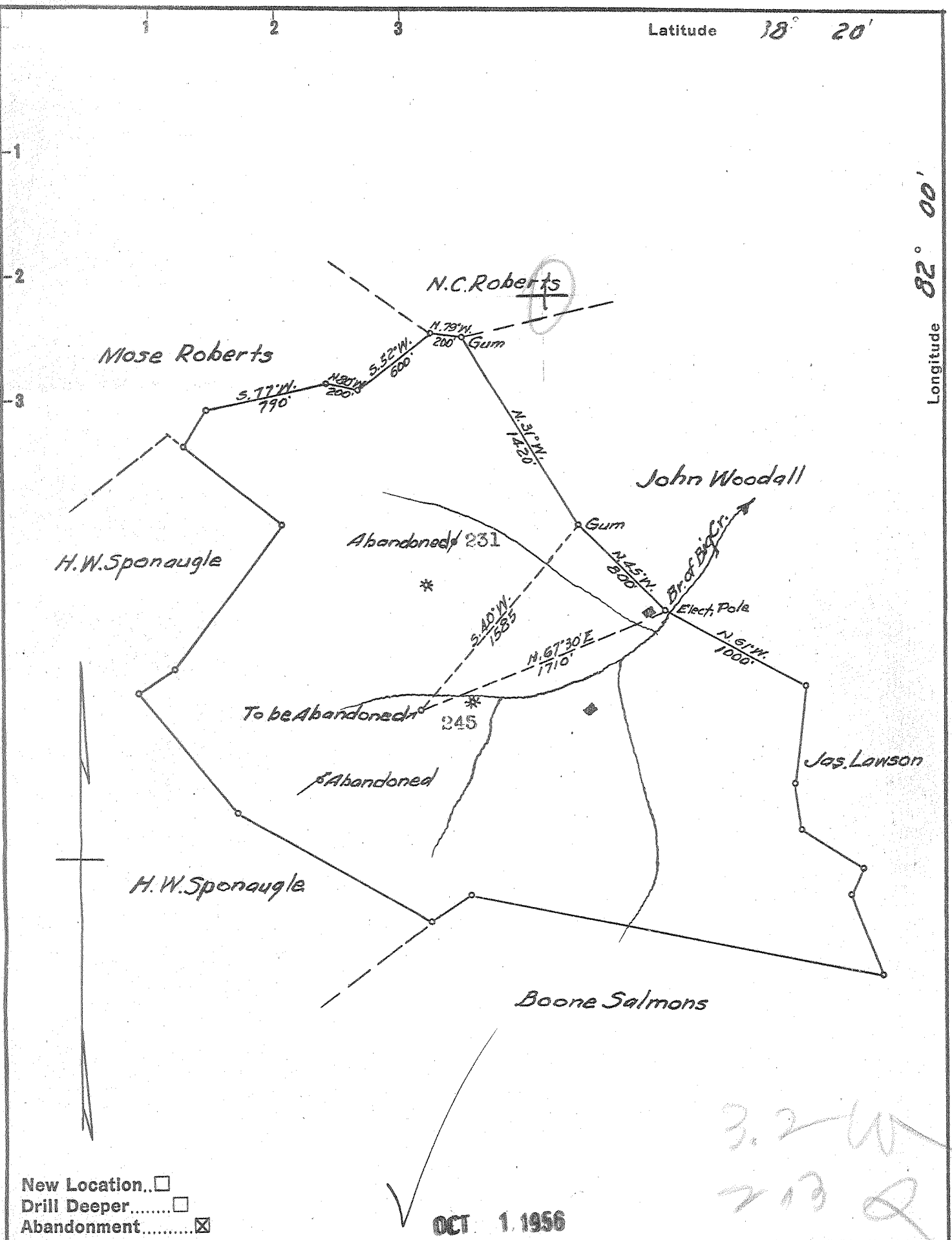

New Location..
 Drill Deeper.....
 Abandonment.....

OCT. 1. 1956

3.2 W
 213 Q

Company GUY L. MEABON
 Address HUNTINGTON, W.VA.
 Farm LEE DENT
 Tract _____ Acres 166 Lease No. _____
 Well (Farm) No. 245 Serial No. _____
 Elevation (Spirit Level) 800±
 Quadrangle MILTON
 County LINCOLN District CARROLL
 Engineer G. E. Gwing
 Engineer's Registration No. 309
 File No. _____ Drawing No. _____
 Date 7-30-56 Scale 1"=800'

STATE OF WEST VIRGINIA
 DEPARTMENT OF MINES
 OIL AND GAS DIVISION
 CHARLESTON

WELL LOCATION MAP
 FILE NO. LIN-1235-A

+ Denotes location of well on United States Topographic Maps, scale 1 to 62,500, latitude and longitude lines being represented by border lines as shown.
 - Denotes one inch spaces on border line of original tracing.

LEE DENT No. 245 - GUY L. MEABON - LIN-1235-A