

Latitude 38° 15'

Longitude 82° 10'

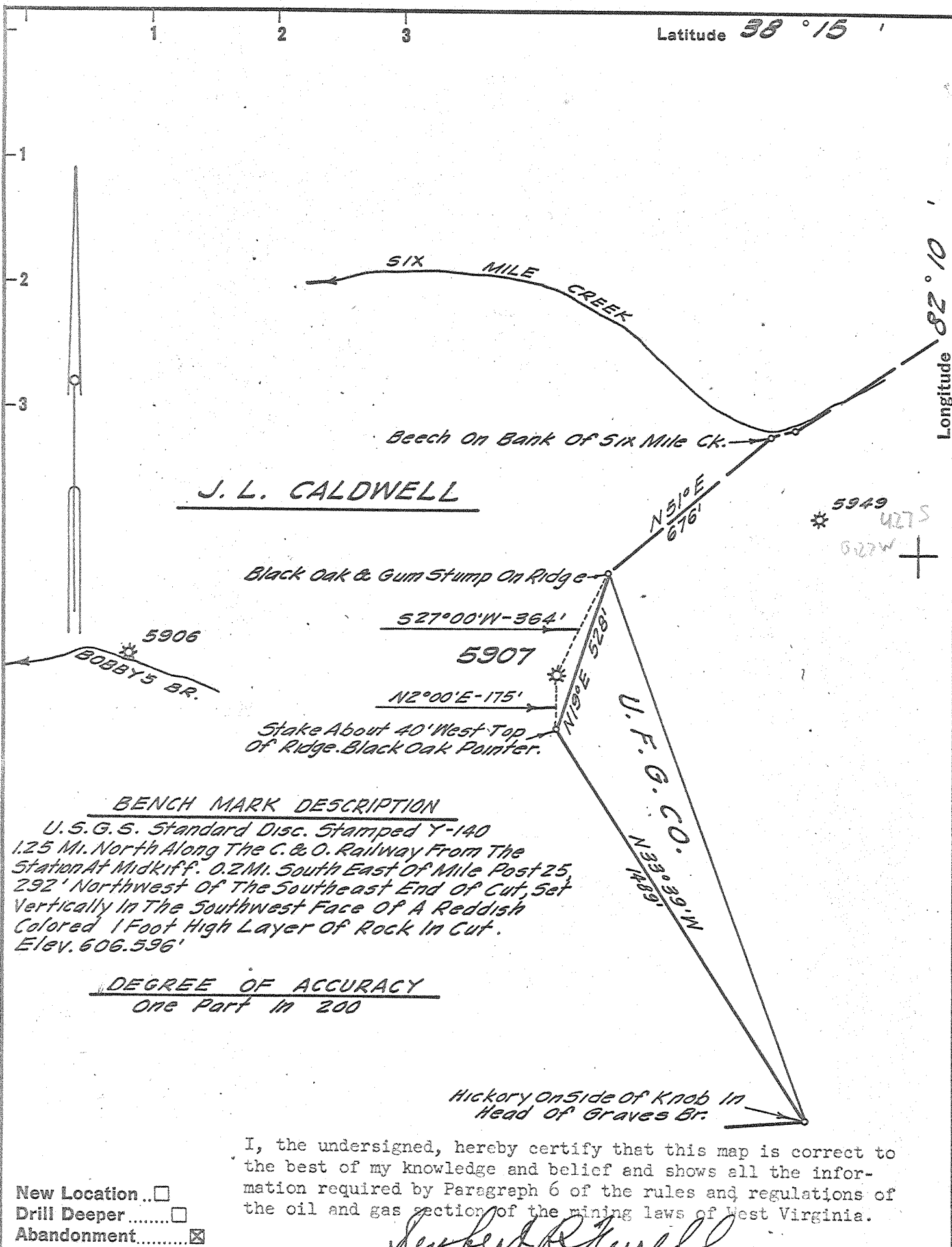

DEGREE OF ACCURACY
One Part In 200

New Location...
Drill Deeper.....
Abandonment.....

Company UNITED FUEL GAS CO.
 Address CHARLESTON, W. VA.
 Farm J. L. CALDWELL
 Tract _____ Acres 913 Lease No. 45190
 Well (Farm) No. 35 Serial No. 5907
 Elevation (Spirit Level) 975.89'
 Quadrangle MIDKIFF - NW
 County LINCOLN District LAUREL HILL
 Engineer Seybert R. Howell
 Engineer's Registration No. 2529
 File No. 32-47 Drawing No. _____
 Date SEPT. 10, 1925 Scale 1" = 400'

STATE OF WEST VIRGINIA
DEPARTMENT OF MINES
OIL AND GAS DIVISION
CHARLESTON

WELL LOCATION MAP
FILE NO. 32-47-1315-A

+ Denotes location of well on United States Topographic Maps, scale 1 to 62,500, latitude and longitude lines being represented by border lines as shown.
- Denotes one inch spaces on border line of original tracing.