

Latitude $38^{\circ} 15'$

Longitude $82^{\circ} 05'$

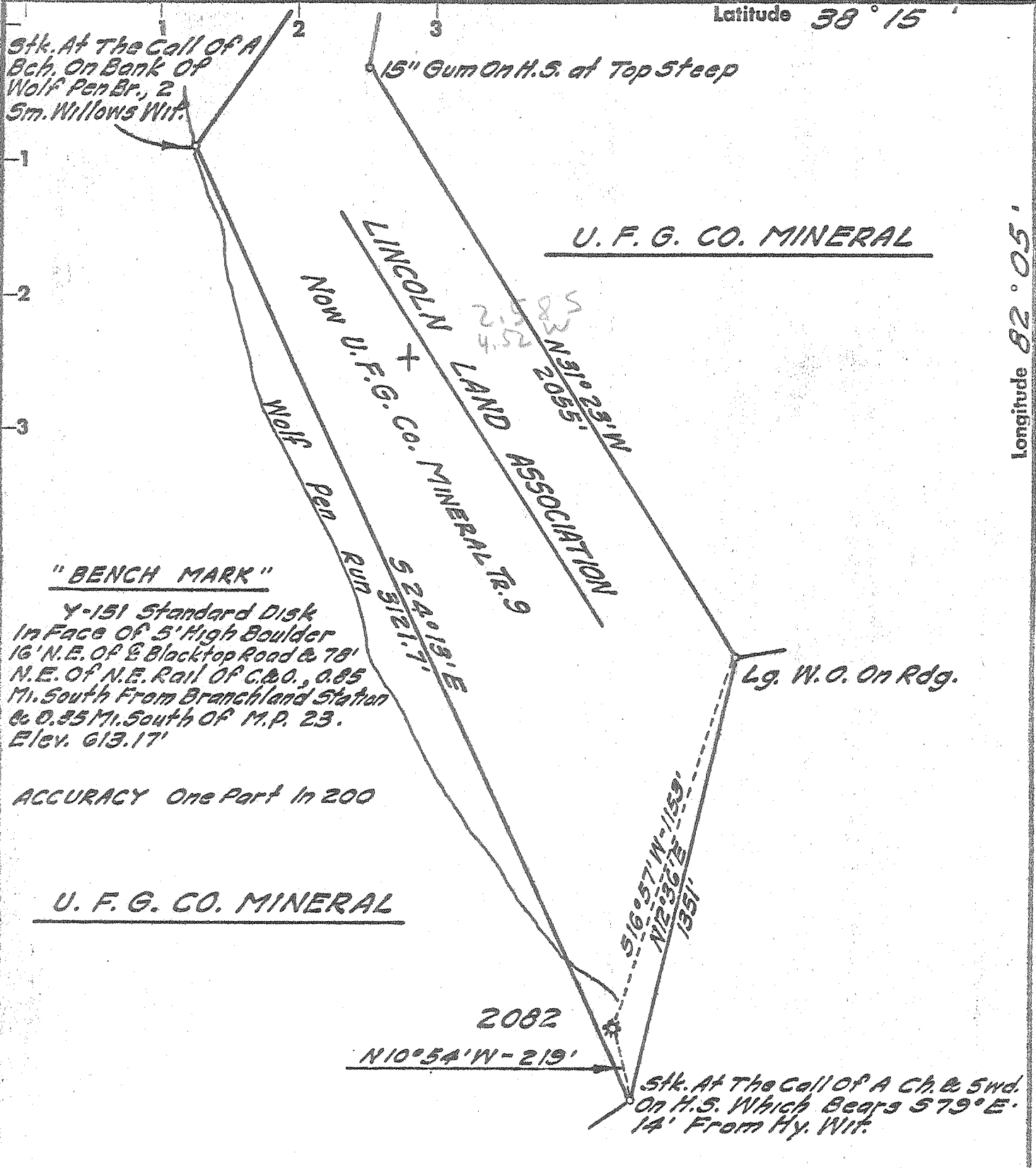

U. F. G. CO. MINERAL

LINCOLN LAND ASSOCIATION
 NOW D. F. G. CO. MINERAL TR. 9

WOLF PEN RUN

"BENCH MARK"

Y-151 Standard Disk
 In Face of 5' High Boulder
 16' N.E. of Blacktop Road & 78'
 N.E. of N.E. Rail of C.&O., 0.85
 Mi. South from Branchland Station
 & 0.35 Mi. South of M.P. 23.
 Elev. 613.17'

ACCURACY One Part In 200

U. F. G. CO. MINERAL

- Fracture Before 6/5/29
- New Location
- Drill Deeper
- Redrill
- Abandonment

I, the undersigned, hereby certify that this map is correct to the best of my knowledge and belief and shows all the information required by Paragraph 5 of the Rules and Regulations of the Oil and Gas Section of the Mining Laws of West Virginia.
 The accuracy of this survey is within the limits and as prescribed in Paragraph 5 by the Oil and Gas Division of the Department of Mines Regulations.

Company UNITED FUEL GAS CO.
 Address CHARLESTON, W. VA.
 Farm LINCOLN LAND ASSOCIATION
 Tract Acres 1371.07 REF. No. 24690
 Well (Farm) No. 2082 Serial No. 2082
 Elevation (Spirit Level) 805.54'
 Quadrangle MIDKIFF NC
 County LINCOLN District SHERIDAN
 Engineer William E. Sandman
 Engineer's Registration No. 2330
 File No. 32-49 Drawing No.
 Date MAR. 10, '71 Scale 1" = 400'

STATE OF WEST VIRGINIA
 DEPARTMENT OF MINES
 OIL AND GAS DIVISION
 CHARLESTON

WELL LOCATION MAP
 FILE NO. Lin-1358 (A)

+ Denotes location of well on United States Topographic Maps, scale 1 to 62,500 latitude and longitude lines being represented by border lines as shown.
 - Denotes one inch spaces on border line of original tracing.