

Latitude 37° 55'
37.55

Longitude 82° 05'
82.05

HUNTINGTON DEVELOPMENT & GAS CO.

ISLAND CREEK COAL CO.

ALTIZER & LAWSON 1000.62 AC. FEE TRACT

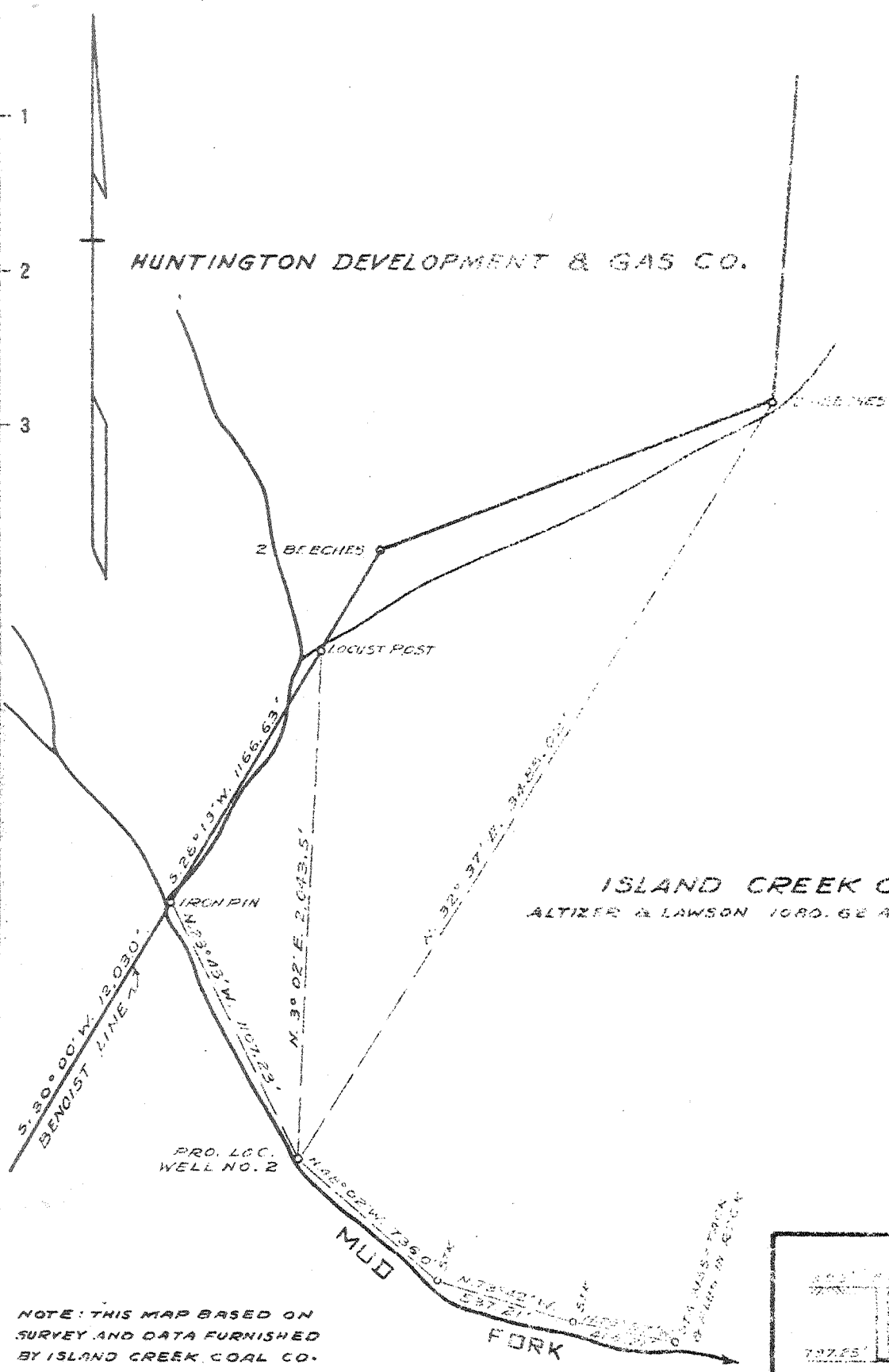

1.19 W.
3.56 S.
5 EC (4-3)

NOTE: THIS MAP BASED ON SURVEY AND DATA FURNISHED BY ISLAND CREEK COAL CO.

New Location X
Drill Deeper
Abandonment

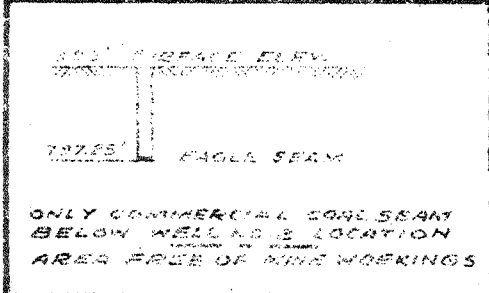

Company COLUMBIAN CARBON CO.
 Address BOX 873 CHARLESTON W.VA.
 Farm ISLAND CREEK COAL CO.
 Tract _____ Acres 30,380 Lease No. _____
 Well (Farm) No. 2 Serial No. GM-747
 Elevation (Spirit Level) 893
 Quadrangle HOLDEN S.E. 5-C
 County LOGAN District LOGAN
 Engineer J.M. Lee
 Engineer's Registration No. 772
 File No. _____ Drawing No. 264
 Date APRIL 7, 1944 Scale 1" = 600'

STATE OF WEST VIRGINIA
DEPARTMENT OF MINES
OIL AND GAS DIVISION
CHARLESTON

WELL LOCATION MAP
FILE NO. 406-105

+ Denotes location of well on United States Topographic Maps, scale 1 to 62,500. Latitude and longitude lines being represented by border lines as shown.
 - Denotes one inch spaces on border line of original tracing.

6-6 274

Deep well

WEST VIRGINIA DEPARTMENT OF MINES
OIL & GAS DIVISION
W E L L R E C O R D

Permit No. Log 105

Gas Well
CASING & TUBING

Holden Quad.	Columbian Carbon Company	13 48# 22'6 22'6
Company	Box 873, Charleston 23, W.Va.	10 1/2 32.75 367'5 Same
Address	Island Creek Coal Co. A-30, 380	8 1/2 28# 1227'1 Pulled
Farm	Mud Fork	7 23# 1561'1 Same
Location	2 (GW- 747) Elev. 897.1 DF	2 3/8 4# 3565'8 Same
Well No	Logan Logan County	3560' of 7" hole had 2'
District	Island Creek Coal Co. Box 2187,	syphon line
Surface	Huntington W.Va.	
Mineral	Same	
Commenced	4-23-44	Midget Bottom Hole Pack-
Completed	7-17-44	er
Date shot	7-19-44 Depth 3560 to 3260' with	
	2150# Gelatin 32 - 4 1/2 x 10' shells	
Volume	158,000 C.F.	Coal at 90' 48"
Rock Pressure	365 lbs. 40 hrs.	
Oil	760' show	
Fresh Water	30' H.F.	
Salt Water	737' 3-10" blrs.; 895' H.F.; 1325' H.F.	

Clay	0	10	CEMENT RECORD: 5-1-44 10 1/2" casing.
Quick Sand	10	20	Ran 125 bags Green Bay Cement.
Sand	20	40	8 sacks Aquagel and 2 bales
Slate	40	90	Fibrotex. No circulation.
Coal - <i>Engle</i>	90	94	
Sand	94	160	5-29-44 8 5/8" casing with steel
Slate	160	240	shoe on bottom. Ran 25 sacks
Sand	240	270	aquagel and 2 bales Fibrotex.
Slate & Shells	270	303	Circulation and returns while
Sand 360' DLM -- 364' SLM	303	400	mixing.
Slate & Shells	400	450	
Sand	450	800	6-7-44 7" casing. Ran 16 sacks
Slate	800	825	aquagel and 50# Fibrotex. Cir-
Sand	825	907	ulation while mixing. Returns
Slate	907	915	275'.
Sand	915	935	
Slate	935	955	Delbert Lawson, cementer,
Sand	955	1055	C.C. Co. Crew
Slate	1055	1077	
Sand	1077	1095	
Slate	1095	1118	
Bed Rock	1118	1176	
Lime	1176	1205	
Sand 1215' DLM -- 1216' SLM	1205	1225	
Slate	1225	1285	
Red Rock	1285	1260	
Slate & Shells	1260	1285	
Sand	1285	1365	
Slate	1365	1375	
Lime	1375	1432	
Sand	1432	1476	
Slate	1476	1479	
Lime	1479	1520	
Big Lime	1520	1707	
Big Injun Sand	1707	1735	
Slate	1735	1738	
Lime	1738	1971	
Slate & Shells	1971	2250	
Shale - <i>Dark</i>	2250	2285	
Black Lime	2285	2324	
Slate & Shells	2324	2265	
Brown Shale	3255	3287	
Lime	3287	3305	
Brown Shale	3305	3546	
White Slate	3546	3870	
Brown Shale	3870	4018	
Lime - <i>461</i>	4018	4022 SLM	PAYS: 1690-1693' - 3121
TOTAL DEPTH		4022 SLM	Oil 760' Show

4018
897

461