

Latitude 37 50

3.57 W.
1.02 S.
7 NW (L-3)

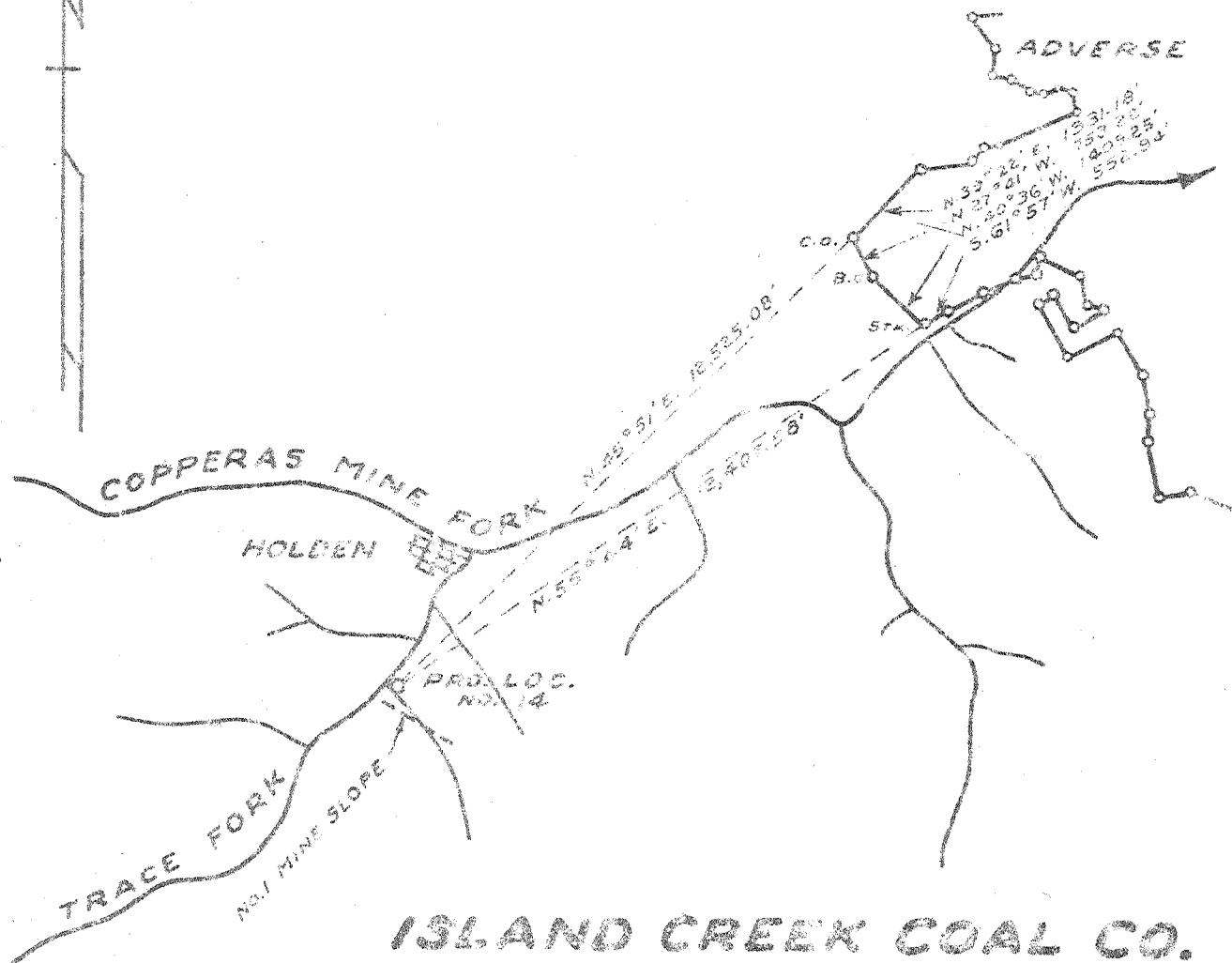

Longitude 82 00

ISLAND CREEK COAL CO.
WATSON-HUTCHINSON 3071.63 AC.
4 FEET

797 SURFACE ELEV.	
750	ISLAND CK.
715	DRAPER
572	EAGLE
COMMERCIAL COAL SEAMS BELOW PRO. LOCATION NO. 14	

REVISED PLAT

- New Location
- Drill Deeper
- Abandonment

THIS MAP BASED ON SURVEY AND DATA FURNISHED BY THE ISLAND CREEK COAL CO

Company COLUMBIAN CARBON CO.
 Address BOX 873 CHARLESTON, W. VA.
 Farm ISLAND CREEK COAL CO.
 Tract _____ Acres 34953.47 Lease No. C-2448
 Well (Farm) No. 14 Serial No. GW-789
 Elevation (Spirit Level) 797.0
 Quadrangle HOLDEN'S. E. 7 S. 105 W. 353
 County LOGAN District LOGAN
 Engineer C. A. Branham
 Engineer's Registration No. 683
 File No. _____ Drawing No. WA-45
 Date JAN. 27, 1945 Scale 1" = 3600'

STATE OF WEST VIRGINIA
DEPARTMENT OF MINES
OIL AND GAS DIVISION
CHARLESTON

WELL LOCATION MAP
FILE NO. LOG-125

- + Denotes location of well on United States Topographic Maps, scale 1 to 62,500, latitude and longitude lines being represented by border lines as shown.
- Denotes one inch spaces on border line of original tracing.

Samples 11-F (1753 - 3/27) 3-0 274 Deep Well

WEST VIRGINIA DEPARTMENT OF MINES
OIL & GAS DIVISION
W E L L R E C O R D

Permit No. Log 125
Holden S.E. Quad.
Company
Address
Farm
Location
Well No.
District
Surface

Mineral
Commenced
Completed
Not shot
Volume
Fresh Water
Salt Water

Columbian Carbon Company
Box 873, Charleston 23, W.Va.
Island Creek Coal Co Acres 34,953
Trace Fork
14 (GW-789) Elev. 797' G
Logan Logan County
Island Creek Coal Co.,
Guaranty Bank Bldg., Huntington, W.Va.
Same
4-7-45
6-11-45

Not enough to gauge
44'; 133'
918'; 1248-60' H.F.; 1650' show

Dry Hole
CASING & TUBING

	16	27'2	27'2	
	10 $\frac{3}{4}$	32.75	264'10	Sm.
	8 $\frac{1}{2}$	24#	1339'9	Pld.
	7	22#	1846'11	Sm.
	Coal at 44' 60"; 226' 48"			

Slate	0	44
Coal <i>cedar</i>	44	49
Sand	49	160
Gray Slate	160	226
Coal <i>EAGLE</i>	226	230
Slate	230	245
Gray Sand	245	263
Sand	263	278
Slate & Shells	278	357
Sand	357	439
Slate	439	450
Sand	450	485
Slate	485	514
Slate & Shells	514	619
Sand	619	713
Salt Sand	713	820
Slate & Shells	820	832
Lime	832	846
Sand	846	919
Slate & Shells	919	962
Lime	962	970
Slate	970	1000
Salt Sand	1000	1088
Slate	1088	1100
Salt Sand	1100	1165
Slate	1165	1172
Lime	1172	1190
Shale	1190	1197
Salt Sand	1197	1277
Slate	1277	1353
Lime	1353	1363
Red Rock & Shells	1363	1467
Slate & Shells	1467	1497
Red Rock	1497	1527
Slate & Shells	1527	1560
Lime	1560	1574
Limey Sand	1574	1610
Sand	1610	1628
Slate & Shells	1628	1638
Sand	1638	1690
Slate	1690	1698
Slate & Shells	1698	1753
Dark Lime	1753	1793
Lime	1793	1798
Pencil Cave	1798	1800
Lime	1800	1848
Big Lime	1848	2063
Red Injun - <i>Maccland</i>	2063	2112
Gray Injun	2112	2225
Slate & Shells	2225	2483
Lime	2483	2518
Slate & Shells	2518	2560
Brown Shale	2560	2585
Berea Sand	2585	2597

Lime	2597	2611
Slate & Shells	2611	3350
Hard Lime	3350	3400
Slate & Shells	3400	3580
Brown Shale	3580	3910
Gray Shale	3910	3958
Slate & Shells	3958	4387
Corniferous Lime	4387	4402
TOTAL DEPTH		4402 DLM
Not enough gas to burn in 1"		

CEMENT RECORD:

4-12-45 10 $\frac{3}{4}$ " casing. Ran 110 sacks cement- did not circulate.

5-2-45 8 5/8" casing. Ran 16 bags Aquagel and 1 bale Fibrotex. Good returns.

5-11-45 7" casing . Ran 13 sacks Aquagel. Set pipe on bottom

2585
797

1788

4387
797

-3590

Gas 2058 show

2585
1850

735