

WW-7
8-30-06



West Virginia Department of Environmental Protection
Office of Oil and Gas
WELL LOCATION FORM: GPS

API: 47-049-00440^P WELL NO.: WV 602450 (Moore et. al. #2450)

FARM NAME: Moore

RESPONSIBLE PARTY NAME: EQT Production Company

COUNTY: Marion DISTRICT: Lincoln

QUADRANGLE: Shinnston 7.5'

SURFACE OWNER: John Postlewait Jr.

ROYALTY OWNER: J. Henry Hess Agent

UTM GPS NORTHING: 4,370,658

UTM GPS EASTING: 556,095 GPS ELEVATION: 380 m (1248 ft)

The Responsible Party named above has chosen to submit GPS coordinates in lieu of preparing a new well location plat for a plugging permit or assigned API number on the above well. The Office of Oil and Gas will not accept GPS coordinates that do not meet the following requirements:

1. Datum: NAD 1983, Zone: 17 North, Coordinate Units: meters, Altitude: height above mean sea level (MSL) – meters.
2. Accuracy to Datum – 3.05 meters
3. Data Collection Method:

Survey grade GPS : Post Processed Differential
Real-Time Differential

Mapping Grade GPS X: Post Processed Differential X
Real-Time Differential

4. **Letter size copy of the topography map showing the well location.**

I the undersigned, hereby certify this data is correct to the best of my knowledge and belief and shows all the information required by law and the regulations issued and prescribed by the Office of Oil and Gas.

Ben R. Seafelt
Signature

P.S. 2092
Title

9-9-11
Date

RECEIVED
OFFICE OF OIL & GAS
OCT 25 2011
WV Department of
Environmental Protection

Topo Quad: Shinnston

Scale: 1" = 2000' 49-00440P

County: Marion

Date: Aug. 5, 2011

District: Lincoln

Project No: 74-18-00-08

47-049-00440 (WV 602450)

Topo

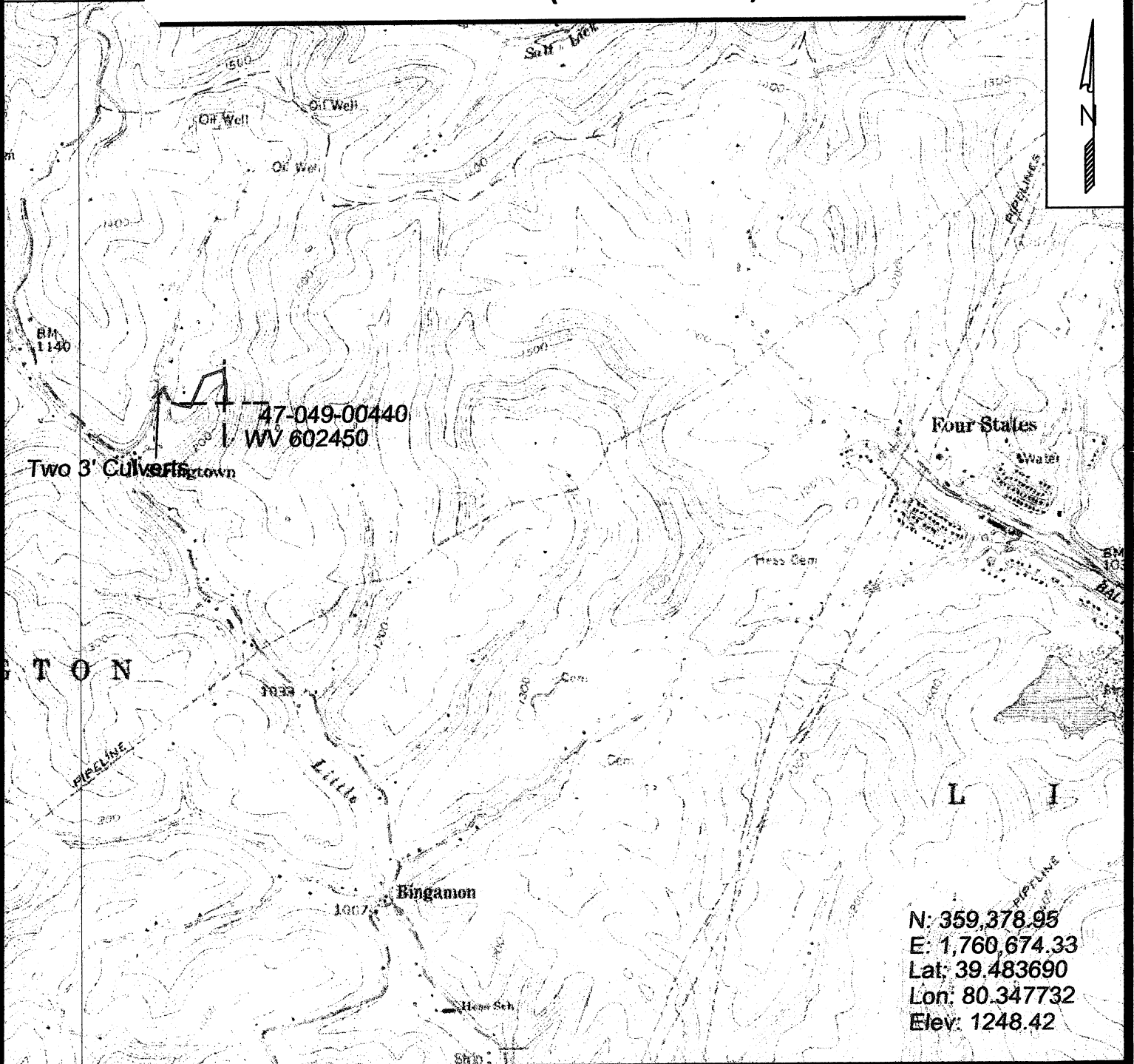

SURVEYING AND MAPPING SERVICES PERFORMED BY:
ALLEGHENY SURVEYS, INC.
 1-800-482-8606
 P.O. BOX 438
 BIRCH RIVER, WV 26610
 PH: (304) 649-8606
 FAX: (304) 649-8608

PREPARED FOR:

EQT Production Company
 1710 Pennsylvania Ave.
 Charleston, WV 25302