

LATITUDE 39°37'30"

WELL LOCATION  
**UTM 17-NAD83**  
**N:4384566.08**  
**E:560663.45**  
 NAD83, WV NORTH  
 N:404805.21  
 E:1744988.03  
 LAT/LOG DATUM-WGS84  
 LAT:39°36'31.30"  
 LON:80°17'36.03"

NOTE:  
 It is not the purpose or intention of this plat to represent surveyed locations of the surface or mineral parcels depicted hereon. The location of the boundary lines, as shown, are based on record deed descriptions, field evidence found and/or tax map position, unless otherwise noted.



LONGITUDE 80°17'30"

COORDINATES:  
 470' WEST  
 5939.34' SOUTH



**Blue Mountain Engineering**  
 11023 MASON DIXON HIGHWAY  
 BURTON, WV 26562  
 PHONE: (304) 662-6486

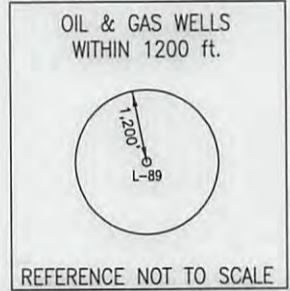

FILE #: L-89  
 DRAWING #: L-89  
 SCALE: 1" = 400'  
 MINIMUM DEGREE OF ACCURACY: 1/2500  
 PROVEN SOURCE OF ELEVATION: U.S.G.S. MONUMENT THOMAS 1498.81'

I, THE UNDERSIGNED, HEREBY CERTIFY THAT THIS PLAT IS CORRECT TO THE BEST OF MY KNOWLEDGE AND BELIEF AND SHOWS ALL THE INFORMATION REQUIRED BY LAW AND THE REGULATIONS ISSUED AND PRESCRIBED BY THE DEPARTMENT OF ENVIRONMENTAL PROTECTION.  
 Signed: *[Signature]*  
 R.P.E.: \_\_\_\_\_ L.L.S.: P.S. No. 2000

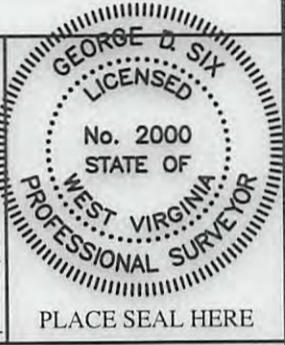

(+) DENOTES LOCATION OF WELL ON UNITED STATES TOPOGRAPHIC MAPS WVDEP  
 OFFICE OF OIL & GAS  
 601 57TH STREET  
 CHARLESTON, WV 25304



DATE: JULY 29, 2013  
 OPERATOR'S WELL #: L-89  
 API WELL #: 47 049 01409C P  
 STATE COUNTY PERMIT

Well Type:  Oil  Waste Disposal  Production  Deep  
 Gas  Liquid Injection  Storage  Shallow

WATERSHED: SUGAR RUN OF PAW PAW CREEK ELEVATION: 1340'  
 COUNTY/DISTRICT: MARION / PAW PAW QUADRANGLE: MANNINGTON, WV-PA 7.5'  
 SURFACE OWNER: CONSOLIDATION COAL COMPANY ACREAGE: 1092.79±  
 OIL & GAS ROYALTY OWNER: CONSOLIDATION COAL COMPANY, et al ACREAGE: \_\_\_\_\_  
 DRILL  CONVERT  DRILL DEEPER  REDRILL  FRACTURE OR STIMULATE   
 PLUG OFF OLD FORMATION  PERFORATE NEW FORMATION  PLUG & ABANDON   
 CLEAN OUT & REPLUG  OTHER CHANGE  (SPECIFY): \_\_\_\_\_  
 TARGET FORMATION: PITTSBURGH ESTIMATED DEPTH: 830'  
 WELL OPERATOR CNX GAS COMPANY LLC DESIGNATED AGENT JEREMY JONES  
 Address 200 EVERGREENE Dr. Address ONE DOMINION DRIVE  
 City WAYNESBURG State PA Zip Code 15370 City JANE LEW State WV Zip Code 26378

10/25/2013

4901409P

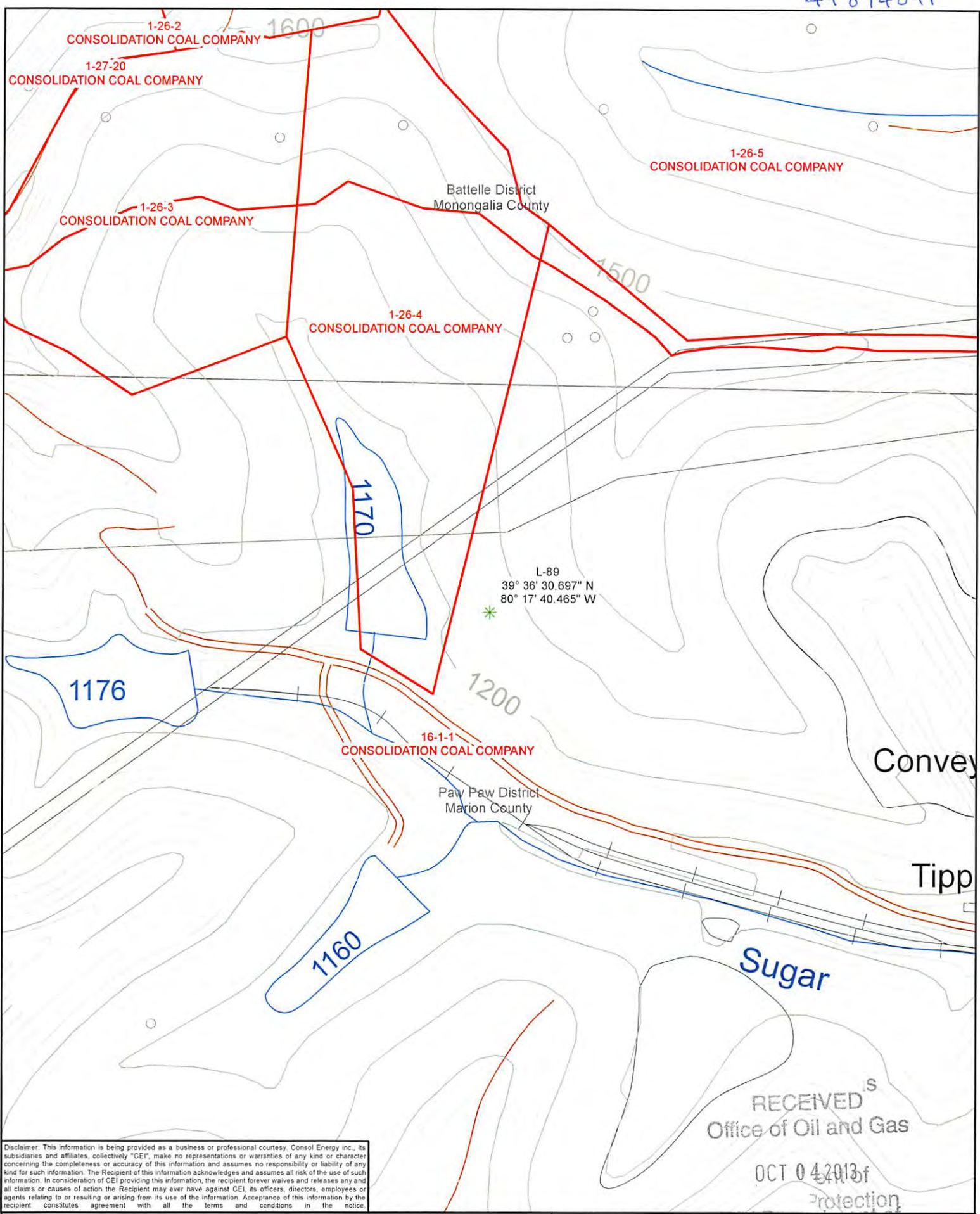

Disclaimer: This information is being provided as a business or professional courtesy. Consol Energy inc., its subsidiaries and affiliates, collectively "CEI", make no representations or warranties of any kind or character concerning the completeness or accuracy of this information and assumes no responsibility or liability of any kind for such information. The Recipient of this information acknowledges and assumes all risk of the use of such information. In consideration of CEI providing this information, the recipient forever waives and releases any and all claims or causes of action the Recipient may ever have against CEI, its officers, directors, employees or agents relating to or resulting or arising from its use of the information. Acceptance of this information by the recipient constitutes agreement with all the terms and conditions in the notice.

RECEIVED  
Office of Oil and Gas  
OCT 04 2013  
Environmental Protection

**Legend**

- GOB Well
- Surface Property
- District / County

N

Date: 7/10/2013		Prepared By: K. McCartney	
Revisions:		Approved By:	

This map is property of CONSOL Energy Inc. and contains information that is proprietary and confidential in nature and may not be copied or reproduced without prior written consent.

**CONSOL ENERGY**

GOB Well Location Map  
Well L-89 for Plugging  
Loveridge Project Area