

49 01940P

WW-7  
8-30-06



West Virginia Department of Environmental Protection  
Office of Oil and Gas  
**WELL LOCATION FORM: GPS**

API: 47-049-01940 WELL NO.: 608271

FARM NAME: J. Lawlis

RESPONSIBLE PARTY NAME: Equitrans, L.P.

COUNTY: Marion DISTRICT: Mannington

QUADRANGLE: Glover Gap 7.5

SURFACE OWNER: Consolidation Coal Company

ROYALTY OWNER: William M. Burnside ETAL

UTM GPS NORTHING: 4374415.682

UTM GPS EASTING: 548091.594 GPS ELEVATION: 311.2008 meters (1020.7')

The Responsible Party named above has chosen to submit GPS coordinates in lieu of preparing a new well location plat for a plugging permit or assigned API number on the above well. The Office of Oil and Gas will not accept GPS coordinates that do not meet the following requirements:

1. Datum: NAD 1983, Zone: 17 North, Coordinate Units: meters, Altitude: height above mean sea level (MSL) – meters.
2. Accuracy to Datum – 3.05 meters
3. Data Collection Method:

Survey grade GPS  : Post Processed Differential

Real-Time Differential

Mapping Grade GPS  : Post Processed Differential

Real-Time Differential

4. Letter size copy of the topography map showing the well location.

I the undersigned, hereby certify this data is correct to the best of my knowledge and belief and shows all the information required by law and the regulations issued and prescribed by the Office of Oil and Gas.

[Signature]  
Signature

Leadman  
Title

8/4/2017  
Date

RECEIVED  
Office of Oil and Gas

AUG 31 2017

WV Department of  
Environmental Protection

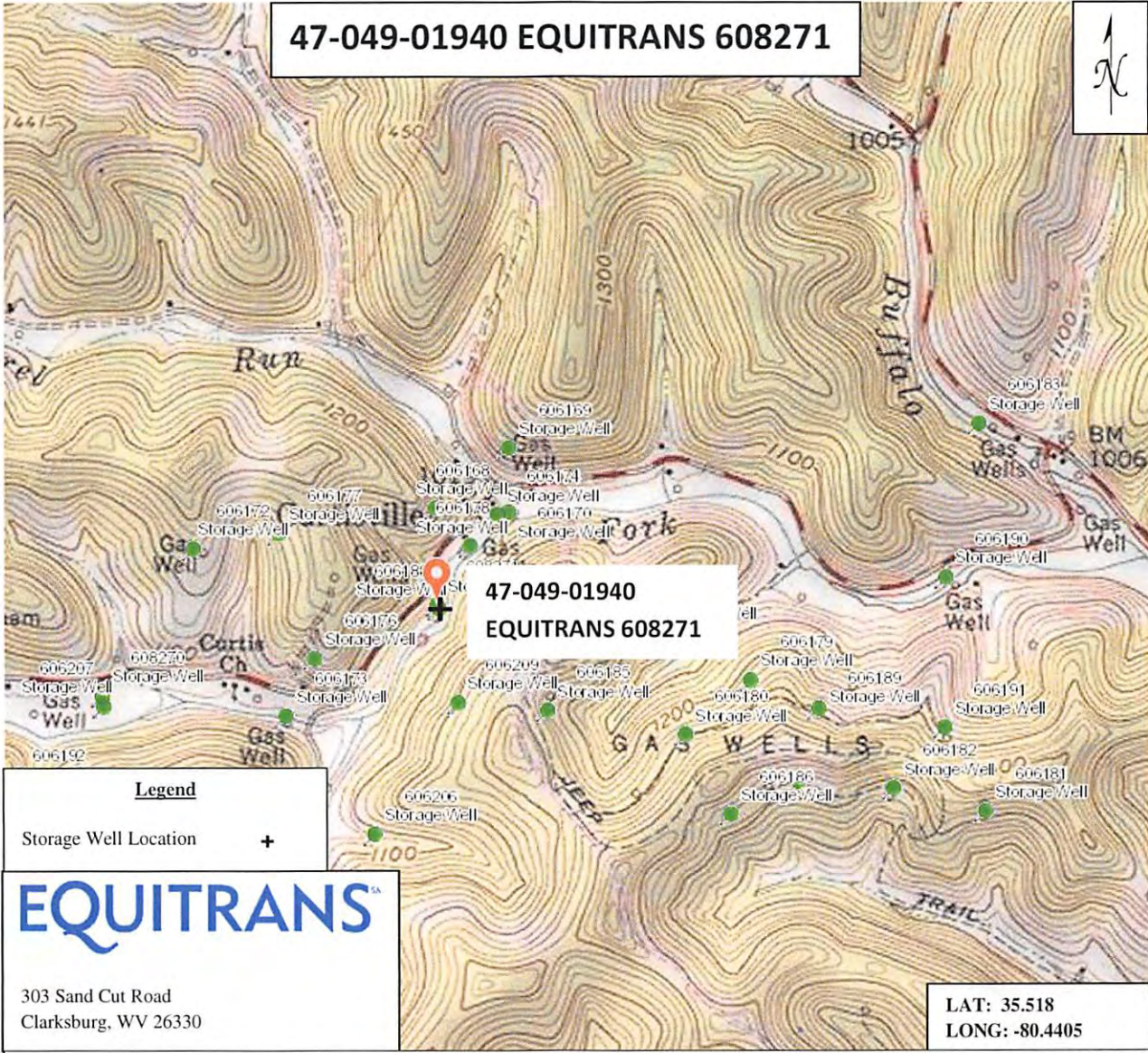

**47-049-01940 EQUITRANS 608271**



**Legend**  
Storage Well Location +

**EQUITRANS**<sup>SA</sup>  
303 Sand Cut Road  
Clarksburg, WV 26330

**LAT: 35.518  
LONG: -80.4405**

DISCLAIMER: ALL INFORMATION DEPICTED ON THIS MAP PROVIDED BY EOT (SAID TERM SHALL MEAN EOT PRODUCTION OR EOT MIDSTREAM, DEPENDING ON WHICH EOT ENTITY PROVIDED THE MAP) IS FOR INFORMATION PURPOSES ONLY AND SHALL BE TREATED AS CONFIDENTIAL INFORMATION AND SHALL ONLY BE USED FOR THE SOLE PURPOSE FOR WHICH IT WAS PROVIDED. ANY OTHER USE OF THIS MAP, OR THE INFORMATION INCLUDED THEREON, IS STRICTLY PROHIBITED. THE EXACT LOCATION OF THE FACILITIES (INCLUDING BUT NOT LIMITED TO WELLS, PIPELINES, STRUCTURES, FACILITIES, LEASE BOUNDARIES OR ANY OTHER INFORMATION) SHOWN ON THIS MAP SHALL NOT BE RELIED UPON FOR THE SPECIFIC LOCATION OF THE FACILITIES, AND THE PARTIES AGREE THAT THE INFORMATION SHOWN ON THE MAP MAY NOT HAVE BEEN PLACED ON THE MAP USING SURVEY LINES OR GPS COORDINATES. EOT MAKES NO EXPRESS OR IMPLIED REPRESENTATION OR WARRANTY AS TO THE ACCURACY OF THE MAP, OR THE INFORMATION SHOWN THEREON. THE SPECIFIC LOCATION OF ANY OF THE INFORMATION, INCLUDING ANY WELL, PIPELINE, STRUCTURE, FACILITY OR LEASE BOUNDARY, SHOULD BE DETERMINED BY A FIELD SURVEY PERFORMED BY A LICENSED SURVEYOR UPON CONSULTATION WITH EOT. THIS MAP MAY NOT BE COPIED OR OTHERWISE MADE AVAILABLE TO ANY OTHER PARTY IN PAPER OR ELECTRONIC FORMAT WITHOUT WRITTEN CONSENT FROM EOT. RECIPIENT EXPRESSLY AGREES THAT ITS USE AND/OR RETAINER OF THIS MAP SHALL BE DEEMED ITS AGREEMENT TO THE TERMS SET FORTH ABOVE.

Quad: <u>Glover Gap 7.5</u>	Scale: <u>Not Mapped to Scale</u>
County: <u>Marion</u>	Date: <u>8/4/2017</u>
District: <u>Mannington</u>	API: <u>47-049-01940</u>

RECEIVED  
Office of Oil and Gas  
AUG 31 2017  
10/06/2017  
WV Department of  
Environmental Protection