

- Proposed Gas Well
- Located Corner, as noted
- Surface Tract Lines
- Reference Line
- Lease Boundary
- Creek or Drain
- Ⓢ WV County Route
- Ⓟ WV State Route

(-○-) Denotes Location of Well on United States Topographic Maps



I, the undersigned, hereby certify that this plat is correct to the best of my knowledge and belief and shows all the information required by law and the regulations issued and prescribed by the Department of Environmental Protection.

Dwayne A. Hall
P.S. 2089SU



FILE NO: 48-18
DRAWING NO: Elliott 1H
SCALE: 1" = 2000'
MINIMUM DEGREE OF ACCURACY: 1:2500
PROVEN SOURCE OF ELEVATION: NGS CORS Station

STATE OF WEST VIRGINIA
DEPARTMENT OF ENVIRONMENTAL PROTECTION
OIL AND GAS DIVISION

DATE: October 7 20 20
OPERATOR'S WELL NO.: Elliott 1H
API WELL NO
47 - 049 - 02499
STATE COUNTY PERMIT

WELL TYPE: OIL GAS LIQUID INJECTION WASTE DISPOSAL
(IF GAS) PRODUCTION: STORAGE DEEP SHALLOW
LOCATION: ELEVATION: 1343' WATERSHED Tributary of Dents Run QUADRANGLE: Glover Gap
DISTRICT: Mannington COUNTY: Marion
SURFACE OWNER: Consolidated Coal Company ACREAGE: 153.25
ROYALTY OWNER: Randy J. Elliott and Leonard W. Stafford LEASE NO: 871454 ACREAGE: 183
PROPOSED WORK: DRILL CONVERT DRILL DEEPER FRACTURE OR STIMULATE PLUG OFF OLD FORMATION
 PERFORATE NEW FORMATION OTHER PHYSICAL CHANGE IN WELL (SPECIFY)
 PLUG AND ABANDON CLEAN OUT AND REPLUG TARGET FORMATION: Marcellus ESTIMATED DEPTH:

WELL OPERATOR: EQT Production Company DESIGNATED AGENT: Joseph C. Mallow
ADDRESS: 400 Woodcliff Drive ADDRESS: 115 Professional Place PO Box 280
Canonsburg, PA 15317 Bridgeport, WV 26330

**Elliott 1H
GLO176
EQT Production Company**

Tract I.D.	Tax Map No.	Parcel No.	County	District	Surface Tract Owner	Acres
1	34	40	Marion	Mannington	Consolidation Coal Company	153.25
2	34	37	Marion	Mannington	Consolidation Coal Company	133.37
3	34	38	Marion	Mannington	Consolidation Coal Company	17.00
4	34	36	Marion	Mannington	Consolidation Coal Company	120.00
5	34	34	Marion	Mannington	Consolidation Coal Company	48.85
6	34	52	Marion	Mannington	CSX Transportation	12.62
7	34	35	Marion	Mannington	Consolidation Coal Company	16.00
8	36	19	Marion	Mannington	Consolidation Coal Company	123.50
9	36	18	Marion	Mannington	CNX Land LLC	18.50
10	37	30	Marion	Mannington	Consolidation Coal Company	107.00
11	34	49	Marion	Mannington	Dennis M. & Lisa A. Hayes	24.78
12	34	47	Marion	Mannington	Edward F. Price	23.00
13	33	1	Marion	Mannington	Thomas D. & Almee J. Haught	108.82
14	34	40.1	Marion	Mannington	Raymond F. & Betty J. Fluharty	20.75
15	34	45	Marion	Mannington	City of Mannington	42.50
16	34	41	Marion	Mannington	Consolidation Coal Company	47.00
17	34	30	Marion	Mannington	Consolidation Coal Company	42.75
18	34	33	Marion	Mannington	Consolidation Coal Company	134.00
19	34	32	Marion	Mannington	Consolidation Coal Company	22.25
20	35	9	Marion	Mannington	The Harrison County Coal Company	125.75
21	34	1	Marion	Mannington	Carol J. Murphy	52.00
22	35	9.1	Marion	Mannington	CNX Land LLC	2.00
23	35	8	Marion	Mannington	Dennis R. & Donna M. Carl	88.58
24	35	10.1	Marion	Mannington	CNX Land LLC	5.40
25	35	10.6	Marion	Mannington	Keith R. & Sandra D. Pigott	1.00
26	35	11	Marion	Mannington	CNX Land LLC	195.19
27	36	19.1	Marion	Mannington	CSX Transportation	4.00
28	36	17	Marion	Mannington	Consolidation Coal Company	35.00
29	30	16	Marion	Mannington	Consolidation Coal Company	60.11

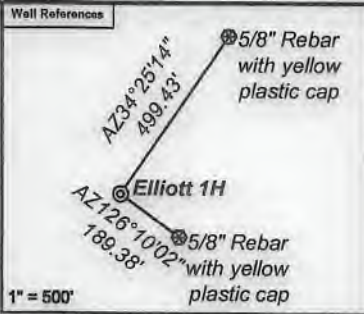

Notes:
 Elliott 1H coordinates are
 NAD 27 N: 381,907.55 E: 1,751,172.23
 NAD 27 Lat: 39.545205 Long: -80.382371
 NAD 83 UTM N: 4,377,472.89 E: 553,085.44
 Elliott 1H Landing Point coordinates are
 NAD 27 N: 380,155.02 E: 1,747,433.09
 NAD 27 Lat: 39.540292 Long: -80.395567
 NAD 83 UTM N: 4,376,919.95 E: 551,955.14
 Elliott 1H Bottom Hole coordinates are
 NAD 27 N: 382,234.70 E: 1,746,225.20
 NAD 27 Lat: 39.545968 Long: -80.399924
 NAD 83 UTM N: 4,377,547.42 E: 551,576.59
 West Virginia Coordinate system of 1927 (North Zone)
 based upon Differential GPS Measurements.
 Plat orientation, corner and well ties are based upon
 the grid north meridian.
 Well location references are based upon the grid north
 meridian.
 UTM coordinates are NAD83, Zone 17, Meters.

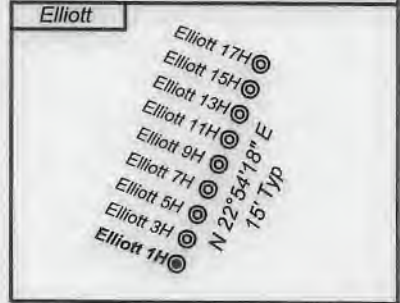

Lease No.	Owner	Acres
871516	Lee and Hall Royalties, a partnership, et al.	160.1
877887	Kennis D. Baker, Jr., Clark C. Baker and Pamela B. Arena, et al.	42.75
871542	AMP IV, LP, et al.	16
871680	Venable Royalty, LTD, V14, LP, JVO, LLC	16.25
871582	Geneva L. Straight, et al.	110

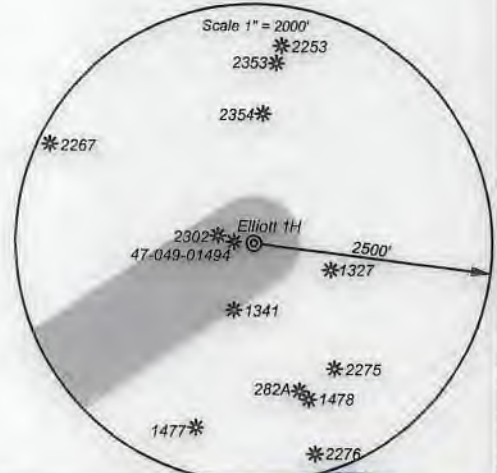

I, the undersigned, hereby certify that this plat is correct to the best of my knowledge and belief and shows all the information required by law and the regulations issued and prescribed by the Department of Environmental Protection.

Dwayne A. Hall
 P.S. 2089SU



FILE NO: 48-18
 DRAWING NO: Elliott 1H
 SCALE: 1" = 2000'
 MINIMUM DEGREE OF ACCURACY:
 1:2500
 PROVEN SOURCE OF ELEVATION:
 NGS CORS Station



DATE: October 7 20 20
 OPERATOR'S WELL NO.: Elliott 1H
 API WELL NO
 47 - 049 - 02499
 STATE COUNTY PERMIT

WELL TYPE: OIL GAS LIQUID INJECTION WASTE DISPOSAL
 (IF GAS) PRODUCTION: STORAGE DEEP SHALLOW
 LOCATION: ELEVATION: 1343' WATERSHED Tributary of Dents Run QUADRANGLE: Glover Gap
 DISTRICT: Mannington COUNTY: Marion
 SURFACE OWNER: Consolidated Coal Company ACREAGE: 153.25
 ROYALTY OWNER: Randy J. Elliott and Leonard W. Stafford LEASE NO: 871454 ACREAGE: 183
 PROPOSED WORK: DRILL CONVERT DRILL DEEPER FRACTURE OR STIMULATE PLUG OFF OLD FORMATION
 PERFORATE NEW FORMATION OTHER PHYSICAL CHANGE IN WELL (SPECIFY) _____
 PLUG AND ABANDON CLEAN OUT AND REPLUG TARGET FORMATION: Marcellus ESTIMATED DEPTH: _____

WELL OPERATOR: EQT Production Company DESIGNATED AGENT: Joseph C. Mallow
 ADDRESS: 400 Woodcliff Drive ADDRESS: 115 Professional Place PO Box 280
 Canonsburg, PA 15317 Bridgeport, WV 26330