

**Elliott 17H
GLO176
EQT Production Company**

Tract I.D.	Tax Map No.	Parcel No.	County	District	Surface Tract Owner	Acres
1	34	40	Marion	Mannington	Consolidation Coal Company	153.25
2	34	37	Marion	Mannington	Consolidation Coal Company	133.37
3	32	10	Marion	Mannington	Anna M. Mike, et al	73.51
4	36	21	Marion	Mannington	Consolidation Coal Company	169.49
5	32	13.1	Marion	Mannington	Willis E. Anderson	33.40
6	36	9	Marion	Mannington	Fredrick E. & Deborah S. Lilley	138.22
7	36	10	Marion	Mannington	CNX Land LLC	34.86
8	28	20	Marion	Mannington	Sportsman Square Circle Club Inc	102.85
9	34	49	Marion	Mannington	Dennis M. & Lisa A. Hayes	24.78
10	34	47	Marion	Mannington	Edward F. Price	23.00
11	34	48	Marion	Mannington	Edward F. Price	3.00
12	34	40.1	Marion	Mannington	Raymond F. & Betty J. Fluharty	29.75
13	34	45	Marion	Mannington	City of Mannington	42.50
14	34	41	Marion	Mannington	Consolidation Coal Company	47.00
15	34	39	Marion	Mannington	Consolidation Coal Company	42.75
16	34	33	Marion	Mannington	Consolidation Coal Company	134.00
17	34	38	Marion	Mannington	Consolidation Coal Company	17.00
18	33	28	Marion	Mannington	Mildred H. Prichard Heirs	379.56
19	32	11	Marion	Mannington	Consolidation Coal Company	118.00
20	32	9	Marion	Mannington	Michael L. & Belle J. Higgs	155.18
21	32	13.2	Marion	Mannington	Suzanne A. & Charles W. Given	33.40
22	31	34.1	Marion	Mannington	Consolidation Coal Company	88.05
23	32	12	Marion	Mannington	James K. & Rosa K. Haugh	78.21
24	32	13	Marion	Mannington	Suzanne A. & Charles W. Given	33.40
25	36	24	Marion	Mannington	CNX Land LLC	47.68
26	36	22	Marion	Mannington	Consolidation Coal Company	50.87
27	33	1	Marion	Mannington	Thomas D. & Aimee J. Haight	106.82
28	31	39	Marion	Mannington	CNX Land LLC	57.25
29	28	23	Marion	Mannington	CNX Land LLC	46.50
30	31	38	Marion	Mannington	CNX Land LLC	132.05
31	28	1	Marion	Mannington	Shirley M. Dunigan	107.39
32	28	22	Marion	Mannington	CNX Land LLC	36.60
33	36	23	Marion	Mannington	CNX Land LLC	30.98
34	28	21	Marion	Mannington	Sportsman Square Circle Club Inc	81.00
35	28	25	Marion	Mannington	CNX Land LLC	7.25
36	28	3	Marion	Mannington	Ray E. Cooker	41.30
37	28	4	Marion	Mannington	Jeffrey H. Michael	36.75
38	28	5	Marion	Mannington	Betty A. Earl	9.00
39	28	17	Marion	Mannington	CNX Land LLC	77.95
40	28	6.1	Marion	Mannington	Wilson Investments LLC	52.85
41	28	6	Marion	Mannington	Joshua A. & Courtney N. Wilfong	52.85
42	28	8.5	Marion	Mannington	Elijah & Erica Dean	55.00
43	28	16	Marion	Mannington	Consolidation Coal Company	107.83
44	28	8.1	Marion	Mannington	CNX Land LLC	15.96
45	28	2.1	Marion	Mannington	Larry Goll	160.04
46	28	9	Marion	Mannington	Waco Oil & Gas Company Inc	124.50
47	28	10	Marion	Mannington	Waco Oil & Gas Company Inc	41.50
48	28	13.1	Marion	Mannington	CNX Land LLC	21.58
49	27	11	Marion	Mannington	Jason G. & Cathy L. Straight	13.52
50	27	12.1	Marion	Mannington	Jason G. & Cathy L. Straight	20.00
51	28	13	Marion	Mannington	CNX Land LLC	13.16
52	27	17	Marion	Mannington	Raymond L. & Karen L. Mercer	104.00
53	28	9.1	Marion	Mannington	Douglas A. & Lisa A. Hayes	10.00
54	28	11	Marion	Mannington	CNX Land LLC	39.00
55	28	8.4	Marion	Mannington	CNX Land LLC	1.03
56	28	7	Marion	Mannington	Betty A. Earl	15.00
57	28	8.2	Marion	Mannington	Rhonda S. Dean	42.94
58	28	8.3	Marion	Mannington	CNX Land LLC	3.01

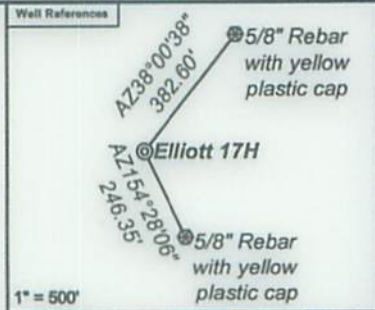

Notes:
 Elliott 17H coordinates are
 NAD 27 N: 382,018.08 E: 1,751,218.93
 NAD 27 Lat: 39.545509 Long: -80.382209
 NAD 83 UTM N: 4,377,506.80 E: 553,099.10
 Elliott 17H Landing Point coordinates are
 NAD 27 N: 384,172.75 E: 1,754,350.87
 NAD 27 Lat: 39.551509 Long: -80.371177
 NAD 83 UTM N: 4,378,179.17 E: 554,042.37
 Elliott 17H Bottom Hole coordinates are
 NAD 27 N: 396,858.07 E: 1,746,983.17
 NAD 27 Lat: 39.586136 Long: -80.397754
 NAD 83 UTM N: 4,382,006.51 E: 551,733.33
 West Virginia Coordinate system of 1927 (North Zone)
 based upon Differential GPS Measurements.
 Plat orientation, corner and well ties are based upon
 the grid north meridian.
 Well location references are based upon the grid north
 meridian.
 UTM coordinates are NAD83, Zone 17, Meters.

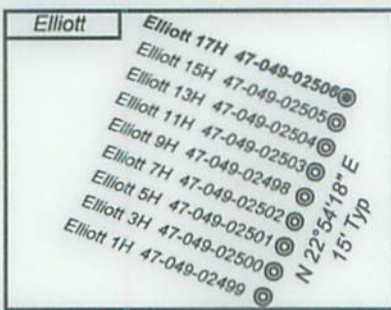

Lease No.	Owner	Acres
871540	Country Roads Minerals, LLC, et al.	89.75
871426	John D. Haskins, III	117
1016945	Ferrari VI OG, LLC, Bradley W. Thomas, Robert F. Horner & Jacob G. Ford, et al.	78.21
871548	West Virginia University Foundation, Inc., et al.	169.49
U12-36-24	CNX Gas Company LLC	47.68
1023072	WV Minerals Inc., et al.	56.25
871423	Country Roads Minerals, LLC, et al.	83.1
871855	Nita M. Cordray, et al.	115.86
871644	J & N Management Enterprises, LLC	48.75
871417	Sheila Lightfoot and Tina Fischer, et al.	105.75
871565	Lora L. Rinehart, et al.	15
871421	Claud Kendall Trust, et al.	125

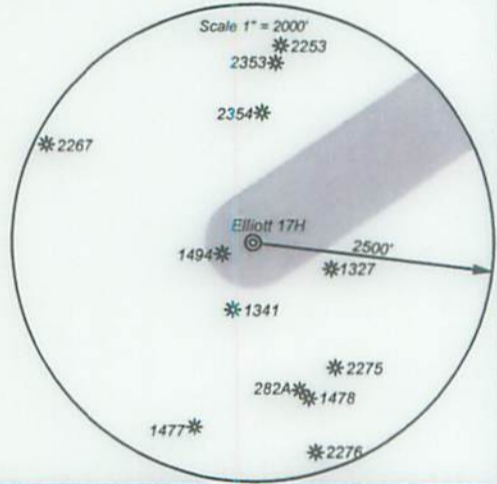

I, the undersigned, hereby certify that this plat is correct to the best of my knowledge and belief and shows all the information required by law and the regulations issued and prescribed by the Department of Environmental Protection.

Ben R. Singleton
 P.S. 2092



FILE NO: 48-18
 DRAWING NO: Elliott 17H
 SCALE: 1" = 2000'
 MINIMUM DEGREE OF ACCURACY: 1:2500
 PROVEN SOURCE OF ELEVATION: NGS CORS Station

STATE OF WEST VIRGINIA
 DEPARTMENT OF ENVIRONMENTAL PROTECTION
OIL AND GAS DIVISION

DATE: June 21 20 21
 OPERATOR'S WELL NO.: Elliott 17H
 API WELL NO: EXH09
 47 - 49 - 02506
 STATE - COUNTY - PERMIT

WELL TYPE: OIL GAS LIQUID INJECTION WASTE DISPOSAL
 (IF GAS) PRODUCTION: STORAGE DEEP SHALLOW
 LOCATION: ELEVATION: 1343' WATERSHED: Tributary of Dents Run QUADRANGLE: Glover Gap
 DISTRICT: Mannington COUNTY: Marion
 SURFACE OWNER: Consolidated Coal Company ACREAGE: 153.25
 ROYALTY OWNER: Randy J. Elliott and Leonard W. Stafford LEASE NO: 871454 ACREAGE: 183
 PROPOSED WORK: DRILL CONVERT DRILL DEEPER FRACTURE OR STIMULATE PLUG OFF OLD FORMATION
 PERFORATE NEW FORMATION OTHER PHYSICAL CHANGE IN WELL (SPECIFY)
 PLUG AND ABANDON CLEAN OUT AND REPLUG TARGET FORMATION: Marcellus ESTIMATED DEPTH: 7,770'

WELL OPERATOR: EQT Production Company DESIGNATED AGENT: Joseph C. Mallow
 ADDRESS: 400 Woodcliff Drive ADDRESS: 115 Professional Place PO Box 280
 Canonsburg, PA 15317 Bridgeport, WV 26330