

TH: 5584' LAT: 39-32-30

BH: 6250' LAT: 39-32-30

BH: 5345' LONG: 80-25-00
TH: 6510' LONG: 80-25-00

Carnegie 9H Carnegie EQT Production Company

Tract ID	Tax Map No.	Parcel No.	County	District	Surface Tract Owner	Acres
1	49	39	Marion	Mannington	Jeanne A. Musgrave Akers & Joseph Forte	28.96
2	49	37	Marion	Mannington	Equitrans LP	51.50
3	49	39.1	Marion	Mannington	Jeanne A. Musgrave Akers & Joseph Forte	23.90
4	49	40	Marion	Mannington	Marshall & Dick Cartright	36.00
5	50	14	Marion	Mannington	Melvin L. Gooch Sr.	28.00
6	50	15	Marion	Mannington	Perry R. & Janice M. Thorne	5.61
7	50	16	Marion	Mannington	Richard H. & Lucy M. Lambert	0.66
8	50	17	Marion	Mannington	Jason H. & Brande L. Batson	0.32
9	48	13	Marion	Mannington	Harlen O. & Diana S. Batson	1.10
10	48	13.1	Marion	Mannington	Gary A. & Sheila D. Earl	2.02
11	48	14	Marion	Mannington	Roger L. & Pauline A. Eshelman	25.09
12	48	15	Marion	Mannington	Elmer O. & Alja G. Duncan	23.50
13	49	36	Marion	Mannington	Frederic R. & Kimberly P. Steele	16.25
14	49	35	Marion	Mannington	Trustees Mannington Church Of Christ	13.00
15	48	38	Marion	Mannington	Thomas B. Wright	30.00
16	48	13.2	Marion	Mannington	Dustin Earl	0.73

- Carnegie**
- Carnegie 18H ⊙ ⊙ Carnegie 19H
 - Carnegie 18H ⊙ ⊙ Carnegie 17H
 - Carnegie 14H ⊙ ⊙ Carnegie 15H
 - Carnegie 12H ⊙ ⊙ Carnegie 13H
 - Carnegie 10H ⊙ ⊙ Carnegie 11H
 - Carnegie 8H ⊙ ⊙ Carnegie 9H
 - Carnegie 6H ⊙ ⊙ Carnegie 7H
 - Carnegie 4H ⊙ ⊙ Carnegie 5H
 - Carnegie 2H ⊙ ⊙ Carnegie 3H
 - ⊙ Carnegie 1H

Notes:
 Carnegie 9H coordinates are
 NAD 27 N: 374,264.31 E: 1,735,837.48
 NAD 83 UTM N: 4,375,066.33 E: 548,452.24
 Carnegie 9H Landing Point coordinates are
 NAD 27 N: 374,571.81 E: 1,735,586.78
 NAD 27 Lat: 39.524632 Long: -80.437363
 NAD 83 UTM N: 4,375,213.58 E: 548,373.39
 Carnegie 9H Bottom Hole coordinates are
 NAD 27 N: 375,435.83 E: 1,735,183.84
 NAD 27 Lat: 39.526992 Long: -80.438823
 NAD 83 UTM N: 4,375,419.93 E: 548,247.16
 West Virginia Coordinate system of 1927 (North Zone) based upon Differential GPS Measurements. Plat orientation, corner and well ties are based upon the grid north meridian. Well location references are based upon the grid north meridian. UTM coordinates are NAD83, Zone 17, Meters.



I, the undersigned, hereby certify that this plat is correct to the best of my knowledge and belief and shows all the information required by law and the regulations issued and prescribed by the Department of Environmental Protection.

Ben R. Singleton
 P.S. 2092



SEAL

FILE NO: 93-21
 DRAWING NO: Carnegie 9H
 SCALE: 1" = 1000'
 MINIMUM DEGREE OF ACCURACY: 1:2500
 PROVEN SOURCE OF ELEVATION: NGS CORS Station

STATE OF WEST VIRGINIA
 DEPARTMENT OF ENVIRONMENTAL PROTECTION
 OIL AND GAS DIVISION

DATE: August 19 20 21
 OPERATOR'S WELL NO.: Carnegie 9H
 API WELL NO: 47-049-02508
 STATE COUNTY PERMIT

WELL TYPE: OIL GAS LIQUID INJECTION WASTE DISPOSAL
 (IF GAS) PRODUCTION: STORAGE DEEP SHALLOW
 LOCATION: ELEVATION: Existing: 1343 Proposed: 1318' WATERSHED Laurel Run of Owen Davy Fork QUADRANGLE: Glover Gap
 DISTRICT: Mannington COUNTY: Marion
 SURFACE OWNER: Jeanne A. Musgrave Akers & Joseph Forte ACREAGE: 28.96
 ROYALTY OWNER: Bounty Minerals, LLC, et al. LEASE NO: 124799 ACREAGE: 135
 PROPOSED WORK: DRILL CONVERT DRILL DEEPER FRACTURE OR STIMULATE PLUG OFF OLD FORMATION
 PERFORATE NEW FORMATION OTHER PHYSICAL CHANGE IN WELL (SPECIFY)
 PLUG AND ABANDON CLEAN OUT AND REPLUG TARGET FORMATION: Marcellus ESTIMATED DEPTH: 7754'

WELL OPERATOR: EQT Production Company DESIGNATED AGENT: Joseph C. Mallow
 ADDRESS: 400 Woodcliff Drive ADDRESS: 115 Professional Place PO Box 280
 Canonsburg, PA 15317 Bridgeport, WV 26330

10/15/2021

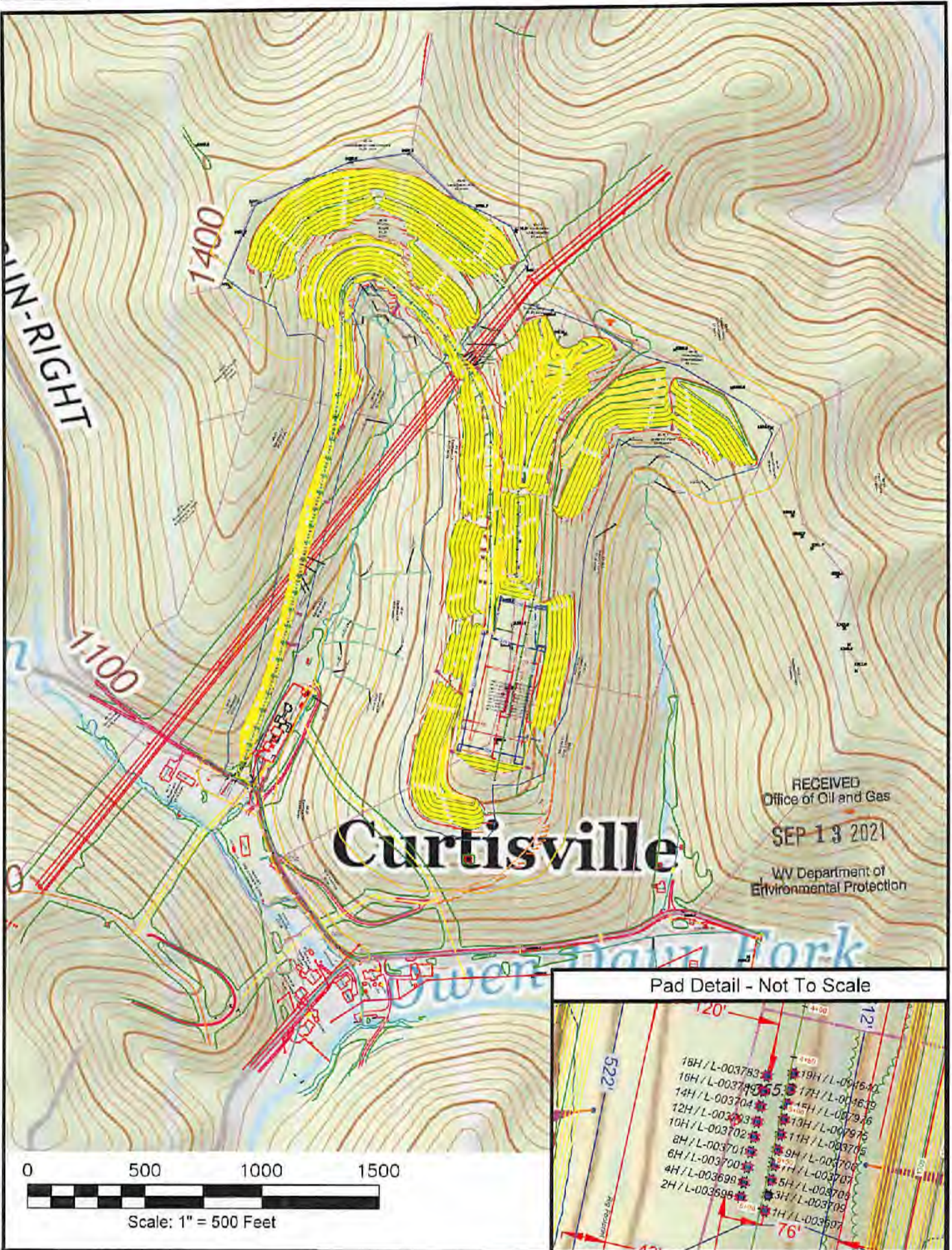

Pine Grove 7.5' USGS QUADRANGLE		Proposed Disturbance Area	
Projected culvert inventory. (for bid purposes only)		Well Site Location	See Site Plan
15" minimum diameter culverts	See Site Plan	Proposed Access Road	See Site Plan
24" minimum diameter culverts	See Site Plan	Approximate Total Disturbance	See Site Plan
DRAWN BY: Scott Brown	DATE: August 5, 2021	FILE NO. 92-21	DRAWING FILE NO. Carnegie Rec Plan

Note: SEE SITE PLAN OF CARNEGIE FOR COMPLETE GRADING & DRAINAGE CONSTRUCTION INCLUDING EROSION & SEDIMENT CONTROL DETAILS, ETC.

10/15/2021



SURVEYING AND MAPPING SERVICES PERFORMED BY:
ALLEGHENY SURVEYS, INC.
 1-800-482-8606
 Birch River Office Phone: (304) 649-8606 Fax: (304) 649-8608
 237 Birch River Road P.O. Box 438 Birch River, WV 26610

Topo Quad: Glover Gap Scale: 1" = 1000'
 County: Marion Date: July 13, 2021
 District: Mannington Project No: 92-18-M-21

Water **Carnegie North Well Pad**

10 Potential Water Sources within 2500'

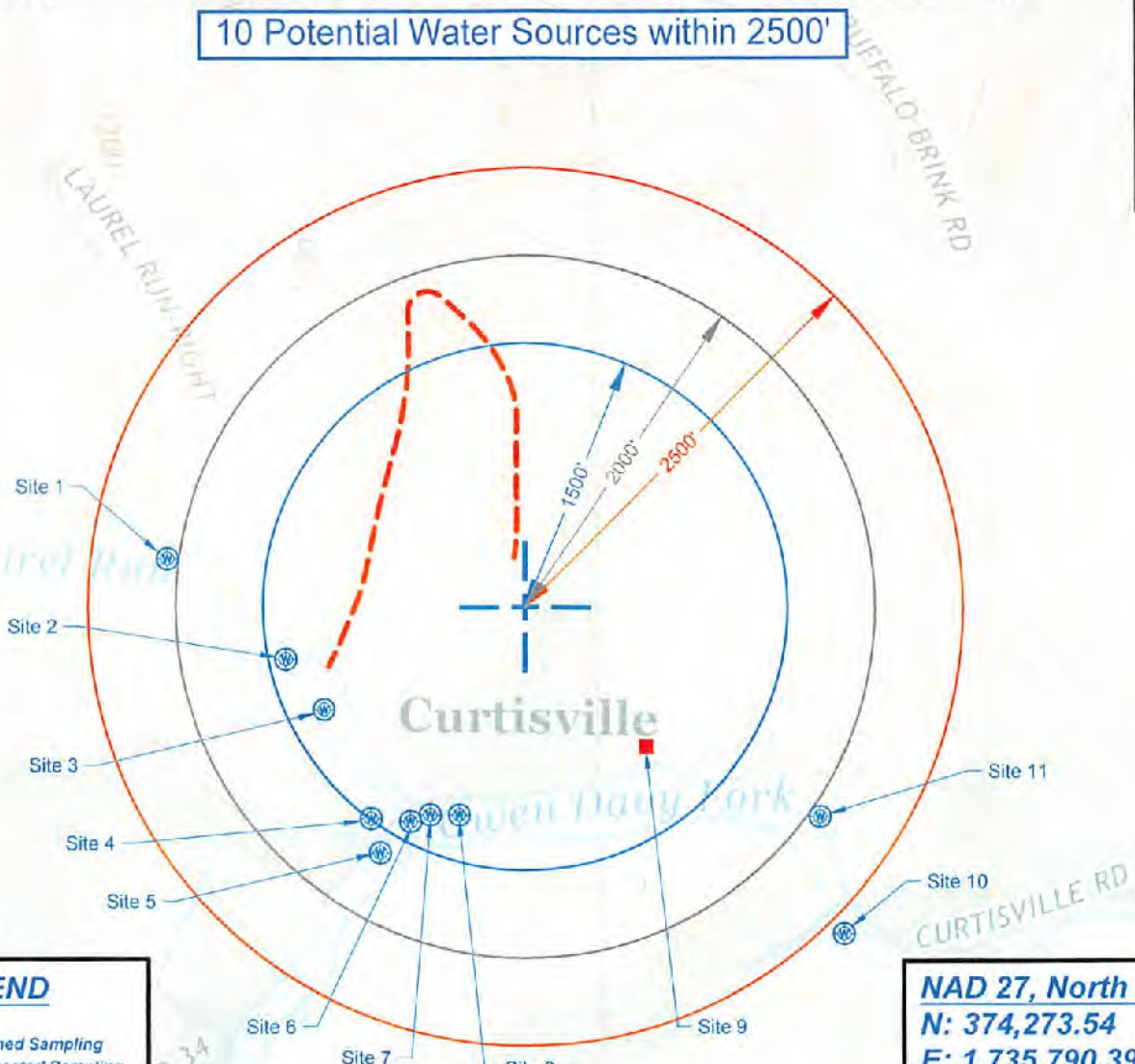

LEGEND

Red Symbol - Declined Sampling
 Blue Symbol - Requested Sampling / Unable to Contact

- Well
- Spring
- Pond
- Building

NAD 27, North Zone
N: 374,273.54
E: 1,735,790.39

WGS 84
LAT: 39.523903
LONG: -80.436440
ELEV: 1316.0'



SURVEYING AND MAPPING SERVICES PERFORMED BY:
ALLEGHENY SURVEYS, INC.
 1-800-482-8606
 237 Birch River Road
 Birch River, WV 26610
 PH: (304) 649-8606
 FAX: (304) 649-8608

PREPARED FOR:
EQT Production Company
 400 Woodcliff Drive
 Canonsburg, PA 15317