

TH: 2018' LAT: 39-35-00  
 BH: 9605' LAT: 39-32-30

BH: 2412' LONG: 80-20-00  
 TH: 13807' LONG: 80-22-30

- ⊙ Proposed Gas Well
- ⊙ Located Corner, as noted
- Surface Tract Lines
- - - Reference Line
- ▬ Lease Boundary
- Creek or Drain
- ⑤ WV County Route
- ⑤ WV State Route

(⊙) Denotes Location of Well on United States Topographic Maps

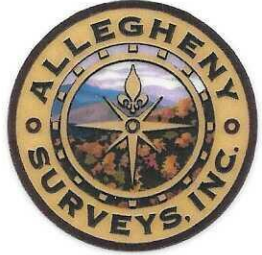

*I, the undersigned, hereby certify that this plat is correct to the best of my knowledge and belief and shows all the information required by law and the regulations issued and prescribed by the Department of Environmental Protection.*

*Ben R. Singleton*  
 P.S. 2092



FILE NO: 142-22  
 DRAWING NO: Elliott 12H  
 SCALE: 1" = 1000'  
 MINIMUM DEGREE OF ACCURACY: 1:2500  
 PROVEN SOURCE OF ELEVATION: NGS CORS Station



DATE: June 24 20 25  
 OPERATOR'S WELL NO.: Elliott 12H  
 API WELL NO  
 47 - 049 - 02558  
 STATE COUNTY PERMIT

WELL TYPE:  OIL  GAS  LIQUID INJECTION  WASTE DISPOSAL  
 (IF GAS) PRODUCTION:  STORAGE  DEEP  SHALLOW  
 LOCATION: ELEVATION: 1342' WATERSHED Tributary of Dents Run QUADRANGLE: Glover Gap  
 DISTRICT: Mannington COUNTY: Marion 04/24/2026  
 SURFACE OWNER: Marion County Coal Resources Inc. ACREAGE: 153.25  
 ROYALTY OWNER: Randy J. Elliott, et al. LEASE NO: 134417000 ACREAGE: 183  
 PROPOSED WORK:  DRILL  CONVERT  DRILL DEEPER  FRACTURE OR STIMULATE  PLUG OFF OLD FORMATION  
 PERFORATE NEW FORMATION  OTHER PHYSICAL CHANGE IN WELL (SPECIFY) \_\_\_\_\_  
 PLUG AND ABANDON  CLEAN OUT AND REPLUG TARGET FORMATION: Marcellus ESTIMATED DEPTH: 7,796'

WELL OPERATOR: EQT Production Company DESIGNATED AGENT: Joseph C. Mallow  
 ADDRESS: 400 Woodcliff Drive ADDRESS: 427 Midstate Drive  
 Canonsburg, PA 15317 Clarksburg, WV 25301

**Elliott 12H  
Elliott  
EQT Production Company**

Tract I.D.	Tax Map No.	Parcel No.	County	District	Surface Tract Owner	Acres
1	34	40	Marion	Mannington	Marion County Coal Resources Inc.	153.25
2	34	49	Marion	Mannington	Thomas D. & Aimee J. Haught	24.78
3	34	47	Marion	Mannington	Edward F. Price	23
4	33	1	Marion	Mannington	Thomas D. & Aimee J. Haught	106.823
5	34	40.1	Marion	Mannington	Betty J. Fluharty	29.75
6	34	45	Marion	Mannington	City of Mannington	42.5
7	34	41	Marion	Mannington	Marion County Coal Resources Inc.	47
8	34	39	Marion	Mannington	Marion County Coal Resources Inc.	42.75
9	34	33	Marion	Mannington	Marion County Coal Resources Inc.	134
10	34	38	Marion	Mannington	Marion County Coal Resources Inc.	17
11	34	37	Marion	Mannington	Marion County Coal Resources Inc.	133.37
13	34	52	Marion	Mannington	CSX Transportation	12.62
83	34	37	Marion	Mannington	Consolidation Coal Company	NA
105	34	43	Marion	Mannington	State of West Virginia Department of Commerce	67.087
106	34	44	Marion	Mannington	Consolidation Coal Company	NA
107	34	50	Marion	Mannington	CSX Transportation	45.25
121	34	44.1	Marion	Mannington	City of Mannington	25.75
128	33	10	Marion	Mannington	City of Mannington	39.7
129	33	9	Marion	Mannington	Newton S. Beaty Families Trust	220.003
141	32	11	Marion	Mannington	Marion County Coal Resources Inc.	116
142	33	28	Marion	Mannington	Mildred H. Prichard Heirs	379.56
143	33	4	Marion	Mannington	Dents Run Properties LLC	109.089
144	33	4.1	Marion	Mannington	Barbara A. Fluharty	0.4115
145	33	8	Marion	Mannington	Jackson L. Yankie	5.564
146	33	8.1	Marion	Mannington	Mark D. & Deborah J. Snider	1
147	33	8.2	Marion	Mannington	Mark D. Snider	16.431
148	33	9.2	Marion	Mannington	City of Mannington	5.8

**As Drilled Well Information:**  
**Elliott 12H coordinates are**  
 NAD 27 N: 381,987.83 E: 1,751,233.20  
 NAD 83 UTM N: 4,377,497.60 E: 553,103.61  
**Elliott 12H Landing Point coordinates are**  
 NAD 27 N: 382,608.56 E: 1,753,256.73  
 NAD 83 UTM N: 4,377,697.06 E: 553,716.96  
**Elliott 12H Bottom Hole coordinates are**  
 NAD 27 N: 378,170.06 E: 1,755,362.07  
 NAD 83 UTM N: 4,376,355.49 E: 554,380.89  
 West Virginia Coordinate system of 1927 (North Zone)  
 based upon Differential GPS Measurements.  
 Plat orientation, corner and well ties are based upon  
 the grid north meridian.  
 Well location references are based upon the grid north  
 meridian.  
 UTM coordinates are NAD83, Zone 17, Meters.

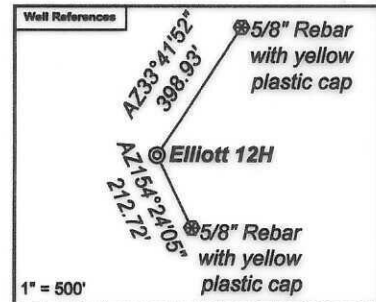

- Elliott**
- Elliott 17H 47-049-02506
  - Elliott 15H 47-049-02505
  - Elliott 13H 47-049-02504
  - Elliott 11H 47-049-02503
  - Elliott 9H 47-049-02498
  - Elliott 7H 47-049-02502
  - Elliott 5H 47-049-02501
  - Elliott 3H 47-049-02500
  - Elliott 1H 47-049-02499
  - Elliott 16H 47-049-02560
  - Elliott 14H 47-049-02559
  - Elliott 12H 47-049-02558
  - Elliott 10H 47-049-02557
  - Elliott 8H 47-049-02556
  - Elliott 6H 47-049-02555
  - Elliott 4H 47-049-02554
  - Elliott 2H 47-049-02553

Lease No.	Owner	Acres
134417000	Randy J. Elliott, et al.	183
172703000	EQT Production Company, et al.	90.125 & 63
111590063	MCJV Holdings, LLC, et al.	42.5
111591078	MCJV Holdings, LLC, et al.	118.45
124413000	Newton S. Beaty Families Trust	427.153

