

LATITUDE 39 37 30

LONGITUDE 80 15

2.15s
.58w

7'5 OGIS topo location

7.5' loc _____ 15' loc _____
(calc.) _____

Company _____

Farm O J SUTTON 2

Quad MANNINGTON

County MARION

District PAW PAW

WELL LOCATION MAP

File No. 30030

I, the undersigned, hereby certify that this map is correct and shows all the information to the best of my knowledge and belief as required by the oil and gas section of the mining laws of West Virginia.

Paul [unclear]
[unclear]

Acknowledged before me a Notary Public this 16th day of February, 1931.
My commission expires on the 30th day of March, 1931.

John F. Wiegman
NOTARY PUBLIC

JOHN F. WEGMAN, NOTARY PUBLIC
MY COMMISSION EXPIRES, MAR. 30, 1931

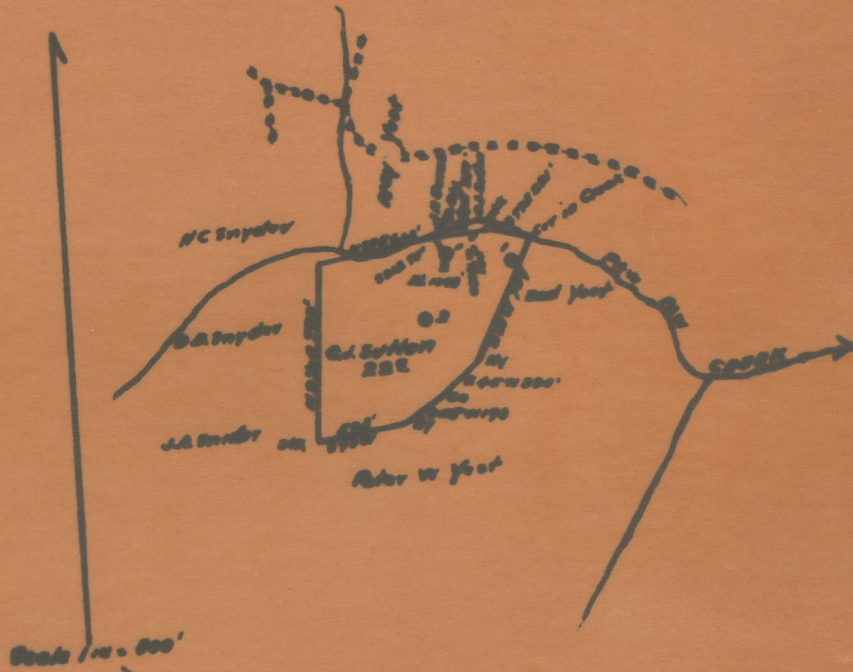

Mar - 30 - A

Paw Paw District, Marion County, W. Va.

By South Penn Oil Co., P. O. Drawer 1255, Pittsburgh, Pa.

On 22 acres, surface owned by I. L. Yost, Fairview, W. Va., and
mineral rights by Harry J. McHugh, Washington, Pa.

Elevation, 1043' L.

10" casing, 204'; 8 $\frac{1}{2}$ " , 900'; 6-5/8" , 1805' 4".

Coal was encountered at 505'.

Abandonment reported to Dept. of Mines Feb. 16, 1931.

Well was shot in Big Injun Sand.

Oil well.

MAR-30-A

	Top.	Bottom.
Pittsburgh Coal	505	
Big Injun Sand (oil, 1939' and 1944')	1871	
Total depth		1971