

LATITUDE 39 40

LONGITUDE 80 22 30

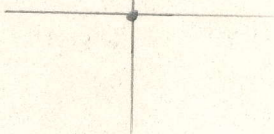

2.53 S
1.25 W

7'5 OGIS topo location

7.5' loc _____ 15' loc _____
(calc.) _____

Company _____

Farm D V LIMING 1

Quad HUNORED

County MARION

District MANNINGTON

WELL LOCATION MAP

File No. 30057

Pittsburgh Coal owned by the Heirs of
 C. E. Hennen. Land in Mannington District
 Marion County, West Virginia

Mar-57-A

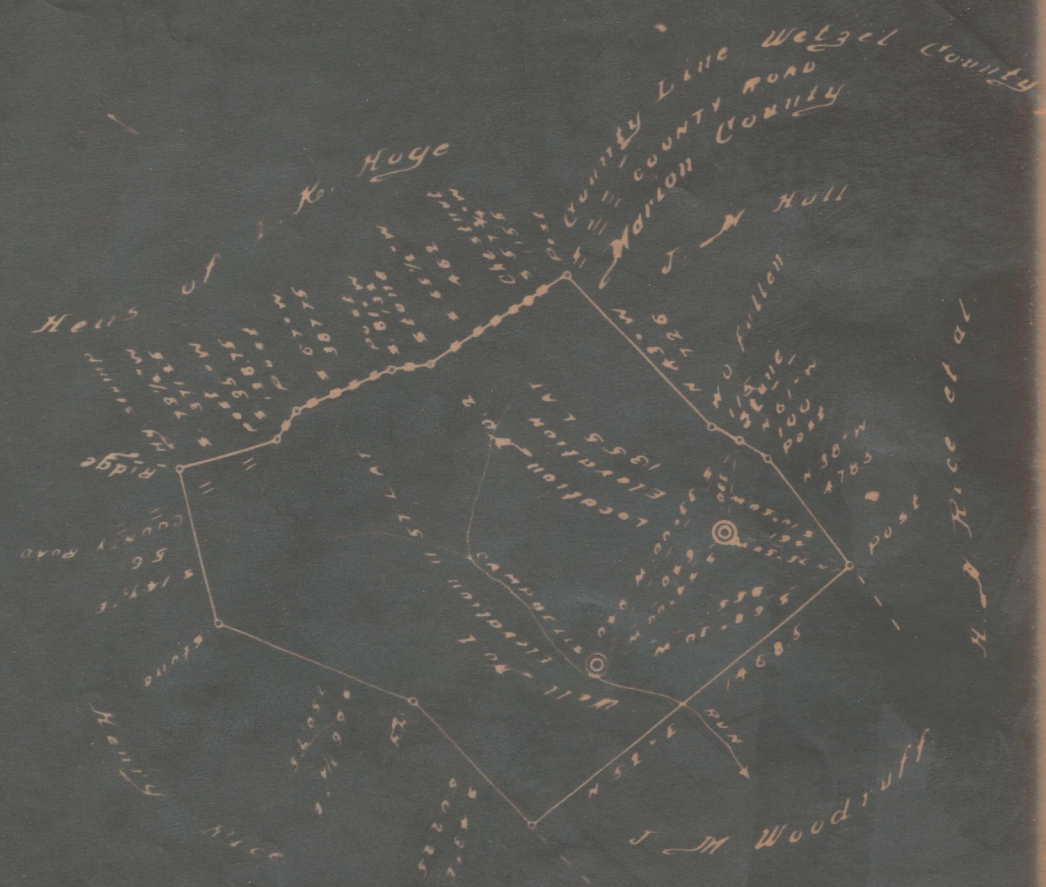

I, the undersigned hereby certify this map
 correct, and shows all the information to the
 best of my knowledge, as required by the
 Oil and Gas section of the Mining Law
 West Virginia. David Weed, Engineer.
 Acknowledged before me a Notary Public
 this 19th day of March, 1932

— R. A. Rymer, Notary Public

My commission expires the 11th day of
 September, 1938.

NAME	COLOR	CHARACTER	OIL, GAS OR WATER	TOP	BOTTOM	THICK- NESS	TOTAL DE- PTH	RE- MARKS
Conductor				12ft				
Mapletown Coal				1120	1123			
Pittsburgh Coal				1225	1232			
Little Dunkard				1690	1700			
Big Dunkard				1710	1867			
Gas Sand				1900	1985			
First Salt Sand				2055	2100			
Second Salt Sand				2130	2160			
Little Lime				2440	2450			
Pencil Cave				2450	2456			
Big Lime				2456	2495			
Big Injun Sand				2495				
First Gas Pay				2500	2518			
2nd Gas Pay				2578	82 ft. in sand			
Feb. 25, 1932, first shut down								
June 29, 1931, small gas well								
Second drilling, Jan. 25th, 1932								
Completed, Feb. 25, 1932								
MONROE AND LAUGHLIN								

Well was not shot at _____ feet; well was shot at _____ feet.

Salt Fresh water at _____ feet; salt fresh water at _____ feet.

Well was producing *the 82 ft in Injun sand 2 miles up.*
Monroe & Laughlin

February 25, 1932 Approved *By R. B. Monroe*

WELL RECORD
FOREMAN'S REPORT
MONROE AND LAUGHLIN

7-11-517

Farm... D. V. Liking..... Well No. 1.....

Date November 1924.....

Work Done: By, W. W. Laughlin.....

Conductor 16 ft.

Mapletown Coal 940 - 943

Pittsburgh " 1040 - 1047

Little Dunkard 1436 - 1456

Big " 1530 - 1600

Gas Sand 16 15 - 1690

1st Salt Sand 1800 - 1845

Water 1810

2nd Salt Sand 1850 - 1895

3rd Salt Sand 1900 - 1930

Little Lime 2248 - 2257

Pencil Cave 2257 - 2260

Big Lime 2260 - 2330

Big Injun 2330 - 2470

Dry, no oil, no gas, no water

Fifty Foot 3010 - 3045

Thirty " 3059

Oil at 3069 - 3070

Drilled down to 3380 Dry

Filled back up to 3075 and shot 10 qt.

made 2 Bbls. per week. Kept it to hold
lease

Casing

98 ft. 10 in.

1530 ft. 8 1/2 in. 8 1/2 casing pulled

2535 ft. 6 5/8 in.

Little Kanawha Syndicate Mines

COAL OPERATOR

Monroe and Laughlin

NAME OF WELL OPERATOR

Box 716, Morgantown, W. Va.

ADDRESS

257 E. Main St., Clarksburg, W. Va.

COMPLETE ADDRESS

Samuel D. Brady, Jr.
Gen. Agent and Consulting Engr

COAL OPERATOR

By S. D. Monroe

April 23

1932

WELL AND LOCATION

ADDRESS

Martinsburg District

COAL OPERATOR

Marion County

ADDRESS

Well No. 1

1.7. Line 57.21 acres Farm

AFFIDAVIT TO BE MADE IN TRIPPLICATE. ONE COPY TO BE MAILED BY REGISTERED MAIL TO THE DEPARTMENT. ONE COPY TO BE RETAINED BY THE WELL OPERATOR AND THE THIRD COPY (AND EXTRA COPIES IF REQUIRED) TO BE MAILED TO EACH COAL OPERATOR ABOVE NAMED AT THEIR RESPECTIVE ADDRESSES.

AFFIDAVIT

STATE OF WEST VIRGINIA,

County of Marion

ss:

S. K. Thomas and Ray Laughlin

being first duly sworn according to law depose and say that they are experienced in the work of plugging

and filling oil and gas wells and were employed by Monroe and Laughlin, well operator, and participated in the work of plugging and filling the above well, that said work was commenced on the

4th day of April, 1932, and that the well was plugged and filled in the following manner:

Manner in which sand was plugged:

in 6 5/8

Manner in which coal was plugged:

(THE ABOVE DESCRIPTIONS MUST BE IN DETAIL AND IN ACCORDANCE WITH THE PROVISIONS OF SECTION 10, OIL AND GAS ACT OF 1932.)

and that the work of plugging and filling said well was completed on the 21 day of May, 1932

1932

And further deponents saith not.

S. K. Thomas
Ray Laughlin

Sworn to and subscribed before me this 25th day of May, 1932

W. C. Watson
Notary Public

NOTICE OF INTENTION TO PLUG AND ABANDON WELL
(REQUIRED BY SECTION 9, ARTICLE 4, CHAPTER 22 OF THE CODE)
WEST VIRGINIA DEPARTMENT OF MINES
OIL AND GAS DIVISION

TO THE DEPARTMENT OF MINES,
Charleston, W. Va.

Monroe and Laughlin
NAME OF WELL OPERATOR

Little Kanawha Syndicate Lines
COAL OPERATOR OR COAL OWNER

253 E. Main St., Clarksburg, W. Va.
COMPLETE ADDRESS

Box 716, Morgantown, W. Va.
Sammel D. Brady, Jr.,
Gen. Agent and Consulting Engr.

By, R. S. Monroe

March 26th 19**22**

WELL TO BE ABANDONED

ADDRESS

LEASE OR PROPERTY OWNER

A' CRESS

Marion District

Marion County

Well No. **81**

D. V. Lining 57.24 acres Farm

*3
Little
Kawha*

Gentlemen:—

The undersigned well operator is about to abandon the above described well and will commence the work of plugging and abandoning said well on the 4th day of April, 1922, (which date shall not be less than five days after the day on which this notice so mailed is received, or in due course should be received by the Department of Mines).

This notice is given you in order that your respective representatives may be present at the plugging and filling of said well. You are further notified that whether you are represented or not represented the undersigned will proceed on that date, or shortly thereafter, to plug and fill said well in the manner required by Section 10, Article 4, Chapter 22 of the Code and given in detail on the reverse side of this notice, in "Work Order."

This notice is being mailed by registered mail to each of you at the above addresses on the above date.

Very truly yours,

Monroe and Laughlin
Well Operator.
By, **R. S. Monroe**

NOTE: Upon the abandonment of all wells drilled prior to June 1, 1920, a plat prepared by a competent engineer, showing the district and county in which the tract of land is located, the name and acreage of same, the names of the owners of adjacent tracts, and the location of the about to be abandoned well, determined by survey, and the courses and distances of such well from two permanent points or landmarks on said tract, shall be submitted with this notice.

(Over)

WORK ORDER

Well to be plugged and filled as follows:

Run male and female plug at 1850 ft. in 6 5/8 casing and fill with cement to 1780 ft. and cut the casing there and run male and female plug, pull two joints and run cement in hole in bqiler using dump rod and let run down around the outside of the 6 5/8 casing. Thence pull casing to 1700 ft. and put in bridge. Cement and red mud Pull casing to 1600 ft. and fill hole with cement and red mud to 1600 feet and there drive male and female plugs, and from there to 1010 ft. set bridge and cement through Pittsburgh coal solid to a measurement 920 ft. See letter attached from Little Kanawha Syndicate Lines, by S. D. Brady, Engineer, granting privelege to cement coal solid, and from 920 ft. fill to top with red mud and clay and erect a marker of cement 12 x 12 x 8 x 8, and 3 ft. high over old hole.

To the Department of Mines,
Coal Owner or Operator,
Lease or Property Owner.

Gentlemen:

This "work order" is submitted for your approval and concurrence and unless notified of your disapproval or non-currence, the undersigned will proceed with the plugging and filling of said well in the above described manner on the date stated in the notice of intention to plug and abandon the said well on opposite side of this sheet.

Very truly yours,

Well Operator.

No objections have been filed by the coal owner or coal operator, or any available adjacent lease or property owners or interposed by the Department of Mines to the manner herein described for the plugging and filling of the well above mentioned. Therefore, the same is hereby approved this 28th day

of March, 1932.

DEPARTMENT OF MINES
Oil and Gas Division

D M

OK
2.7.73

Run male and female plug 1850 ft. casing and fill with cement to 1780 ft. and cut the casing there and ran male and female plugs. Pull casing up two joints and ran cement in hole in bailer using dump rod to let down around the outside at the 6 5/8 casing. Thence pull casing to 1700 ft. put in a bridge cement and red mud, thence pull casing to 1600 ft. and fill hole with cement and red mud to 1600ft. and there ran male and female plug and from there to 1010 ft. set bridge and cemented through Pittsburgh coal solid to a measurement of 920 ft. and from that distance filled solid with red mud and clay to top and erected marker of cement 12 x 12 x 3x9 and 3 ft. high over the old hole.

D. V. Lining, No. 1