

LATITUDE 39 35

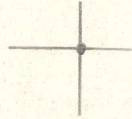

1.27 S  
.58 W

LONGITUDE 80 07 30

7'5 OGIS topo location

7.5' loc \_\_\_\_\_ 15' loc \_\_\_\_\_  
(calc.) \_\_\_\_\_

Company \_\_\_\_\_

Farm J N & NA MICHAEL 71

Quad GRANT TOWN

County MARION

District PAW PAW

WELL LOCATION MAP

File No. 30059

PLAN OF LOCATION OF WELL No. 71

being Well No. 1 in J. L. & A. Michael Tract of A. O. acres;  
located in Parish, Louisiana State, MOBILE County.

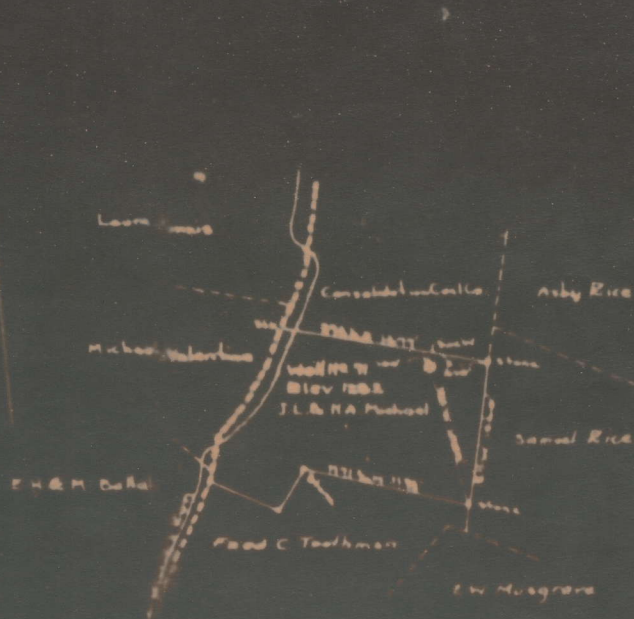

Coordinates of well is as on the map.

*Mar 59 A*

Scale 1" = 1000'

ENGINEER'S CERTIFICATE

I, the undersigned, do hereby certify that the map is correct and shows all the information to the best of my knowledge and belief, respectively, by the oil and gas laws of the Mining Laws of West Virginia.

*T. S. Flannery*  
Engineer

Acknowledged before me this 1st day of March 1959 at Mobile, Louisiana  
*Henry Public*

Paw Paw District, Marion County, W. Va.  
By Owens-Illinois Glass Co., Gast Dept., Charleston, W. Va.  
On 40 acres, on Ministers Run; surface ~~with~~ owned by  
J. L. and N. A. Michael, Fairmont, W. Va., coal rights  
by Consolidation Coal Co. and Continental Coal Co.,  
Fairmont, W. Va., and oil and gas rights by J. L. Michael  
and F. C. Toothman, Fairmont, W. Va.

Elevation, 1251.2' L.

16" conductor, 16'; 10" casing, 638' 6"; 6-5/8", 1646';

8 1/2", 889' (set at 1267'); 2" tubing, 2477'.

Heeter Com. Anchor wall packer, 6-5/8 x 2 x 16, set at 1890'.

Coal was encountered at 180-183, 457-464, and 569-577' (15-18, 120-2').

10" casing cemented through Pittsburgh Coal (top, 569') from  
50' below to 50' above. Used 30 sacks of cement and 60  
sacks of sand. Cemented 1-31-25.

Abandonment reported to Dept. of Mines April 18, 1932.

Well was not shot.

Fresh water at 570'; salt water at 1560'.

Gas well.

	Top.	Bottom.	Thickness.
Surface, gravel	0	15	15
Coal	15	18	3
Slate	18	120	102
Coal	120	122	2
Slate	122	180	58
Coal	180	183	3
Slate and lime	183	420	237
Sand	420	450	30
Slate	450	457	7
Mapletown (Sewickley) Coal	457	464	7
Slate	464	470	6
Lime	470	485	15
Slate	485	495	10
Hard lime	495	525	30
Slate	525	569	44
Pittsburgh Coal	569	577	8
Slate	577	628	51
Lime	628	643	15
Slate	643	785	142
Sand	785	840	55
Slate	840	970	130
Little Dunkard Sand	970	1000	30
Slate	1000	1145	145
Big Dunkard Sand	1145	1210	65
Slate	1210	1218	8
Lime	1218	1240	22
Gas Sand	1240	1340	100
Slate	1340	1360	20
First Salt Sand	1360	1460	100
Slate	1460	1500	40
Second Salt Sand	1500	1740	240
Red rock	1740	1830	90
Lime and slate	1830	1844	14
Little Lime	1844	1854	10
Pencil Cave	1854	1862	8

(OVER)

MAR-57A?

J. L. & N. A. MICHAEL NO. 71 WELL (Continued).  
 (OR MICHAEL & TOOTHMAN NO. 71)

	Top.	Bottom.	Thickness.
Big Lime	1862	1930	68
Big Injun Sand (gas, 2020-2025')	1930	2034	104
Slate and shells	2034	2118	84
Sand	2118	2175	57
Slate and shells	2175	2394	219
Hard lime	2394	2425	31
Slate	2425	2437	12
Gantz Sand (gas, 2423-2442')	2437	2477	40
Slate	2477	2487	10
Fifty-foot Sand	2487	2530	43
Slate	2530	2535	5
Thirty-foot Sand	2535	2600	65
Red rock	2600	2608	8
Sand	2608	2628	20
Slate and lime shells	2628	2665	37
Red rock	2665	2695	30
Gordon Stray Sand	2695	2710	15
Slate and shells	2710	2870	160
Fourth Sand	2870	2895	25
Slate	2895	2937	42
Fifth Sand	2937	2980	43
Slate	2980	3050	70
Lime	3050	3075	25
Slate	3075	3110	35
Total depth		3110	
Hole plugged back to		2482	
Stones, etc.	3110-2937		
3' wood plug,	2937-2934		
Open hole,	2934-2482		
Bridged at	2482		