

LATITUDE 39 32 30

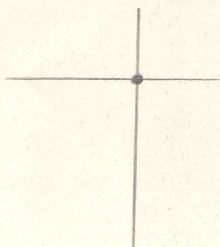

605
1.69 W

LONGITUDE 80 10

7'5 OGIS topo location

7.5' loc _____ 15' loc _____
(calc.) _____

Company _____ 6877

Farm M C SNODDERLY

Quad GRANT TOWN

County MARION

District LINCOLN (FAIRMONT)

WELL LOCATION MAP

File No. 30102

Plat of Well N° 6877.
 Hope Natural Gas Company
 M. C. Snoderly
 Lincoln

District Marion

of the
 Clarksburg, W. Va. on the
 Farm consisting of 65 Acres
 County W. Va.

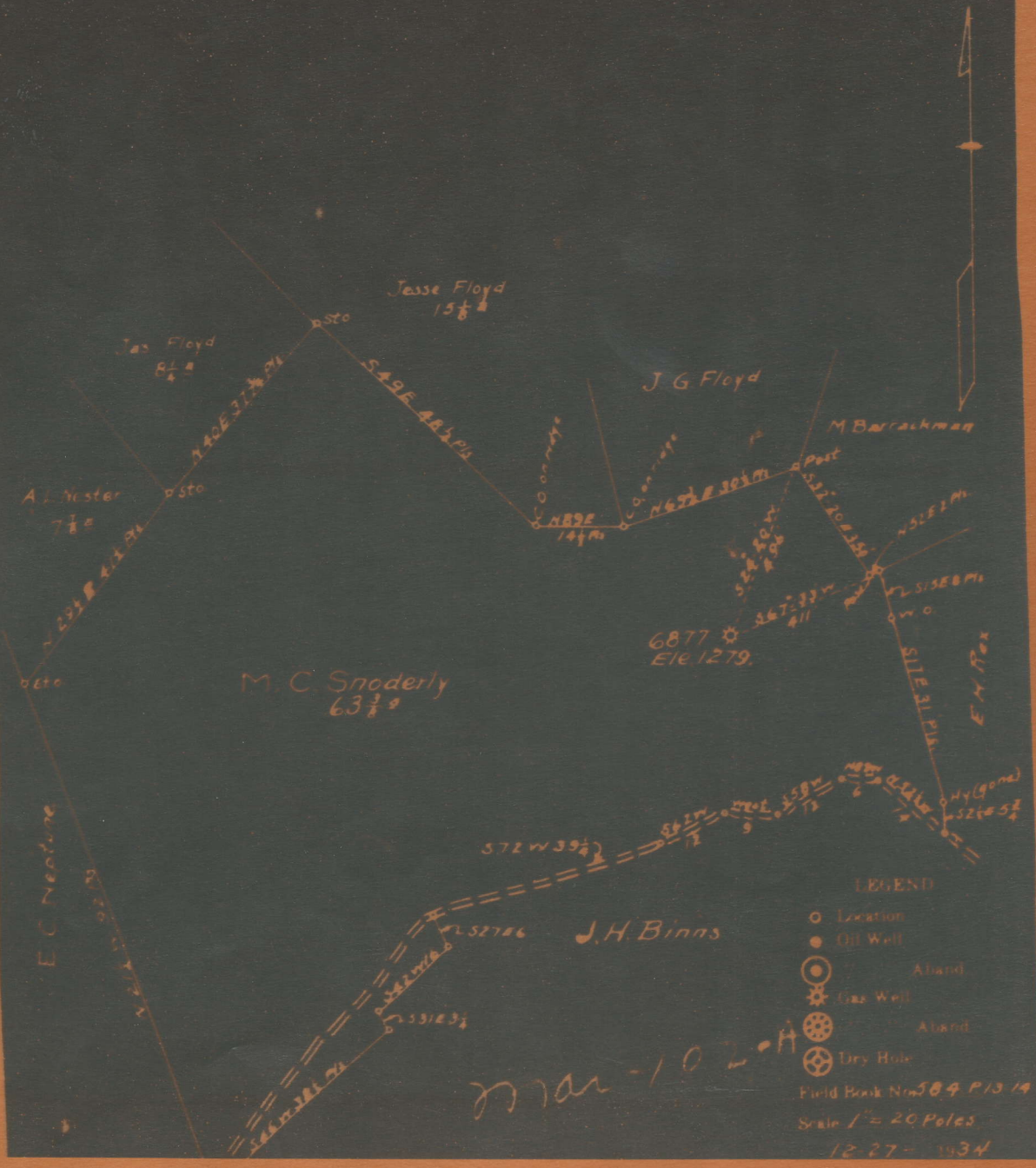

Lincoln District, Marion County, W. Va.

By Hope Natural Gas Co., 445 W. Main St., Clarksburg, W. Va.

On 65 acres, surface owned by Lawrence Conoway, Route 2,

Fairmont, W. Va., and mineral rights by New England Fuel & Transportation Co., Grant Town, W. Va.

Elevation, 1279' L.

10" casing, 658'; 8 $\frac{1}{2}$ ", 1102'; 6-5/8", 1339'.

Coal was encountered at 120-126, 174-179, 470-478, and 593-600'.

Abandonment reported to Dept. of Mines Dec. 31, 1934.

Well was shot at 2026-2034'. 5" liner, 537'; bottom at 1887'.

Fresh water at 40'; no salt water recorded.

Gas well; now exhausted to extent that it is no longer commercially productive.

2" tubing, 2030'.

	Top.	Bottom.	Thickness.
Fresh water at 40'			
Native coal	120 -	126	6
Waynesburg Coal	174 -	179	5
Mapletown (Sewickley) Coal	470 -	478	8
Pittsburgh Coal	593 -	600	7
Big Dunkard Sand	1095 -	1131	36
Gas Sand (gas, 1281-1285 and 1293-1302')	1263 -	1310	47
First Salt Sand	1334 -	1352	18
Second Salt Sand	1420 -	1445	25
Third Salt Sand	1550 -	1620	70
Maxton Sand	1718 -	1742	24
Little Lime	1833 -	1848	15
Pencil Cave	1848 -	1860	12
Big Lime	1860 -	1923	63
Big Injun Sand (gas, 2027-2034')	1923 -	2060	127
Total depth		2082	

MAR-102-A