

LATITUDE 39 35

LONGITUDE 86 27 30

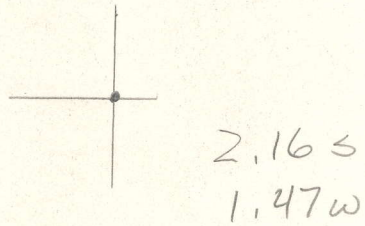

7'5 OGIS topo location

7.5' loc \_\_\_\_\_ 15' loc \_\_\_\_\_  
 \_\_\_\_\_ (calc.) \_\_\_\_\_

Company \_\_\_\_\_

Farm T. J. TOTHMAN 4

Quad GLOVER GAP

County MARION

District MANNINGTON

WELL LOCATION MAP

File No. 30130

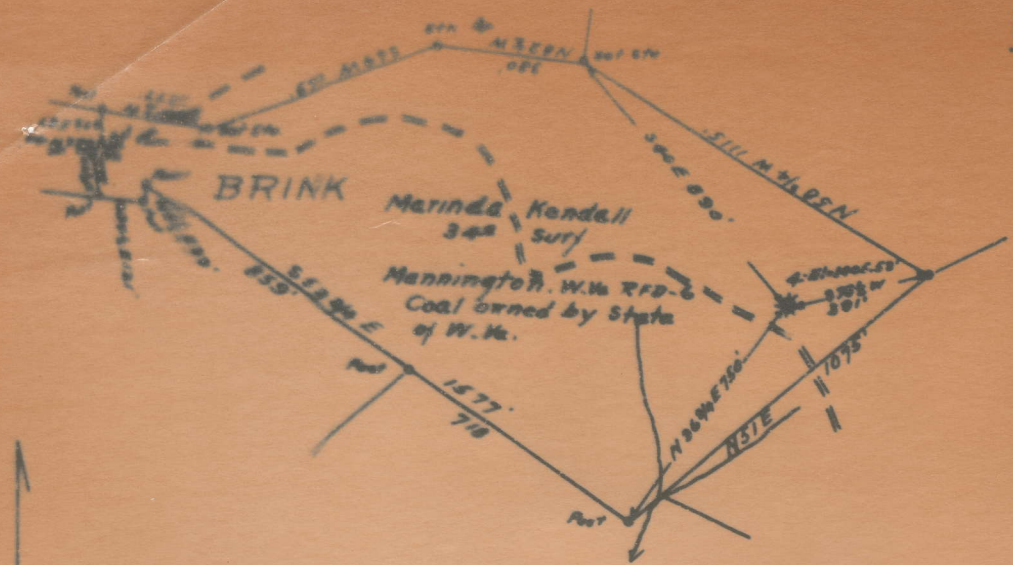

Company South Penn Oil Co  
 Address 411 - 7th Ave. Pittsburgh, Pa  
 Form T. d. Toothman  
 Tract - Acres 24 Lease No. 70269  
 Well (Farm) No. 6 Serial No. -  
 Quadrangle Mannington  
 County MARIETTA  
 District Mannington  
 Engineer E. C. Toliver  
 Engineer's Registration No. -  
 File No. - Drawing No. -  
 Date Apr. 7 - 1936 Scale 1" = 100'

STATE OF WEST VIRGINIA  
 DEPARTMENT OF MINES  
 OIL AND GAS DIVISION  
 CHARLESTON

**WELL LOCATION MAP**  
 FILE NO. MAR-150

† Denotes location of well on United States Topographic Maps, scale 1 to 62,500, latitude and longitude lines being represented by border lines as shown.

- Denotes one inch spaces on border: line of original tracing.



Mannington District, Marion County, W. Va.

By South Penn Oil Co., Chamber of Commerce Bldg., Pittsburgh, Pa.

On 3/4 acres, surface and mineral rights owned by Marinda B.

Kendall, Mannington, W. Va.

Elevation, 1405.53' L.

16' conductor; 10" casing, 395'; 8 1/2", 1539' 8".

Coal was encountered at 1075-1079 and 1180-1186'.

Abandonment reported to Dept. of Mines April 17, 1936.

Gas well.

MAR-130-A

	Top.	Bottom.
Mapletown (Sewickley) Coal	1075	1079
Pittsburgh Coal	1180	1186
Little Dunkard Sand (gas, 1515')	1510	
Total depth		1527