

LATITUDE 39°35'

LONGITUDE 80°25'

Surface:

Jas. D. Charlton
Mannington, W. Va.

Coal:

The Union Trust Co. "Trustee"
Pittsburgh, Pa.

Elev. # 1 1342.04
4 1202.99

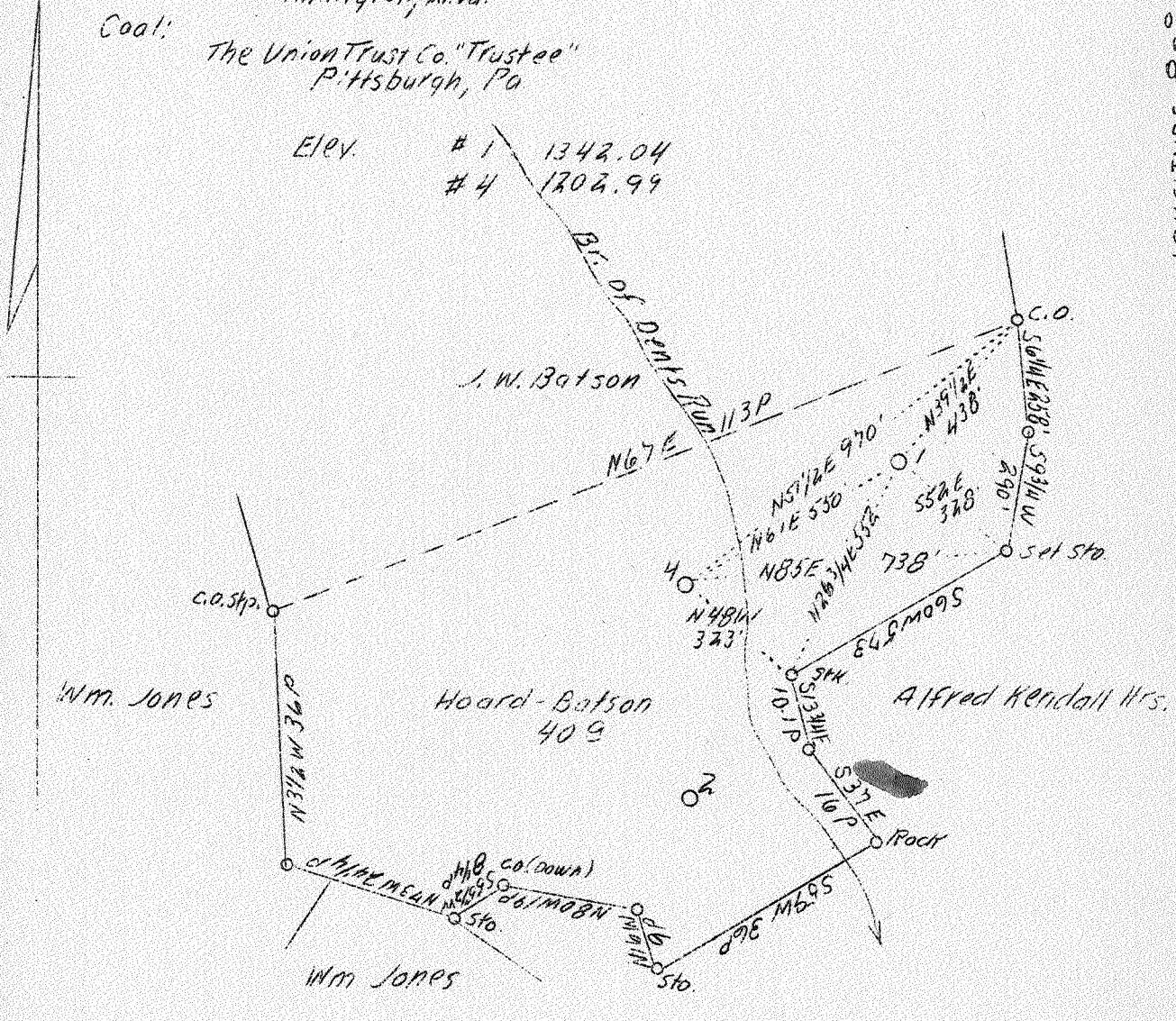

Alfred Kendall Hrs.

.15 W	# 1	0.16 W
.45		0.4 A
# 4		0.29 W
		0.45 A

ABD.

AUG 14 1939

Company South Penn Oil Co.
 Address 411-7th Ave., Pgh. Pa.
 Farm Hoard - Batson
 Acres 40
 Lease No. 69215 - 69216
 Well (Farm) No. 1 and 4
 Elevation (SL) 1-1342.04 - 4-1202.99
 Quadrangle Mannington
 County Marion
 District Mannington
 Engineer E. C. Tabler
 Eng. Reg. No. -
 Date June 26, 1939
 Scale 1" - 400'

STATE OF WEST VIRGINIA
 Department of Mines
 OIL & GAS DIVISION
 Charleston

WELL LOCATION MAP

File No. M01-221-222-A

x Denotes location of well on U. S. Topographic Maps, scale 1 to 62,500, latitude and longitude lines being represented by border lines as shown.

- Denotes one inch spaces on border line of original tracing.

(SW)

WEST VIRGINIA DEPARTMENT OF MINES
OIL AND GAS DIVISION

319

WELL RECORD

Permit No. 221-A
Mannington Sw.

Oil or Gas Well OIL
(Kind)

Company South Penn Oil Company
Address 411 Seventh Ave., Pittsburgh, Pa.
Farm Hoard-Batson Acres 40
Location (waters) Dents Run
Well No. 1 Elev. 1342.04¹⁶
District Mannington County Marion
The surface of tract is owned in fee by Jas. D. Charlton
Mannington, W. Va.
Mineral rights are owned by Zebedee Batson
R. D. No. 5 Address Mannington, W. Va.
Drilling commenced May 25, 1916
Drilling completed July 16, 1916
Date shot 7-16-19 Depth of shot B. Injun
8-17-17
Open Flow /10ths Water in - Inch
/10ths Merc. in - Inch
Volume - Cu. Ft.
Rock Pressure - lbs. - hrs.
Oil 60 bbls., 1st 24 hrs.
Fresh water 1870 feet - feet
Salt water 2020 feet 2040-2060 feet

Casing and Tubing	Used in Drilling	Left in Well	Packers
Size			Kind of Packer
13			-
10	388' 7"		Size of
8 1/4	1568'		-
6 5/8	2330'		Depth set
5 3/16			-
3			Perf. top
2			Perf. bottom
Liners Used			Perf. top
Cond	16		Perf. bottom

CASING CEMENTED - SIZE - No. FT. - Date -
COAL WAS ENCOUNTERED AT 995 FEET 60 INCHES
1098 FEET 84 FEET INCHES
INCHES FEET INCHES FEET INCHES

Formation	Color	Hard or Soft	Top	Bottom	Oil Gas or Water	Depth Found	Remarks
Mapletown Coal			995	1000			
Pittsburgh Coal			1098	1105			
Little Dunkard Sand			1500	1525			
Big Dunkard Sand			1560	1660			
1st Gas Sand			1700	1750			
2nd Gas Sand			1800	1900			
1st Salt Sand			1950	1990	Water	1870	
2nd Salt Sand			2000	2110			
					Water	2020	
					Water	2040	
					Water	2060	Hole full
Maxon Sand			2170	2265			
Little Lime			2325	2332			
Big Lime			2337	2395			
Big Injun Sand			2395				
					Gas	2492	
					Oil	2495	
Total Depth				2498			

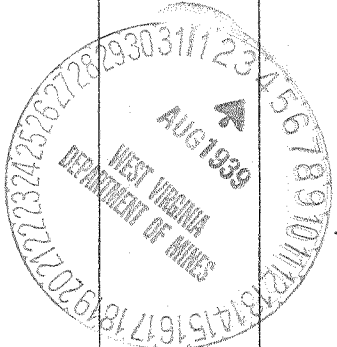

AUG 24 1939

