

Latitude

Longitude



Topo Location

7.5' Loc. \_\_\_\_\_ 15' Loc. \_\_\_\_\_  
 \_\_\_\_\_ (calc.) \_\_\_\_\_

Company \_\_\_\_\_

Farm \_\_\_\_\_

15' Quad \_\_\_\_\_  
(sec.)

7.5' Quad Mammoth

District Mammoth

WELL LOCATION PLAT

County 049 Permit 30824

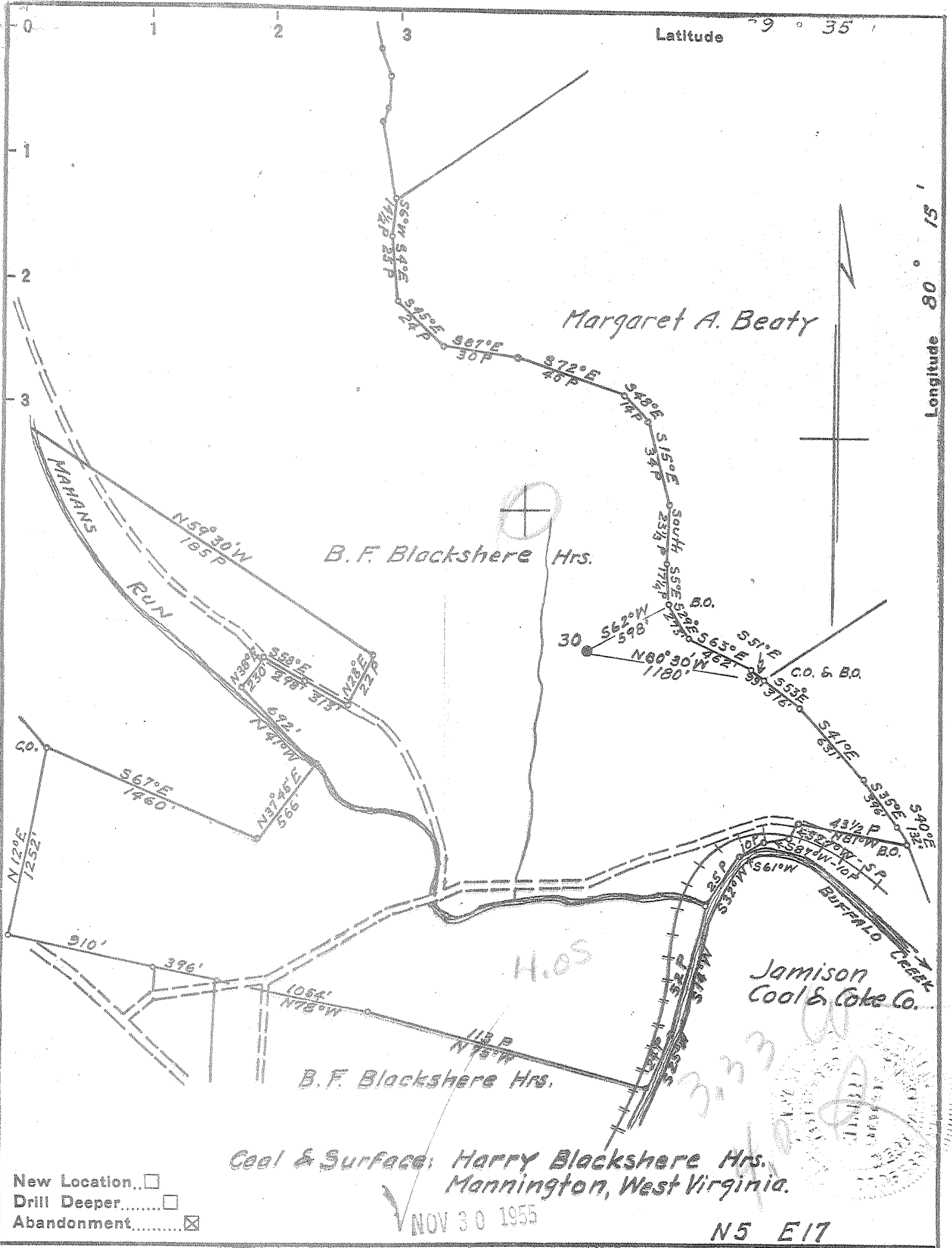

Coal & Surface: Harry Blackshere Hrs.  
Mannington, West Virginia.

NOV 30 1955

N5 E17

- New Location
- Drill Deeper
- Abandonment

Company	<u>South Penn Natural Gas Co.</u>
Address	<u>Parkersburg, W.Va.</u>
Farm	<u>B. F. Blackshere</u>
Tract	Acres <u>130</u> Lease No. <u>14346</u>
Well (Farm) No.	<u>30</u> Serial No. _____
Elevation (Spirit Level)	<u>1153.80 Ground</u>
Quadrangle	<u>Mannington</u>
County	<u>Marion</u> District <u>Mannington</u>
Engineer	<u>Wm. S. Hayes</u>
Engineer's Registration No.	<u>1429</u>
File No.	Drawing No. _____
Date	<u>Oct. 31, 1955</u> Scale <u>1" = 800'</u>

STATE OF WEST VIRGINIA  
DEPARTMENT OF MINES  
OIL AND GAS DIVISION  
CHARLESTON

**WELL LOCATION MAP**  
FILE NO. MAR-824-A

+ Denotes location of well on United States Topographic Maps, scale 1 to 62,500, latitude and longitude lines being represented by border lines as shown.

- Denotes one inch spaces on border line of original tracing.

B, F. BLACKSHERE NO. 30 - SOUTH PENN N. 6, 16, - MAR-824A