

7/18/78 R

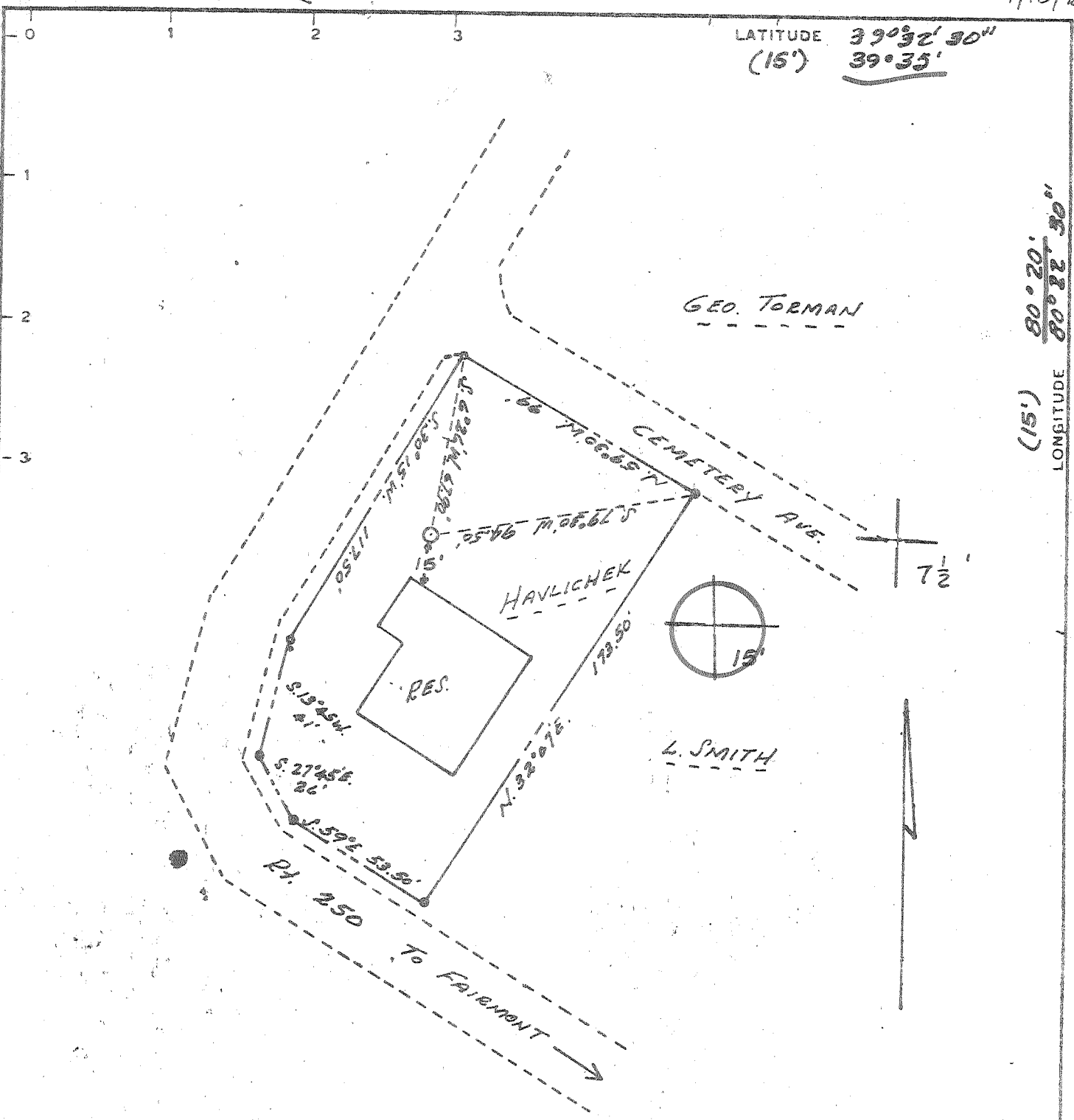

LATITUDE $39^{\circ}32'30''$
(15') $39^{\circ}35'$

LONGITUDE $80^{\circ}20'30''$
(15') $80^{\circ}22'30''$

Minimum Error of Closure 1 in 200

Source of Elevation Consol. map

H.24S
2.44W

I, the undersigned, hereby certify that this map is correct to the best of my knowledge and belief and shows all the information required by paragraph 6 of the rules and regulations of the oil and gas section of the mining laws of West Virginia

- Fracture
- New Location
- Drill Deeper
- Abandonment 7/24/78

Signed: *[Signature]*
Squares N S E W

Company J. W. HAYLICHEK, JR.
 Address 501 E. MAIN ST, MANNINGTON, WV
 Farm Burt Mfg. Co.
 Tract _____ Acres 83 Lease No. 57836
 Well (Farm) No. 12 Serial No. _____
 Elevation (Spirit Level) _____ 993.2
 Quadrangle Mannington *SC*
 County Marion District Mannington
 Engineer [Signature]
 Engineer's Registration No. _____
 File No. _____ Drawing No. _____
 Date 7/13/78 Scale 1" = 50'

STATE OF WEST VIRGINIA
DEPARTMENT OF MINES
OIL AND GAS DIVISION
CHARLESTON

WELL LOCATION MAP
FILE NO MAR-981-A

+ Denotes location of well on United States Topographic Maps, scale 1 to 62,500, latitude and longitude lines being represented by border lines as shown. *24,000*
AUG 7 1978
- Denotes one inch spaces on border line of original tracing.
47-049