



west virginia department of environmental protection

Office of Oil and Gas
601 57th Street, S.E.
Charleston, WV 25304
(304) 926-0450
fax: (304) 926-0452

Harold D. Ward, Cabinet Secretary
www.dep.wv.gov

Monday, October 31, 2022
WELL WORK PLUGGING PERMIT
Vertical Plugging

WEST VIRGINIA LAND RESOURCES, INC.
46226 NATIONAL ROAD WEST

ST. CLAIRSVILLE, OH 43950

Re: Permit approval for 3403
47-051-00010-00-00

This well work permit is evidence of permission granted to perform the specified well work at the location described on the attached pages and located on the attached plat, subject to the provisions of Chapter 22 of the West Virginia Code of 1931, as amended, and all rules and regulations promulgated thereunder, and to any additional specific conditions and provisions outlined in the pages attached hereto. Notification shall be given by the operator to the Oil and Gas Inspector at least 24 hours prior to the construction of roads, locations, and/or pits for any permitted work. In addition, the well operator shall notify the same inspector 24 hours before any actual well work is commenced and prior to running and cementing casing. Spills or emergency discharges must be promptly reported by the operator to 1-800-642-3074 and to the Oil and Gas Inspector.

Upon completion of the plugging well work, the above named operator will reclaim the site according to the provisions of WV Code 22-6-30. Please be advised that form WR-38, Affidavit of Plugging and Filling Well, is to be submitted to this office within 90 days of completion of permitted well work, as should form WR-34 Discharge Monitoring Report within 30 days of discharge of pits, if applicable. Failure to abide by all statutory and regulatory provisions governing all duties and operations hereunder may result in suspension or revocation of this permit and, in addition, may result in civil and/or criminal penalties being imposed upon the operators.

Per 35 CSR 4-5.2.g this permit will expire in two (2) years from the issue date unless permitted well work is commenced. If there are any questions, please feel free to contact me at (304) 926- 0450.

James A. Martin
Chief

Operator's Well Number: 3403
Farm Name: McCRACKEN, BYRON
U.S. WELL NUMBER: 47-051-00010-00-00
Vertical Plugging
Date Issued: 10/31/2022

I

4705100010P

PERMIT CONDITIONS

West Virginia Code § 22-6-11 allows the Office of Oil and Gas to place specific conditions upon this permit. Permit conditions have the same effect as law. Failure to adhere to the specified permit conditions may result in enforcement action.

CONDITIONS

1. All pits must be lined with a minimum of 20 mil thickness synthetic liner.
2. In the event of an accident or explosion causing loss of life or serious personal injury in or about the well or while working on the well, the well operator or its contractor shall give notice, stating the particulars of the accident or explosion, to the oil and gas inspector and the Chief within twenty-four (24) hours.
3. Well work activities shall not constitute a hazard to the safety of persons.

11/04/2022

4705100010 P

WW-4B
Rev. 2/01

1) Date SEPTEMBER 26, 20 22
2) Operator's
Well No. M-1567
3) API Well No. 47-051-00010

STATE OF WEST VIRGINIA
DEPARTMENT OF ENVIRONMENTAL PROTECTION
OFFICE OF OIL AND GAS

APPLICATION FOR A PERMIT TO PLUG AND ABANDON

4) Well Type: Oil ___ / Gas X / Liquid injection ___ / Waste disposal ___ /
(If "Gas, Production ___ or Underground storage ___) Deep ___ / Shallow ___

5) Location: Elevation 1215.08' Watershed GRAVE CREEK
District CAMERON County MARSHALL Quadrangle CAMERON WV, PA

6) Well Operator WEST VIRGINIA LAND RESOURCES INC.
Address 1 BRIDGE STREET
MONONGAH, WV 26554

7) Designated Agent DAVID ROPPY
Address 1 BRIDGE STREET
MONONGAH, WV 26554

RECEIVED
OIL AND GAS
OCT 06 2022
WV Department of
Environmental Protection

8) Oil and Gas Inspector to be notified
Name STRADER GOWER
Address 2525W ALEXANDER RD.
VALLEY GROVE, WV 26060

9) Plugging Contractor
Name _____
Address _____

10) Work Order: The work order for the manner of plugging this well is as follows:

See Exhibit No. 1

⚡

MSHA 101 C
EXEMPTION

Notification must be given to the district oil and gas inspector 24 hours before permitted work can commence.

Work order approved by inspector Strader Gower Date 9/30/2022

11/04/2022

EXHIBIT No.1

From the experience and technology developed since 1970 in plugging oil and gas wells for the mining through, West Virginia Land Resources will utilize the following method to plug all future wells.

SOLID PLUG METHOD**Well Clean Out**

- ★ (a) If active well: Clean out to the total depth and plug back according to the state regulations to a minimum of 200 feet below the lowest minable coal seam.
- ~~(b) If abandoned well: Clean out to the first plug 200 feet below the lowest minable coal seam.~~

★ **Cement**

- (a) Circulate through the tubing or drill steel an expanding Class A cement plug from a minimum of 200 feet below the minable coal seam to a point 100 feet above the minable coal seam.
- (b) Circulate through the tubing or drill steel an expanding Class A cement plug from 100 feet above the coal seam to the surface

A monument will be installed with API number and stating "solid plug."

Marshall County 101C

Docket No. M-2016-016-C

RECEIVED
Office of Oil and Gas

OCT 06 2022

WV Department of
Environmental Protection

101C MSHA Petition Summary
 Marshall County Coal
 Ohio County Coal

I. Definitions

- A. Diligent Effort is defined as pulling 150% casing weight and making at least 3 attempts. Assume casing is 3,000' when length is unknown.

II. Active Well

- A. Check for Methane
 B. Notify MSHA we are plugging an active well
 C. Kill Well
 D. Pull Sucker Rods and tubing
 E. Make Diligent Effort to Pull Casing
 F. If casing cannot be pulled...
 i. Run Bond Log
 1. Discuss Action Plan with Mine Personal
 ii. Notify MSHA that casing cannot be pulled
 iii. Cut, rip, or perforate every 200'. First cut will be 200' above the end of casing up to 200' below Pittsburgh coal
 1. MSHA can waive 200' cuts if bond log shows adequate material behind casing.
 iv. Cut, Rip, or Perforate every 50' from 200' below Pittsburgh to 100' above Pittsburgh (see Appendix A).
 v. Cut, Rip, or Perforate every 5' from 10' below Pittsburgh Coal to 10' above Pittsburgh (see Appendix A).
 G. Pump Class A Cement from TD to 200' below Pittsburgh
 H. Pump Thixotropic Cement from 200' below Pittsburgh to 100' above
 I. Pump Class A cement from 100' above Pittsburgh to surface.
 J. Install Well Marker

RECEIVED
 Office of Oil and Gas

OCT 06 2022

WV Dept. of
 Environment, Planning & Natural Resources

III. Abandoned Well

- A. Check for Methane
 i. Notify MSHA if actively producing methane
 B. Kill Well
 C. If well is less than 4,000' deep, clean out well 220' below Pittsburgh (cleanout an extra 20' to allow for variance in coal elevation).
 D. If well has casing, make diligent effort to pull casing as defined above.
 E. If casing cannot be pulled...
 i. Run Bond Log
 ii. Notify MSHA that casing cannot be pulled
 iii. Cut, Rip, or Perforate every 50' from 200' below Pittsburgh to 100' above Pittsburgh (see Appendix A).

- iv. Cut, Rip, or Perforate every 5' from 10' below Pittsburgh Coal to 10' above Pittsburgh (see Appendix A).
- F. Pump expanding cement under 200 PSI to form a plug 200' below Pittsburgh
- G. Verify plug
- H. Pump Class A Cement from verified plug to 200' below Pittsburgh
- I. Pump Thixotropic Cement from 200' below Pittsburgh to 100' above
- J. Pump Class A cement from 100' above Pittsburgh to surface.
- K. Install well marker

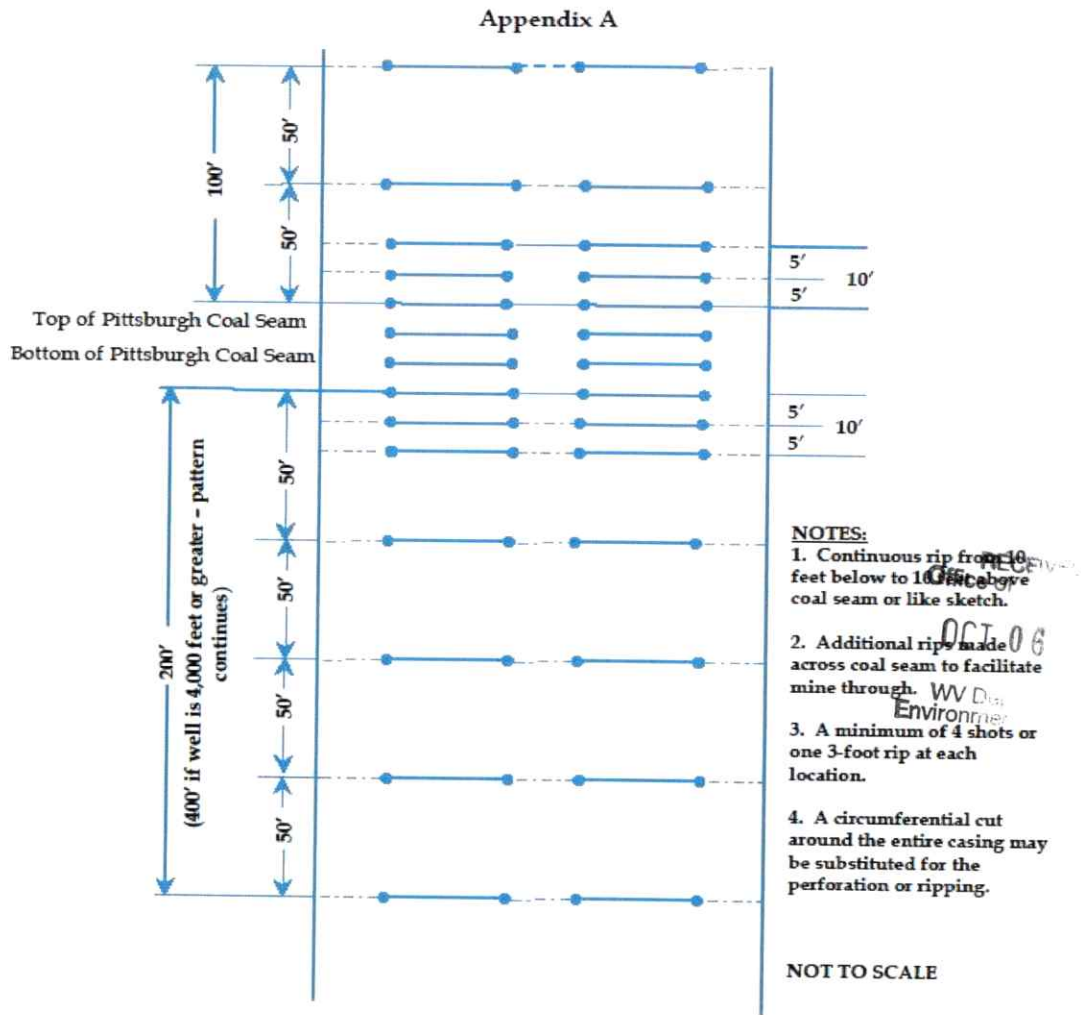

***If the depth is greater than 4,000 feet, all 200' number change to 400' respectively

Record of Well No. 3463 on *W.P. Garrison* Field. *Garrison* County, Pa.
 Rig Commenced *November 10, 1927* Completed *February 1928*
 Drilling Commenced *November 26, 1927* Completed *February 1928*
 Contractor *H. J. McElroy* Address *Garrison, Pa.*
 Drillers' Names *J. H. Moore, Kate Dandum, A. G. Wymer*

BOILER			ENGINE			RIG		
No.	Name of Maker	H.P.	No.	Name of Maker	H.P.	No.	Name of Maker	H.P.

CONDUCTOR AND CASING USED IN DRILLING									
Conductor	30 inch	24 inch	20 inch	18 inch	16 inch	14 inch	12 inch	10 inch	8 inch
16 ft.	204	1105	1945						2761 1/2

CONDUCTOR AND CASING LEFT IN WELL									
Conductor	30 inch	24 inch	20 inch	18 inch	16 inch	14 inch	12 inch	10 inch	8 inch
16 ft.		1105	1945						2761 1/2

When Shot	Kind of Turbine	In. In. Production	Tubing			Remarks
			Top	Bottom	Thickness	
2-12-1930	30 ft. G.V.					4" tubing 10" 105" 1648
Sand			8	14	6	white soft
Bluff Sand			435	480	45	white hard
Haystack Coal			480	484	4	black soft
Waplesburg Coal			684	681	3	black soft
Pgk. Coal black soft			795	801	6	4. Buckets of water per hour
Murphy Sand (interbed)			880	730	50	2% water in 2" opening. Level 8 1/2
Little Runhard			7199	1207	8	hard
Sand			1242	1253	11	light hard
Big Runhard			1300	1343	43	hard
Big Sand			1410	1420	10	hard
East Hill Sand			1495	1513	15	white hard
Second			1585	1615	30	white hard
Third			1635	1690	55	white hard
Matam Sand			1915	1931	16	white hard
Pinel. Coar			1931	1940	9	black soft
Big Limestone			1940	1974	34	white hard
Big Limestone			1974	2214	240	white hard
Thirty Foot Sand (hard)			2515	2233	18	hard
Thirty Foot Sand (hard)			2533	2545	12	hard
Thirty Foot Sand (hard)			2545	2570	25	hard
Twenty Foot Sand (hard)			2734	2765	31	40 water in 2" - Gas 2737.2 2741
London Stray			2800	2810	10	Gas - 2803.6 2807 - with above Gas 2%
London Sand (Very Hard)			2812	2844	32	Gas - 2816.5 2818 - 1 1/2% water
Fourth Sand white hard			2875	2887	11	
Fifth Sand hard			2900	2905	5	
Total Depth				2940		480000 cu ft.

No. 6
 APPROVED BY
 I. G. SUSSEX
I. G. SUSSEX
 SUSSEX CO.

Examined, plans, logs, and measurements and found to be correct by *H. J. McElroy* Superintendent of Drilling
 Examined and approved by *J. H. Schuman* Superintendent of Drilling
 NOTE: - The logs should be filled out carefully by the Contractor, with a complete and accurate record of the Well, and accompany, when forwarded for record the bill for drilling.
 All formations and hours made must be given by their proper name, with size (line measurements), and make the level of "Monitors" must be recorded in what and at what depth the Gas or Water was found, the quantity of same, the quality of the sand, and thickness of pay.
 Make no measurements of holes and engine by contractor.

Division _____ Company _____
 Record of well No. 3403 on B.R. Chambers Farm 4705 Acres
 Field District Towards County State 100010
 Rig Commenced 19 Completed 19
 Drilling Commenced 19 Completed 19
 Contractor _____ Address _____
 Driller's Name _____

CASING AND TUBING RECORD

Conductor	13"	16"	20"	24"	30"	36"	42"	48"	60"

PACKER RECORD

SHOOTING RECORD

No.	Depth Set	Type Packer	Date	Type Explosive	Amount	DEPTH		Volume Below Co. Ft.	Volume Above Co. Ft.
						Top	Bottom		

VOLUME AND PRESSURE

Date	Reading in Inches	Liquid	Gage	Volume	Sand	PRESSURE IN MIN.					St. Hour R. P.	Max. R. P.	Hours	
						1	5	10	20	60				

TOTAL INITIAL OPEN FLOW

CUBIC FEET PER 24 HOURS

FORMATION	TOP	BOTTOM	THICKNESS	REMARKS	2570	2665	93
Clay black soft	0	8	8	Slate dark soft	2570	2665	93
Slate & shells	14	435	421	Pink Rock soft	2665	2670	3
Limestone white hard	484	684	200	Lime light soft	2670	2734	64
Lime light hard	668	700	32	Shells white soft	2765	2800	34
Slate light soft	700	795	95	Slate dark soft	2810	2812	2
Lime white hard	801	880	79	Slate white soft	2814	2879	33
Slate white soft	930	985	55	Slate dark soft	2887	2900	13
Red Rock red soft	985	1110	25	Slate dark soft	2905	2940	35
Limeshells gray soft	1110	1190	80				
Red Rock red soft	1190	1199	9				
Slate light soft	1207	1217	10				
Lime light hard	1217	1232	15				
Slate light soft	1232	1242	10				
Shale black soft	1253	1300	47				
Slate dark soft	1348	1410	62				
Black shale soft	1420	1498	78				
Slate dark soft	1513	1533	20				
Lime hard white	1533	1553	20				
Slate soft white 1553	1553	1585	32				
Slate white soft	1615	1635	20				
Slate dark soft	1690	1730	40				
Lime white hard	1730	1742	12				
Slate dark soft	1742	1775	33				
Lime white hard	1775	1795	20				
Slate white soft	1795	1915	120				
Slate dark soft	2214	2230	16				
Slate & shale dark	2230	2425	195				
Slate dark soft	2425	2515	90				

RECEIVED
 Office of Oil and Gas
 OCT 06 2022
 WV Department of Environmental Protection

Standard above information and measurements had found to be correct by

Standard and Approved by

Contractor

Field Superintendent

The above blank must be filled out carefully by the contractor, with a complete and accurate record of the well, and accompany, when presented for payment of the bill for this work. All formations and known sands must be given by their proper name, with exact line measurements, and under the head of "Remarks" must be recorded in what sand and what depth Oil, Gas or Water was found, the quantity of same, the quality of the sand, and thickness of bed.

11/04/2022

4705100010P
Mun-10

WEST VIRGINIA DEPARTMENT OF MINES

OIL & GAS SECTION

PRELIMINARY DATA SHEET NO. 1

File No. _____ Well No. 3405

The Manufacturers Light & Heat Company, of 800 Union Trust Bldg.,
Pittsburgh, Pennsylvania, on the B. R. Chambers Farm
containing 105 acres. Location _____
Cameron District, in Marshall County, W. Va.

The surface of the above tract is owned in fee by B. R.
Chambers of R D, Cameron, W. Va., address, and the
mineral rights are owned by The Manufacturers Light & Heat Co., of Pittsburgh, Pa.

The oil and gas privileges are held under lease by the
above named company, and this well is drilled under permit No. _____
issued by the West Virginia Department of Mines, Oil and Gas Section,
November 1st 1929.

Elevation of surface at top of well, 1225' Spirit
Baremetric.

The number of feet of the different sized casings used in the well.

16 feet 13" size.. Wood conductor.

1109 1/2 feet 8 1/4" size, csg. 204 feet 10" sized csg. All Palled

1946 1/2 feet 6 7/8" size, csg. _____ feet _____ sized csg.

2961 1/2 feet 4" size, Tubing _____ feet _____ sized csg.

Anchor packer of 6 7/8" x 4" size, set at 2561 1/2 ft.

_____ packer of _____ size, set at _____

4 in. Tubing perforated at 2916 1/2 feet to 2916 1/2 feet.

4 in. Tubing perforated at 2727 3/4 feet to 2727 3/4 feet.

Coal was encountered at 480 feet; thickness 4' 00 inches, and

684 feet; thickness 4' 00 inches; and at 795 feet;

thickness 6' 00 inches.

Miners were used as follows: (Give details) _____

No Miners used

July 18, 1930 Date.



Approved THE MANUFACTURERS LIGHT & HEAT CO. Owner.

By Harry H Fowler
LAND AGENT

RECEIVED
Oil and Gas
06 2022
Department of
Environmental Protection

11/04/2022

4705100010

The Manufacturers Light & Heat Company
 800 Union Trust Building, Address
 Pittsburgh, Pa.

COMPLETION DATA SHEET
 NO. 2
 FORMATION RECORD

Well # 3403 B.R. Police Chambers Cameron Dist. Meigs Co. W. Va.

Name	Color	Character	Oil, Gas or Water	Top	Bottom	Thickness	Total Depth	Remarks
Sand	White	Soft		8	14	6		
Bluff Sand	"	Hard		435	480	45		
Waynesburg Coal	Black	Soft		480	484	4		
Lime	White	Hard		484	684	200		
Mapletown Coal	Black	Soft		684	688	4		
Lime	Light	Hard		688	700	12		
Slate	"	Soft		700	795	95		
Pgh. Coal	Black	"	water in coal	795	801	6		
Lime	White	Hard		801	880	79		
Murphy Sand	"	"	Gas at 896	880	930	50		
Little Dunkard	"	"		1199	1207	8		
Sand	"	"		1248	1253	11		
Big Dunkard	"	"		1300	1348	48		
Gas Sand	"	"		1410	1420	10		
1st Salt Sand	"	"		1488	1513	15		
2nd " "	"	"		1585	1615	30		
3rd " "	"	"		1635	1690	55		
Maxom Sand	"	"		1915	1931	16		
Pencil Cave	Black	Soft		1931	1940	9		
Big Lime	White	Hard		1940	1974	34		
Big Injun	"	"		1974	2214	240		
Thirty Foot Sand	"	"		2515	2533	18		
Slate	Black	Soft		2533	2545	12		
Thirty Foot Sand	White	Hard		2545	2570	25		
Fifty Foot Sand	"	"	Gas at 2737	2734	2765	31		
Gordon Stray	"	"	" " 2803	2800	2810	10		
Gordon Sand	"	"	" " 2816	2812	2844	32		
Fourth Sand	"	"		2878	2887	11		
Fifth Sand	"	"		2900	2905	5		
						Total Depth	2840 2940	

Well was ~~not~~ shot at 2813 to 2820 feet; well was shot at _____ feet.

Fresh water at in Pgh. Coal _____ feet; fresh water at _____ feet.

Well was gas producing hole.

THE MANUFACTURERS LIGHT & HEAT CO.

Feb. 18, 1930
Date

Approved

Harry H Fowler
LAND AGENT

NOTE: All bottom formations must be noted as indicated above and all key-rocks and oil and gas sands must be recorded under their proper geological names in the district as well as any local names commonly used in the district for such strata.

COPY

Mars-10 4705100010P

WEST VIRGINIA DEPARTMENT OF MINES

OIL AND GAS DIVISION

PRELIMINARY DATA SHEET NO. 1

File No. _____ Well No. 3403

The Manufacturers Light & Heat Co. Company, of 800 Union Trust Building,

Pittsburgh, Pa., on the B. R. & Alice Chambers Farm

containing 105 acres. Location _____

Cameron District, in Marshall County, West Virginia

The surface of the above tract is owned in fee by B. R. and Alice Chambers

of R. D. Cameron, W. Va., address, and the mineral rights are owned by

The Manufacturers Light & Heat Co., of Pittsburgh, Pa.

The oil and gas privileges are held under lease by the above named company, and this well is drilled under permit

No. Mars-10 issued by the West Virginia Department of Mines, Oil and Gas Division

November 12th, 1929

Elevation of surface at top of well 1225 feet Spirit Barometric

The number of feet of the different sized casings used in the well

_____ feet _____ also Wood conductor.

204 feet 10" size, cog 1105 feet 8 1/4" sized cog.

194.5 feet 6 5/8" size, cog 2961 feet 4" sized cog.

_____ feet _____ size, cog _____ feet _____ sized cog.

_____ packer of _____ size, set at _____

_____ packer of _____ size, set at _____

_____ in casing perforated at _____ feet to _____ feet.

_____ in casing perforated at _____ feet to _____ feet.

Coal was encountered at 480 feet; thickness 48 inches, and at 604

feet; thickness 48 inches; and at 795 feet; thickness 72 inches.

Liners were used as follows: (Give details) _____

February 26, 1930

Date

Approved THE MANUFACTURERS LIGHT & HEAT CO., Owner.

By Harry H. Fowler Land Agent.

OCT 15 '933

11/04/2022

THE MANUFACTURERS LIGHT & HEAT Company

COMPLETION DATA SHEET
No. 2

800 Union Trust Bldg., Pittsburgh, Pa. Address

Well No. 3103

FORMATION RECORD

B. R. and Alice Chambers (Cameron Dist., Marshall Co., W.Va)

Name	Color	Character	Oil Gas or Water	Top	Bottom	Thickness	Total Depth	Remarks
Sand				8	14	6		
Bluff Sand				135	180	45		
Waynesburg Coal				180	184	4		
Mapletown Coal				184	188	4		
Pgh. Coal				188	195	7		
Murphy Sand				195	201	6		4 barrels water per hour
Little Dunkard				201	230	29		
Sand				230	257	27		
Big Dunkard				257	263	6		
Gas Sand				263	268	5		
1st Salt Sand				268	270	2		
2nd Salt Sand				270	275	5		
3rd Salt Sand				275	285	10		
Mazon Sand				285	290	5		
Pencil Cave				290	291	1		
Big Lime				291	294	3		
Big Ingun				294	297	3		
30-Ft. Sand				297	327	30		
Slate				327	333	6		
30-Foot Sand				333	345	12		
50-Foot Sand				345	370	25		
Gordon Stray				370	375	5		
Gordon Sand				375	380	5		6/10 water in 2" opn
1st Sand				380	384	4		
5th Sand				384	387	3		
Total depth				387	395	8		

RECEIVED
Office of Oil and Gas
OCT 06 2022
WV Department of
Environmental Protection

shot _____
Well was not shot at _____ feet; well was shot at _____ feet.
Salt _____
Fresh water at _____ feet; fresh water at _____ feet.
producing _____
Well was _____ hole.
dry _____

Date February 26, 1930

THE MANUFACTURERS LIGHT & HEAT COMPANY,
Approved Stanley H. Fowler Land Agent.
Owner

NOTE: All bottom formations must be noted as indicated above and all key-rocks and oil and gas sands must be recorded under their proper geological names in the district as well as any local names commonly used in the district for such strata.

OCT 16 1933

11/04/2022

Cameron District, Marshall County, W. Va.
Manufacturers Light & Heat Co., 800 Union Tr. Bldg., Pittsburgh, Pa.
On 105 acres, surface owned by B. R. and Alice Chambers, R. D.,
Cameron, W. Va., and mineral rights by WELAN Co., Pittsburgh, Pa.
Drilled under permit Mars-10, issued Nov. 12, 1929.
Elevation, 1225'.
10" casing, 204'; 8 1/2", 1105'; 6-5/8", 1945'; 4" tubing, 2961'.
Coal was encountered at 480-484, 684-688, 795-801'.
Completion reported to Dept. of Mines Feb. 26, 1930.

Mars-10

	Top.	Bottom.
Sand	5	14
Bluff Sand	435	480
✓Waynesburg Coal	480	484
✓Napletown Coal	684	688
✓Pittsburgh Coal (4 barrels water per hr.)	795	801
✓Murphy Sand	880	930
✓Little Dunkard Sand	1199	1207
Sand	1242	1253
✓Big Dunkard Sand	1300	1348
Gas Sand	1410	1420
✓1st Salt Sand	1498	1513
✓2nd Salt Sand	1583	1615
✓3rd Salt Sand	1635	1690
✓Marion Sand	1915	1931
✓Pencil Cove	1931	1940
Big Lime	1940	1974
Big Injun Sand	1974	2214
✓30-Ft. ? Sand	2515	2533
Slate	2533	2545
✓30-Ft. ? Sand	2545	2570
✓50-Ft. ? Sand (gas, 6/10 water in 2")	2734	2765
✓Gordon Stray Sand	2800	2810
✓Gordon Sand	2812	2844
✓4th Sand	2878	2887
✓5th Sand	2900	2905
Total depth		2940

K 103 ml

LATITUDE

395230

4705100010

8032

LONGITUDE

→ OGIS
7.5' loc

RECEIVED
Office of Oil and Gas

OCT 06 2022

WV Department of
Environmental Protection

7.5 OGIS topo location

7.5' loc 2845
LLW

15' loc 5.725
(calc.) LLW

Company _____

Farm _____

Quad Cameron +15'EC

County _____

District Cameron

WELL LOCATION MAP

File No. Menasha 10

11/04/2022

man-10

4705100,010P

WEST VIRGINIA DEPARTMENT OF MINES

OIL & GAS SECTION

PRELIMINARY DATA SHEET NO. 1

File No. _____ Well No. 3405

The Manufacturers Light & Heat Company, of 800 Union Trust Bldg.

Pittsburgh, Pennsylvania, on the B. R. Chambers Farm

containing 105 acres. Location _____

Cameron District, in Marshall County, W. Va.

The surface of the above tract is owned in fee by B. R.

Chambers of R. D. Cameron, W. Va. address, and the

mineral rights are owned by The Manufacturers Light & Heat Co.,

of Pittsburgh, Pa.

The oil and gas privileges are held under lease by the

above company, and this well is drilled under permit No. _____

issued by the West Virginia Department of Mines, Oil and Gas Section,

November 10th 1929.

Elevation of surface at top of well, 1225 Spirit Barometric.

The number of feet of the different sized casings used in the well.

16 feet 13" size. Wood conductor.

1109 1/2 feet 8 1/2" size csg. 204 feet 10 sized csg. *All Palled*

1946 1/2 feet 6 7/8" size csg. _____ feet _____ sized csg.

2961 1/2 feet 4" size Tubing _____ feet _____ sized csg.

Anchor packer of 6 7/8" x 4" size, set at 2561 1/2 ft.

_____ packer of _____ size, set at _____

1/2 in. Tubing perforated at 2916 1/2 feet to 2916 1/2 feet.

4 in. Tubing perforated at 2727 3/4 feet to 2727 1/2 feet.

Coal was encountered at 480 feet; thickness 4' 00 inches, and at

684 feet; thickness 4' 00 inches, and at 295 feet;

thickness 6' 00 inches.

Liners were used as follows: (Give details) _____

No liners used

Feb 18 1930 Date.

Approved THE MANUFACTURERS LIGHT & HEAT CO. Owner.

By Harry H. Fowler

LAND AGENT

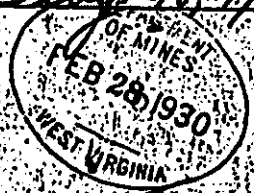

The Manufacturers Light & Heat Company
 800 Union Trust Building, Address
 Pittsburgh, Pa.

COMPLETION DATA SHEET
 NO. 2
 FORMATION RECORD

Well # 2103 (A.P. Price Chamberlain Dist. Mus. Co. H.V.)

Name	Color	Character	Oil, Gas or Water	Top	Bottom	Thickness	Total Depth	Remarks
Sand	White	Soft						
Bluff Sand	"	Hard		8	14	6		
Waynesburg Coal	Black	Soft		435	480	45		
Lime	White	Hard		480	484	4		
Mapletown Coal	Black	Soft		484	664	200		
Lime	Light	Hard		664	688	24		
Slate	"	Soft		688	700	12		
Pgh. Coal	Black	"	water in coal	700	795	95		
Lime	White	Hard		795	801	6		
Murphy Sand	"	"	Gas at 895	801	880	79		
Little Dunkard Sand	"	"		880	930	50		
Sand	"	"		1199	1207	8		
Big Dunkard	"	"		1242	1253	11		
Gas Sand	"	"		1300	1348	48		
1st Salt Sand	"	"		1410	1420	10		
2nd "	"	"		1488	1513	25		
3rd "	"	"		1683	1615	80		
Maxon Sand	"	"		1635	1690	55		
Pencil Cave	Black	Soft		1915	1931	16		
Big Lime	White	Hard		1931	1940	9		
Big Injun	"	"		1940	1974	34		
Thirty Foot Sand	"	"		1974	2214	240		
Slate	Black	Soft		2515	2533	18		
Thirty Foot Sand	White	Hard		2533	2545	12		
Fifty Foot Sand	"	"	Gas at 2737	2545	2570	25		
Gordon Stray	"	"	"	2734	2765	31		
Gordon Sand	"	"	"	2803	2810	7		
Fourth Sand	"	"	"	2816	2844	28		
Fifth Sand	"	"	"	2876	2887	11		
				2900	2905	5		
Total Depth						2940	2940	

RECEIVED
 Office of Oil and Gas
 OCT 06 2022
 WV Department of Environmental Protection

Well was shot at 2819 to 2820 feet; well was shot at _____ feet.
 Fresh water at _____ feet; fresh water at _____ feet.

Well was not producing hole.
 THE MANUFACTURERS LIGHT & HEAT CO.
 Approved: Berry H. Fowler
 Date: July 16, 1933 LAND AGENT

NOTE: All bottom formations must be noted as indicated above and all key-rocks and oil and gas sands must be recorded under their proper geological names in the district as well as any local names commonly used in the district for such strata.

4705100010P

Form G-1

NOTICE OF PROPOSED LOCATION OF OIL AND GAS WELL
(REQUIRED BY SECTION 3, CHAPTER 60, ACTS 1929)
WEST VIRGINIA DEPARTMENT OF MINES
OIL AND GAS SECTION

To THE DEPARTMENT OF MINES,
Charleston, W. Va.

Faith Coal Company,
COAL OPERATOR

The Manufacturers Light & Heat Company
NAME OF WELL OPERATOR

Uniontown, Penn'a.
ADDRESS

800 Union Trust Bldg., Pittsburgh, Pa.
COMPLETE ADDRESS

COAL OPERATOR

October 30th, 19 29

PROPOSED LOCATION

ADDRESS

Cameron District

COAL OPERATOR

Marshall County

ADDRESS

Well No. 3403

B. R. Chambers Farm (105 ac)

GENTLEMEN:
The undersigned well operator is entitled to drill upon the above named farm or tract of land for oil and gas, having fee title thereto, (or as the case may be) under grant or lease dated July 11th, 1929. (No. 9571), made by B. R. Chambers et ux to

The Manufacturers Light & Heat Company and recorded on the 2nd day of August, 1929, in the office of the County Clerk for said County in

Book 196, page 229

The enclosed plat was prepared by a competent engineer and shows the proposed location of a well to be drilled for oil and gas by the undersigned well operator on the farm and in the Magisterial District and County above named, determined by survey and courses and distances from two permanent points, or land marks.

The undersigned well operator is informed and believes there are no coal operators operating beds of coal beneath said farm or tract of land on which said well is located, or within 500 feet of the boundaries of the same, who have mapped their workings and filed their maps as required by law, excepting the coal operators (if any) above named as addresser.

2773

The above named coal operators (if any) are notified that any objections they may desire to make to such proposed location, or which they are required to make by Section 3 of said Act, if the drilling of a well at said proposed location will cause a dangerous condition in or about their respective coal mines, must be received by, or filed with the Department of Mines within ten days from the receipt of a copy of this notice and accompanying plat by said Department. Said coal operators are further notified that forms for use in making such objections will be furnished to them by the Department of Mines promptly on request and that all such objections must set forth as definitely as is reasonably possible the ground or grounds on which such objections are based and indicate the direction and distance the proposed location should be moved to overcome same.

(The next paragraph is to be completed only in Department's copy.)

Copies of this notice and the enclosed plat were mailed by registered mail, or delivered to the above named coal operators at their above shown respective address _____ day _____ before, or on the same day with the mailing or delivery of this copy to the Department of Mines at Charleston, West Virginia.

RECEIVED
Office of Oil and Gas
OCT. 06 2022

DEPARTMENT OF MINES
NOV - 1 1929
WEST VIRGINIA

Very truly yours,
THE MANUFACTURERS LIGHT & HEAT COMPANY
Harry H. Fowles
WELL OPERATOR / LAND AGENT

Address of Well Operator

800 Union Trust Building,
STREET

Pittsburgh

CITY OR TOWN

Pennsylvania

STATE

Section 3. If no such objections be filed, or be found by the department of mines, within said period of ten days from the receipt of said notice and plat by the department of mines, to said proposed location, the department shall forthwith issue to the well operator a drilling permit reciting the filing of such plat, that no objections have been made by the coal operators to the location, or found thereto by the department, and that the same is approved and the well operator authorized to proceed to drill at said location.

Ward 10

11/04/2022

PLAT OF THE PROPOSED LOCATION OF WELL NO. 3403 OF THE MANUFACTURERS LIGHT & HEAT CO. OF PITTSBURGH, PA. ON THE B. R. CHAMBERS FARM CONSISTING OF 105 ACRES LOCATED IN CAMERON DISTRICT MARSHALL COUNTY W. VA.

Map - 10

Note:
Faith Coal Co., owns coal
Coal not operated

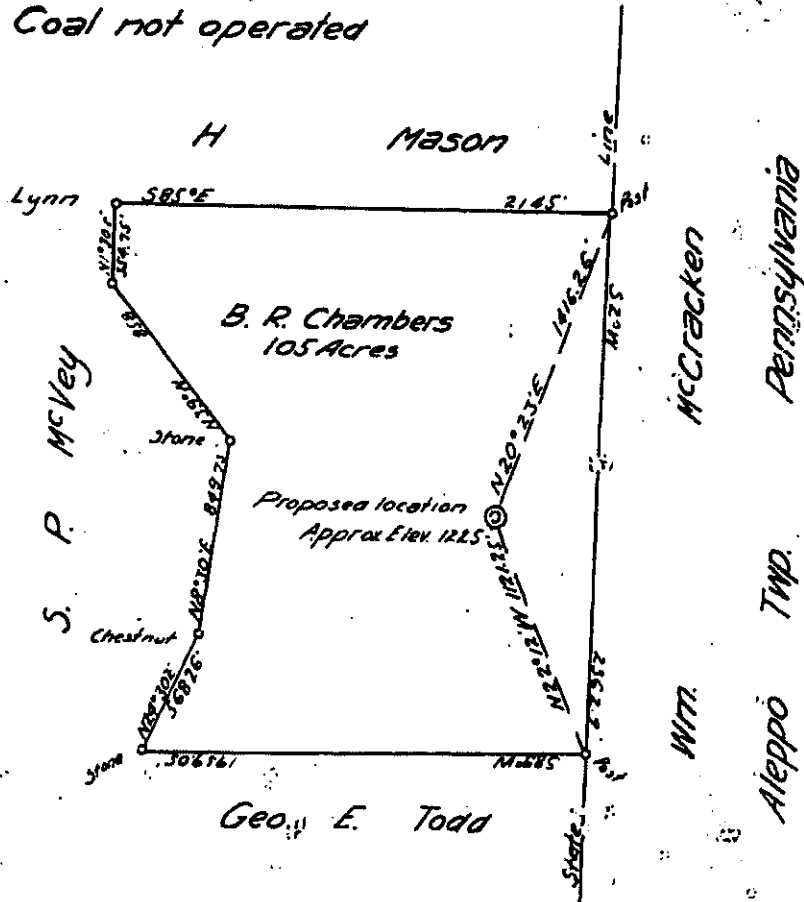

ENGINEERS CERTIFICATE

I, THE UNDERSIGNED, HEREBY CERTIFY THAT THIS MAP IS CORRECT AND SHOWS ALL THE INFORMATION, TO THE BEST OF MY KNOWLEDGE AND BELIEF, REQUIRED BY THE OIL AND GAS SECTION OF THE MINING LAWS OF WEST VIRGINIA

Donald L. Bell
ENGINEER

ACKNOWLEDGED BEFORE ME A NOTARY PUBLIC OF AND FOR ALLEGHENY COUNTY STATE OF PENNSYLVANIA THIS 29 DAY OF October 19 29

Harry H Fowler

4705100010P

WW-4A
Revised 6-07

1) Date: SEPTEMBER 26, 2022
2) Operator's Well Number M-1567
3) API Well No.: 47 - 051 - 00010

STATE OF WEST VIRGINIA
DEPARTMENT OF ENVIRONMENTAL PROTECTION, OFFICE OF OIL AND GAS
NOTICE OF APPLICATION TO PLUG AND ABANDON A WELL

4) Surface Owner(s) to be served:	5) (a) Coal Operator
(a) Name <u>ALLEN L. WENDT ET UX</u> ✓	Name <u>WEST VIRGINIA LAND RESOURCES INC.</u>
Address <u>274 MCCRAKEN RD.</u>	Address <u>1 BRIDGE STREET</u>
<u>CAMERON, WV 26033</u>	<u>MONONGAH, WV 26554</u>
(b) Name _____	(b) Coal Owner(s) with Declaration
Address _____	Name _____
(c) Name _____	Address _____
Address _____	Name _____
6) Inspector <u>STRADER GOWER</u>	(c) Coal Lessee with Declaration
Address <u>2525W ALEXANDER RD.</u>	Name _____
<u>VALLEY GROVE, WV 26060</u>	Address _____
Telephone <u>(304) 993-6188</u>	_____

RECEIVED
Office of Oil and Gas
OCT 06 2022
WV Department of
Environmental Protection

TO THE PERSONS NAMED ABOVE: You should have received this Form and the following documents:

- (1) The application to Plug and Abandon a Well on Form WW-4B, which sets out the parties involved in the work and describes the well its and the plugging work order; and
- (2) The plat (surveyor's map) showing the well location on Form WW-6.

The reason you received these documents is that you have rights regarding the application which are summarized in the instructions on the reverses side. However, you are not required to take any action at all.

Take notice that under Chapter 22-6 of the West Virginia Code, the undersigned well operator proposes to file or has filed this Notice and Application and accompanying documents for a permit to plug and abandon a well with the Chief of the Office of Oil and Gas, West Virginia Department of Environmental Protection, with respect to the well at the location described on the attached Application and depicted on the attached Form WW-6. Copies of this Notice, the Application, and the plat have been mailed by registered or certified mail or delivered by hand to the person(s) named above (or by publication in certain circumstances) on or before the day of mailing or delivery to the Chief.

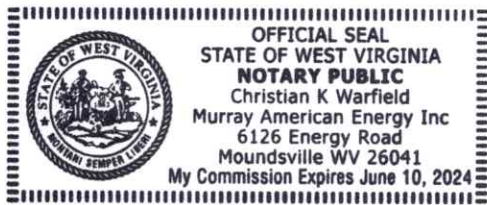

Well Operator	<u>WEST VIRGINIA LAND RESOURCES INC.</u>
By:	<u>JAY HORES</u>
Its:	<u>PROJECT ENGINEER</u>
Address	<u>6126 ENERGY ROAD</u>
	<u>MOUNDSVILLE, WV 26041</u>
Telephone	<u>(304) 843-3565</u>

Subscribed and sworn before me this 29 day of September 2022
Christian Warfield Notary Public
My Commission Expires June 10, 2024

Oil and Gas Privacy Notice

The Office of Oil and Gas processes your personal information, such as name, address and phone number, as a part of our regulatory duties. Your personal information may be disclosed to other State agencies or third parties in the normal course of business or as needed to comply with statutory or regulatory requirements, including Freedom of Information Act requests. Our office will appropriately secure your personal information. If you have any questions about our use of your personal information, please contact DEP's Chief Privacy Officer at depprivacyoffier@wv.gov.

11/04/2022

4705100010P

RECEIVED
Office of Oil and Gas
OCT 06 2022
WV Department of
Environmental Protection

7020 0640 0001 3302 0284

U.S. Postal Service™
CERTIFIED MAIL® RECEIPT
Domestic Mail Only

For delivery information visit our website at www.usps.com

Certified Mail Fee	\$
Extra Services & Fees (check box, add fee as appropriate)	
<input type="checkbox"/> Return Receipt (hardcopy)	\$
<input type="checkbox"/> Return Receipt (electronic)	\$
<input type="checkbox"/> Certified Mail Restricted Delivery	\$
<input type="checkbox"/> Adult Signature Required	\$
<input type="checkbox"/> Adult Signature Restricted Delivery	\$
Postage	\$
Total Postage and Fees	\$

Postmark: CAMERON WV POST OFFICE OCT 03 2022

Sender:
Allen Wendt
274 McCracken Rd
Cameron, WV 26033

11/04/2022

WW-9
(5/16)

API Number 47 - 051 - 00010
Operator's Well No. _____

STATE OF WEST VIRGINIA
DEPARTMENT OF ENVIRONMENTAL PROTECTION
OFFICE OF OIL AND GAS
FLUIDS/ CUTTINGS DISPOSAL & RECLAMATION PLAN

Operator Name WEST VIRGINIA LAND RESOURCES INC. OP Code _____

Watershed (HUC 10) GRAVE CREEK Quadrangle CAMERON WV,PA

Do you anticipate using more than 5,000 bbls of water to complete the proposed well work? Yes No

Will a pit be used? Yes No

If so, please describe anticipated pit waste: _____

Will a synthetic liner be used in the pit? Yes No If so, what ml.? _____

Proposed Disposal Method For Treated Pit Wastes:

- Land Application (if selected provide a completed form WW-9-GPP)
- Underground Injection (UIC Permit Number _____)
- Reuse (at API Number _____)
- Off Site Disposal (Supply form WW-9 for disposal location)
- Other (Explain Tanks, see attached letter)

RECEIVED
Office of Oil and Gas

OCT 06 2022

WV Department of
Environmental Protection

Will closed loop system be used? If so, describe: Yes. Gel circulated from tank thru well bore and returned to tank

Drilling medium anticipated for this well (vertical and horizontal)? Air, freshwater, oil based, etc. Gel or Cement

-If oil based, what type? Synthetic, petroleum, etc.

Additives to be used in drilling medium? Bentonite, Bicarbonate of Soda

Drill cuttings disposal method? Leave in pit, landfill, removed offsite, etc. Shaker cutting buried on site.

-If left in pit and plan to solidify what medium will be used? (cement, lime, sawdust) N/A

-Landfill or offsite name/permit number? N/A

Permittee shall provide written notice to the Office of Oil and Gas of any load of drill cuttings or associated waste rejected at any West Virginia solid waste facility. The notice shall be provided within 24 hours of rejection and the permittee shall also disclose where it was properly disposed.

I certify that I understand and agree to the terms and conditions of the GENERAL WATER POLLUTION PERMIT issued on April 1, 2016, by the Office of Oil and Gas of the West Virginia Department of Environmental Protection. I understand that the provisions of the permit are enforceable by law. Violations of any term or condition of the general permit and/or other applicable law or regulation can lead to enforcement action.

I certify under penalty of law that I have personally examined and am familiar with the information submitted on this application form and all attachments thereto and that, based on my inquiry of those individuals immediately responsible for obtaining the information, I believe that the information is true, accurate, and complete. I am aware that there are significant penalties for submitting false information, including the possibility of fine or imprisonment.

Company Official Signature Jay Hores

Company Official (Typed Name) Jay Hores

Company Official Title Project Engineer

Subscribed and sworn before me this 29 day of September

Chris Warfield



OFFICIAL SEAL
STATE OF WEST VIRGINIA
NOTARY PUBLIC
Christian K Warfield
Murray American Energy Inc
6126 Energy Road
Moundsville WV 26041
My Commission Expires June 10, 2024

My commission expires June 10, 2024

4705100010P

**AMERICAN CONSOLIDATED NATURAL
RESOURCES & WEST VIRGINIA LAND
RESOURCES**

**AMERICAN CONSOLIDATED
NATURAL RESOURCES & WEST
VIRGINIA LAND RESOURCES**

46226 National Road
St. Clairsville, OH 43950

phone: 304.843.3565

fax: 304.843.3546

e-mail: JayHores@acnrinc.com

JAY HORES

Project Engineer

September 29, 2022

Department of Environmental Protection
Office of Oil and Gas
601-57th Street
Charleston, WV 25320

RECEIVED
Office of Oil and Gas

OCT 06 2022

WV Department of
Environmental Protection

To Whom It May Concern,

As per the Division of Environmental Protection, Office of Oil and Gas request, Consolidation Coal Company submits the following procedures utilizing pit waste.

Upon submitting a well work application (without a general permit for Oil & Gas Pit Waste Discharge Application), Consolidation Coal Company will construct no pits, but instead will use mud tanks to contain all drilling muds.

Once the well is completed, that material (minus the cave material) will be trucked to the next well to be plugged or to DEP facilities number U-0033-83, O-1001-00, U-1035-91U-46-84, U-78-83, O-1044-9, or U-100-83.

Sincerely,



Jay Hores
Project Engineer

11/04/2022

Operator's Well No. _____

Proposed Revegetation Treatment: Acres Disturbed 1 Prevegetation pH _____

Lime 3 Tons/acre or to correct to pH 6.0

Fertilizer type 10-20-20 or equivalent

Fertilizer amount 500 lbs/acre

Mulch 2 Tons/acre

Seed Mixtures

Temporary

Permanent

Seed Type lbs/acre

Seed Type lbs/acre

Seed Mix in accordance with WVDEP Oil and Gas, Erosion and Sediment Control Field Manual

Seed Mix in accordance with WVDEP Oil and Gas, Erosion and Sediment Control Field Manual

Attach:

Maps(s) of road, location, pit and proposed area for land application (unless engineered plans including this info have been provided). If water from the pit will be land applied, provide water volume, include dimensions (L, W, D) of the pit, and dimensions (L, W), and area in acres, of the land application area.

Photocopied section of involved 7.5' topographic sheet.

RECEIVED
Office of Oil and Gas
OCT 06 2022
WV Department of Environmental Protection

Plan Approved by: Strader Gener

Comments: _____

Title: Oil and Gas Inspector Date: 9/30/2022

Field Reviewed? () Yes () No

TYPICAL DRAWING OF WELL PLUGGING SITE PLAN

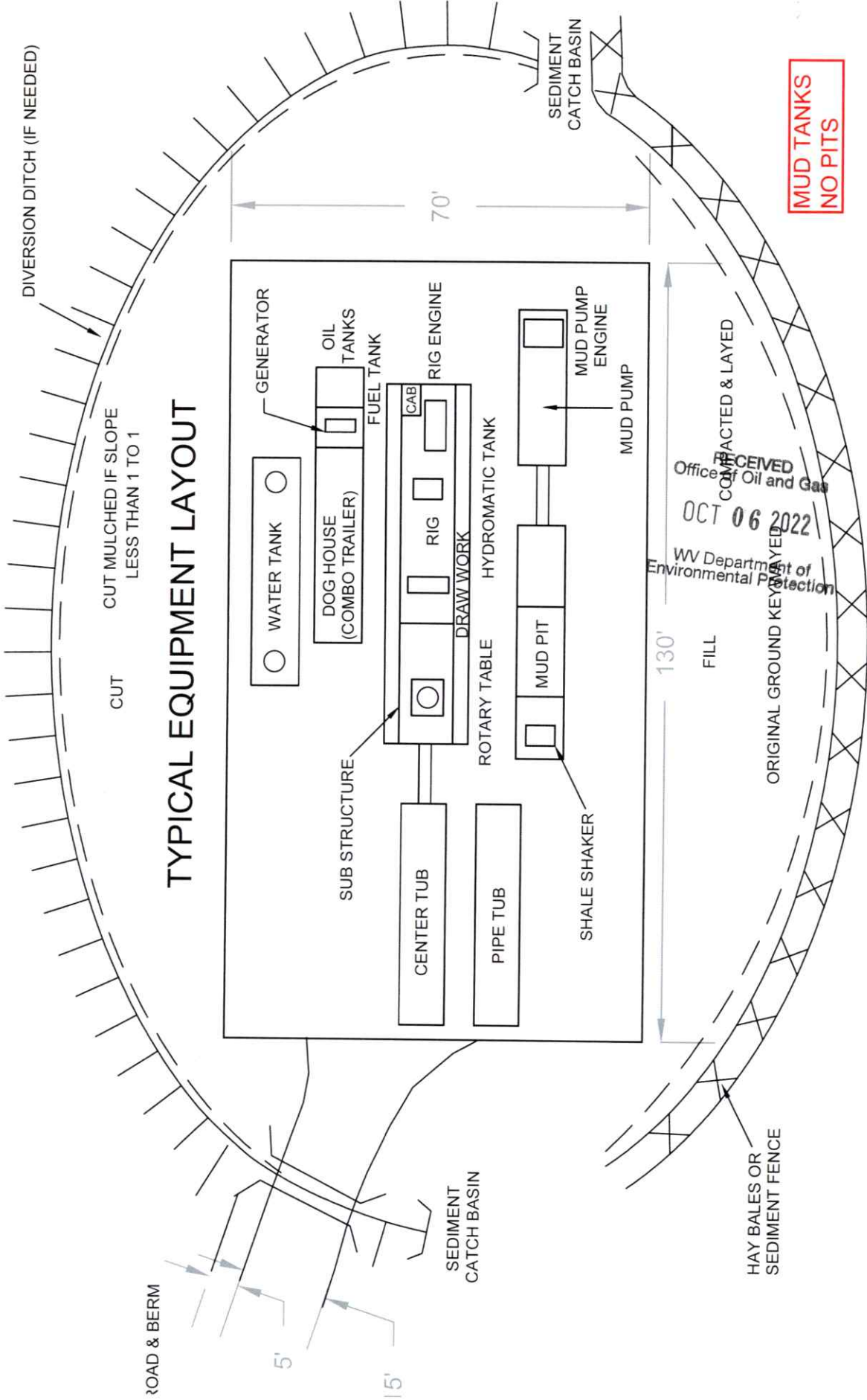

MUD TANKS
NO PITS

4705100010P

CAMERON QUADRANGLE
WEST VIRGINIA-PENNSYLVANIA
7.5 MINUTE SERIES (TOPOGRAPHIC)
SE/4 CAMERON 15' QUADRANGLE

4963 IV NW
(WIND RIDGE)

39 32'30"

1710 000 FEET (W. VA.)

WAYNESBURG, PA. 23 MI.
GRAYSVILLE, PA. 8.4 MI.

542

80°30'
39°52'30"

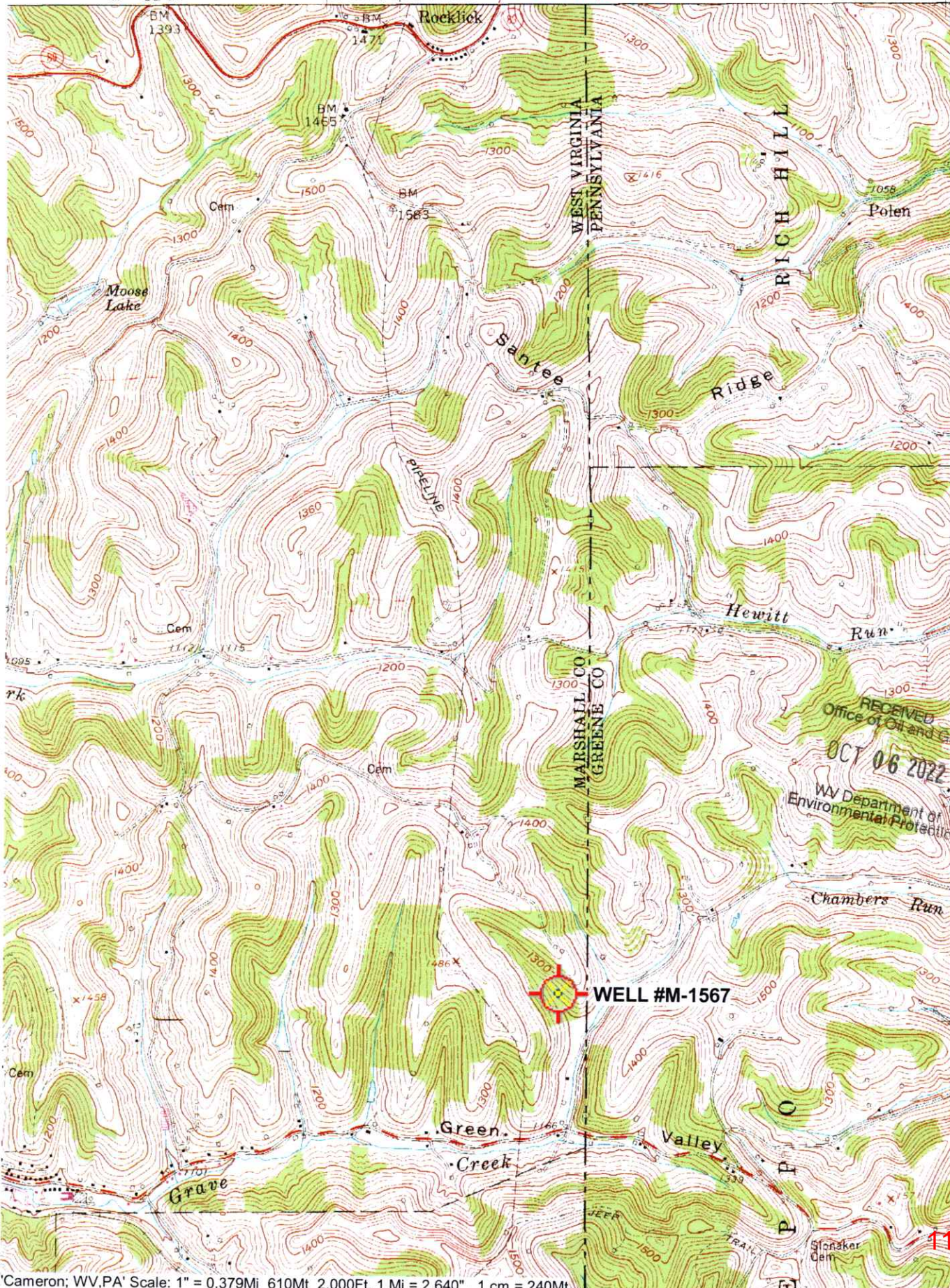

500 000 FEET
(W. VA.)

4412

4411

4410

50'

4409

4408

RECEIVED
Office of Oil and Gas
OCT 06 2022
WV Department of
Environmental Protection

WELL #M-1567

11/04/2022

WW-7
8-30-06



West Virginia Department of Environmental Protection
Office of Oil and Gas

WELL LOCATION FORM: GPS

API: 47-051-00010 WELL NO.: M-1567
 FARM NAME: B.R. & ALICE CHAMBERS
 RESPONSIBLE PARTY NAME: WEST VIRGINIA LAND RESOURCES INC.
 COUNTY: MARSHALL DISTRICT: CAMERON
 QUADRANGLE: CAMERON WV, PA
 SURFACE OWNER: ALLEN L. WENDT ET UX
 ROYALTY OWNER: _____
 UTM GPS NORTHING: 4,409,496 m (1214')
 UTM GPS EASTING: 541,008 m GPS ELEVATION: 370 m

The Responsible Party named above has chosen to submit GPS coordinates in lieu of preparing a new well location plat for a plugging permit or assigned API number on the above well. The Office of Oil and Gas will not accept GPS coordinates that do not meet the following requirements:

- Datum: NAD 1983, Zone: 17 North, Coordinate Units: meters, Altitude: height above mean sea level (MSL) – meters.
- Accuracy to Datum – 3.05 meters
- Data Collection Method:

Survey grade GPS : Post Processed Differential _____
 Real-Time Differential

Mapping Grade GPS _____ : Post Processed Differential _____
 Real-Time Differential _____

- Letter size copy of the topography map showing the well location.**

I the undersigned, hereby certify this data is correct to the best of my knowledge and belief and shows all the information required by law and the regulations issued and prescribed by the Office of Oil and Gas.

Signature

Professional Surveyor

Title

SEPTEMBER 26, 2022

Date

11/04/2022

RECEIVED
Office of Oil and Gas
OCT 06 2022
WV Department of
Environmental Protection



Kennedy, James P <james.p.kennedy@wv.gov>

plugging permit issued for 4705100010

1 message

Kennedy, James P <james.p.kennedy@wv.gov>

Mon, Oct 31, 2022 at 1:28 PM

To: DavidRoddy@acnrinc.com, Strader C Gower <strader.c.gower@wv.gov>, ebuzzard@marshallcountywv.org

To whom it may concern, a plugging permit has been issued for 4705100010.

James Kennedy
WVDEP OOG

2 attachments

 IR-8 4705100010.pdf
12K

 4705100010.pdf
2704K

11/04/2022