

39°45'00"

Latitude

80°05'08"

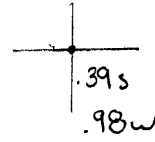

Longitude

**Topo Location**

7.5' Loc. \_\_\_\_\_ 15' Loc. \_\_\_\_\_  
 \_\_\_\_\_ (calc.) \_\_\_\_\_

Company Pitts Plate + Glass

Farm PP+G

15' Quad \_\_\_\_\_  
(sec.)

7.5' Quad New Martinsville

District Franklin

**WELL LOCATION PLAT**

County OSI Permit 137

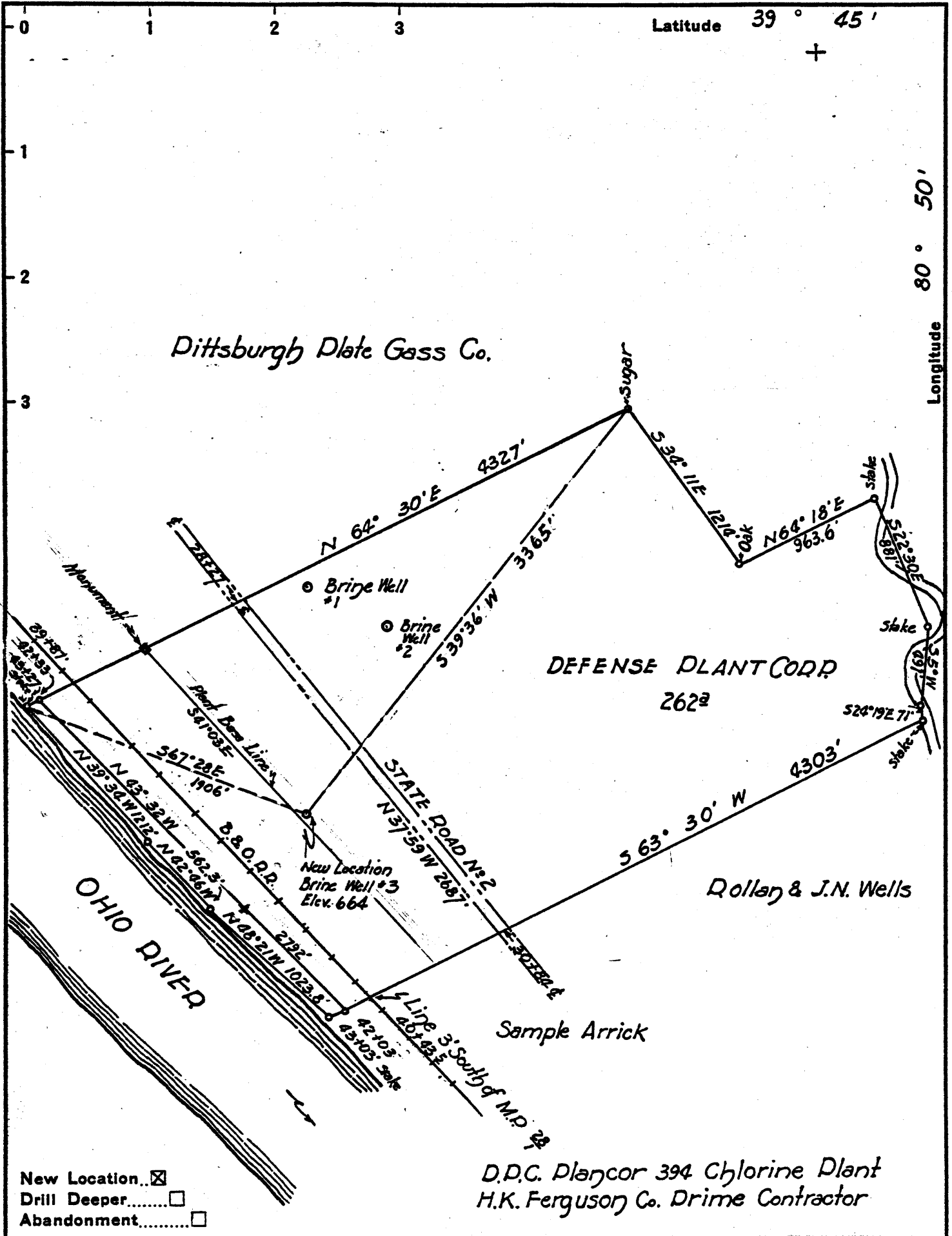

Company DITTSBURGH PLATE GLASS CO.  
 ENGINEERS & LESSEES  
 Address NEW MARTINSVILLE WEST VIRGINIA  
 Farm DEFENSE PLANT CORP.  
 Tract \_\_\_\_\_ Acres 262 Lease No. \_\_\_\_\_  
 Well (Farm) No. 3 Serial No. \_\_\_\_\_  
 Elevation (Spirit Level) 664  
 Quadrangle NEW MARTINSVILLE  
 County MARSHALL District FRANKLIN  
 Engineer W.M. Bowers  
 Engineer's Registration No. 900  
 File No. \_\_\_\_\_ Drawing No. \_\_\_\_\_  
 Date DECEMBER 14 Scale 1" = 800'

STATE OF WEST VIRGINIA  
 DEPARTMENT OF MINES  
 OIL AND GAS DIVISION  
 CHARLESTON

**WELL LOCATION MAP**  
 FILE NO. MARS-137-P  
051-

+ Denotes location of well on United States Topographic Maps, scale 1 to 62,500, latitude and longitude lines being represented by border lines as shown.

- Denotes one inch spaces on border line of original tracing.

"IMPERIAL" TRACING CLOTH  
 K & E CO., N. Y.

DEEP WELL

MAR 23 1981

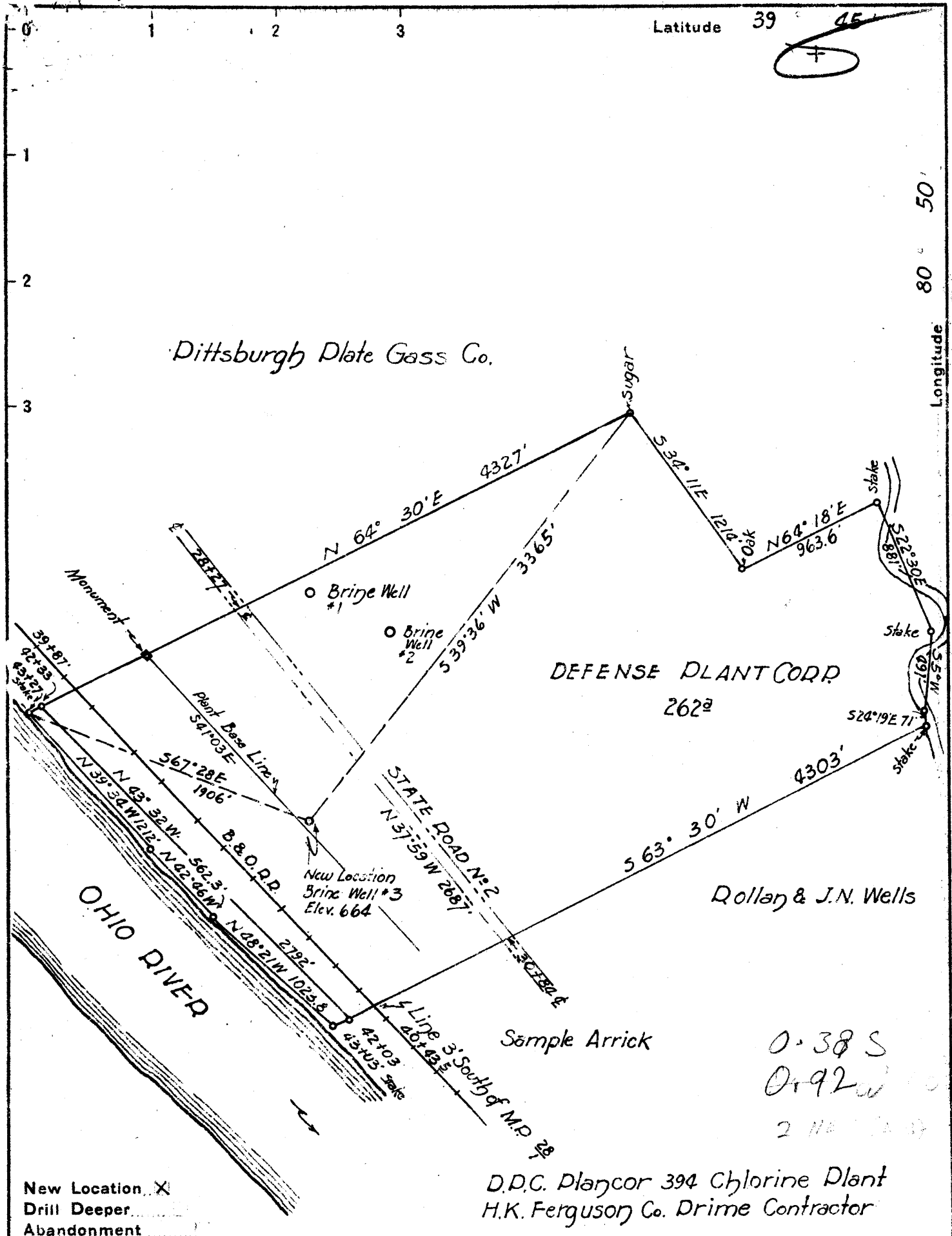

Company DITTSBUDGH PLATE GLASS CO.  
ENGINEERS & LESSEES  
 Address NEW MARTINSVILLE WEST VIRGINIA  
 Farm DEFENSE PLANT CORP.  
 Tract \_\_\_\_\_ Acres 262 Lease No. \_\_\_\_\_  
 Well (Farm) No. 3 Serial No. \_\_\_\_\_  
 Elevation (Spirit Level) 664  
 Quadrangle NEW MARTINSVILLE - NC  
 County MARSHALL District FRANKLIN  
 Engineer W.M. Bowers  
 Engineer's Registration No. 900  
 File No. \_\_\_\_\_ Drawing No. \_\_\_\_\_  
 Date DECEMBER 14 Scale 1" = 800'

STATE OF WEST VIRGINIA  
 DEPARTMENT OF MINES  
 OIL AND GAS DIVISION  
 CHARLESTON

**WELL LOCATION MAP**  
 FILE NO. MARS-137

+ Denotes location of well on United States Topographic Maps, scale 1 to 62,500. latitude and longitude lines being represented by border lines as shown.  
 - Denotes one inch spaces on border line of original tracing.

"IMPERIAL" TRACING CO. K & E CO., N. Y.

9-0 23 deep well

WEST VIRGINIA DEPARTMENT OF MINES  
OIL & GAS DIVISION  
W E L L R E C O R D

Permit No. Mars 137  
New Martinsville Quad.  
Company  
Address  
Farm  
Location  
Well No  
District  
Surface  
Mineral  
Commenced  
Completed

Salt Well  
CASING & TUBING

Pittsburgh Plate Glass Co.  
New Martinsville, W.Va. 11-3/4 846  
Defense Plant Corp. Acres 225 8 5/8 6457  
E. Bank of Ohio R. near Proctor 4-1/2 6805  
3 Elev. 664  
~~Franklin Marshall County~~  
Defense Plant Corp., Washington, D.C.

---  
Jan. 20, 1943  
April 13, 1943

Casing cemented: Yes  
Size 8 5/8" 2500'  
April 10, 1943

Rotary Table		0	12.5
Gravel & Sand	S	12.5	90
Lime stone	S	90	95
Gravel & Sand	S	95	100
Lime stone	S	100	135
Lime stone with Sand	H	135	197
Shale & Red Bed	H	197	252
Hard Sand & Lime with Shale	H	252	616
Hard Sand & Lime	H	616	747
Hard Sand, Lime & Shale	H	747	774
Shale	H	774	860
Shale & Lime	H	860	951
Hard Sand & Lime	H	951	1038
Coal	H	1038	1042
Sandy Lime & Shale	H	1042	1265
✓ Lime & Sand	H	1265	1488
Lime & Shale	H	1488	1596
Hard Sand & Lime	H	1596	1648
Shale & Sand	H	1648	1714
Sand, Shale & Lime	H	1714	1846
✓ Shale & Lime	H	1846	2215
Hard Sandy Lime & Shale	H	2215	2652
Shale & Lime	H	2652	2889
Sandy Lime & Shale	H	2889	3424
Shale & Lime	H	3424	3677
Sandy Shale & Lime	H	3677	4227
Shale & Lime	H	4227	5707
Shale	H	5707	5725
Hard Shale & Lime	H	5725	5750
Shale	H	5750	5775
Shale & Lime	H	5775	5823
o. ✓ Cherty Lime	H	5823	6029
or ✓ Hard Sand	H	6029	6090
✓ Hard Sand & Sandy Lime	H	6090	6097
Hard Shale & Sandy Lime	H	6097	6391
✓ Shale & Lime	H	6391	6438
Hard Shale, Lime & Sand	H	6438	6481
Sandy Lime & Shale	H	6481	6533
Shale & Lime	H	6533	6697
Anhydrite & Salt	H	6697	6817
Anhydrite	H	6817	6821

51

RECEIVED

APR 30 1981

FORM OG-8

STATE OF WEST VIRGINIA  
DEPARTMENT OF MINES  
OIL AND GAS WELLS DIVISION

OIL & GAS DIVISION  
DEPT. OF MINES

AFFIDAVIT OF PLUGGING AND FILLING WELL

AFFIDAVIT SHOULD BE MADE IN TRIPLICATE, ONE COPY MAILED TO THE DEPARTMENT, ONE COPY TO BE RETAINED BY THE WELL OPERATOR AND THE THIRD COPY (AND EXTRA COPIES IF REQUIRED) SHOULD BE MAILED TO EACH COAL OPERATOR AT THEIR RESPECTIVE ADDRESSES.

PPG Industries, Inc.  
COAL OPERATOR OR OWNER  
Box 191, New Martinsville, WV 26155  
ADDRESS  
COAL OPERATOR OR OWNER  
Same  
ADDRESS  
Same  
LEASE OR PROPERTY OWNER  
ADDRESS

PPG Industries, Inc.  
NAME OF WELL OPERATOR  
P.O. Box 191, New Martinsville, WV 26155  
COMPLETE ADDRESS  
March 20 19 81  
WELL AND LOCATION  
Franklin District  
Marshall County  
Well No. MARS 0137 (Brine Well No. 3)  
Farm

STATE INSPECTOR SUPERVISING PLUGGING Phillip L. Tracy

AFFIDAVIT

STATE OF WEST VIRGINIA,  
County of Marshall } ss:

S. W. Jack Drilling Co. and Halliburton Services  
being first duly sworn according to law depose and say that they are experienced in the work of plugging and filling oil and gas wells and were employed by PPG Industries, well operator, and participated in the work of plugging and filling the above well, that said work was commenced on the 17th day of March, 19 81, and that the well was plugged and filled in the following manner:

SAND OR ZONE RECORD FORMATION	FILLING MATERIAL	PLUGS USED SIZE & KIND	CASING	
			CSG PULLED	CSG LEFT IN
4003 - 6815	Brine Treatment Wastes			
4001 - 4003	Bridge Plug	Baker Model N 5AA Bridge Plug	7" Xline (978 ft.) &	8 5/8" (6459 ft.)
3801 - 4001	Cemented inside 8 5/8" casing and applied static cement head to perforations 3939-41	Cement 200 ft.	4 1/2" Tubing (3034 ft.)	11 3/4" (846 ft.)
901 - 3801	6% Bentonite Gel			
Surface to 901	Cemented 8 5/8" casing and circulated cement through perforations 889 - 902 back to surface between 8 5/8" casing and 11 3/4" casing.	Cement 902 ft.		
(NAME) Lower Kittanning 1030-1035			DESCRIPTION OF MONUMENT	
(NAME) Pittsburgh No. 8 256-260			Inscribed plate at surface location welded to 11 3/4" casing.	
(NAME)			Located per attached plat.	
(NAME)				

and that the work of plugging and filling said well was completed on the 20th day of March, 19 81.

And further deponents saith not.

*John E. Eidson*

Sworn to and subscribed before me this 29th day of April, 19 81.

*Betty Lee Mason*  
Notary Public.

My commission expires:  
*December 21, 1986*

Permit No. 47-051-0137-P