

39°45'00"

Latitude

80°50'00"

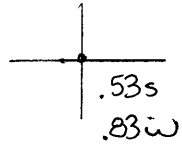

Longitude

**Topo Location**

7.5' Loc. \_\_\_\_\_ 15' Loc. \_\_\_\_\_  
 \_\_\_\_\_ (calc.) \_\_\_\_\_

Company PPG

Farm \_\_\_\_\_

15' Quad \_\_\_\_\_  
(sec.)

7.5' Quad New Martinsville

District Franklin

**WELL LOCATION PLAT**

County OSI Permit 140

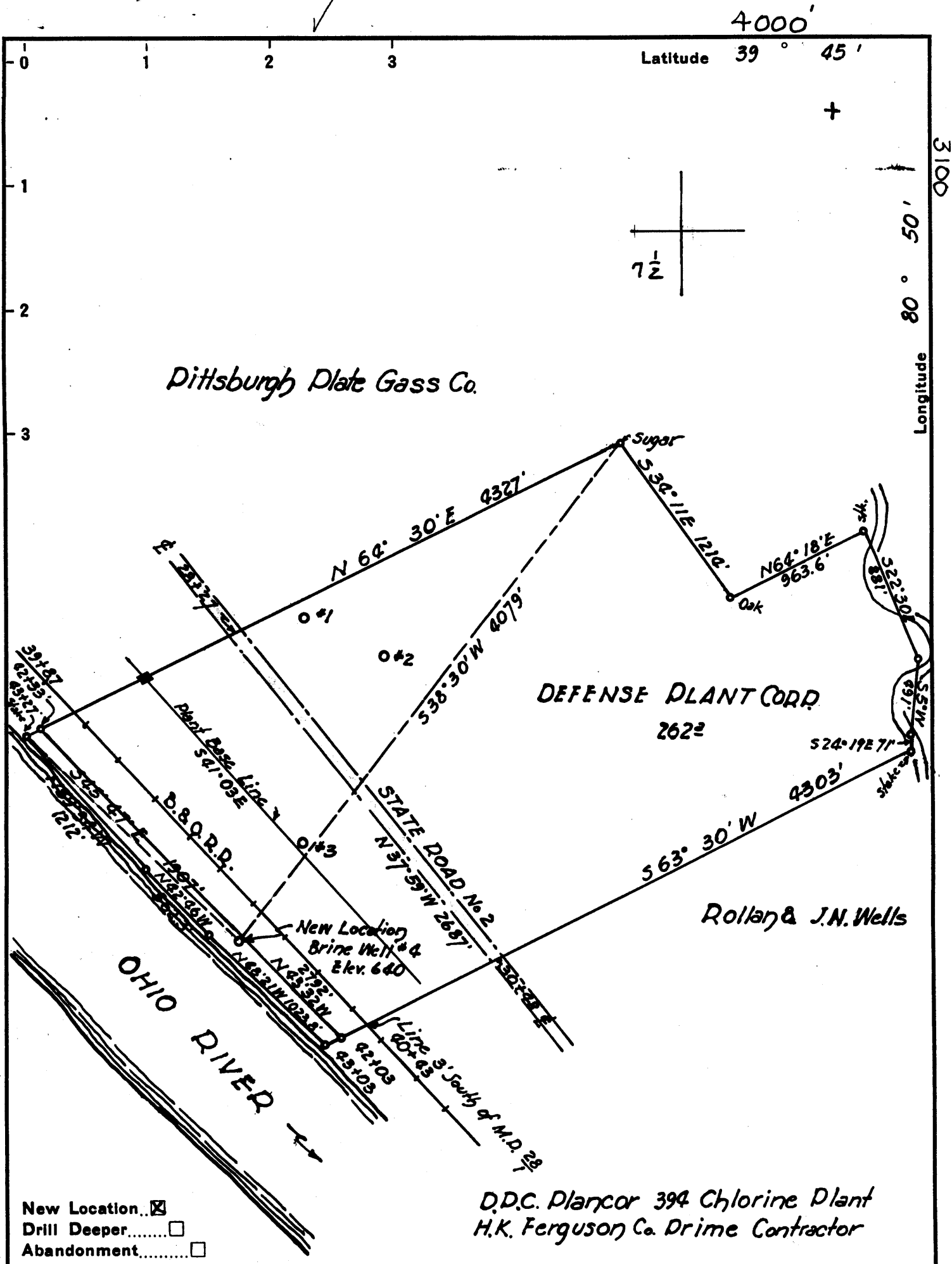

New Location...   
 Drill Deeper.....   
 Abandonment.....

D.P.C. Planor 394 Chlorine Plant  
 H.K. Ferguson Co. Prime Contractor

Company DITTSBURGH PLATE GLASS Co.  
 Address NEW MARTINSVILLE WVA.  
 Farm DEFENSE PLANT CORD  
 Tract \_\_\_\_\_ Acres 262 Lease No. \_\_\_\_\_  
 Well (Farm) No. 4 Serial No. \_\_\_\_\_  
 Elevation (Spirit Level) 640  
 Quadrangle NEW MARTINSVILLE  
 County MARSHALL District FRANKLIN  
 Engineer Wm Bowes  
 Engineer's Registration No. \_\_\_\_\_  
 File No. \_\_\_\_\_ Drawing No. \_\_\_\_\_  
 Date 4-26-43 Scale 1" = 800'

STATE OF WEST VIRGINIA  
 DEPARTMENT OF MINES  
 OIL AND GAS DIVISION  
 CHARLESTON

WELL LOCATION MAP  
 FILE NO. MARS-140-7

+ Denotes location of well on United States Topographic Maps, scale 1 to 62,500, latitude and longitude lines being represented by border lines as shown.

- Denotes one inch spaces on border line of original tracing.

AUG 14 1992

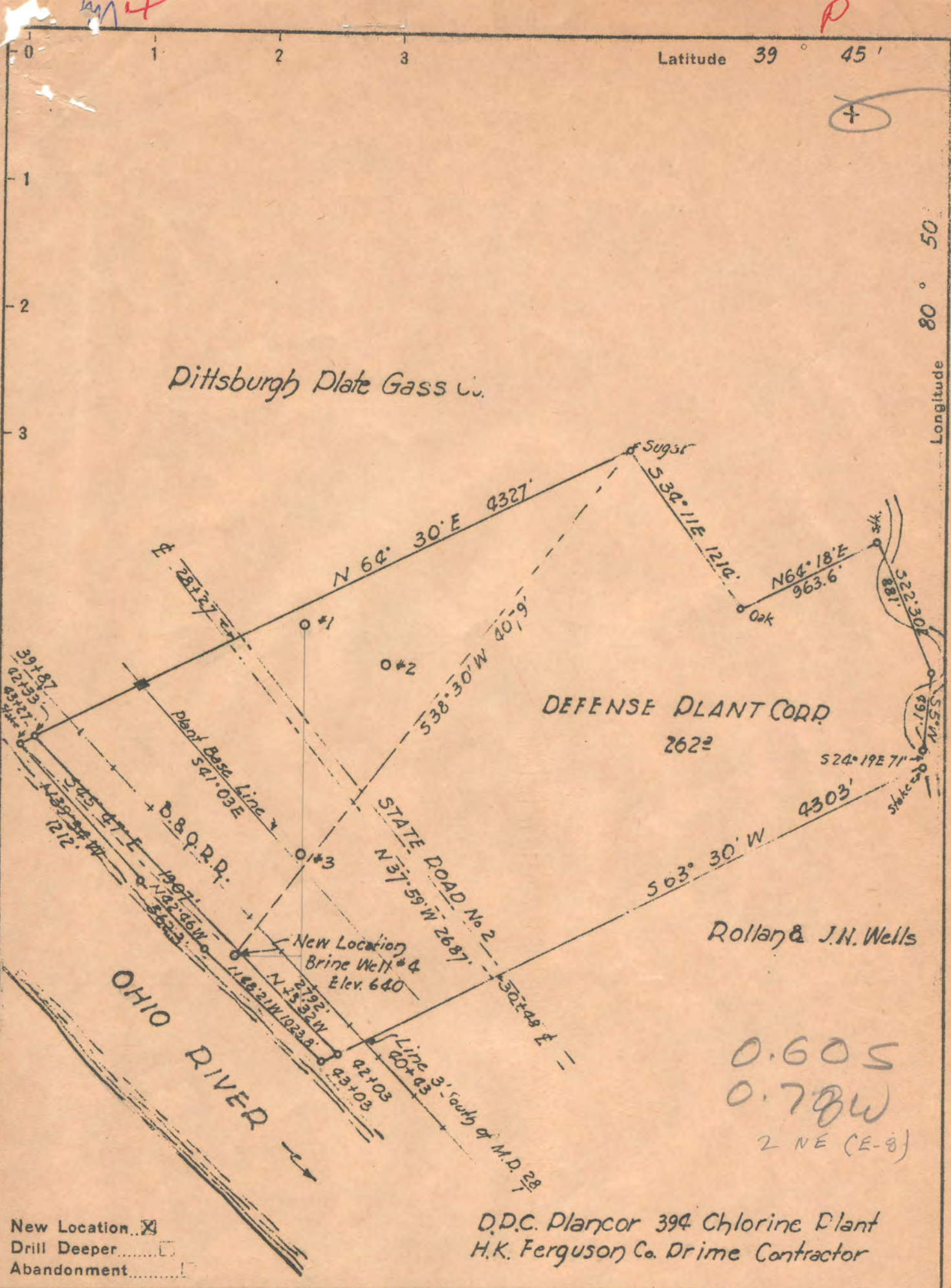

Company PITTSBURGH PLATE GLASS Co.  
 ENGINEERS & LESSEES  
 Address NEW MARTINSVILLE WVA.  
 Farm DEFENSE PLANT CORD  
 Tract \_\_\_\_\_ Acres 262 Lease No. \_\_\_\_\_  
 Well (Farm) No. 4 Serial No. \_\_\_\_\_  
 Elevation (Spirit Level) 640  
 Quadrangle NEW MARTINSVILLE - NC  
 County MARSHALL District FRANKLIN  
 Engineer Wm Bower  
 Engineer's Registration No. \_\_\_\_\_  
 File No. \_\_\_\_\_ Drawing No. \_\_\_\_\_  
 Date 4-26-33 Scale 1" = 800'

STATE OF WEST VIRGINIA  
 DEPARTMENT OF MINES  
 OIL AND GAS DIVISION  
 CHARLESTON

**WELL LOCATION MAP**  
 FILE NO. MARS-140

+ Denotes location of well on United States Topographic Maps, scale 1 to 62,500, latitude and longitude lines being represented by border lines as shown.

- Denotes one inch spaces on border line of original tracing.

WEST VIRGINIA DEPARTMENT OF MINES  
OIL & GAS DIVISION  
W E L L R E C O R D

Permit No. Mars 140  
New Martinsville Quad.  
Company  
Address  
Farm  
Location  
Well No  
District  
Surface  
Mineral  
Commenced  
Completed

Salt Well

Pittsburgh Plate Glass Company 18 32  
New Martinsville, W.Va. 11 837  
Defense Plant Corp. Acres 225 8 5/8 6430  
E. Bank of Ohio River near Proctor 4 6782  
4 Elev. 640  
Franklin Marshall County  
Defense Plant Corp. Washington, D. C.  
  
May 13, 1943  
Aug. 4, 1943

Rotary Table	S	0	12	Anhydrite	H	6658	6667
Sand & Gravel	S	12	17	Salt	H	6667	6791
Clay	S	17	27	Anhydrite	H	6791	6797
Sand & Gravel	S	27	31				
Bed Rock	S	31	93				
Sand	S	93	102				
Lime	S	102	136				
Shale & Lime	S	136	169				
✓Coal	S	169	171 1/2				
Shale & Lime	S	171 1/2	231				
Coal	S	231	232				
Shale & Lime	S	232	259				
✓Coal	S	259	262				
Shale	S	262	298				
Shale, Lime with Sand	S	298	371				
Shale & Lime	S	371	384				
Red Rock	S	384	410				
Shale & Lime	S	410	418				
Shale	S	418	485				
Shale & Lime	S	485	580				
Shale	S	580	620				
Shale & Lime	S	620	879				
Sand & Lime	H	879	891				
Shale	H	891	937				
Shale with Sand & Lime	H	937	1055				
Shale & Sand	H	1055	1180				
Sand	H	1180	1202				
Sand & Shale	H	1202	1275				
Shale	H	1275	1295				
✓Lime & Shale with Sand	H	1295	1344				
Hd. Sand & Salt Sand	H	1344	1374				
✓Hd. Sand & Lime	H	1374	1575				
Sand, Lime & Shale	H	1575	1610				
Shale with Sandy Lime	H	1610	1662				
Shale & Lime Hd. Sand	H	1662	1757				
Sand, Shale & Lime	H	1757	1979				
✓Shale & Lime	H	1979	2070				
Shale & Sandy Shale	H	2070	2110				
Shale & Lime	H	2110	2276				
Hd. Sand & Lime	H	2276	2322				
Hd. Shale & Sandy Lime	H	2322	2442				
Sandy Shale & Lime	H	2442	2476				
Shale & Sandy Lime	H	2476	2543				
Sand, Shale & Lime	H	2543	2946				
Sandy Shale with Lime	H	2946	3371				
Hd. Shale & Sandy Lime	H	3371	3416				
Sandy Shale & Lime	H	3416	3460				
Shale & Lime	H	3460	5790				
on - Chert & Lime	H	5790	5823				
Chert	H	5823	5835				
Chert & Lime	H	5835	5851				
Chert	H	5851	5873				
Chert & Lime	H	5873	5890				
Chert	H	5890	5993				
or - Hd. Sand	H	5993	6059				
✓Hd. Shale & Sandy Lime	H	6059	6646				
✓Shale & Anhydrite	H	6646	6658				

5790  
640  
-----  
5150

5993  
640  
-----  
5353

STATE OF WEST VIRGINIA  
DIVISION OF ENVIRONMENTAL PROTECTION  
SECTION OF OIL AND GAS

MAR 15 93

AFFIDAVIT OF PLUGGING AND FILLING WELL

AFFIDAVIT SHOULD BE IN TRIPLICATE, one copy mailed to the Division, one copy to be retained by the Well Operator and the third copy (and extra copies if required) should be mailed to each coal operator at their respective addresses.

Farm name: PPG INDUSTRIES, INC. Operator Well No.: BRINE WELL #4

LOCATION: Elevation: 640.00 Quadrangle: NEW MARTINSVILLE  
District: FRANKLIN County: MARSHALL  
Latitude: 3100 Feet South of 39 Deg. 45 Min. 0 Sec.  
Longitude 4000 Feet West of 80 Deg. 50 Min. 0 Sec.

Well Type: OIL \_\_\_\_\_ GAS \_\_\_\_\_ Brine X

Company: PPG Industries, Inc.  
P.O. Box 191  
New Martinsville, WV 26155

Coal Operator PPG Industries, Inc.  
or Owner P.O. Box 191  
New Martinsville, WV 26155

Agent: K. S. WALBORN

Coal Operator \_\_\_\_\_  
or Owner \_\_\_\_\_

Permit Issued: 08/11/92

AFFIDAVIT

STATE OF WEST VIRGINIA,  
County of MARSHALL ss:

I.L. Morris Well Service and HALLIBURTON SERVICES being first duly sworn according to law depose and say that they are experienced in the work of plugging and filling oil and gas wells and were employed by the above named well operator, and participated in the work of plugging and filling the above well, and RANDALL MICK Oil and Gas Inspector representing the Director, say that said work was commenced on the Third day of August, 1992, and that the well was plugged and filled in the following manner:

TYPE	FROM	TO	PIPE REMOVED	LEFT
BAKER OPEN Hole Bridge Plug	6039.06'	6036.06'	0' to 2241.40'	2241.40' to 6429.90'
CEMENT	6036.06'	5536.06'	OF 8 5/8" PIPE	OF 8 5/8" PIPE
GEL	5536.06'	5102'		
CEMENT	5102'	4829.26'	0'-1000' OF	0'-837.36'
CEMENT	2329.16'	2129.16'	4 1/2" EUE LINER	OF 11 3/4" OD PIPE
CEMENT	1588.51'	1288.51'		
CEMENT	1037.51'	687.51'		
CEMENT	139.93'	SURFACE		
* Brine Mud / GEL Between Cement	BETWEEN CEMENT			

Description of monument: 30" High, 8 5/8" Ø Pipe RISER with Cap AND WELL ID and that the work of plugging and filling said well was completed on the 9th day of August, 1992.

And further deponents saith not.

K. S. Walborn 1/28/93

Sworn and subscribe before me this 2nd day of February, 1993  
My commission expires: Mar. 23, 2002

Alice K. Johnson  
Notary Public

Randal Mick  
Oil and Gas Inspector:



OFFICIAL SEAL  
NOTARY PUBLIC  
STATE OF WEST VIRGINIA  
ALICE K. JOHNSON  
Route 1, Box 6 Doon

MAR 23 1993