

COAL OWNED BY _____
 RECONDITION & PARTIAL PLUG (ACTIVE WELL)

NEW LOCATION...

DRILL DEEPER...

ABANDONMENT... *issued 2-17-71*

WELL TIES AND ELEV. TAKEN FROM GUY PATTERSON DRAWING.

COMPANY THE MANUFACTURERS LIGHT & HEAT
 ADDRESS 300 UNION TRUST BLDG. PGH. PA.
 FARM C.F. WILLIAMS
 TRACT _____ ACRES 45 LEASE No. 26957
 WELL (FARM) No. 2 SERIAL No. 4210
 ELEVATION (SPIRIT LEVEL) 1263'
 QUADRANGLE CAMERON SW
 COUNTY MARSHALL DISTRICT LIBERTY
 ENGINEER I. STEGMAN (GUY PATTERSON DWG.)
 ENGINEER'S REGISTRATION No. 304
 FILE No. _____ DRAWING No. Y-15-973
 DATE 16 JUNE 1959 SCALE 1" = 660'

STATE OF WEST VIRGINIA
 DEPARTMENT OF MINES
 OIL AND GAS DIVISION
 CHARLESTON

WELL LOCATION MAP

FILE No. MARS-141-Recondition
 CORRECTED
Mars-141-R-PP-P

+ DENOTES LOCATION OF WELL ON UNITED STATES TOPOGRAPHIC MAPS, SCALE 1 TO 62,500. LATITUDE AND LONGITUDE LINES BEING REPRESENTED BY BOLDEN LINES AS SHOWN.

- DENOTES ONE INCH SPACES ON BORDER LINE OF ORIGINAL TRACING.

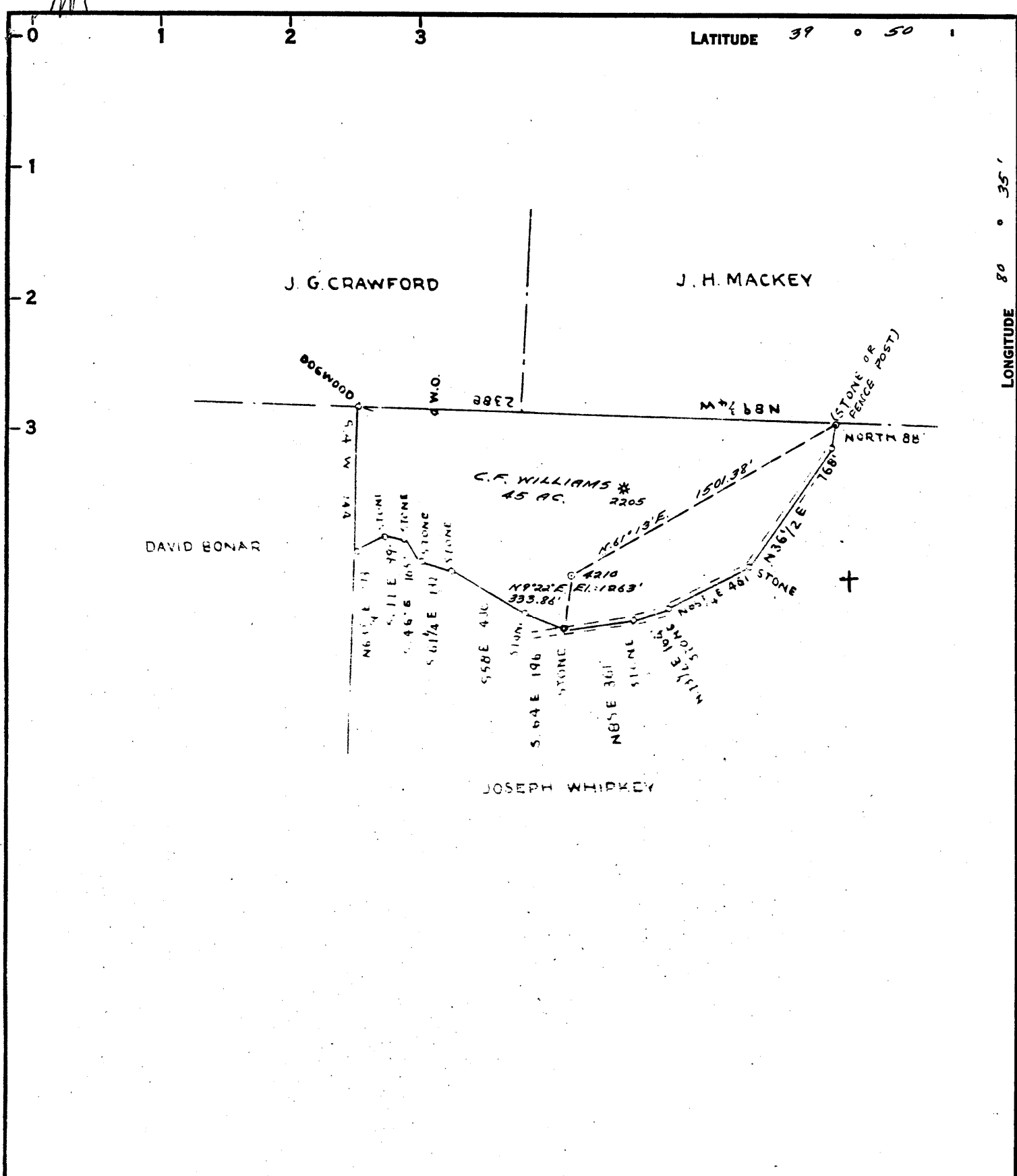

COAL OWNED BY RECONDUCTION + PARTIAL PLUG (ACTIVE WELL)

NEW LOCATION

DRILL DEEPER

ABANDONMENT

WELL TIES AND ELEV. TAKEN FROM GUY PATTERSON DRAWING.

COMPANY THE MANUFACTURERS LIGHT + HEAT

ADDRESS 300 UNION TRUST BLDG. PGH. PA.

FARM C.F. WILLIAMS

TRACT _____ ACRES 45 LEASE No. 26957

WELL (FARM) No. 2 SERIAL No. 4210

ELEVATION (SPIRIT LEVEL) 1263'

QUADRANGLE CAMERON - 5C

COUNTY MARSHALL DISTRICT LIBERTY

ENGINEER I. STEGMAN (GUY PATTERSON DWG.)

ENGINEER'S REGISTRATION No. 394

FILE No. _____ DRAWING No. Y-15-973

DATE 16 JUNE 1959 SCALE 1" = 660'

STATE OF WEST VIRGINIA
DEPARTMENT OF MINES
OIL AND GAS DIVISION
CHARLESTON

WELL LOCATION MAP

FILE No. MARS-141-ReconDition
CORRECTED

+ DENOTES LOCATION OF WELL ON UNITED STATES TOPOGRAPHIC MAPS. SCALE 1 TO 62,500. LATITUDE AND LONGITUDE LINES BEING REPRESENTED BY BORDER LINES AS SHOWN.

- DENOTES ONE INCH SPACES ON BORDER LINE OF ORIGINAL TRACING.

too crowded to plot.

WEST VIRGINIA DEPARTMENT OF MINES
OIL & GAS DIVISION
W E L L R E C O R D

Permit No. Mars 141

Oil & Gas Well
CASING & TUBING

Cameron Quad.	Guy B. & A. G. Patterson			
Company	Cameron, W.Va.	10	260	200
Address	Herman Romack Acres 44	8 1/2	1334	1334
Farm	Big Run	6 5/8	2029	2029
Location	1 Elev. 126'3	2	2940	2940
Well No	Liberty Marshall County			
District	Herman Romack, Star Route		Coal at 634', 638',	
Surface	Cameron, W.Va.		834', 839', 934, 940'	
Mineral	Belton Fuel Co., Uniontown, Panna.			
Commenced	August 15, 1943			
Completed	Oct. 1, 1943			
Date shot	Oct. 1, 1943	Depth 2926 to 2936		
Open flow	with 20 qts. glycerine			
Volume	5 1/2 plate			
Rock Pressure	400,000 C.F.			
Oil	400 lbs. 24 hrs.			
No water	12 bbls., 1st 24 hrs.			

✓Waynesburg Coal	Bk	S	637	642
✓Mapletown "	Bk	S	827	832
✓Pittsburgh Coal	Bk	S	934	939
Sand	Wh	H	1050	1080
✓L. Dunkard	Wh	H	1341	1373
✓B. Dunkard	Wh	H	1455	1514
✓Gas Sand	Wh	H	1540	1565
✓1st Salt S	Bk	M	1625	1655
✓5th Sand	Wh	H	1843	1963
✓Maxon	Wh	H	1963	1992
Slate	Dk	S	1992	2001
✓Big Lime	Wh	H	2001	2062
✓Big Injun	Y	H	2062	2320
Slate	Bk	S	2320	2870
✓Fifty Foot	Wh	H	2870	2893
Slate	Dk	S	2893	2925
✓Gordon	Wh	H	2925	2938
TOTAL				2940

Bluff Sand 2 Bbls 662
 Little Gas 825 In cap
 Little Gas 937
 Little Gas 1060
 Gas 1975
 Gas 2871 400,000 C.F.
 Gas-Oil 2928 Oil 12 bbls. per week

2001
 105

 2106
 1263

 843