

COAL OWNED BY BERTHA COAL CO.  
 JOBE REDRILLED FOR STORAGE  
 NEW LOCATION   
 DRILL DEEPER   
 ABANDONMENT  Issued 8-26-70

COMPANY THE MANUFACTURERS LIGHT AND HEAT CO.  
 ADDRESS 800 UNION TRUST BLDG PITTSBURGH PA.  
 FARM J.N. PYLES  
 TRACT B ACRES 62 LEASE No. 7938  
 WELL (FARM) No. 1 SERIAL No. 2938  
 ELEVATION (SPIRIT LEVEL) 1120'  
 QUADRANGLE LITTLETON NC  
 COUNTY MARSHALL DISTRICT LIBERTY  
 ENGINEER J. L. ...  
 ENGINEER'S REGISTRATION No. \_\_\_\_\_  
 FILE No. W.B.K. 24 PAGE 14 DRAWING No. Y-11-15  
 DATE MARCH 31 1944 SCALE 1" = 800'

**STATE OF WEST VIRGINIA**  
 DEPARTMENT OF MINES  
 OIL AND GAS DIVISION  
 CHARLESTON

**WELL LOCATION MAP**

FILE No. MARS-206-A  
272-Redrill-P

+ DENOTES LOCATION OF WELL ON UNITED STATES TOPOGRAPHIC MAPS. SCALE 1 TO 62,500, LATITUDE AND LONGITUDE LINES BEING REPRESENTED BY BORDER LINES AS SHOWN.

— DENOTES ONE INCH SPACES ON BORDER LINE OF ORIGINAL TRACING.

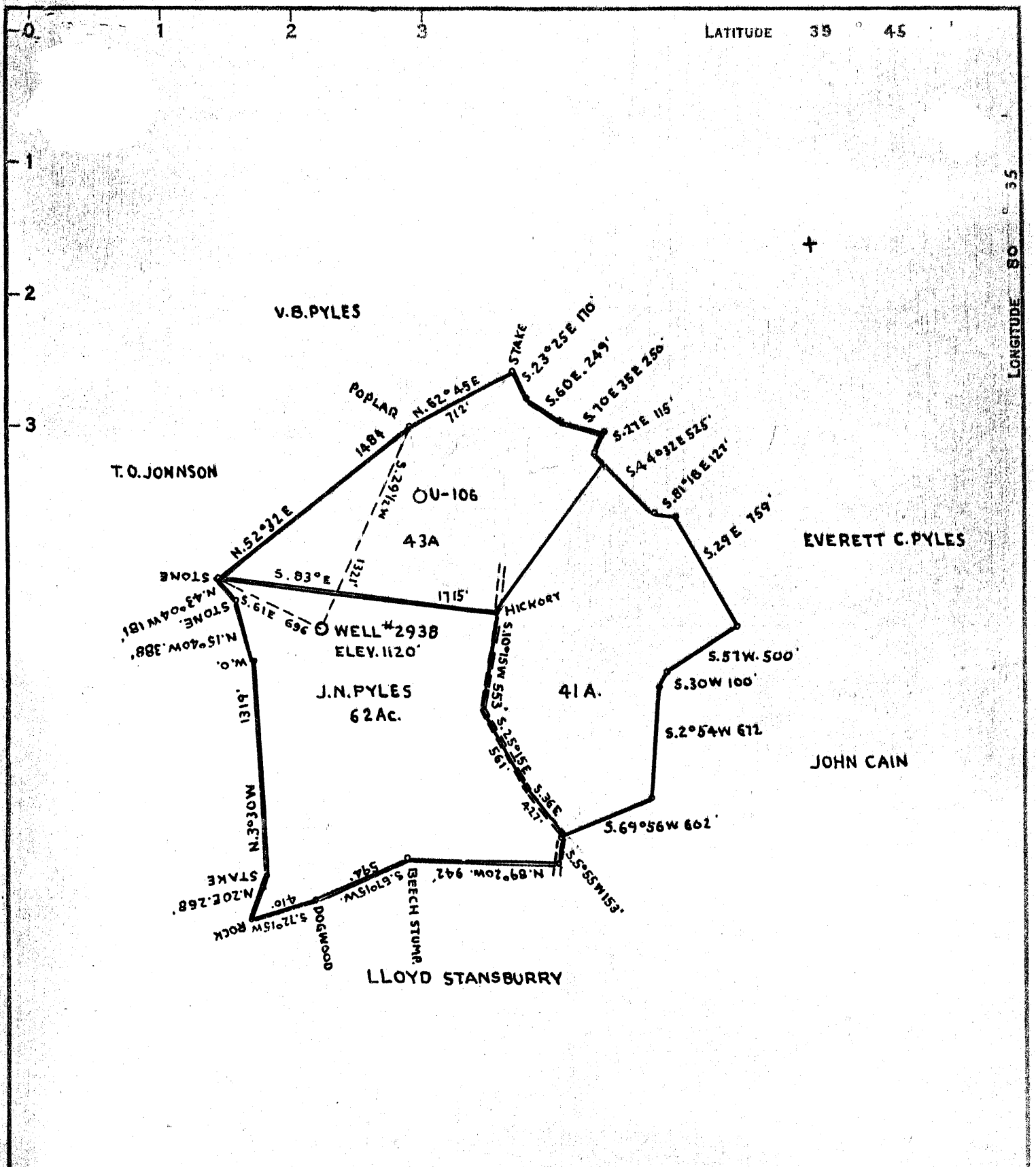

COAL OWNED BY BERTHA COAL CO.  
 To Be Redrilled for Storage  
 NEW LOCATION.....  
 DRILL DEEPER.....  
 ABANDONMENT.....

COMPANY THE MANUFACTURERS LIGHT AND HEAT CO.  
 ADDRESS 600 UNION TRUST BLD'G PITTSBURGH PA.  
 FARM J.N.PYLES  
 TRACT 8 ACRES 62 LEASE No. 1938  
 WELL (FARM) No. 1 SERIAL No. 2938  
 ELEVATION (SPIRIT LEVEL) 1120'  
 QUADRANGLE LITTLETON  
 COUNTY MARSHALL DISTRICT LIBERTY  
 ENGINEER J. L. ...  
 ENGINEER'S REGISTRATION No. \_\_\_\_\_  
 FILE No. W.BK.24 PAGE 14 DRAWING No. Y-11-15  
 DATE MARCH 31 1944 SCALE 1" = 800'

**STATE OF WEST VIRGINIA**  
 DEPARTMENT OF MINES  
 OIL AND GAS DIVISION  
 CHARLESTON  
**WELL LOCATION MAP**

FILE No. MARS-206-A  
272-Redrill

+ DENOTES LOCATION OF WELL ON UNITED STATES TOPOGRAPHIC MAPS, SCALE 1 TO 62,500, LATITUDE AND LONGITUDE LINES BEING REPRESENTED BY BORDER LINES AS SHOWN.  
 - DENOTES ONE INCH SPACES ON BORDER LINE OF ORIGINAL TRACING.

1,79

1,62

+ 1.795  
1.605

LONGITUDE 80 35

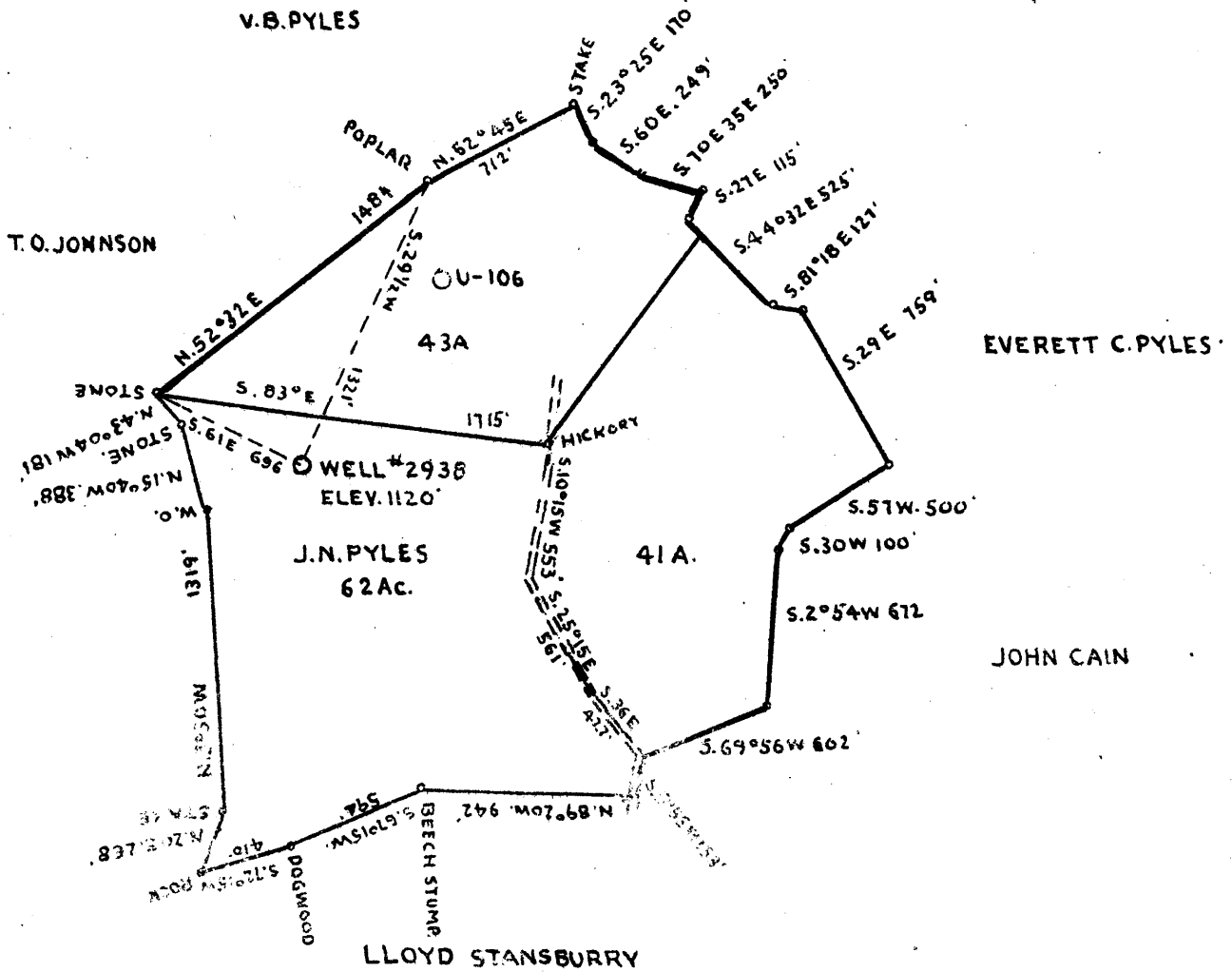

COAL OWNED BY BERTHA COAL CO.

- WELL LOCATION
- RILL DEEPER
- ABANDONMENT

COMPANY THE MANUFACTURERS LIGHT AND HEAT CO.  
 ADDRESS 800 UNION TRUST BLD'G PITTSBURGH PA.  
 FARM J.N.PYLES  
 TRACT B ACRES 62 LEASE NO. 1938  
 WELL (FARM) NO. 1 SERIAL NO. 2938  
 ELEVATION (SPIRIT LEVEL) 1120'  
 QUADRANGLE LITTLETON NC  
 COUNTY MARSHALL DISTRICT LIBERTY  
 ENGINEER [Signature]  
 ENGINEER'S REGISTRATION NO. \_\_\_\_\_  
 FILE NO. W.BK.24 PAGE 14 DRAWING NO. Y-11-15  
 DATE MARCH 31 1944 SCALE 1" = 800'

STATE OF WEST VIRGINIA  
 DEPARTMENT OF MINES  
 OIL AND GAS DIVISION  
 CHARLESTON

WELL LOCATION MAP

FILE NO. MAR-206-A →  
292

→ DENOTES LOCATION OF WELL ON UNITED STATES TOPOGRAPHIC MAP, SCALE 1 TO 62 500. LATITUDE AND LONGITUDE LINES BEING REPRESENTED BY BORDER LINES AS SHOWN

ONE INCH SPACES ON BORDER LINE OF ORIGINAL MAP



STATE OF WEST VIRGINIA  
DEPARTMENT OF MINES  
OIL AND GAS DIVISION

Quadrangle Littleton

WELL RECORD

Permit No. MARS-272-R

Oil or Gas Well Gas  
(KIND)

Company THE MANUFACTURERS LIGHT AND HEAT CO.  
Address 800 Union Trust Bldg., Pgh., Penna.  
Farm J. N. Pyles Acres 61  
Location (waters) \_\_\_\_\_  
Well No. 2938 Elev. 1120'  
District Liberty County Greene  
The surface of tract is owned in fee by \_\_\_\_\_  
Address \_\_\_\_\_  
Mineral rights are owned by \_\_\_\_\_  
Address \_\_\_\_\_  
Drilling commenced January 10, 1955  
Drilling completed April 19, 1955  
Date Shot \_\_\_\_\_ From \_\_\_\_\_ To \_\_\_\_\_  
With \_\_\_\_\_  
Open Flow 40/10ths Water in 1/4 Inch  
/10ths Merc. in \_\_\_\_\_ Inch  
Volume 3990 Cu. Ft.  
Rock Pressure 195 lbs. 48 hrs.  
Oil \_\_\_\_\_ bbls., 1st 24 hrs.  
Fresh water \_\_\_\_\_ feet  
Salt water \_\_\_\_\_ feet

Casing and Tubing	Used in Drilling	Left in Well	Packers
Size			
16			Kind of Packer
13			
10	295	295	Size of
8 1/4	1447	1447	
7	2074	2075	Depth set
5 3/16			
4	2106	2106	Perf. top
2			Perf. bottom
Liners Used			Perf. top
			Perf. bottom

CASING CEMENTED \_\_\_\_\_ SIZE \_\_\_\_\_ No. Ft. \_\_\_\_\_ Date \_\_\_\_\_

COAL WAS ENCOUNTERED AT 615 FEET \_\_\_\_\_ INCHES  
820 FEET \_\_\_\_\_ INCHES 910 FEET \_\_\_\_\_ INCHES  
\_\_\_\_\_ FEET \_\_\_\_\_ INCHES \_\_\_\_\_ FEET \_\_\_\_\_ INCHES

Formation	Color	Hard or Soft	Top	Bottom	Oil, Gas or Water	Depth Found	Remarks
Waynesburg Coal			615	619	Run 295' of	10-3/4"	casing, SM H40
Mapletown Coal			820	825	32.75# on a		steel shoe. Not cemented.
Pittsburgh Coal			910	917	Run 793' of	8-5/8"	casing SM. J55 24#
Big Injun Sand			2078	2323	and connected it to	654'	of original pipe with a casing die nipple.
Total Depth			2323	2323	Run 2074' of	7"	casing SM. J55. 20# on a steel shoe set at 2058. Cemented the 7" and 8-5/8" casing at the same time with 400 bags cement and 2 bags of Aquagel. Good return of cement at surface
				275	Run 2106' of	4 1/2"	tubing SM. J. 12.60# on a steel shoe set at 2078. Cemented with 246 bags cement and 2 bags Aquagel. Good return of cement at surface.

