

LATITUDE 39° 52' 30"



00° 08' 08" LONGITUDE

7'5 OGIS topo location

7.5' loc 1.115 ✓ 15' loc _____
 1.87w (calc.) _____

Company _____

Farm _____

Quad CAMERON 7 1/2'

County MARSHALL

District CAMERON

WELL LOCATION MAP

File No. 051-0574

(024)

COMPANY COLUMBIA GAS TRANSMISSION CORPORATION MAP NO. Cameron

FARM Margaret R. Campbell, Agt. WELL NO. 601653

DISTRICT Cameron COUNTY Marshall STATE WV

SCALE: 1" = 1375' LONG. 80°32'09" LAT. 39°51'31"

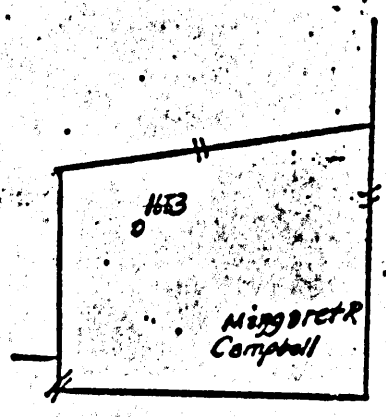

MSH 574

THE MANUFACTURERS LIGHT & HEAT CO.

Company

Division
Record of Well No. **1653**
Field

on **J. H. Buckley**
District Township

Farm
County

Acres
State

Rig Commenced 19 Completed 19
Drilling Commenced 19 Completed 19
Contractor Address
Driller Name

CASING AND TUBING RECORD

Conductor	13"	10"	8 1/2"	7"	6 1/2"	5 1/2"	4"	3"
Used in Drig.								
Let in Well								

PACKER RECORD

SHOOTING RECORD

Size	Depth Set	Type Packer	Date	Type Explosive	Amount	DEPTH		Volume Before Cu. Ft.	Volume After Cu. Ft.
						Top	Bottom		

VOLUME AND PRESSURE

Date	Reading in inches	Liquid	Size Orifice	Volume	Sand	PRESSURE IN MIN.					24 Hr. R. P.	Max. R. P.	Hour
						1	5	10	30	60			

TOTAL INITIAL OPEN FLOW

CUBIC FEET PER 24 HOURS

FORMATION	TOP	BOTTOM	THICKNESS	REMARKS
Slates White Soft	0	80	80	
Lime White Hard	80	205	125	
Slates Black Soft	205	325	120	
Lime White Hard	325	385	60	
Shiff Sand Gray Soft	385	440	55	
Slates Black	440	485	45	
Lime White Hard	440	640	200	
Slates Black Soft	646	685	39	
Lime White Hard	685	730	45	
Slates Black Soft	735	830	95	
Red Rock Red Soft	865	1160	295	
Red Rock Red Soft	1170	1235	65	
Slates White Soft	1280	1380	100	
Slates Black	1380	1410	30	
Lime Gray Hard	1525	1600	75	
Slates White Soft	1600	1700	100	
Slates Black Soft	1770	1800	30	
Pencil Cave Dark Soft	1812	1820	8	
Shells White Hard	2127	2300	173	
Slates Black Soft	2300	2430	130	
30 ft Light Hard	2430	2520	90	
Slates Dark Soft	2520	2670	150	
Pink Rock Red Soft	2700	2721	21	
Slates Dark Soft	2757	2763	6	
Slates Dark Soft	2770	2798	28	

MSH 574

JOHN W. RITCHIE NO. 1653 WELL.

now

574

Cameron District, Marshall County, W. Va.

By Manufacturers Light & Heat Co.

Completed Sept. 22, 1913.

Record from Mr. Schillingham Sept. 30, 1939.

	Top.	Bottom.
Pittsburgh Coal	730	- 737
Murphy Sand	830	- 865
Little Dunkard Sand	1130	- 1170
Big Dunkard Sand	1235	- 1280
Little Lime	1800	- 1812
Big Lime	1820	- 1870
Big Injun Sand	1870	- 2127
50-Foot Sand	2670	- 2700
Gordon Stray Sand	2721	- 2759
Gordon Sand	2763	- 2770
Fourth Sand	2798	- 2803
Fifth Sand	2828	- 2831
Total depth		2885