

LATITUDE 39° 47' 30"

D

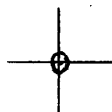

LONGITUDE 80° 37' 30"

7'5 OGIS topo location

7.5' loc 1.42 S ✓ 15' loc 4.30 S  
                  1.98 W (calc.) 4.18 W

Company \_\_\_\_\_

Farm \_\_\_\_\_

Carrerton SC

Quad GLEN EASTON 7 1/2'

County MARSHALL

District MEADE

Elev. 1040 ± (TOPO)

WELL LOCATION MAP

File No. 051-634

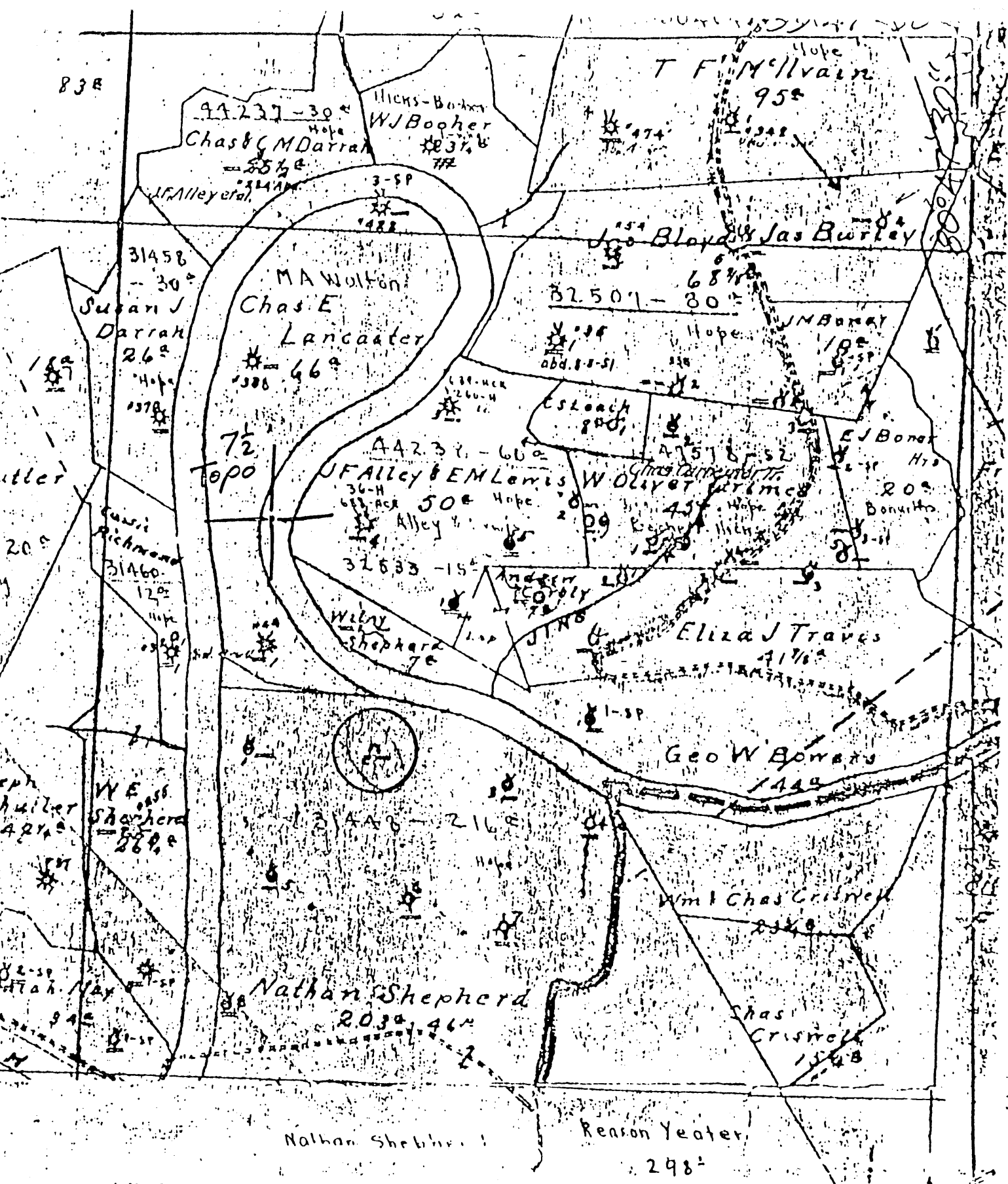

(\*) DENOTES LOCATION OF WELL ON UNITED STATES TOPOGRAPHIC MAPS

FORM IV-6  
8-78  
08 N23 W1



STATE OF WEST VIRGINIA  
DEPARTMENT OF MINES  
OIL AND GAS DIVISION

DATE Jan 5, 1979  
OPERATOR'S WELL NO. 2  
API WELL NO. 47-051-0634  
STATE COUNTY PERMIT

WELL TYPE: OIL  GAS  LIQUID INJECTION  WASTE DISPOSAL   
(IF "GAS", PRODUCTION  STORAGE  DEEP  SHALLOW   
LOCATION: ELEVATION \_\_\_\_\_ WATER SHED Fish Creek  
DISTRICT Meade COUNTY Marshall  
QUADRANGLE Glen Easton 7 1/2  
SURFACE OWNER \_\_\_\_\_ ACREAGE \_\_\_\_\_  
OIL & GAS ROYALTY OWNER \_\_\_\_\_ LEASE NO. \_\_\_\_\_ LEASE ACREAGE \_\_\_\_\_  
PROPOSED WORK: DRILL  CONVERT  DRILL DEEPER  REDRILL  FRACTURE OR STIMULATE  PLUS OFF OLD FORMATION  PERFORATE NEW FORMATION  OTHER PHYSICAL CHANGE IN WELL (SPECIFY) \_\_\_\_\_  
PLUG AND ABANDON  CLEAN OUT AND REPLUG   
TARGET FORMATION \_\_\_\_\_ ESTIMATED DEPTH \_\_\_\_\_  
WELL OPERATOR Pennzoil Company DESIGNATED AGENT James A. Crews  
ADDRESS P. O. Box 1588 ADDRESS P. O. Box 1588  
Parkersburg, WV 26101 Parkersburg, WV 26101

NATHAN SHEPHERD-2

051  
0634

**SOUTH PENN OIL COMPANY—COMPLETION**

NO. 1  
 SERIAL NO. \_\_\_\_\_ FARM Nathan Shepherd WELL NO. 2  
 ELEVATION \_\_\_\_\_ N. 23 S. \_\_\_\_\_ E. 2 W. 24  
 LEASE NO. 31448 ACRES 216  
 WATERS OF \_\_\_\_\_  
 DISTRICT Meade COUNTY Marshall STATE W. Va.  
 DRILLING COMMENCED 2/18/02 COMPLETED 5/3/02 DEPTH 2795

PGH. COAL <del>COAL</del>	SANDS		ELEV. TOP	CASING	
	TOP	BOTTOM			
Big Injun	778	784		10"	1257' 5"
Stray Sand	1875	2110		8"	1504'
Gordon Sand	2732	2738		6"	1769'
	2768	2795		5"	2245' 8"

PACKERS AND DEPTH SET \_\_\_\_\_

INITIAL PROD. 280 Bbls. SAND Gordon DEPTH \_\_\_\_\_  
 GAS TEST \_\_\_\_\_ QUARTS 20 \_\_\_\_\_  
 SHOT 10/;2/02 \_\_\_\_\_  
 REMARKS \_\_\_\_\_ Gordon \_\_\_\_\_ 2770

REPORTED BY G. L. KING NINEVEN DISTRICT

**RADIOACTIVITY LOG**

051-634

Very BAD Copy